

ARCHITECTURAL DESIGN ASSOCIATES, P.C.
7501 'O' STREET, SUITE 105
LINCOLN, NE. 68510

March 1, 2017
DIALYSIS CENTER OF LINCOLN
NORTHWEST UNIT
LINCOLN, NEBRASKA

ADDENDA #2 – For Bid Documents Dated 2-15-2017

This addenda is issued by the Architect to all known bidders before receipt of proposals. Bidders shall acknowledge the receipt of this Addendum on their bid form and all information and instructions given herein shall become a part of the Contract Documents.

SPECIFICATIONS:

Item No. 2-1: 07 62 00 – Sheet Metal Flashing, Trim Gutters and Downspouts

- A. At Section 2.01 'Metals' at paragraph C, revise the Gutter metal thickness to 0.032" thick aluminum.

Item No. 2-1: 11 52 13 – Projection Screens

- A. Delete Specification Section '11 52 13 – Projection Screens' and note that recessed manual projection screens will be provided and installed by the Owner. The Contractor will coordinate openings in the ceiling for the Owner provided screens. The screen sizes are as follows:
 - 1. The South Projection Screen is to be: 150" diagonal – 16:9 aspect ratio – provided by Owner.
 - 2. The North Projection Screen is to be: 100" diagonal – 16:9 aspect ratio – provided by Owner.

DRAWINGS:

Item No. 2-3: Sheet L1.01

- A. At the Site Landscape Plan, add shrubs at the Northeast and Southeast corner of the project and adjust the landscape schedule as shown on the attached sheets AD2-1, AD2-2 and AD2-3.

Item No. 2-2: Sheet A1.0

- A. At the Code Plan Main Level, in addition to the FEC (Fire Extinguisher Cabinet) shown in Corridor 119 and 145, add a note that there is a FEC in Hall 102A and in Staging Area 128. Also, note there is a FE (Wall Mounted Fire Extinguisher) at Mech Lofts 200 and 201.

Item No. 2-3: Sheet A3.1

- A. At Conf/Training Room 151, at the recessed projection screen note number 3, add a note that the Owner will provide and install recessed manual projection screens above the ceiling. The Contractor will include a pre-finished metal trimmed opening in the ceiling at each of 2 projector screens and will coordinate the opening size and location with the Owner.
- B. At Conf/Training Room 151, at the ceiling mounted projector note number 4, add a note to coordinate the projector location with the Owner.

See Attached Electrical Addenda items

END OF ADDENDA NO. 2

CAPE PLAN

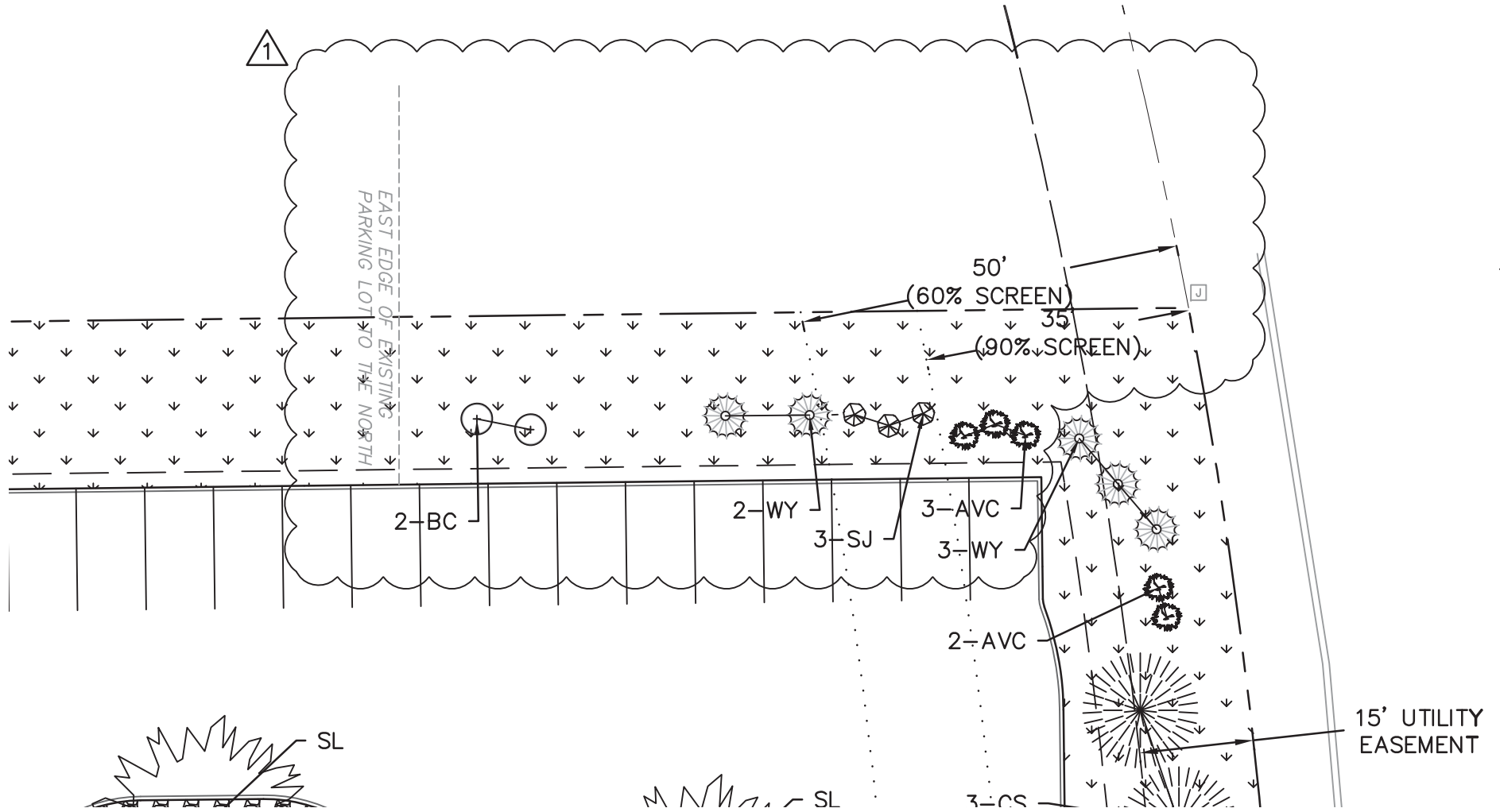

Partial Plan From Landscape Plan Sheet L1.01
Addenda No. 2 - Page: AD2-1
Olsson Assoc. 3-1-2017

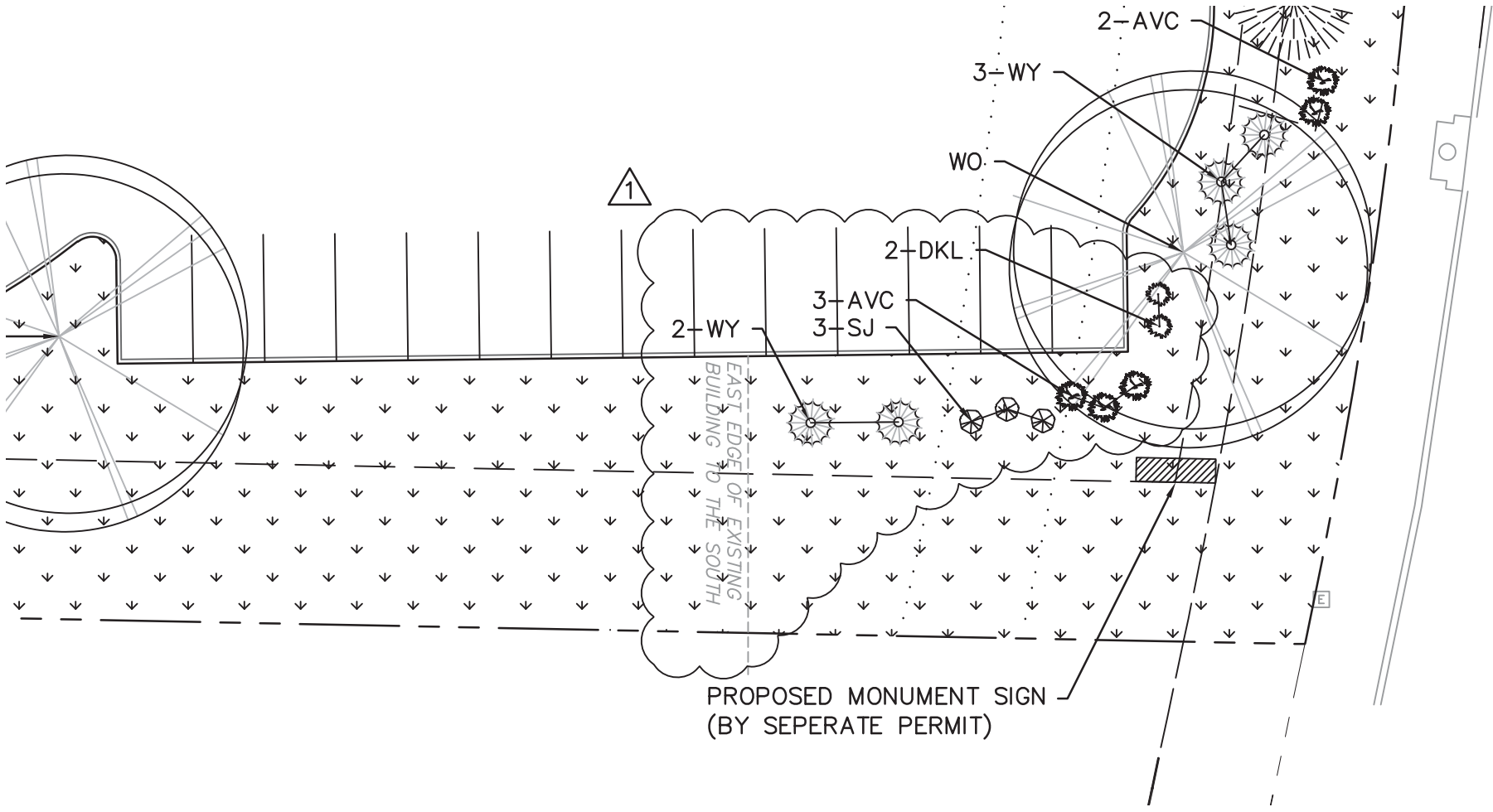

Partial Plan From Landscape Plan Sheet L1.01
 Addenda No. 2 - Page: AD2-2
 Olsson Assoc. 3-1-2017

1 SITE LANDSCAPE PLANT SCHEDULE							
KEY	COMMON NAME	BOTANICAL NAME	SIZE @ PLANTING	PLANTING METHOD	DESIGN SIZE		QUANT.
					HT.	SPRD.	
EVERGREEN SHRUBS							
SJ	Seagreen Juniper	Juniperus chinensis 'Sea Green'	18-24"	B&B	3'	3'	19
BJ	Broadmoor Juniper	Juniperus sabina 'Broadmoor'	15-18"	B&B	12"	4'	14
WY	Ward's Yew	Taxus x media 'Wards'	15-18"	B&B	4'	6'	15
EVERGREEN TREES							
CS	Colorado Spruce	Picea pungens	6'	B&B	25'	15'	6
DECIDUOUS SHRUBS							
BC	Viking Black Chokeberry	Aronia melanocarpa 'Viking'	18-24"	Cont.	4'	4'	12
KS	Knockout Shrubrose	Rosa 'Knockout'	18-24"	Cont.	3'	3'	23
AVC	Compact American Viburnum	Viburnum trilobum compactum	18-24"	Cont.	4'	4'	10
DKL	Dwarf Korean Lilac	Syringa palibiniana 'Meyeri'	15-18"	Cont.	3'	3'	16
DECIDUOUS TREES							
RSM	Red Sunset Maple	Acer rubrum 'Red Sunset'	2" cal.	B&B	35'	30'	3
SL	Shademaster Honeylocust	Gleditsia triacanthos inermis 'Shademaster'	2" cal.	B&B	35'	30'	6
WO	White Oak	Quercus alba	2" cal.	B&B	50'	45'	3

Partial Plan From Landscape Plan Sheet L1.01
 Addenda No. 2 - Page: AD2-3
 Olsson Assoc. 3-1-2017

ADDENDUM



Date: March 1, 2017

Project: NW Dialysis
Salt Creek Circle
Lincoln, NE

To: David Stirtz
Architectural Design Associates
7501 'O' Street, Lincoln, NE 68510
Phone: 402-486-3232
Fax: 402-486-3380

Project No.: 16-113

Addendum No.: 2-R1

CC:

CHANGES TO PROJECT DRAWINGS

All work shall be in accordance with the terms, stipulations, and conditions of the original contract.

Electrical

1. Sheet – E2.1 MAIN FLOOR PLAN-POWER

- a) Provide one Manual pull station in Treatment Room 126A/126B at the north face of the south duct chase just west of Treatment Room door 126.

2. Sheet E2.3R – ENLARGED PLANS – ADDENDA NO. 1

- a) At Sheet E2.3R in Addenda No. 1, at detail 3, revise the 175 amp fuses to 150 amp fuses for the RO water equipment.

3. Sheet – E4.1 DETAIL 1 ELECTRICAL ONE-LINE DIAGRAMS

- a) For the RO water equipment revise the 175amp fuses to 150amp fuses.

4. Specification Section 283111 DIGITAL, ADDRESSABLE FIRE-ALARM SYSTEM

- a) Under paragraph 2.03 A.2 MAUNFACTURERS: Add Other brands that are acceptable are Siemens and EST.

5. Specification Section 263213.16 GASEOUS EMERGENCY ENGINE GENERATORS

- a) Under paragraph R 1.01 A.1 REVISE TO RELFLECT "Natural gas engine only" and provide an M1 deduct alternate pricing for "removing cost associated with the propane back up feature."

By:

AES

Date:

03/01/2017