



17 MARCH 2015

MILITARY DEPARTMENT
STATE of NEBRASKA
LINCOLN, NEBRASKA

**NEBRASKA ARMY NATIONAL GUARD
CATS FMS #5 Sustainment Project**

at the

**Camp Ashland Training Site
220 County Road A
Ashland, Nebraska 68003**

for the

MILITARY DEPARTMENT
STATE of NEBRASKA
Lincoln, Nebraska

ADDENDUM NO. 1

The original specifications and drawings on the STATE OF NEBRASKA REQUEST for PROPOSAL FORM for the project noted above are amended as noted in this Addendum No. 1.

Receipt of this Addendum shall be acknowledged by inserting its number and date in the space provided on the Bid Form.

ADDENDUM NO. 1

NOTE TO ALL PLANHOLDERS: Please insert this Addendum into your copy of the Contract Documents for the above named project.

The following changes to the Contract Documents are issued by the CFMO-CMB and shall have the same force and affect as though a part of the original issue.

THE RECEIPT DATE, TIME and LOCATION of the BID PROPOSAL submission HAS NOT CHANGED.

ITEM NO.:

ADD 1-1. See attached Pre-Bid Meeting "Sign In Sheet".

Changes to Project Manual

NONE

Changes to drawings

ADD 1-2. Reference Sheet AD101: Replace with attached AD101-Revised 18 Mar. 2015. Note that ABI items are identified.

ADD 1-3. Reference Sheet AD101, General Demolition Note 7: As a matter of clarification, owner will be responsible for moving all necessary existing furniture and equipment.



ADD 1-4. Reference Sheet A101 "5B": Revise sheet to show yellow paint stripe and note shown on attached "A101.1". Note that "floor build up" will only occur if ABI 5 is accepted.

ADD 1-5. Reference Sheet A102: Replace with attached A102-Revised 18 Mar 2015, modify roof sections at exhaust fans.

ADD 1-6. Reference Sheet A601, revise Note 2. "Owner to move all equipment and furnishings as required to perform work." in lieu of "contractor to assist with necessary movement of equipment", refer to sketch A601.1.

ADD 1-7. "5B": Revise sheet to show yellow paint stripe and note shown on attached "A101.1". Note that "floor build up" will only occur if ABI 5 is accepted.

ADD 1-8. Reference Sheet MD101: As a matter of clarification, demolition involving vehicle exhaust system will only occur if ABI 1 is accepted.

ADD 1-9. Reference Sheet M101: As a matter of clarification, installation of new vehicle exhaust system will only occur if ABI 1 is accepted.

ADD 1-10. Reference Sheet M201: As a matter of clarification, installation of new welder exhaust system will only occur if ABI 2 is accepted.

THIS ADDENDUM SHALL BE ATTACHED TO AND MADE A PART OF THE DRAWINGS AND SPECIFICATIONS AND SHALL BE ACKNOWLEDGED WITH THE BIDDER'S PROPOSAL.

DARYL L. BOHAC

Major General The Adjutant General

End of Addendum No. 1



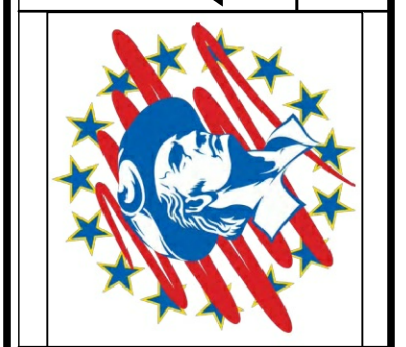

NEBRASKA NATIONAL GUARD
31100090
Camp Ashland Field Maintenance Shop #5
Ashland, Nebraska 68003

© 2014 Calvin L. Hinz Architects P.C.
These plans are specifically designed for construction by Calvin L. Hinz Architects and are intended for no other purposes. Permission for use of this document in part or whole without written consent of Calvin L. Hinz Architects is prohibited.

DATE: 24 FEB 15
DRAWN BY: R.J.R.
APPROVED BY: C.L.H.
PROJECT NO: 2014-18
Calvin L. Hinz is the Coordinating Professional

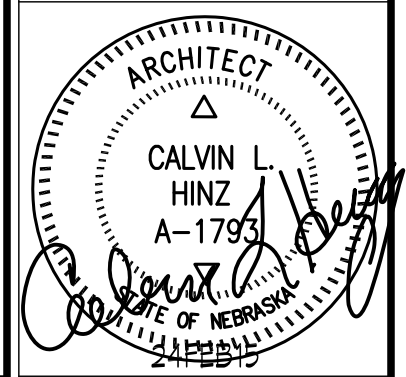

FIRST FLOOR & MEZZANINE DEMO PLANS

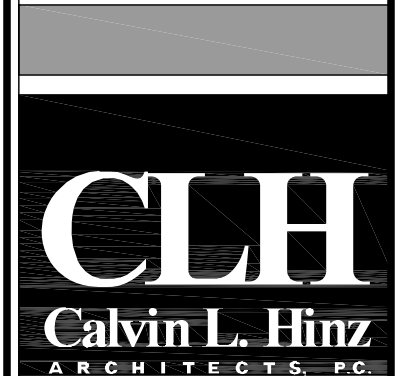

SHEET NO: **AD101**

- GENERAL DEMOLITION NOTES:**
1. DASHED BOLD LINES INDICATE EXTENT OF DEMOLITION.
 2. CONTRACTOR SHALL FIELD VERIFY ALL EXISTING CONDITIONS.
 3. ALL LIGHT OR HALFTONE LINES INDICATE EXISTING TO REMAIN.
 4. SEE ROOM FINISH SCHEDULE, MECHANICAL PLANS, AND ELECTRICAL PLANS FOR EXTENT OF NEW CEILING CONSTRUCTION OR CEILING PATCHING IN EXISTING AREAS.
 5. SEE ROOM FINISH SCHEDULE FOR EXTENT OF NEW FLOORING MATERIAL IN EXISTING AREAS.
 6. CONTRACTOR TO VERIFY ALL FIELD CONDITIONS & ITEMS NOTED FOR REMOVAL. TAKE INTO ACCOUNT ANY DISCREPANCY AND MAKE PROPER ADJUSTMENT TO ACCOMPLISH REQUIRED CONSTRUCTION & FINISHES.
 7. OWNER WILL BE RESPONSIBLE FOR MOVING ALL NECESSARY EXISTING FURNITURE AND EQUIPMENT.
 8. SALVAGE BRICK TO PATCH EXISTING OPENINGS, CLEAN BRICK PRIOR TO INSTALLATION.
 9. ALL DEMOLITION TO BE COORDINATED WITH OWNER AND TO OCCUR WHILE BUILDING IS OCCUPIED.
 10. BUILDING MUST BE KEPT SECURE AT ALL TIMES, COORDINATE REMOVAL AND INSTALLATION OF DOORS.
 11. DO NOT DEMOLISH (REMOVE) ALTERNATE BID ITEMS IF ALTERNATE BID ITEMS WERE NOT ACCEPTED AND MADE PART OF CONTRACT.

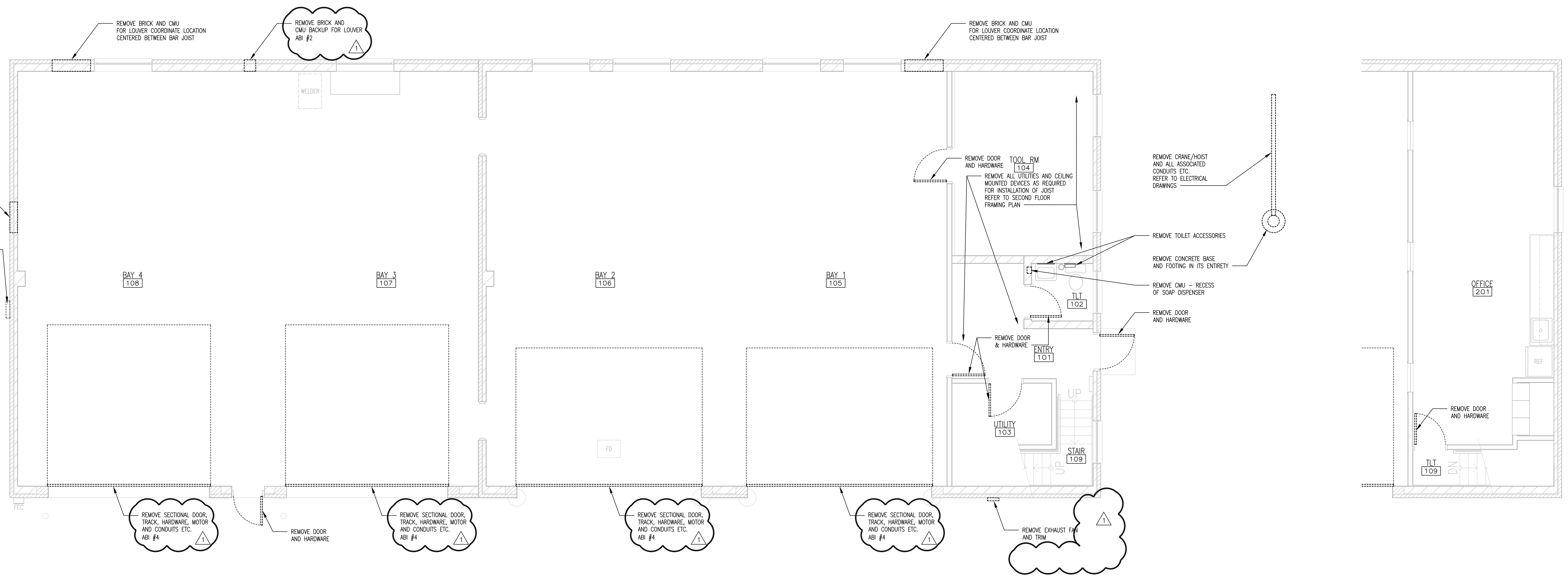

5B FIRST FLOOR - DEMOLITION PLAN
SCALE: 1/4" = 1'-0"

1B SECOND FLOOR - DEMOLITION PLAN
SCALE: 1/4" = 1'-0"

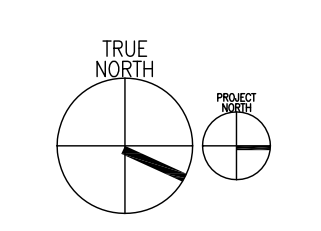

Scale bars for various increments: three eighths inch = one foot, three quarters inch = one foot, one half inch = one foot, one quarter inch = one foot, one eighth inch = one foot, one inch = one foot, one and one half inches = one foot, three inches = one foot, six inches = one foot, twelve inches = one foot.

P:\Projects - Active\2014-18 NNG Ashland Sustainment Bldg 5\Current Drawings\201418AD101.dwg 3-20-15 10:25:57 AM rryckman

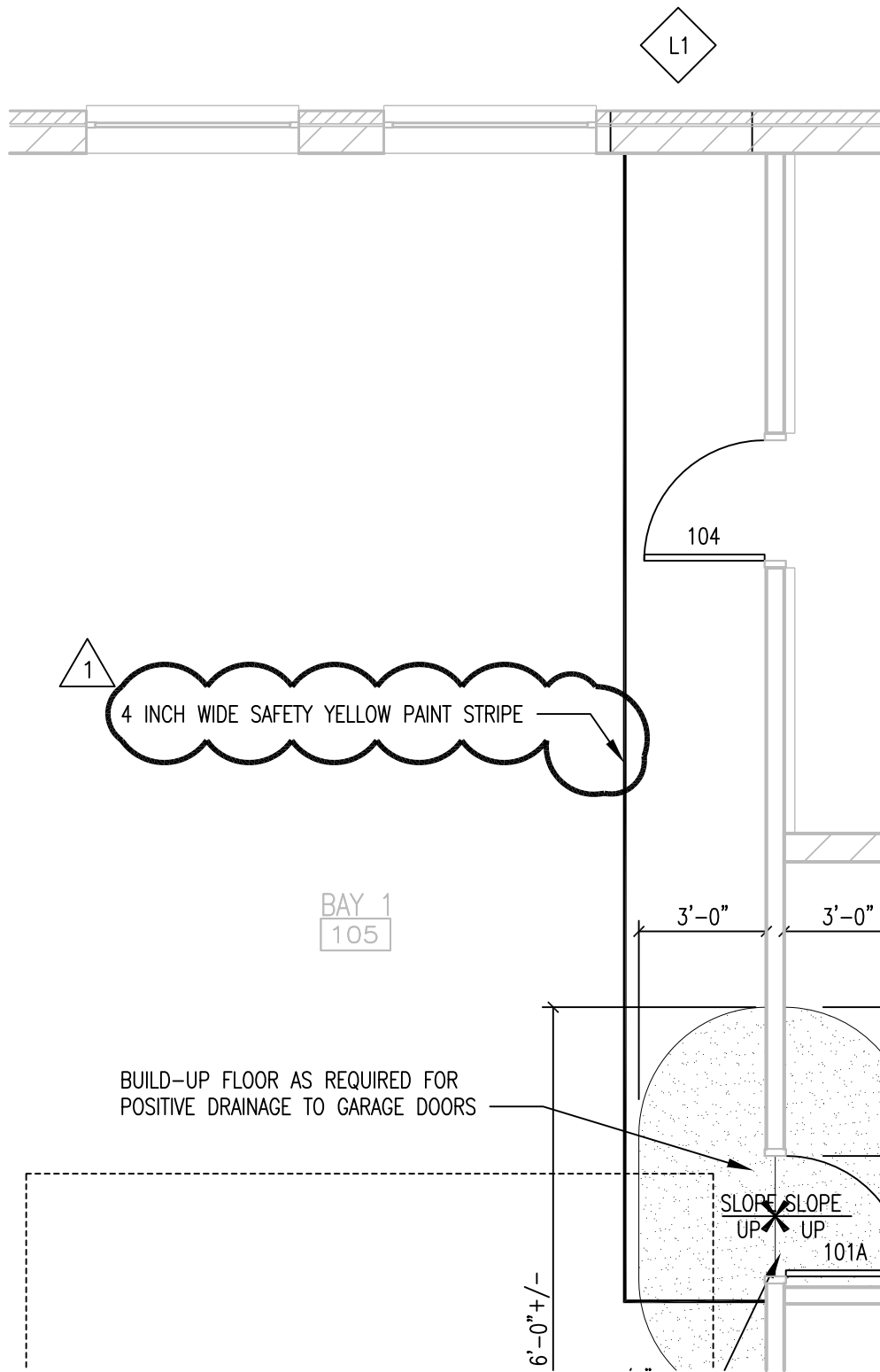

5B FIRST FLOOR – FLOOR PLAN
 SCALE: 1/4" = 1'-0"

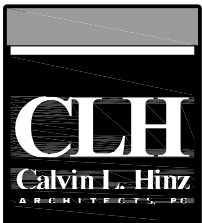

Project Title	NEBRASKA NATIONAL GUARD Camp Ashland FMS #5
Sheet Title	FIRST FLOOR & MEZZANINE FLOOR PLANS

Project Number	2014-18
Project Manager	B. RYCKMAN
Date	18MAR15

Reference Sheet	A101
Reference Document	ADDENDUM 1
Sketch Number	A101.1

1

NOTES:

1. PAINT AND FLOORING WILL BE PHASED AND COORDINATED WITH OWNER IN ADVANCE.
2. OWNER TO MOVE ALL EQUIPMENT AND FURNISHINGS AS REQUIRED TO PERFORM WORK.

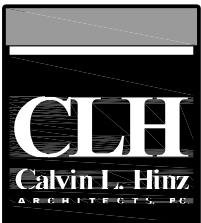

Project Title	NEBRASKA NATIONAL GUARD Camp Ashland FMS #5
Sheet Title	SCHEDULE AND DETAILS

Project Number	2014-18
Project Manager	B. RYCKMAN
Date	18MAR15

Reference Sheet	A601
Reference Document	ADDENDUM 1
Sketch Number	A601.1