



ARCHITECTURE • ENGINEERING • INTERIOR DESIGN

ADDENDUM

PROJECT: Lincoln Public Schools
Wysong Elementary School
Mass Grading Package
Lincoln, Nebraska

ADDENDUM NUMBER

AD-2

ISSUED BY:

Leroy Svatora, Architect
Nate Buss, Civil Engineer

PROJECT #: 14-0133

DATE ISSUED: Wednesday, November 12, 2014

This addendum is issued by the Architect to all known bidders before receipt of proposals, for the purpose of explaining, interpreting, or modifying the original plans and specifications. When enumerated by the bidder upon the proposal sheet, the information or instructions given hereon will be equally binding upon all parties as if included in the original plans and specifications.
BIDDER MUST ENTER THE NUMBER OF THIS ADDENDUM ON HIS PROPOSAL SHEET

THE FOLLOWING ITEMS ARE GENERAL INFORMATION:

AD-2, ITEM 1: Sign-In Sheet

A Pre-Bid Meeting was held on Tuesday, November 11, 2014 beginning at 1:00 p.m. local time. See attached Sign-in Sheet.

AD-2, ITEM 2: Rubble Fill @ B-9

Contractor to remove all rubble materials from site. We are anticipating needing to remove approximately **20 Tons** of rubble. Contractor to provide unit price per ton of rubble to be removed for any change orders that would cause additions or deductions.

AD-2, ITEM 3: As-built Survey

Contractor to perform an as-built survey of the site at time of completion. The as-built survey shall be completed by a licensed surveyor.

AD-2, ITEM 4: Electronic Files

As noted on the plans, CAD files are available for contractors use.

AD-2, ITEM 5: SWPPP Inspections and NDEQ Notice of Intent (NOI)

SWPPP Inspections will be by Contractor.

NOI will be under LPS, with the Contractor being listed as the responsible party.

AD-2, ITEM 6: Areas of Over-Excavation in Building

Refer to pages 6 and 7 of the Geotechnical Report. The areas of the building that are in cut don't need to be over-excavated an additional 3'.

The only area where over-excavation is required is @ B-3 (3.0' below subgrade), B-5 (less than 1.0' below subgrade), and B-6 (less than 1.0' below subgrade).

AD-2, ITEM 7: Areas of Over-Excavation in Pavement

Refer to pages 6 - 9 of the Geotechnical Report. The materials within 3' of all pavement subgrades shall be over-excavated, moisture conditioned, and recompleted to the specifications noted in the Geotechnical Report.

AD-2, ITEM 8: Top Soil and Seeding

Refer to attached exhibit. Contractor will be required to re-spread top soil where seeding and mat is planned. Remaining top soil shall be stockpiled for reuse by Building General Contractor.

Seeding shall only be on areas where mat is planned, See attached exhibit. Seeding shall be Type 'C' as defined in Chapter 30 of the City of Lincoln Standard Specifications. The remaining site shall be seeded by Building General Contractor.

AD-2, ITEM 9: Areas of Over-Excavation in Pavement

Refer to page 7 of the Geotechnical Report. The underlying natural materials are considered suitable foundation materials.

AD-2, ITEM 10: Testing

Materials testing will be retained by the Owner.

AD-2, ITEM 11: Building Subgrade Elevation

Subgrade is 8" below finish floor elevation.

AD-2, ITEM 12: Completion Dates

The contractor shall anticipate two (2) completion dates; one for the Building Pad, Parking Lot, and Well Field; and one for the remaining site work. See attached exhibit denoting each area.

Building Pad, Parking Lot, and Well Field Completion Date: **January 30, 2015**
Remaining Site Work Completion Date: **March 27, 2015**

AD-2, ITEM 13: Square Feet of Mat

Refer to attached exhibit and Item 8 above. The total area of mat is 72,000 Square Feet.

AD-2, ITEM 14: Sediment Trap

See attached to clarify sediment trap elevations.

AD-2, ITEM 15: Excess Material

Contractor to stockpile approximately 5,000 Cubic Yards of material on site to be handled by the General Contractor. Location of stockpile shall be north of the building and west of planned well field. Coordinate with Owner and Engineer on stockpile location.

THE FOLLOWING ITEMS ARE APPLICABLE TO THE SPECIFICATIONS:

AD-2, ITEM 16: Revised Bid Form

In reference to the Bid Form, Bid Form has been modified to add unit pricing for Unit Price No. 1 noted in Item 2 above.

END AD-2

SIGN-IN SHEET — WYSONG ELEM.

11/11/14

NAME	COMPANY	EMAIL	PHONE
Jim Loseke	LPS	TLOSEKE@LPS.ORG	402 436-1072
Matt Westling	Shanahan	mattw@shanahinc.com	429-1402
Don Theisen	Commercial Contractors	doncei@neb.com	476-1711
Ben Woods	LMS Exc + Demo	ben@landexcdemo.com	477-5263
Adam Root	GANATRUCK:EXC	adamr@ganatruck.com	794-5000
Brian Tekelste	LPS	btekelst@lps.org	436-1072
NATE BUSS	OA	n.buss@olssonassociates.com	458-5645

N

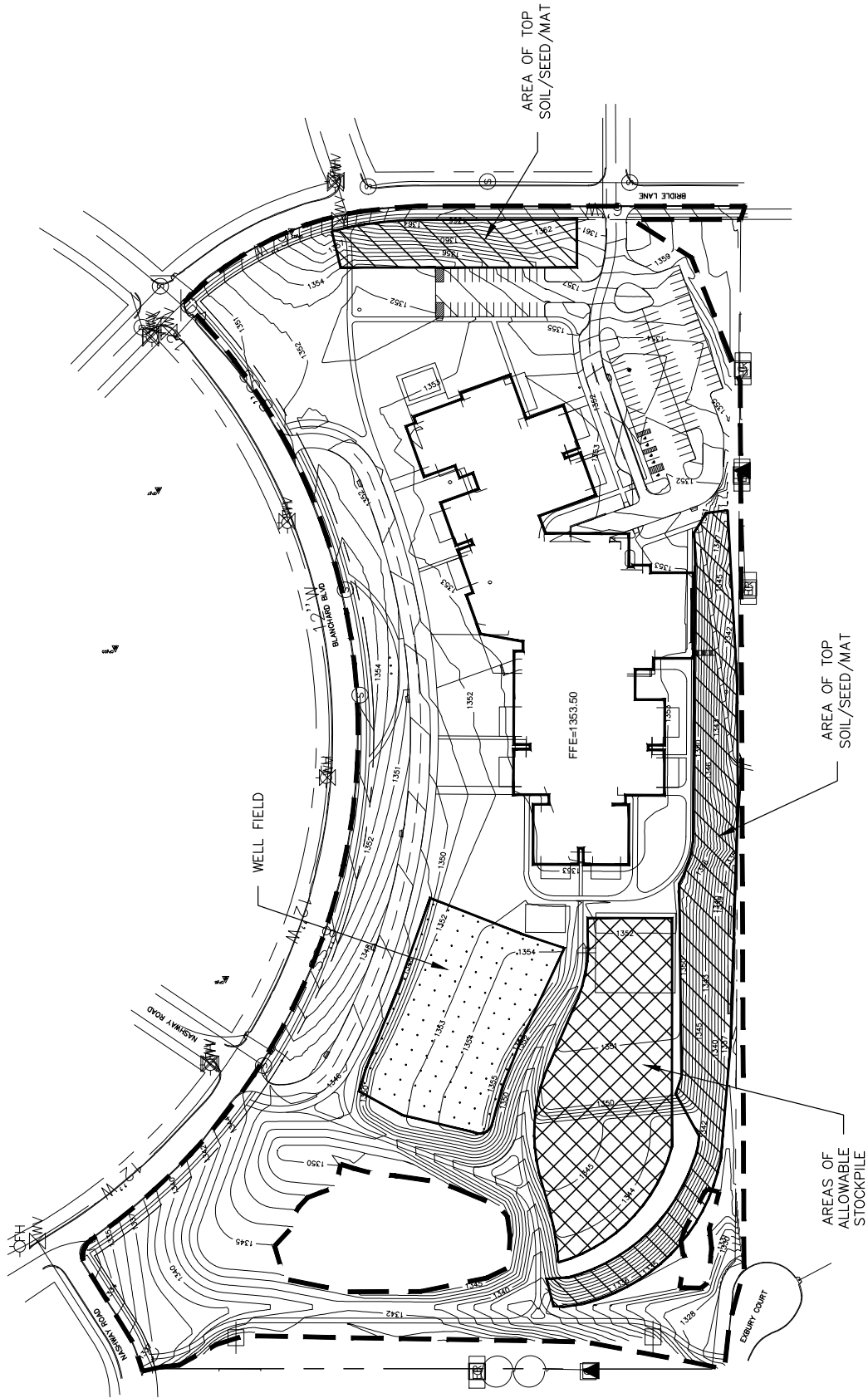

PROJECT NO: 014-1397

DRAWN BY: JEF

DATE: 11.13.2014

WYSONG ELEMENTARY GRADING EXHIBIT



601 P Street, Suite 200
P.O. Box 84608
Lincoln, NE 68508
TEL 402.474.6311
FAX 402.474.5160

EXHIBIT

1

TEMPORARY SEDIMENT BASIN SCHEDULE

BASIN	DRAINAGE AREA (AC)	RECD. SEDIMENT VOL. (CY)	LENGTH (FT)	WIDTH (FT)	D1 (FT)	D2 (FT)	D3 (FT)	D4 (FT)	D5 (FT)	AVAIL. SEDIMENT VOL. (CY)	FLOWING AT INVERT
NORTH	4.60	616 CY	60	40	4.0'	6.0'	7.0'	8.0'	9.0'	356 CY	FL(24")=1341.60
SOUTH	3.05	409 CY	50	30	4.0'	6.0'	7.0'	8.0'	9.0'	222 CY	FL(18")=1346.15

PROJECT NO: 014-1397

DRAWN BY: JEF

DATE: 11.13.2014

**WYSONG ELEMENTARY
SEDIMENT TRAP TABLE**



601 P Street, Suite 200
P.O. Box 84608
Lincoln, NE 68608
TEL 402.474.6311
FAX 402.474.5160

EXHIBIT

2

**LINCOLN PUBLIC SCHOOLS
WYSONG ELEMENTARY SCHOOL
MASS GRADING PACKAGE
LINCOLN, NEBRASKA**

DOCUMENT 004113 - BID FORM - STIPULATED SUM (SINGLE-PRIME CONTRACT)

1.1 BID INFORMATION

A. Bidder: _____.

B. Project Identification:

1. Lincoln Public Schools
Wysong Elementary School
Mass Grading Package
7901 Blanchard Boulevard
Lincoln, Nebraska 68516

C. Owner: Lincoln Public Schools.

D. Owner Project Number: 7924-1.

E. Architect:

Davis Design, Inc.
1221 'N' Street, Suite 600
Lincoln, Nebraska 68508
Telephone: (402) 476-9700
Facsimile: (402) 476-9722

F. Architect Project Number: 14-0133.

1.2 CERTIFICATIONS AND BASE BID

A. Base Bid, Single-Prime (All Trades) Contract: The undersigned Bidder, having carefully examined the Procurement and Contracting Requirements, Conditions of the Contract, Drawings, Specifications, and all subsequent Addenda, as prepared by Davis Design, Inc., and Architect's consultants, having visited the site, and being familiar with all conditions and requirements of the Work, hereby agrees to furnish all material, labor, equipment and services, including all scheduled allowances, necessary to complete the construction of the above-named project, according to the requirements of the Procurement and Contracting Documents, for the stipulated base bid sum of:

BID AMOUNT

1. _____
_____ Dollars \$ _____.

**LINCOLN PUBLIC SCHOOLS
WYSONG ELEMENTARY SCHOOL
MASS GRADING PACKAGE
LINCOLN, NEBRASKA**

1.3 UNIT PRICES

- A. Unit Price No. 1: Provide unit price per ton of rubble to be removed for any change orders that would cause additions or deductions.

BID AMOUNT

1. _____
_____ Dollars \$ _____/ton.

1.4 BID GUARANTEE

- A. The undersigned Bidder agrees to execute a contract for this Work in the above amount and to furnish surety as specified within 10 days after a written Notice of Award, if offered within 30 days after receipt of bids, and on failure to do so agrees to forfeit to Owner the attached cash, cashier's check, certified check, U.S. money order, or bid bond, as liquidated damages for such failure, in the following amount constituting five percent (5%) of the Base Bid amount above:

1. _____ Dollars \$ _____.

- B. In the event Owner does not offer Notice of Award within the time limits stated above, Owner will return to the undersigned the cash, cashier's check, certified check, U.S. money order, or bid bond.

1.5 TIME OF COMPLETION

- A. The undersigned Bidder proposes and agrees hereby to commence the Work of the Contract Documents on a date specified in a written Notice to Proceed to be issued by Architect, and shall fully complete the Work within _____ calendar days.

1.6 ACKNOWLEDGEMENT OF ADDENDA

- A. The undersigned Bidder acknowledges receipt of and use of the following Addenda in the preparation of this Bid:

1. Addendum No. 1, dated _____.
2. Addendum No. 2, dated _____.
3. Addendum No. 3, dated _____.
4. Addendum No. 4, dated _____.

**LINCOLN PUBLIC SCHOOLS
WYSONG ELEMENTARY SCHOOL
MASS GRADING PACKAGE
LINCOLN, NEBRASKA**

1.7 BIDDER ACKNOWLEDGEMENTS

- A. Bidder acknowledges that all specified allowances and unit costs (if any) are included in the base bid amount.

_____ YES _____ NO

1.8 SUBMISSION OF BID

Respectfully submitted this ____ day of _____, 20__.

Submitted By: _____
(Name of bidding firm or corporation)

Authorized
Signature: _____
(Handwritten signature)

Signed By: _____
(Type or print name)

Title: _____
(Owner/Partner/President/Vice President)

Street Address: _____

City, State, Zip _____

Phone: _____

License No.: _____

Federal ID No.: _____

(Affix Corporate Seal Here)

END OF DOCUMENT 004113