

ADDENDUM NO. 3

PROJECT NAME: Othmer Hall Machine Shop Renovation
UNL PROJECT NUMBER: 10151
BID INVITATION NUMBER: 2410-14-7200

CONSULTANT: Alley Poyner Macchietto Architecture, Incorporated
ADDRESS: 1516 Cuming St, Omaha NE 68102

DATE OF ISSUANCE: 7-15-2014
DATE OF BID OPENING: 7-17-2014

The bid documents dated June 24, 2014 for the above referenced project are amended by this addendum.

NOTICE: This Addendum is issued to all interested prospective bidders as an amendment to the project manual or other parts of the bidding (contract) documents for the above named project. Reference to this Addendum must be included in the Bid proposal. The information contained herein shall be fully incorporated into the contract documents as though originally included therein.

GENERAL ITEMS – ELECTRICAL

1. All fire alarm cabling and devices shall be in conduit and back box system.
2. All Initiating Device Circuits, Signaling Line Circuits, & Notification Appliance Circuits shall be wired Class A.

Class A Fire Alarm Circuits need to follow NFPA 72 note below specifically:

23.4.2.2* Class A and Class X circuits using physical conductors (e.g., metallic, optical fiber) shall be installed such that the outgoing and return conductors, exiting from and returning to the control unit, respectively, are routed separately. The outgoing and return (redundant) circuit conductors shall be permitted in the same cable assembly (i.e., multi-conductor cable), enclosure, or raceway only under the following conditions:

- (1) For a distance not to exceed 10 ft (3.0 m) where the outgoing and return conductors enter or exit the initiating device, notification appliance, or control unit enclosures.
 - (2) For single raceway drops to individual devices or appliances.
 - (3) For single raceway drops to multiple devices or appliances installed within a single room not exceeding 1000 ft² (93 m²) in area.
3. All fire alarm system devices, hardware and installation shall be the responsibility of the electrical contractor.

PRIOR APPROVAL – MECHANICAL

1. The following manufacturers have received prior approval for bidding purposes subject to shop drawing review:
 - A. Louvers Air Balance
 - B. Centrifugal HVAC Fans Twin City Fan Company

ADDENDUM NO. 3

Project Name: Othmer Hall Machine Shop Renovation

Project Number: 10151

2 of 2

MODIFICATIONS TO THE DRAWINGS:

1. Sheet M3.0 HVAC Plan

- A. The width of the exhaust ductwork shall be modified as shown, see attachment M3.0-1.
- B. Section callouts have been added for clarification, see attachment M3.0-1.

2. Sheet M4.0 Mechanical Details

- A. Typical Wall Louver Detail F7 has been modified, see attachment M4.0-1, detail F7.
- B. Exhaust Outlet Sections has been added for clarification, see attachment M4.0-1, detail K12.

MODIFICATIONS TO THE SPECIFICATIONS:

1. Section 00 41 13 – Bid Form – Stipulated Sum

- A. Replace the Bid Form with the new attached form

2. Section 01 22 00- Unit Prices

- A. Add this section to the specification.

END OF ADDENDUM NO. 3

BID PROPOSAL

TO: THE BOARD OF REGENTS OF THE UNIVERSITY OF NEBRASKA
c/o University of Nebraska-Lincoln
Business Services
Procurement Services Dept.
1700 Y Street
Lincoln, NE 68588-0645

BID PROPOSAL FOR: General Contractor

PROJECT: 10151, Othmer Hall Machine Shop

INVITATION NO.: 2410-14-7200

COMPLETE THE FOLLOWING INFORMATION – BIDDERS NAME AND TYPE OF BUSINESS:

This Bid is offered by _____, hereinafter referred to as the Bidder,
 a corporation organized and existing under the laws of the State of _____.
 a limited liability company organized and existing under the laws of the State of _____.
 a partnership doing business as _____.
 an individual doing business as _____.

In response to the Bidding Requirements for the construction of the project identified above by name, invitation number, and project number, the Bidder hereby makes the following representations:

Bidder has received the drawings and specifications for the project prepared by **Architect**.

Bidder has examined the Bidding Documents, visited the site, and otherwise familiarized itself with the local conditions affecting the construction of the project.

COMPLETE THE FOLLOWING INFORMATION – BASE BID:

Bidder agrees to furnish all labor, materials, tools, equipment, services, transportation, and supervision required to complete the work indicated in the Bidding Documents within the time set forth herein for the lump sum Base Bid amount of _____ dollars (\$_____).

COMPLETE THE FOLLOWING INFORMATION – ALTERNATE PROPOSALS:

The Base Bid amount given above may be increased or decreased by the acceptance of any of the Alternate Proposals listed below. The full and complete description of the work to be added to or deleted from the scope of the project by each of the Alternate Proposals is that found in Division 01, Section 01 23 00 - Alternates.

ALTERNATE NO. 1: Provide LED fixtures in lieu of fluorescent light fixtures.

ADD / DEDUCT (circle one) the sum of _____ dollars (\$_____)

COMPLETE THE FOLLOWING INFORMATION – UNIT PRICE PROPOSALS:

The Contract Sum may be increased or decreased by Change Order through the application of the appropriate unit price to the quantities of work added to or deducted from the original scope of work. The unit prices given below are to be utilized in accordance with the provisions of Section 01 22 00 – Unit Prices to compute the adjustments to the Contract Sum resulting from changes in the quantity of any work for which a unit price proposal is provided.

UNIT PRICE NO. 1: Fire seal a 6" pipe penetration.

_____ dollars (\$_____) per _____

SECTION 00 41 13 - BID PROPOSAL FORM

PROVIDE THE FOLLOWING INFORMATION – BID SECURITY:

Included with this Proposal is Bid Security of the type and in the amount required by the Bidding Instructions.

COMPLETE THE FOLLOWING INFORMATION – NUMBER OF ADDENDA RECEIVED:

Bidder has received Addenda Nos. _____, and has included their provisions in this Bid.

COMPLETE THE FOLLOWING INFORMATION – CALENDAR DAYS TO COMPLETE THE WORK:

To substantially complete the work not later than _____ calendar days from the start of construction given in the Notice to Proceed. (Bidder to enter number of days.) Time is of the essence and may be a factor in the award of this Contract.

COMPLY WITH THE FOLLOWING INFORMATION:

In submitting this Bid, Bidder agrees to the following:

1. To hold this Bid open for 60 days following the bid date.
2. To enter into and execute the "University of Nebraska Standard Form Construction Agreement" based upon this Bid, if accepted by Owner.
3. To perform all work required by the Contract Documents.
4. That this Bid has been arrived at without collusion with other Bidders and without any effort or activity which might prevent the University of Nebraska from receiving the lowest possible competitive Bid.
5. To comply with Nebraska Fair Employment Practice Act, understanding that a breach of this provision will be regarded as a material breach of contract.
6. To review and comply with University of Nebraska-Lincoln Standard Terms of Purchase. View at <http://www.nebraska.edu/administration/business-and-finance/purchasing/terms-of-purchase.html>.
7. To comply with all other applicable policies, procedures and requirements of the Board of Regents of the University of Nebraska with respect to this Bid, the Project, the bid invitation and/or the bidding process.

COMPLETE THE FOLLOWING INFORMATION – SIGNATURE AND CONTACT INFORMATION:

Address:

Signature:

Printed Name:

Tele. No.:

Title:

Fax. No.:

Dated this

day of

, 20

Email Address:

SECTION 01 22 00 UNIT PRICES

PART 1 - GENERAL

1.1 RELATED DOCUMENTS

- A. Drawings and general provisions of Contract, including General Conditions and other Division 1 Specifications Sections, apply to this Section.

1.2 SUMMARY

- A. This Section specifies administrative and procedural requirements for unit prices.
 - 1. A unit price is an amount proposed by Bidders and stated on the Bid Form as a price per unit of measurement for materials or services that will be added to or deducted from the Contract Sum by Change Order in the event the estimated quantities of Work required by the Contract Documents are increased or decreased.
 - 2. Unit prices include all necessary material, labor, overhead, profit and applicable taxes.
 - 3. Refer to individual Specification Sections for construction activities requiring the establishment of unit prices. Methods of measurement and payment for unit prices are specified in those Sections.
- B. Schedule: A "Unit Price Schedule" is included at the end of this Section. Specification Sections referenced in the Schedule contain requirements for materials and methods described under each unit price.
 - 1. The Owner reserves the right to reject the Contractor's measurement of work-in-place that involves use of established unit prices, and to have this Work measured by an independent surveyor acceptable to the Contractor at the Owner's expense.

PART 2 - PRODUCTS (Not applicable)

PART 3 - EXECUTION

3.1 UNIT PRICE SCHEDULE

UNIT PRICE NO. 1: It is difficult at this time to define an exact scope of work for sealing the existing penetrations above the west and north corridors. On the bid form, please provide a unit price, including labor and materials, to seal a 6" penetration with fire caulk to achieve a 1-hour fire rating in these areas. Note that the contractor will only be responsible for providing the fire rating from the project side of the penetration. This will be considered an average penetration and used for negotiating a final scope for this work after bids are let.

END OF SECTION

SECTION 01 22 00 UNIT PRICES

THIS PAGE INTENTIONALLY LEFT BLANK

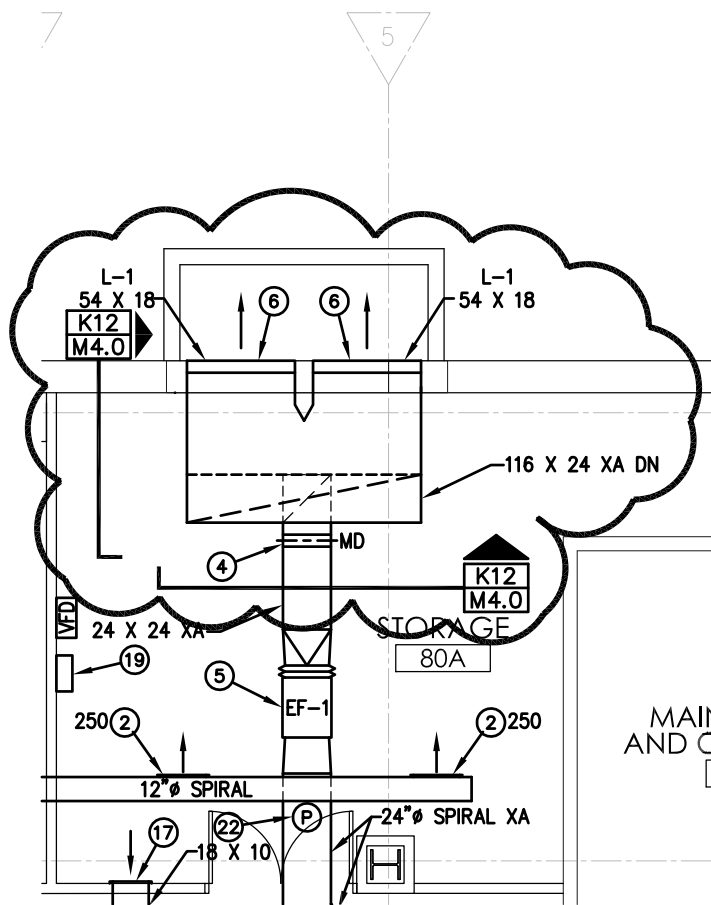

J4 HVAC PLAN
 M3.0 SCALE: 1/8" = 1'-0"

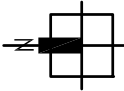

**OTHMER HALL MACHINE
 SHOP RENOVATION
 HVAC PLAN**

SCALE: 1/8" = 1'-0"

MJB



Engineering Technologies Inc.
 Mechanical & Electrical Building Solutions

825 M Street, Suite 200 | Lincoln, NE 68508
 P 402.476.1273 | F 402.476.1274

1111 N. 13th Street, Suite 216 | Omaha, NE
 68102 | P 402.330.2772 | F 402.330.2630

ETI Project No: (2013-096)

ADD #3

SHEET

M3.0

ATTACHMENT NO.

1

07/14/2014

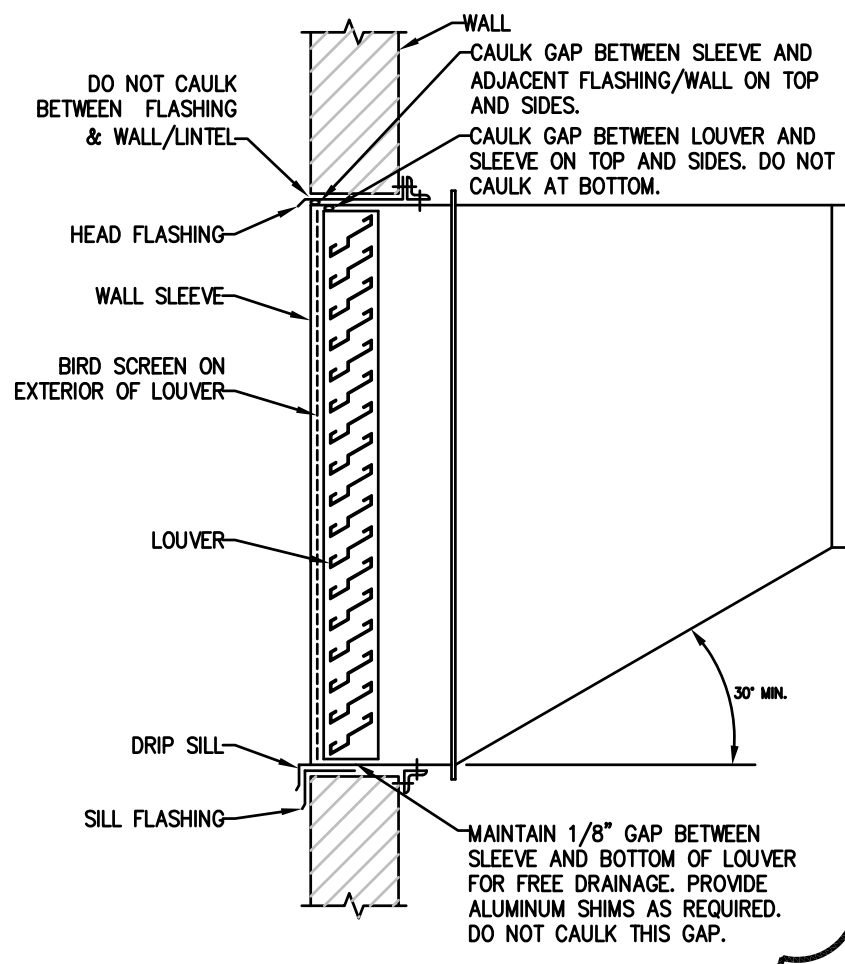

GENERAL NOTES

1. DO NOT ATTACH DUCT TO TOP OF LOWER LOUVER BLADE AS TYPICAL. THIS CREATES SEALING PROBLEMS AT MULLIONS AND OTHER VERTICAL MEMBERS.
2. CONSTRUCT SLEEVE AND DUCTWORK TO SUPPORT WEIGHT OF SERVICE TECHNICIAN.
3. SEAL JOINT BETWEEN DUCT AND SLEEVE WATER TIGHT ALL AROUND.
4. INSULATE DUCT AND SLEEVE AS SPECIFIED.
5. STRUCTURAL OPENING AND ALL STR4UCTURAL SUPPORTS AND SILL SHALL BE BY GENERAL CONTRACTOR. HVAC CONTRACTOR SHALL INSTALL LOUVER AND MAKE ALL FINAL CONNECTIONS

F7 TYPICAL WALL LOUVER DETAIL
M4.0 SCALE: NO SCALE

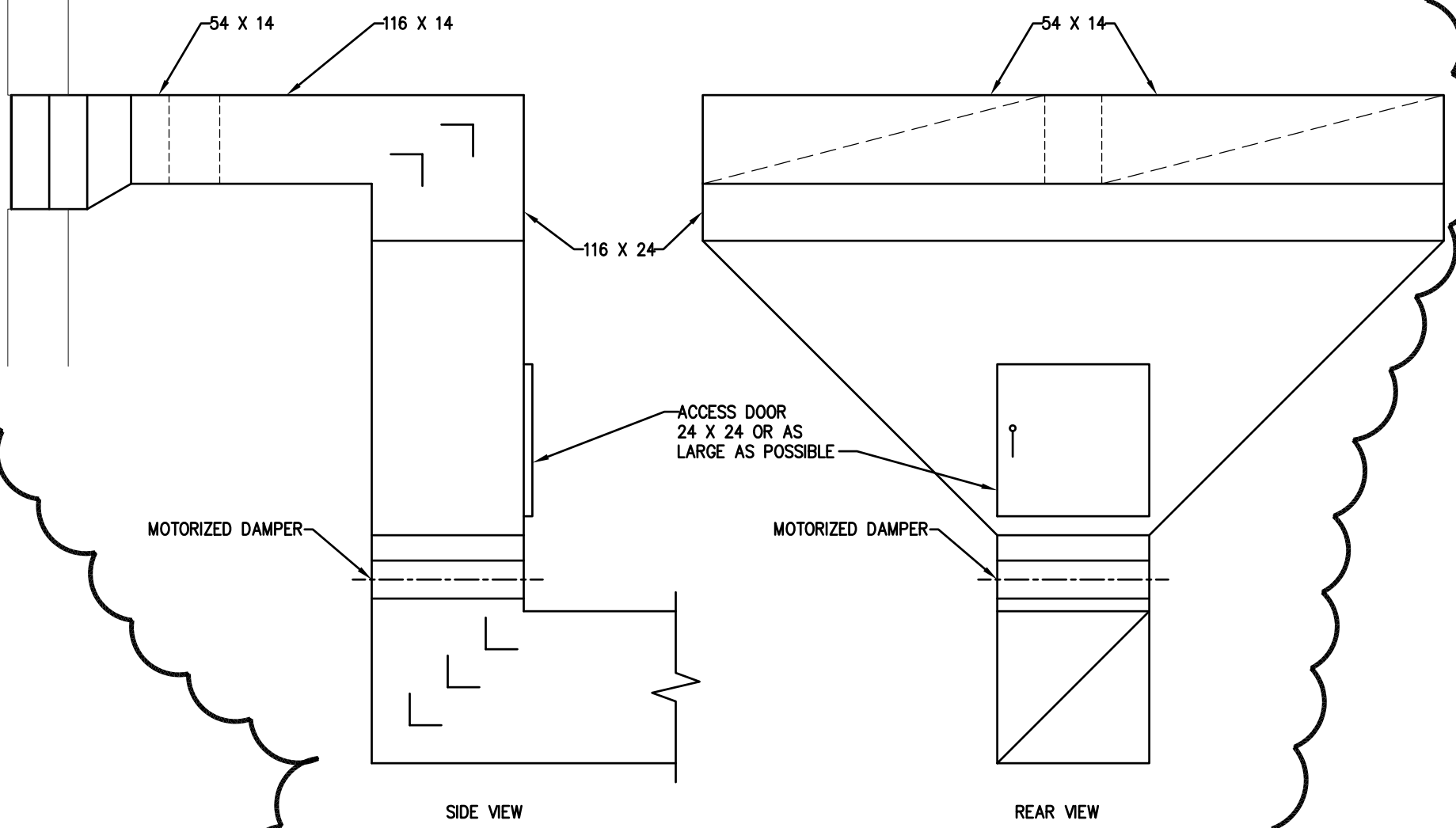

K12 EXHAUST OUTLET SECTIONS
M4.0 SCALE: NO SCALE