



XII STONES INC.

6821 NW 3rd Street
Lincoln, Nebraska 68521

ADDENDUM 1

Date: June 3, 2014

Project: Wayne Maintenance Facility Roof Replacement
District 3
NDOR Building Number: 33702
Project: AFE I-302

This Addendum, consisting of two pages, is issued to the Nebraska Department of Roads and all potential bidders.

The following shall be included with, and considered a part of, the original contract documents to the same extent as if they were included therein, for the construction of the above mentioned project, the Project Manual and Drawings shall be modified or revised as herein described, where at variance with the original work, this Addendum shall have precedence.

SPECIFICATIONS

Section 001000

1. **Bid Date, first paragraph, page 001000-1**
 - A. The bid date for this project has been revised. The new bid date is June 26, 2014 in lieu of June 5, 2014. The time and location for receipt of bids remains the same.
2. **Project Description, third paragraph, page 001000-1**
 - A. In conjunction with the revision of the date for receipt of bids, the mandatory pre-bid walk-through has been revised to allow additional time for contractors to visit the site. It is highly encouraged for interested bidders to visit the site and to become familiar with the existing conditions of the project prior to bidding.

Section 007200

1. **Item 30, last paragraph, page 007200-15**
 - A. Add the following sentence: "Coordinate with the Nebraska Department of Roads the removal and discarding of existing roof ballast prior to commencing this item of work".

Section 075300

1. **Section 2.1 (A), page 075300-3**
 - A. Add "Mule-Hide Products" to the list of acceptable manufacturers for the roofing system.

DRAWINGS

Structural

1. Sheet S-1, notes
 - A. Remove Note Numbers 2 through 5 inclusive. See page number 3 of 4 of attached drawings.

Architectural

1. Sheet D-1, Roof Plan "A", Note #5
 - A. Change Note Number 5 to Note Number 3 as shown on sheet number 1 of 4 of the attached addendum drawings.

2. Sheet D-3
 - A. Add section symbol in detail 8/D3 as shown in on sheet number 2 of 4 of the attached addendum drawings.
 - B. Remove Note Number 15 in its entirety and replace it with the following: "Protect and retain the existing support structure as much as possible and coordinate all new structural components with existing structure. See Structural Sheet S-1.

3. Sheet A-5, Detail 7/A5
 - A. Bottom of counter flashing, at wall of Roof "C", shall be at elevation 113'-0" as shown on sheet number 4 of 4 of the attached addendum drawings.
 - B. Counter flashing, at wall of Roof "C", shall step down at metal exhaust hood at west end of wall. See sheet number 4 of 4 on the attached addendum drawings.

End of Addendum 1

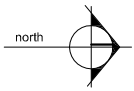
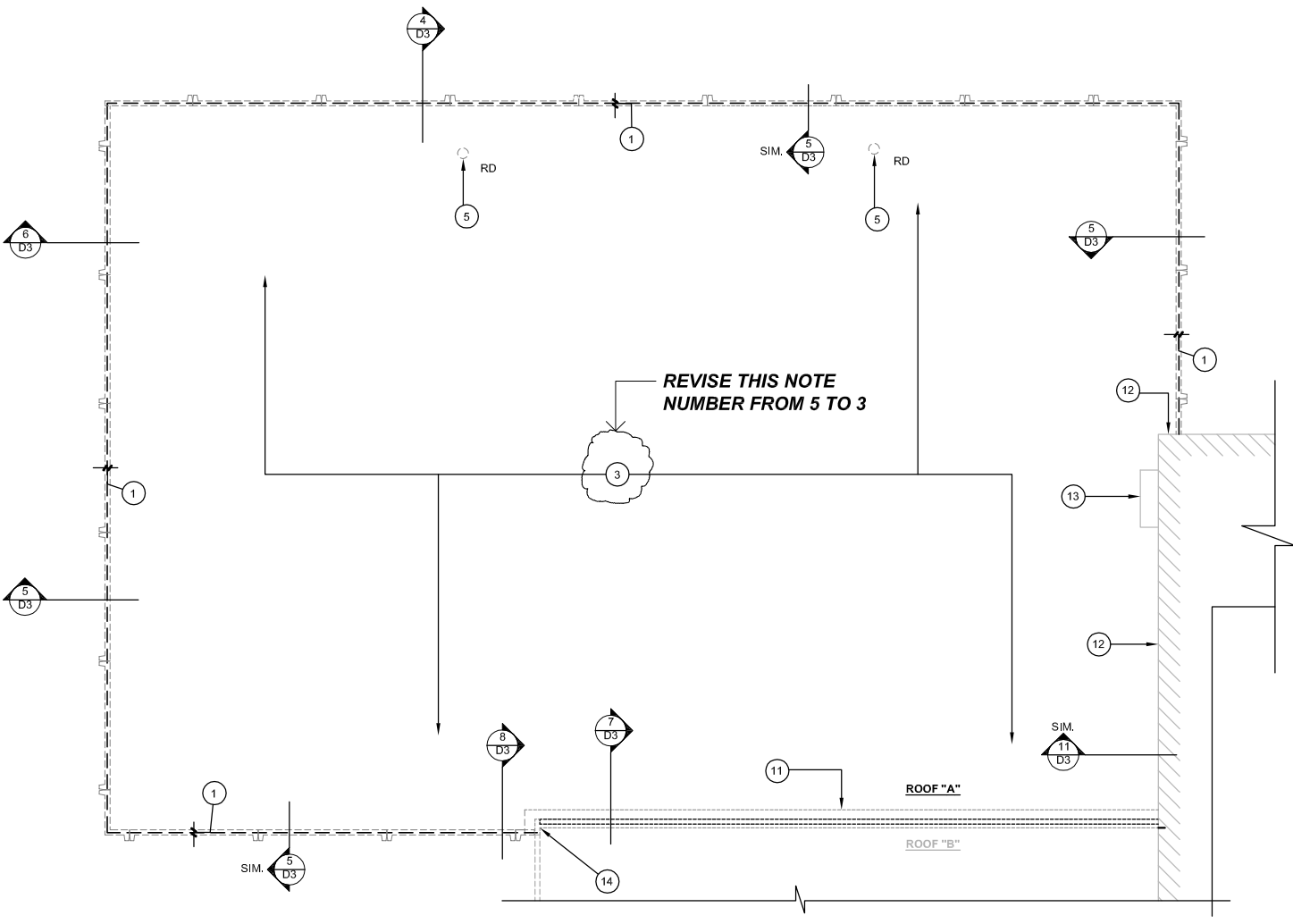

REVISED NOTE NUMBER ON ROOF PLAN 'A'

1/8" = 1' - 0"

****REVISION NOTES IN
BOLD ITALICS



ADDENDUM 1

PROJECT: WAYNE MAINTENANCE FACILITY ROOF REPLACEMENT
 NEBRASKA DEPARTMENT OF ROADS
 PROJECT#: AFE I-302
 BUILDING #: 33702
 DATE: 6 - 2 - 2014

SHEET
D-1
 Number 1 of 4

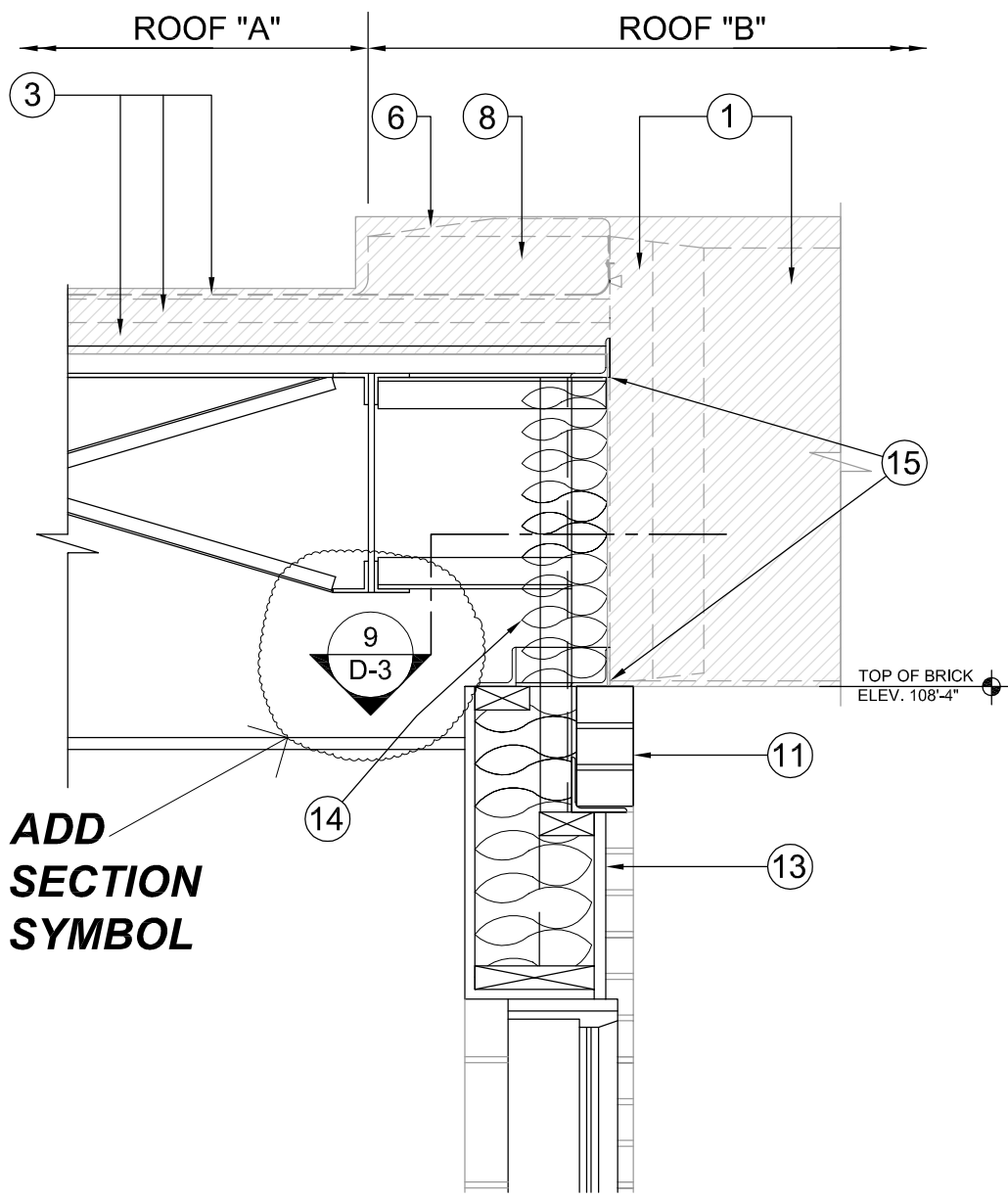

8
D3 ROOF CONSTRUCTION JOINT @ ROOF "A"
1" = 1' - 0"

****REVISION NOTES IN
BOLD ITALICS



ADDENDUM 1

PROJECT: WAYNE MAINTENANCE FACILITY ROOF REPLACEMENT
NEBRASKA DEPARTMENT OF ROADS
PROJECT#: AFE I-302
BUILDING #: 33702
DATE: 6 - 2 - 2014

SHEET
D-3
Number 2 of 4

NOTE:

THE CONDITION OF THE 3" LIGHT WEIGHT CONCRETE ON UPPER ROOF "C" IS UNKNOWN. THE TOPPING MUST BE FULLY ADHERED TO THE TOP OF THE PRECAST TWIN TEES FOR THE NEW ROOF SYSTEM TO MEET THE SPECIFIED STANDARDS AND BE FULLY WARRANTED. TWO TYPES OF WORK ARE BEING CONSIDERED TO ENSURE AN ECONOMICAL / REASONABLE APPROACH TO OBTAIN THE PROPER SUBSTRATE FOR THE NEW ROOF; COMPLETE REMOVAL / REPLACEMENT OF TOPPING, AND SELECTIVE DEMOLITION AND PATCHING OF EXISTING TOPPING. BIDDING FOR THIS PART OF THE WORK IS ESTABLISHED IN NOTE * 1 (UPPER ROOF "C" - BASE BID) AND NOTE *5 (ADJUSTMENT TO UPPER ROOF "C" - BASE BID). THESE LINE ITEMS ARE ON THE PROPOSAL FORM IN THE SPECIFICATION MANUAL.

1. BASE BID: TOTAL REMOVAL OF THE FASCIA, ROOF DRAINS, VENTS, BALLAST, EPDM MEMBRANE, INSULATION AND 3" LIGHT WEIGHT CONCRETE TOPPING DOWN TO THE TOP OF THE PRECAST CONCRETE TEES AND REPLACING THE EXISTING TOPPING WITH A NEW 3/4" CONCRETE TOPPING. THE TOP OF THE PRECAST CONCRETE TEES AND THE TOP OF THE NEW TOPPING SHALL BE PREPARED FOR A FULLY ADHERED INSULATION AND EPDM ROOF MEMBRANE SYSTEM AS SHOWN ON THE DRAWINGS.

2. PRIOR TO THE REMOVAL OF THE 3" CONCRETE TOPPING, THE CONTRACTOR SHALL SOUND TEST THE TOPPING FOR DELAMINATION BETWEEN TOPPING AND THE PRECAST CONCRETE TEES. THE CONTRACTOR SHALL DRAG A LARGE TRUCK CHAIN OVER THE SURFACE OF THE CONCRETE TOPPING IN A ZIG-ZAG FASHION TO HEAR FOR HOLLOW SOUNDS VS. SOLID SOUNDS. HOLLOW SOUNDS ARE INDICATIVE OF DELAMINATION. THIS TEST SHALL COVER 100% OF THE EXISTING UPPER ROOF "C".

3. THE CONTRACTOR SHALL DETERMINE, MARK AND MAP THE GEOMETRIC BOUNDARIES OF ANY VOID POCKETS ENCOUNTERED DURING THIS PROCESS.

4. THE CONTRACTOR SHALL ESTIMATE THE AREA OF EACH VOID AND CALCULATE THE CUMULATIVE TOTAL AREA OF ALL VOIDS IN SQUARE FEET. THE CONTRACTOR SHALL COORDINATE WITH THE ARCHITECT TO DETERMINE THE MOST COST EFFECTIVE APPROACH BETWEEN EITHER SELECTIVE DEMOLITION OR TOTAL DEMOLITION.

5. THE CONTRACTOR SHALL INCLUDE IN THE BID A UNIT PRICE / SQUARE FEET FOR SELECTIVE DEMOLITION/PATCHING AND AN ADJUSTMENT TO THE UPPER ROOF "C" - BASE BID FOR NOT REMOVING THE 3" TOPPING IN ITS ENTIRETY AND REPLACING IT WITH A NEW 3/4" CONCRETE TOPPING.

9

PROJECT NOTES

**REMOVE NOTES 2
THROUGH 5 INCLUSIVE**

*****REVISION NOTES IN
BOLD ITALICS



ADDENDUM 1

PROJECT:
PROJECT#:
BUILDING#:
DATE:

WAYNE MAINTENANCE FACILITY ROOF REPLACEMENT
NEBRASKA DEPARTMENT OF ROADS
AFE I-302
33702
6 - 2 - 2014

SHEET
S-1

Number 3 of 4

B.O. COUNTER FLASHING SHALL BE ELEV. 113'-0"

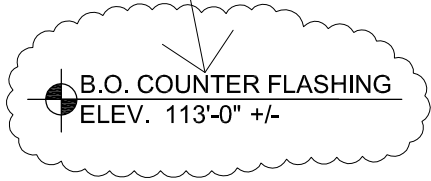

CUT 1 1/2" REGLET INTO BRICK JOINT

SEALANT

PRE-FINISHED 26 GAUGE STEEL COUNTER FLASHING, SPRING LOCKED WITH 4" LAP JOINTS WITH CONT. SEALANT BETWEEN JOINTS.

4"

FASTENER, METAL PLATE AND SEALANT AS RECOMMENDED BY EPDM MANUFACTURER

STEP COUNTER FLASHING AT EXISTING METAL HOOD BEYOND

EPDM MEMBRANE

BONDING ADHESIVE

7
A5 **DETAIL @ LOW TO UPPER ROOF**
3" = 1' - 0"

SEE DET. 1/A4 FOR ROOF ASSEMBLY

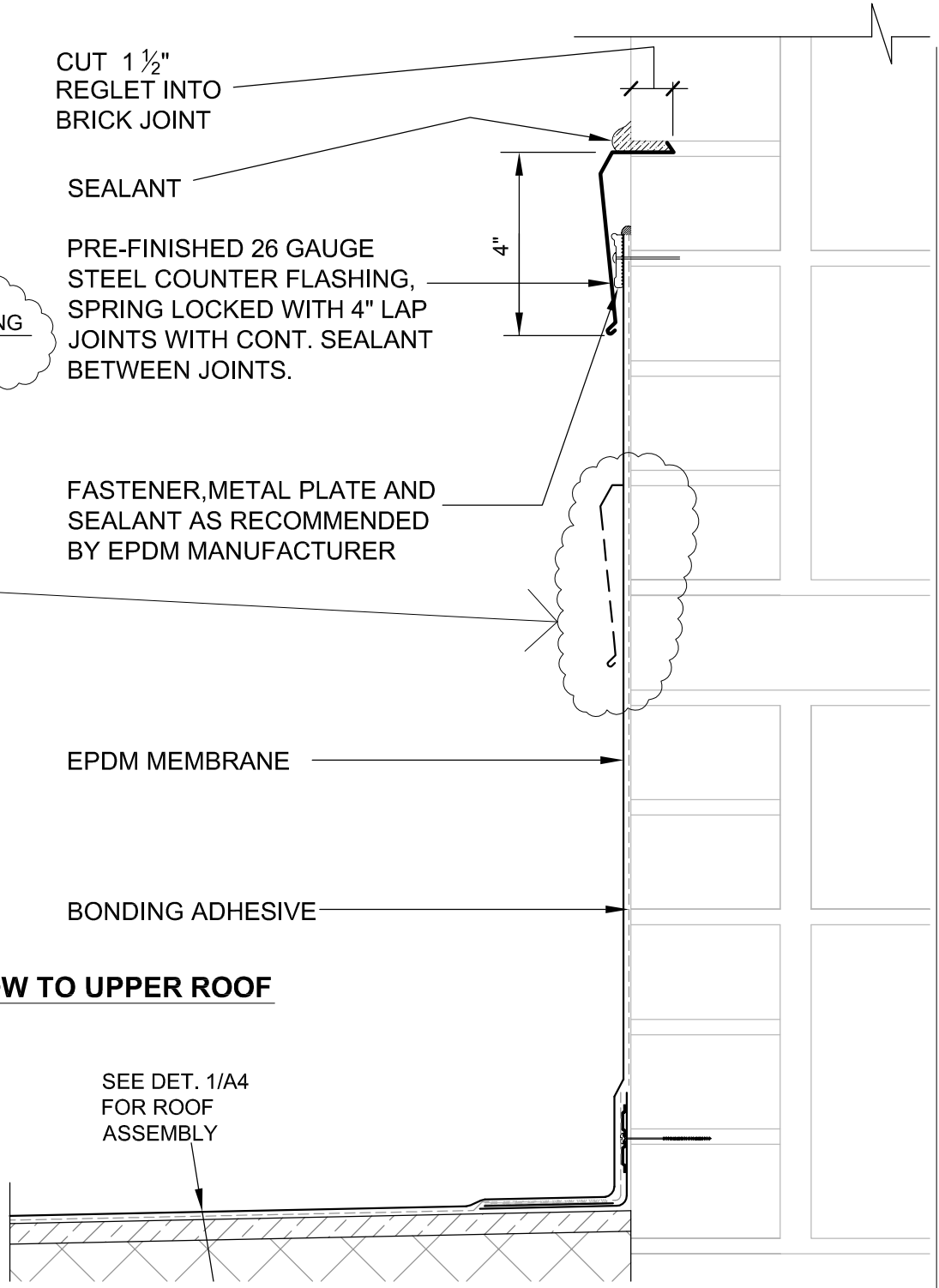

****REVISION NOTES IN **BOLD ITALICS**



APPENDUM 1

PROJECT: WAYNE MAINTENANCE FACILITY ROOF REPLACEMENT
NEBRASKA DEPARTMENT OF ROADS
PROJECT#: AFE I-302
BUILDING #: 33702
DATE: 6 - 2 - 2014

SHEET
A-5
Number 4 of 4