



BIDDERS BULLETIN

PROJECT: Perkins County School Addition
Grant, Nebraska

BULLETIN NUMBER

BB-4

ISSUED BY:

Stephen Granger

PROJECT #: 12-0915

DATE ISSUED: April 14th, 2014

This bulletin is issued by the Architect to all known bidders before receipt of proposals, for the purpose of explaining, interpreting, or modifying the original plans and specifications. When enumerated by the bidder upon the proposal sheet, the information or instructions given hereon will be equally binding upon all parties as if included in the original plans and specifications.
BIDDER MUST ENTER THE NUMBER OF THIS BULLETIN ON HIS PROPOSAL SHEET

Additional Vender Approval

Section 12760 Telescopic Bleachers

Approved Vender; Irwin Telescopic Seating Company

Project Clarification

We pulled the manhole cover off of the sewer line and found that from the school, there is one existing line that feeds into the manhole. The line is approximately located as Sheet C100 indicates.

Coiling Door's; Doors are not required to be fire rated doors due to a complete exhaust system in the kitchen. Doors will however be attached to the alarm system to allow the doors to close during a fire.

THE FOLLOWING ITEMS ARE APPLICABLE TO THE SPECIFICATIONS

BB-4, ITEM #1: Roof Insulation 07222

There will not be Perlite Board to be used as crickets. Utilize the tapered insulation. Provide protection of the existing school roof as required to maintain existing warranty. Provide minimal traffic on existing roof.
Apply non tapered insulation in 2" thickness to provide appropriate staggering of joints.

BB-4, ITEM #2: Telescoping Bleacher 12760

Bleachers are set up as 9 row system on the north side of the gym and a 10 row system on the south side of the gym. South side bleachers are approximately 85'-0" wide, North side bleachers are 92'-0" wide. With the column locations, the top row or rows will be a deck application with the telescopic bleachers folding to the face of the columns.

BB-4, ITEM #3: FRP 09772

Additional Specification Section added to project. Attached at end of BB-4. FRP panel to be installed in Kitchen A110, Dishwashing A107, and Delivery A111. Cooking wall to have 12"x12" wall tile as noted on E-6/A902. All other areas noted to have epoxy paint will remain with epoxy paint. Those areas will be Office A109 and Toilet A108. Provide primer/top coat finish only at outside walls behind walk in cooler and walk in freezer.

BB-4, ITEM #4: Acoustical Ceilings 09510

Ceiling tile clarification; Certaineed School Board Fiber Ceilings in a 2x2 and 2x4 application. Refer to reflected ceiling plans. Kitchen, Delivery, Toilet 108, Office A109 and Dishwashing area to have VinylShield A in a 2x4 application. All other restrooms previously noted for Bioshield will be for Women A118 and Mens A117. Cloud perimeter to be Curved to dimensions indicated on the reflected ceiling plan. Refer to supplier for 16' and 20' radius requirements. Height of edge on clouds to be 2".

BB-4, ITEM #5: Fluid Applied Moisture Barrier

Refer to the attached specifications in reference to fluid applied moisture barrier.

THE FOLLOWING ITEMS ARE APPLICABLE TO THE DRAWINGS

BB-4, ITEM #6: Sheet F102a

Refer to the attached sheet for additional information in regard to the floor layout on the third level.

BB-4, ITEM #7: Sheet A101

Refer to the attached sketch indicating an area of ceiling that will need to be removed and replaced with a fire rated ceiling application Refer to attached drawing.

BB-4, ITEM #8: Sheet A303

Refer to the attached sheet for additional information in regard to the edge of ramp detail for finish applications.

BB-4, ITEM #9: SES Bid Bulletin Items

Mechanical Specification Items: See Attached

Electrical Drawing Items: See Attached

END OF BB-4

Section 09772
Decorative FRP Wall Panels

SECTION 09772–FIBERGLASS REINFORCED WALL PANELS

PART 1 - GENERAL

1.1 SUMMARY

- A. Section Includes: Prefinished polyester glass reinforced plastic sheets and adhered to unfinished gypsum wallboard.
 - 1. PVC trim.
 - 2. Coved Tile Base
- B. Products Not Furnished or Installed under This Section:
 - 1. Gypsum substrate board.
 - 2. Coved Tile Base.

1.2 RELATED SECTIONS

- A. Section 09250 Gypsum substrate board.
- B. Section 09110 Metal Stud Framing

1.3 REFERENCES

- A. American Society for Testing and Materials: Standard Specifications (ASTM)
 - 1. ASTM D 256 - Izod Impact Strengths (ft #/in)
 - 2. ASTM D 570 - Water Absorption (%)
 - 3. ASTM D 638 - Tensile Strengths (psi) & Tensile Modulus (psi)
 - 4. ASTM D 790 - Flexural Strengths (psi) & Flexural Modulus (psi)
 - 5. ASTM D 2583- Barcol Hardness
 - 6. ASTM D 5319 - Standard Specification for Glass-Fiber Reinforced Polyester Wall and Ceiling Panels.
 - 7. ASTM E 84 - Standard Test Method for Surface Burning Characteristics of Building Materials.

1.4 SUBMITTALS

- A. Product Data: Submit sufficient manufacturer's data to indicate compliance with these specifications, including:
 - 1. Preparation instructions and recommendations.
 - 2. Storage and handling requirements and recommendations.
 - 3. Installation methods.

Section 09772

Decorative FRP Wall Panels

- B. Shop Drawings: Submit elevations of each wall showing location of paneling and trim members with respect to all discontinuities in the wall elevation.
- C. Selection Samples: Submit manufacturer's standard color pattern selection samples representing manufacturer's full range of available colors and patterns.
- D. Samples for Verification: Submit appropriate section of panel for each finish selected indicating the color, texture, and pattern required.
 - 1. Submit complete with specified applied finish.
 - 2. For selected patterns show complete pattern repeat.
 - 3. Exposed Molding and Trim: Provide samples of each type, finish, and color.
- E. Manufacturers Material Safety Data Sheets (MSDS) for adhesives, sealants and other pertinent materials prior to their delivery to the site

1.5 QUALITY ASSURANCE

- A. Conform to building code requirements for interior finish for smoke and flame spread requirements as tested in accordance with:
 - 1. ASTM E 84 (Method of test for surface burning characteristics of building Materials)
 - a. Wall Required Rating – Class A
- B. Sanitary Standards: System components and finishes to comply with:
 - 1. United States Department of Agriculture (USDA) requirements for food preparation facilities, incidental contact.
 - 2. Food and Drug Administration (FDA) 1999 Food Code 6-101.11.
 - 3. Canadian Food Inspection Agency (CFIA) requirements.

1.6 DELIVERY, STORAGE AND HANDLING

- A. Deliver materials factory packaged on strong pallets.
- B. Store panels and trim lying flat, under cover and protected from the elements. Allow panels to acclimate to room temperature (70°) for 48 hours prior to installation.

1.7 PROJECT CONDITIONS

- A. Environmental Limitations: Building are to be fully enclosed prior to installation with sufficient heat (70°) and ventilation consistent with good working conditions for finish work
- B. During installation and for not less than 48 hours before, maintain an ambient temperature and relative humidity within limits required by type of adhesive used and recommendation of adhesive manufacturer.
 - 1. Provide ventilation to disperse fumes during application of adhesive as recommended by the adhesive manufacturer.

Section 09772
Decorative FRP Wall Panels

1.8 WARRANTY

- A. Furnish one year guarantee against defects in material and workmanship.

PART 2 - PRODUCTS

2.1 ACCEPTABLE MANUFACTURER

- A. Marlite; 202 Harger Street, Dover, OH 44622. 800-377-1221 FAX (330) 343-4668 Email: info@marlite.com www.marlite.com.

Kemlite; P.O. Box 2429, Joliet, IL 60434. 800-435-0080, FAX 815-467-8666
Email:www.glasbord.com

- B. Product:
1. Standard FRP

2.2 PANELS

- A. Fiberglass reinforced thermosetting polyester resin panel sheets complying with ASTM D 5319.
1. Coating: Multi-layer print, primer and finish coats or applied over-layer.
 2. Dimensions:
 - a. Thickness – 0.090 “ (2.29mm) nominal
 - b. Width - 4'-0” (1.22m) nominal
 - c. Length –10'-0” nominal
 3. Tolerance:
 - a. Length and Width: +/-1/8 “ (3.175mm)
 - b. Square - Not to exceed 1/8 “ for 8 foot (2.4m) panels or 5/32 “ (3.96mm) for 10 foot (2.4m) panels
- B. Properties: Resistant to rot, corrosion, staining, denting, peeling, and splintering.
1. Flexural Strength - 1.0×10^4 psi per ASTM D 790. (7.0 kilogram-force/square millimeter)
 2. Flexural Modulus - 3.1×10^5 psi per ASTM D 790. (217.9 kilogram-force/square millimeter)
 3. Tensile Strength - 7.0×10^3 psi per ASTM D 638. (4.9 kilogram-force/square millimeter)
 4. Tensile Modulus - 1.6×10^5 psi per ASTM D 638. (112.5 kilogram-force/square millimeter)
 5. Water Absorption - 0.72% per ASTM D 570.
 6. Barcol Hardness (scratch resistance) of 35 55 as per ASTM D 2583.
 7. Izod Impact Strength of 72 ft. lbs./in ASTM D 256
- C. Back Surface: Smooth. Imperfections which do not affect functional properties are not cause for rejection.
- D. Front Finish: Standard FRP Pebbled
- a. Color:
 - 1) Marlite Standard FRP is available in a variety of colors, including;

Section 09772
Decorative FRP Wall Panels

a) P-100 White

- b. Surface Pebbled
- c. Fire Rating Class A
- d. Size: [Specifier to choose, or as indicated on drawings.] standard sizes are;

1) FRP

a) 48" x 120" [1.2m x 3m] x .090" (3mm) nom.

2.3 BASE

- a. By Others; 4" coved tile

2.4 MOLDINGS

- A. SaniSeal Trim: Co-extruded, dual-durometer polypropylene/monprene profiles with Dual-Seal Technology and high-performance pressure sensitive adhesive.
 - 1. S650 Inside Corner, 10' length
 - 2. S660 Outside Corner, 10' length
 - 3. S665 Division, 8' length
 - 4. S670 Edge, 10' length
 - 5. Color: White

2.5 ACCESSORIES

- A. Adhesive: Either of the following construction adhesives complying with ASTM C 557.
 - 1. Marlite C-551 FRP Adhesive - Water- resistant, non-flammable adhesive.
- B. Sealant:
 - 1. Marlite Brand MS-250 Clear Silicone Sealant.

PART 3 - EXECUTION

3.1 PREPARATION

- A. Examine backup surfaces to determine that corners are plumb and straight, surfaces are smooth, uniform, clean and free from foreign matter, nails countersunk, joints and cracks filled flush and smooth with the adjoining surface.
 - 1. Verify that stud spacing does not exceed 24" (61cm) on-center.
- B. Repair defects prior to installation.
 - 1. Level wall surfaces to panel manufacturer's requirements. Remove protrusions and fill indentations.

Section 09772

Decorative FRP Wall Panels

3.2 INSTALLATION

- A. Comply with manufacturer's recommended procedures and installation sequence.
- B. Cut sheets to meet supports allowing 1/8" (3 mm) clearance for every 8 foot (2.4m) of panel.
- C. Apply panels to board substrate, above base, vertically oriented with seams plumb and pattern aligned with adjoining panels.
 - 1. Install panels with manufacturer's recommended gap for panel field and corner joints.
 - a. Adhesive trowel and application method to conform to adhesive manufacturer's recommendations.
 - b. Drive fasteners for snug fit. Do not over-tighten.
- D. Apply panel moldings to all panel edges using silicone sealant providing for required clearances.
 - 1. All moldings must provide for a minimum 1/8 " (3mm) of panel expansion at joints and edges, to insure proper installation.
 - 2. Apply sealant to all moldings, channels and joints between the system and different materials to assure watertight installation.

3.3 CLEANING

- A. Remove excess sealant from panels and moldings. Wipe panel down using a damp cloth and mild soap solution or cleaner.
- B. Refer to manufacturer's specific cleaning recommendations Do not use abrasive cleaners.

END OF SECTION 09 7720

PROSOCO R-GUARD® VB Fluid-Applied Membrane Air & Water-Resistive Barrier

Mock-Ups:

Apply fluid applied air barrier system to field-constructed mock-up assemblies illustrating material interfaces and seals. Use the manufacturer's application instructions. Keep mock-ups available for inspection throughout the project.

Manufacturer:

PROSOCO, Inc., 3741 Greenway Circle, Lawrence, KS 66046. Phone: (800) 255-4255; Fax: (785) 830-9797. E-mail: CustomerCare@prosoco.com

Other Manufacturers to be accepted as long as they meet these specifications

Product Description

PROSOCO R-GUARD® VB is a fluid-applied air and water-resistive barrier that stops air and water leakage in cavity wall, masonry veneer construction, as well as in stucco, EIFS and most other building wall assemblies. The easily applied liquid quickly dries into a rubberized, highly-durable, water-resistant membrane. R-GUARD VB performs the function of both a vapor barrier and an air/water resistive barrier and is ideal for special construction types that require protection from the passage of air, liquid water and water vapor. R-GUARD VB reduces heating and cooling costs and lowers the risk of mold and mildew.

TYPICAL TECHNICAL DATA

FORM: pastel green viscous liquid, mild odor

SPECIFIC GRAVITY: 1.34

pH: 7.5 to 10.0

WEIGHT/GALLON: 11.12 pounds per gallon

ACTIVE CONTENT: no data

TOTAL SOLIDS: 62.5 percent ASTM D2369

VOC CONTENT: 45 grams per Liter. Complies with all known national, state and district AIM VOC regulations.

FLASH POINT: not applicable

FREEZE POINT: 32 degrees Fahrenheit (0 degrees Celsius)

SHELF LIFE: 1 year in tightly sealed, unopened container

Limitations

- Do not apply when surface or air temperatures are below 40 degrees Fahrenheit (4 degrees Celsius) or above 110 degrees Fahrenheit (43 degrees Celsius).
- Not for use below-grade or in locations designed to be continuously immersed in water.

SPECIFIER NOTE: Prepare all joints, seams cracks, fastener penetrations and rough openings prior to application of the primary air barrier. See PROSOCO R-GUARD® VB Data Sheet for more information. See appropriate product data sheets and R-GUARD Installation Guidelines for more information.

Installation

Before applying, read "Preparation" and "Safety Information" sections in the Manufacturer's Product Data Sheet for PROSOCO R-GUARD® VB. Refer to the Product Data Sheet for additional information about application.

Do not dilute or alter R-GUARD VB, except for use in sprayers. The product may be thinned with up to 5 percent fresh water, based on surface, drying conditions and equipment. Mix well before use with a low-speed drill and clean mixing paddle. Avoid mixing air into the membrane.

Application Instructions

1. Apply one coat at uniform thickness of 15 wet mils to gypsum, plywood and OSB sheathing. Allow to dry.
2. Apply second coat to uniform thickness of 15 wet mils. When spray applying, back roll as needed to ensure there are no pinholes, voids or gaps in the membrane. For CMU applications, take special care to achieve full coverage around wall ties or surface irregularities.
3. Inspect membrane before covering. Repair any punctures or damaged areas by applying additional R-GUARD VB. Overlap repairs, penetration treatments, transitions, rigid flashing and other air barrier components to ensure positive drainage and continuity of the air and water-resistive barrier.

Curing and Drying

Complete drying times vary with temperature, humidity and surface conditions. Protect from rain or freezing until completely dry. At 70 degrees Fahrenheit (21 degrees Celsius) and 50 percent relative humidity, R-GUARD VB dries to touch and can be over coated in 2 to 4 hours.

Coverage

Coverage rates vary depending on surface porosity, moisture uptake and other factors. Unless otherwise required by the referenced test method, product performance test results are were achieved when the product was applied at two coats of 15 wet mils to DensGlass[®] gold fiberglass mat gypsum sheathing. Many gypsum sheathing products require additional material to achieve hide and the desired mil thickness for a pinhole free coating. Actual rates must be determined through mock-up applications.

- External Gypsum Board / Plywood: 40 to 50 square feet per gallon per coat
- OSB / CMU: 30 to 50 square feet per gallon per coat

Cleanup

Clean tools and equipment with water immediately after use. Dried material must be removed mechanically.



AREA OF WORK

TITLE

FLOOR PLAN
BB-4

PROJECT

Perkins County Schools

Date: 4-14-14

Drawing: EXISTING LINK
From Sheet:

CG-Architects
319 East Francis Street
North Platte, NE 69101

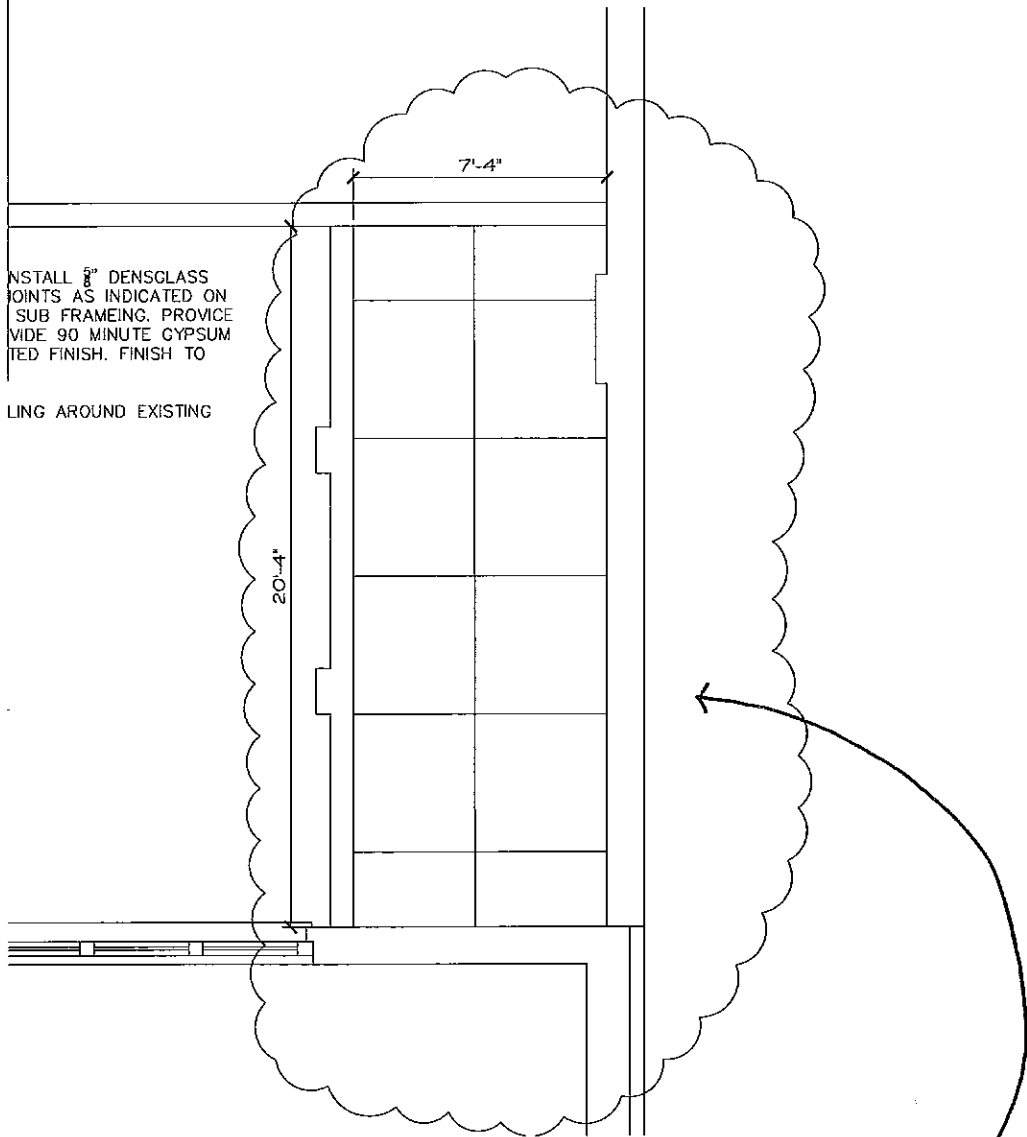
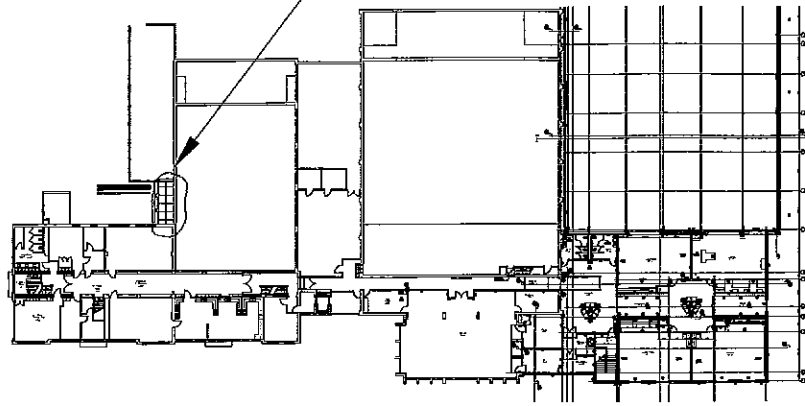

INSTALL 5/8" DENSGLASS
JOINTS AS INDICATED ON
SUB FRAMEING. PROVIDE
1/2" WIDE 90 MINUTE GYPSUM
SETTING COMPOUND. FINISH TO

INSTALL NEW CEILING
FINISH AROUND EXISTING

REMOVE EXISTING PLYWOOD CEILING IN THIS EXTERIOR APPLICATION AND INSTALL 5/8" DENSGLASS
FIREGAURD SHEATHING TO EXISTING SUBSTRUCTURE. PROVIDE CONTROLS JOINTS AS INDICATED ON
THE PLAN. FIELD VERIFY EXACT JOINT LOCATION BASED ON THE EXISTING SUB FRAMEING. PROVIDE
A CAULK EDGE AT PERIMETER LOCATION OF DENSGLASS. AT JOINTS, PROVIDE 90 MINUTE GYPSUM
SETTING COMPOUND. FINISH TO BE A SMOOTH TOP COAT AND AND PAINTED FINISH. FINISH TO
BE WHITE.

EXISTING LIGHT FIXTURES CONNECTIONS TO REMAIN AND INSTALL NEW CEILING AROUND EXISTING
FIXTURES. EXISTING FIXTURES TO REMAIN.

TITLE
RAMP DETAIL
BB-4

PROJECT
Perkins County Schools

Date: 4-14-14
Drawing: DETAIL
From Sheet: A303

CG-Architects
319 East Francis Street
North Platte, NE 69101

COMMONS
A207

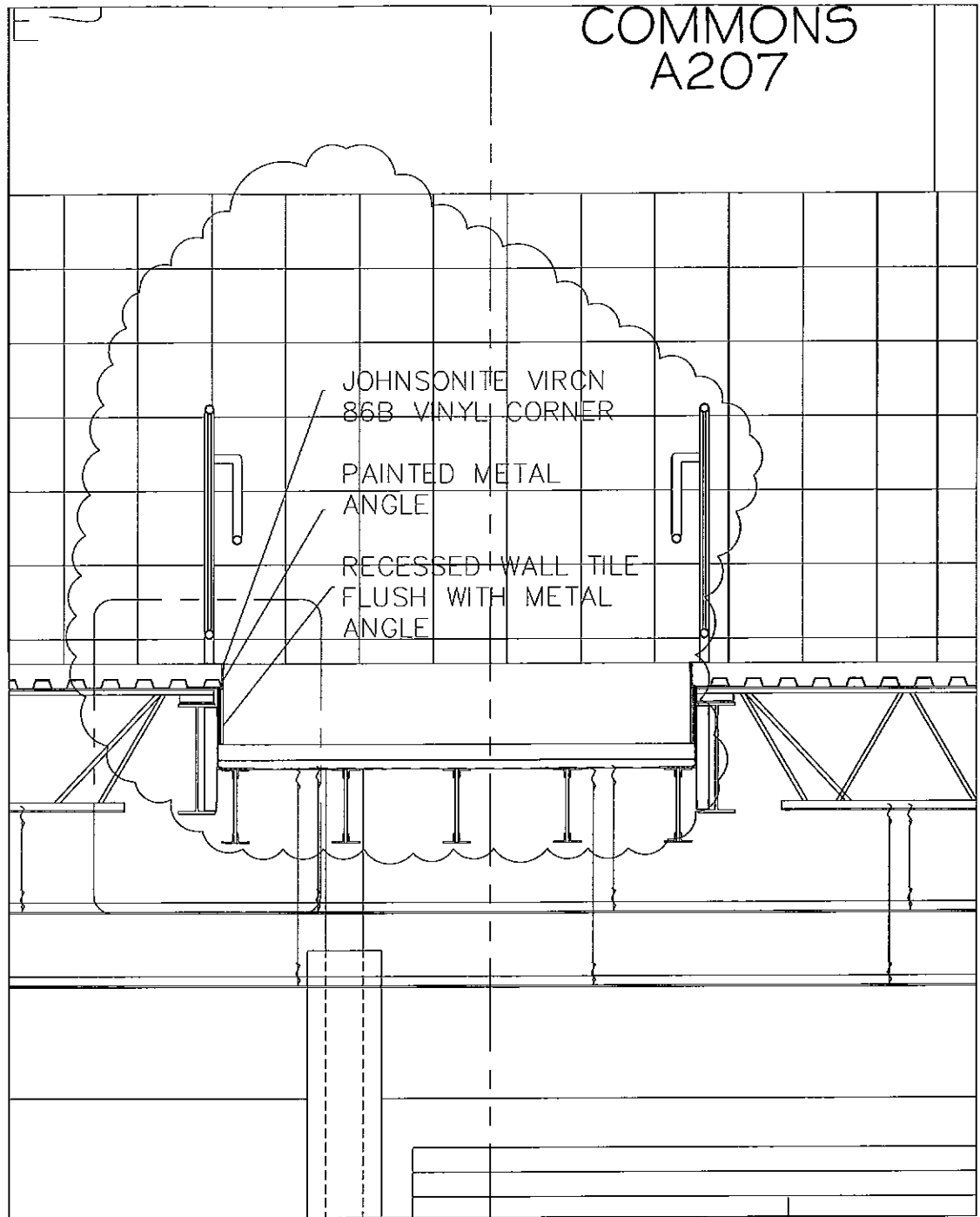



Third Level

SCALE: 1/8" = 1'-0"

REVISION NUMBER
 SHEET NUMBER
F102A

DATE
 MARCH 5th, 2014

CHECKED BY
 bjd/spg

DRAWN BY
 bjd/spg

PROJECT NUMBER
 12-0915

TITLE
Third Level Existing Floor Plan

PROJECT
 2014 High School Renovation & Addition
 740 SHERMAN AVENUE
 GRANT, NE 69140

CG ARCHITECTS
 319 East Francis, Suite 101
 NORTH PLATTE, NE.
 69101
 PHONE: 308.532.0411
 FAX: 308.532.1202

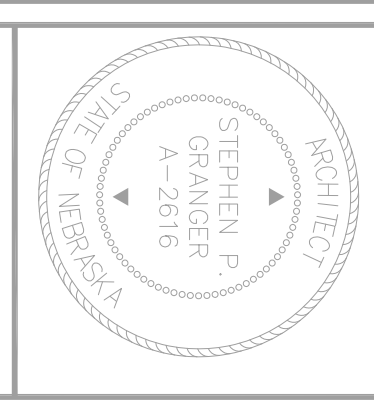

NO.	DATE	REVISIONS

Bid Bulletin 4



Date: 04/14/2014

Project Name: 2014 High School Renovation & Addition

Project #: 12103

Mechanical Drawing Items:

MD1. Drawing Sheet F101- Basement and First Floor Fire Protection Plans:

- A. Sheet Notes #5 and 10, include the following "Include standpipes equipped with 1-1/2 inch hose lines at each side of the stage, according to NFPA 101-15.3.2.3."

Mechanical Specification Items:

MS1. Subject to compliance with requirements, the following are to be included as approved manufacturers for the respective equipment:

- A. Metal Ducts: S.E.T. Duct
- B. Fans: CaptiveAire

Electrical Drawing Items:

E500 Lighting Fixture Schedule – Prudential Lighting P9030LED40LO-FWA-TMW-SC-277-X1-DM10 is an approved alternate for luminaire N.

Submitted By: Jeremy Klima, Ben Schmitt