



ADDENDUM

PROJECT: Majestic Theatre Rehabilitation **PROJECT NO.** L13452
FROM: BVH Architects **DATE:** 3-28-2014
TO: All Perspective Bidders **ADDENDUM NO. 1**

This Addendum is issued by the Architect to all bidders of record prior to receipt of proposals. Bidders shall acknowledge receipt of this addendum by so indicating on the Proposal Form. Failure to do so may subject Bidder to disqualification.

All information and instructions given herein shall become a part of the Contract Documents.

GENERAL

A Pre-Bid conference was held on site March 20th at 9:00am. The Agenda is attached for reference. Questions and Observations answered include:

1. The project site is available for viewing by contacting and arranging a meeting with the Owner's Project Manager, Bo Berry, at 308-324-4681.
2. The project Owner is Lexington Public Schools and therefore sales tax exempt.
3. Any remaining asbestos glue at the Auditorium North and South walls shall be encapsulated with stud furring walls. The Owner's Asbestos Report is available by request.
4. The Contractor is required to provide all required Insurance and Performance Bonding per the Specification Division 0 Bidding and Contract Requirements.
5. An Electronic Document Submittal Service (EDSS) is to be utilized and paid by the Contractor. Additional service providers may be utilized with architect approval prior to bidding. See service provider requirements in Section 013000 Administrative Requirements

PROJECT MANUAL

1. Section 072100 Thermal Insulation
 - a. Products Part 2
 1. As the Contractor's option, Extruded Polystyrene (XPS) meeting or exceeding the performance characteristics of the specified Extruded Polystyrene (EPS) may be used at foundation and underslab locations.
2. Section 126100 Fixed Audience Seating
 - a. Products Part 2 Additional Manufacturers
 1. Add Seating Concepts LLC; BG-800 Designer Series
 2. Add Camatic Activa Series
3. Add Section 274116 Integrated Audio and Video Systems

DRAWINGS

1. Index of Drawing on Sheet G1
 - a. Add AV Drawings AV1 and AV2
2. Materials List on Sheet A2
 - a. CT-1, CTB-1, CTT-1 to be matte finish.
 - b. Revise CTT-1 size to 13" x 24"
3. First Floor Plan A10 on Sheet A2
 - a. Add additional wheelchair space per the attached drawing.
 1. 177 total fixed auditorium seating counts are as follows:
(38) 24" wide seats at Center bank
(65) 22" wide seats at Center bank

ADDENDUM

- (37) 22" wide seats at North bank
- (37) 22" wide seats at South bank

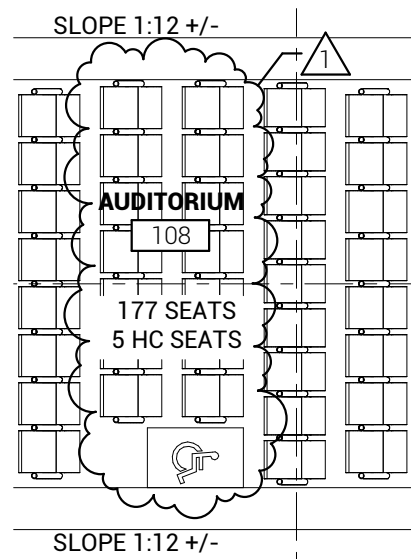

A10/A2 FIRST FLOOR PLAN

1/8" = 1'-0"

- Auditorium East Elevation on Sheet A7
 - Add projection screen portal window below center window opening per AV drawings.
- Mechanical and Electrical Addendum #1 attached.
- Add attached Audio Visual Drawings and Specifications.

END OF ADDENDUM



MAJESTIC THEATRE MEETING AGENDA

BVH PROJECT: #L13452

DATE: March 20, 2014

- 1. Project Background**
- 2. Bid Schedule and Procedures**
 - a. April 4 @ 4pm: Last Day for Addenda**
 - b. April 10 @ 2pm: Bid Date**
 - c. Stipulated Sum Contract w/ Public Bid Opening**
- 3. Alternates**
 - a. Re-Roof**
- 4. Special Issues / Working Conditions**
 - a. LPS Involvement**
 - b. Davis-Bacon Wages**
- 5. Post-Bid Schedule**
 - a. Notice to Proceed**
 - b. 8/15 Owner Performed Items**
 - c. 12/15 Owner Occupancy**
- 6. Questions and Observations**



DATE ISSUED March 27th, 2014

ADDENDUM # 1

ENGINEER Engineering Technologies, Inc.
825 M Street, Suite 200
Lincoln, NE 68508

PROJECT Majestic Theater – Lexington, NE

ETI PROJECT # 2013-168

The Architect issues this Addendum to all known bidders before receipt of proposals. Bidder shall acknowledge the receipt of this addendum on their proposal sheet and all information contained herein shall become a part of the contract documents.

ADDENDUM:

PRIOR APPROVAL – MECHANICAL

- 1. The following manufacturers have received prior approval for bidding purposes subject to shop drawing review:
 - A. List Equipment Here
 - Exhaust Fans
 - Intake/Exhaust Hoods
 - Registers, Grilles & Diffusers
 - Spiral Ductwork
 - Volume Dampers
 - List Manufacturer Here
 - ACME, Loren Cook, Twin City Fan Co.
 - ACME, Loren Cook, Twin City Fan Co.
 - Krueger, Price Industries
 - Norlock, Spiral Pipe of Texas
 - Air Balance Inc.

PRIOR APPROVAL – ELECTRICAL

- 1. The following manufacturers have received prior approval for bidding purposes subject to shop drawing review:
 - A. List Equipment Here
 - Light Fixture Type #1
 - Light Fixture Type #3
 - Light Fixture Type #4
 - Light Fixture Type #5
 - Light Fixture Type #17
 - Light Fixture Type #19
 - Light Fixture Type #22
 - Light Fixture Type #24
 - Light Fixture Type #25
 - Light Fixture Type #26
 - List Manufacturer Here
 - Scott Lighting
 - Celestial Lighting
 - McGraw Edison
 - Celestial Lighting
 - IO Lighting
 - Invue Lighting
 - Tech Lighting
 - Shaper
 - Metalux
 - Metalux

END OF ADDENDUM

SECTION 274116

INTEGRATED AUDIO AND VIDEO SYSTEMS

PART 1 GENERAL

1.01 DEFINITION OF TERMS

- A. The term "Architect" shall refer to Bahr, Vermeer, Haecker Architects, 440 South 8th, #100, Lincoln, NE 68508.
- B. The term "Consultant" shall refer to Diversified Design Group, Inc. 1344 South 7th Street, Lincoln NE 68502.
- C. The term "AV Contractor" shall refer to the person(s) or company, which contracts for the installation of the AV systems described in these specifications.

1.02 SCOPE OF WORK

- A. Items called out in this section include the majority of all items required to provide complete and fully functional AV systems. It shall be the responsibility of the AV Contractor to understand the intent of the designs and to provide fully operational AV systems meeting the design specifications.
- B. The drawings and specifications are both inclusive to this project, and are intended to function together. Items called out on either, but not both, shall be considered binding as to the scope of work performed.
- C. AV systems installation shall be based on equipment and details as designed. Questions and/or clarifications are encouraged and shall be presented in writing at least ten (10) days prior to the bid deadline to allow for adequate response time. Questions submitted after that time may not be answered.
- D. Any deviation from these performance specifications shall be remedied by the AV Contractor. Remedial action shall be applied as required by the Consultant and may include redesign, replacement of all or part of system, all at the AV Contractor's expense.
- E. The AV Contractor shall provide all AV system panels, plates, cables and connectors as called out in the bid specifications and drawings.
- F. AV contractor shall coordinate with owners theater content provider on installation of NAS and remote services.

1.03 WORK BY OTHERS

- A. The AV systems installation does not include conduit, raceways, outlet boxes, junction boxes, or 120-volt AC power circuits, which shall be furnished and installed by the project Electrical Contractor.
- B. The Electrical Contractor shall be responsible for providing and installing all required conduits, raceways, AC power circuits, and junction boxes as called out or implied in these drawings and/or specifications.
- C. The Electrical Contractor shall install and connect the AC power to all projection screens requiring power for operation. This work shall be coordinated with the AV Contractor.
- D. The General Contractor shall be responsible for installing the AV Contractor provided projection screens in the locations shown on drawings. The General Contractor shall coordinate this work with the Electrical Contractor and AV Contractor.

1.04 QUALITY ASSURANCE

- A. It is a requirement that the AV Contractor must have been involved in the execution of professional AV systems installations of this type for a period of ten (10) years or more, and shall have completed at least five (5) system installations of this type.
- B. Bidders for this section are expected to be an authorized dealer for all major pieces of equipment or purchasing them through an authorized dealer or distributor. Documentation of dealer status may be requested from bidders. Failure to provide adequate documentation may be grounds for disqualification.
- C. The AV Contractor shall maintain a minimum certification for staff members with an acceptable industry certification program. Failure to provide proper qualifications shall be grounds for disqualification.
 - 1. The project manager, master/lead technician and technicians working on this project shall have a minimum certification of NICET Audio Systems Level II, EST R-ESI, or CTS-I.
- D. The AV Contractor must maintain a fully equipped and staffed organization capable of performing the installation and maintenance for systems of this type.
- E. If so deemed the AV Contractor shall demonstrate to the satisfaction of the Owner, Architect and Consultant that the AV Contractor meets the requirements described above.

1.05 STANDARDS

- A. All equipment and installation practices, where applicable standards have been established, shall be built and installed to the standards of the following institutions:
 - 1. NFPA 70, National Electric Code (NEC) (2008 Edition).
 - 2. EIA Compliance: Comply with following Electronics Industries Standards.
 - a. Sound Systems, EIA-160.
 - b. Loudspeakers, Dynamic Magnetic Structures and Impedance, EIA-299-A.
 - c. Racks, Panels and associated equipment, EIA-310-A.
 - d. Amplifiers for Sound Equipment, SE-101-A.
 - e. Speakers for Sound Equipment, SE-103.
 - 3. TIA/EIA-607 Telecommunications Grounding
 - 4. BICSI Telecommunications Distribution Methods Manual (Eleventh Edition)
 - 5. Federal Communications Commission Part 15
 - 6. Audio Engineering Society (AES)

1.06 SUBMITTALS

- A. Submittals are required for approval of all specified equipment. All submittals shall be approved by the Architect and Consultant prior to the purchase of equipment or the beginning of installation. These submittals shall be provided not more than thirty (30) days following award of contract. Upon award of contract the Construction Manager may request a different timetable for submittals.
 - 1. The AV Contractor shall furnish (6) sets of Product Submittal Sheets for all equipment to be installed, including anticipated incidental products or materials. Submittal Sheet sets shall be bound on the left side and printed on A-size (8.5"x11") paper. PDF format is acceptable in lieu of hard paper copies. The following shall be included:
 - a. Complete Bill of Materials with quantities, makes, models, and options listed.
 - b. Product specification cut sheets.
 - a) Cut sheets listing multiple models/versions of a product or product options shall have the applicable model, version, and/or options delineated by a suitable notation, such as highlighting or circling in colored ink.
 - 2. The AV Contractor shall furnish (6) sets of Shop Drawings detailing a complete installation plan. The AV Contractor shall convey that the systems are ready to install as shown in the Shop Drawings, and that details not explicitly defined by this specification or on the project drawings have been addressed by the AV Contractor. Shop Drawings

shall be bound on the left side and printed on a minimum of 30"x42" paper and include the proper architectural backgrounds. PDF format is acceptable in lieu of hard paper copies. The following shall be included:

- a. Show all interconnections of submitted components and cables, complete with cable numbers that shall correspond to the installed cable markings
 - b. Proposed rack layouts based on submitted equipment
 - c. Riser diagrams and schematics for individual subsystems
 - d. Calculations
 - a) Nominal impedances on direct-driven loudspeaker lines
 - b) Nominal load on 70V loudspeaker lines
 - c) Path-specific net gain/attenuation for RF systems including cable attenuation losses, amplifier gain, and antenna gain from antenna(s) to receiver(s) or transmitter(s). This calculation shall be done at the highest frequency in the applicable frequency band. Explain reasoning if approximations are necessary.
 - e. Scaled construction drawings of custom plates and panels from the manufacturer. Connectors shall be identified per type with exact part number designations. Identify all dimensions and finishes.
 - f. Drawings for the proposed rigging and placement of the loudspeakers, showing plan views, section views, locations of support steel and bracing, attachment methods, dimensions, weight and load conditions at each point of attachment to structure, and coordination with architectural items (ceilings, acoustic reflectors, lighting, equipment, etc.).
 - g. Locations of rough-ins, conduit, sleeves, and/or raceways required of the Electrical Contractor in addition to those shown on the project drawings
3. If any part of the Submittals are not furnished complete as outlined herein, the Submittals may be rejected by the Consultant and/or Architect, and the AV Contractor shall be required to resubmit a complete set. The Architect and/or Consultant shall not be responsible for delays in the project timeline as a result of incomplete Submittals.

1.07 SYSTEMS WARRANTY AND SERVICE

- A. The AV Contractor shall warranty the systems and/or all equipment under this contract, against defects in material and workmanship for a period of one (1) year from date of acceptance or first beneficial use, whichever occurs first, at no cost to the Owner.
- B. The AV Contractor shall provide adjustments to programming and general adjustments to all audio, video and control system components to maximize system performance for a period of one (1) year from date of acceptance or first beneficial use, whichever occurs first, at no cost to the Owner. This includes, but is not limited to, digital signal processors, digital line arrays, digital video scalars, video projectors, wireless microphone systems, touch panels and control systems.
- C. The AV Contractor shall make at least two (2) visits to the job site to perform any required maintenance services and to determine that all equipment is functioning properly. The first shall be six (6) months after the beginning of the warranty period and the second visit shall occur just prior to the end of the warranty period.
- D. Maintenance services shall consist of, but not be limited to, operational tests and checks of all equipment provided under this contract.
- E. Defective equipment discovered during a maintenance visit shall be repaired or replaced under the terms of the warranty.
- F. The AV Contractor shall not be liable for any equipment damaged by improper use or accidental acts of nature or equipment supplied by the Owner.
- G. The AV Contractor shall provide a maximum 24-hour response time for all service calls during the warranty period.

PART 2 PRODUCTS

2.01 MANUFACTURERS

- A. The base bid shall be based on the specified equipment or approved equivalent equipment.
- B. All approved equivalent equipment must meet or exceed the specified equipment in every aspect of performance, form, and function.
- C. Additionally, any substitutions of loudspeakers, whether submitted as approved equivalent or as a voluntary alternate, must be accompanied by an EASE data and rendering proving intelligibility and loudspeaker coverage throughout the intended listening area. Coordinate submittal with Consultant; submittal is required for approval.

2.02 SUBSTITUTION

- A. Where it is permitted in these specifications to substitute for a designated brand of equipment, it is understood that in such case the written approval of the Consultant must be obtained.
- B. If a specific piece of equipment has been discontinued or replaced by a new model, the AV Contractor shall submit the proposed replacement model number and type to the Consultant for approval prior to its inclusion in the installation.
- C. Any use of substitute equipment shall be at no extra cost to the Owner.
- D. Requests for equipment to be considered as approved equivalent shall be considered only when the following have been submitted to the Consultant:
 - 1. A list of such alternate equipment and materials for consideration as equal.
 - 2. Four (4) copies of working shop drawings.
 - 3. EASE speaker data (if applicable) as noted above.
 - 4. A demo piece of the proposed equipment to be substituted may, at the discretion of the Consultant, be requested for testing and review. If such a request is made by the Consultant, the AV Contractor shall provide a demo piece (or pieces if applicable) of the proposed equipment or arrange a demonstration of the proposed equipment in a similar environment.
- E. If a request for approved equivalent equipment is refused, the AV Contractor shall provide the specified equipment.

2.03 AV SYSTEM COMPONENTS

- A. The following approved manufacturers, quantities, and model numbers shall form the basis of the system. These are minimum requirements. The AV Contractor shall verify all quantities prior to ordering and installation. Quantities are provided for reference only. The AV Contractor is still responsible to provide a complete and working system without claim for additional payment. All equivalents and alternates must be approved by the Consultant prior to system installation.
- B. The AV Contractor shall furnish all equipment and work as noted or implied on the drawings or specifications. In case of a conflict between the drawings and specification, furnish the equipment and work with the greatest cost impact.
- C. **AUDIO SIGNAL PROCESSING**
 - 1. Digital cinema processor with AES input, hearing impaired output and Dolby audio processing.
 - a. One (1) Dolby CP750 or approved equal.
- D. **AMPLIFIERS**
 - 1. Power amplifier with 2 channels rated at 375 watts into 8 ohms, both channels driven.
 - a. Five (5) Crown XLS2000 amplifiers or approved equal.
- E. **LOUDSPEAKERS AND LOUDSPEAKER ACCESSORIES**

1. Two-way loudspeaker system with horn loaded HF. Speakers are two (2) 15-inch LF and 1-inch exit HF driver mounted on 90X-30/+20 degree ScreenArray complex horn.
 - a. Three (3) JBL 3722N loudspeaker or approved equal.
 - b. Three (3) speaker dollies with lockable casters.
 2. Cinema surround loudspeaker with one (1) 8-inch low frequency driver and one (1) one-inch high frequency driver mounted to a 100X90 degree constant coverage horn and a twenty degree downward loudspeaker firing angle.
 - a. Eight (8) JBL 8320 loudspeakers or approved equal.
 3. Subwoofer loudspeaker enclosure with one (1) front loaded 18-inch LF driver.
 - a. One (1) JBL 3635 Cinema subwoofer or approved equal.
 - b. One (1) speaker dolly with lockable casters.
- F. AC POWER
1. AC power sequencer system with surge suppression.
 - a. One (1) Middle Atlantic USC-6R sequencer or approved equal.
 - b. Three (3) Middle Atlantic RLM-20-1C power relay modules or approved equal.
 2. Equipment rack AC power outlet strips rated at 15-amps
 - a. Middle Atlantic PD series rack strips, as required, or approved equal.
 3. Uninterruptible power supply.
 - a. Middle Atlantic UPS-1000R or approved equal.
- G. EQUIPMENT RACKS AND ACCESORIES
1. Equipment Rack #1
 - a. One (1) Middle Atlantic ERK-3525 or approved equal.
 2. Four space, rack mount equipment drawer.
 - a. One (1) Middle Atlantic TD-3 or approved equal.
- H. ASSITIVE LISTENING SYSTEM
1. 72Mhz rack mount transmitter with remote antenna and four (4) receivers with single ear buds.
 - a. One (1) Listen Technologies Corporation LS-03-72 Performance System or approved equal.
- I. VIDEO SIGNAL PROCESSING AND CONTROL EQUIPMENT
1. Control System Processor.
 - a. One (1) Crestron CP3 or approved equal.
 2. 75-watt Cresnet power supply.
 - a. One (1) Crestron CNPWS-75 or approved equal.
 3. Control system touchpanels.
 - a. One (1) Crestron TSW-750-B-S or approved equal.
 - b. One (1) Crestron PWE-4803RU or approved equal.
- J. VIDEO PROJECTORS
1. Three chip DLP digital cinema projector with 9,000 lumens in DCI color space, >1900:1 contrast ratio (full field on:off), integrated media block, integrated touch panel control, motorized lens adjustment and 1.33-2.1:1 zoom lens.
 - a. One (1) Christie Digital Solaria One+ projector or approved equal.
 - b. One (1) Christie Digital 108-495-109-01 1.33-2.1:1 zoom lens or approved equal.
 - c. One (1) Christie Digital CDXL-21S1 Xenon lamp or approved equal.
 - d. One (1) Christie Digital IMP-S2 integrated media block or approved equal.
 - e. One (1) projector pedestal.
- K. PROJECTION PORT
1. 16"X16" Projection port.
 - a. One (1) Kelmar Systems 16"x16" projection port or approved equal.

L. PROJECTION SCREEN

1. Tensioned 133"x236" projection screen with cinema perforated projection screen material and low voltage control.
 - a. One (1) Draper Paragon Series V 114613SD 133"x236" with ClearSoundPerf XT900V surface and low voltage control or approved equal.
 - b. One (1) Draper LVC-III 121057 low voltage control or approved equal.

2.04 GENERAL EQUIPMENT

A. AUDIO CONNECTORS

1. Microphone and line-level type receptacles, cable connectors, and panel mounting receptacles shall be rectangular shape, except as noted.
 - a. Switchcraft Q-G series or approved equal.
2. Phone plugs ¼ inch, 3 conductor, separately mounted, panel mounting jacks with insulated bushings, which isolate the sleeve from the mounting panel, and as shown on drawings
 - a. Switchcraft "HI-D" jacks or approved equal.
3. Phone plugs, ¼ inch, 3 conductors, metal shell, solder terminals.
 - a. Switchcraft 297 or approved equal.
4. Phone connectors, phone plug, RCA type, metal shell.
 - a. Switchcraft 3502 or approved equal.
5. Speakon panel mount connectors.
 - a. Neutrik NL4 or approved equal.

B. AUDIO CABLE

1. Microphone and line-level audio circuits within conduits and equipment racks, #22AWG. 2-conductor, stranded, aluminum polyester shielded.
 - a. West Penn 452 or approved equal.
2. Loudspeaker circuits in conduit, equipment racks, or exposed interior benign environment (except return air plenums) stranded, unshielded, jacketed.
 - a. #18AWG, 2-conductors, (70 volt distributed only) West Penn 224 or approved equal.
 - b. #16AWG, 2-conductors, (16-ohm circuits only) West Penn 225 or approved equal .
 - c. #14AWG, 2-conductors, (8-ohm circuits only) West Penn 226 or approved equal.
 - d. #12AWG, 2-conductors, (4-ohm and 8-ohm circuits over 100 feet) West Penn 227 or approved equal.
3. Loudspeaker circuits where installed exposed above ceilings, which are used as return air plenums; 2-conductor, stranded, unshielded, with FEP Teflon insulation.
 - a. #18AWG, 2-conductor, West Penn 25224 or approved equal.
 - b. #16AWG, 2-conductor, West Penn 25225 or approved equal.
 - c. #14AWG, 2-conductor, West Penn 25226 or approved equal.
 - d. #12AWG, 2-conductor, West Penn 25227 or approved equal.

C. RF CABLE

1. Wireless microphone antenna cable.
 - a. West Penn RG-8U 50-ohm coaxial cable or approved equal.

D. VIDEO AND CONTROL CABLE

1. RS-232/422/485 cable, two pair shielded, 24AWG.
 - a. Belden 9729 or approved equal.
2. RGBHV cable shall consist of a five (5) conductor RG6 18 AWG, 75 ohm coaxial cable wrapped together within a superflex jacket with sequential numbering.
 - a. Extron MHR-5 or approved equal.
3. Installation Video Cable: 75-ohm RG-59/U 3GHz HDTV-compatible coaxial cable.
 - a. Belden 1505A or approved equal.

4. HDMI to DVI interface cables.
 - a. Crestron CBL-HD-DVI interface cables or approved equal.
5. Cable for Crestron DM.
 - a. Crestron DM-CBL-NP and DM-CBL-P or approved equal.
 - b. Crestron DM-CBL-8G-NP and DM-CBL-8G-P or approved equal.
6. HDMI Installation Cable.
 - a. Extron HDMI Pro or approved equal.
7. Precision Digital Cable.
 - a. Belden 1794A or approved equal.
8. Installation Video Cable: 75-ohm coaxial cable, two bundled conductors for S-Video use.
 - a. Belden 1808A or approved equal.

E. VIDEO CONNECTORS

1. RS-232/422/485 9-pin solder type connector shall be stamped contact to accommodate up to 20 AWG wire and stamped contacts with gold flash on remainder.
 - a. Action-Electronics DS9P (MALE) or approved equal.
 - b. Action-Electronics DS9S (FEMALE) or approved equal.
 - c. Action-Electronics DP9C (SHELL) or approved equal.
2. RGBHV video breakout. The BNC connector shall consist of a 75 ohm gold plated center pin with a fully enclosed outer metal conductor which is nickel plated.
 - a. Extron BNC MALE RG6 compression connector or approved equal
3. RGBHV HD15 connector with shell. The connector shall consist of gold plated contact pins with solder cup connections.
 - a. Action-Electronics DHS15P (MALE) or approved equal.
 - b. Action-Electronics DHS15S (FEMALE) or approved equal.
 - c. Action-Electronics DP9C (SHELL) or approved equal.
4. S-video video breakout and 4-pin solder-on connector. The BNC connector shall consist of a 75 ohm gold plated center pin with a fully enclosed outer metal conductor which is nickel plated.
 - a. Extron BNC Male MHR compression connector or approved equal.
5. S-video 4-pin solder-on connector. The 4-pin connector shall consist of gold-plated contacts and solder cup with a long lasting, durable dark silver/zinc alloy body with an integrated stainless steel spring strain relief.
 - a. Extron SV-HQ or approved equal.
6. 75 ohm Coaxial Cable connectors used for Complex and equipment rack interconnect cables. This connector shall be designed for analog and digital cables, a full crimp design, and meet or exceed HDTV standards.
 - a. KINGS 2065-10-9 or approved equal.
7. 75 ohm Coaxial BNC female to RCA male adapter.
 - a. Extron BNCF-RCAM or approved equal.
8. 75 ohm Coaxial RCA female to BNC male adapter.
 - a. Extron RCAF-BNCM or approved equal.

F. EQUIPMENT RACK ACCESSORIES

1. Equipment rack blanks, 1-5 space.
 - a. Middle Atlantic EB-1 or approved equal.
 - b. Middle Atlantic EB-2 or approved equal.
 - c. Middle Atlantic EB-3 or approved equal.
 - d. Middle Atlantic EB-4 or approved equal.

PART 3 EXECUTION

3.01 GENERAL

- A. Non-compliance with any of the following as deemed by the Owner or Architect or Consultant shall be cause for rejection of work. Necessary rework and/or replacement shall be the responsibility of the AV Contractor and shall be provided at no added cost to the Owner to the satisfaction of the aforementioned parties.

- B. Installation of the AV system shall be performed only by knowledgeable and experienced AV system installers.
- C. All equipment and materials shall be installed in accordance with all applicable standards of the National Electric Code and any other applicable local codes.
- D. If, in the opinion of the AV Contractor, an installation practice is desired or required, which is contrary to these specifications or drawings, a written request for modification shall be made to the Architect and Consultant. Modifications shall not be implemented without the written approval from the Consultant.
- E. All materials and labor shall be furnished, whether specifically mentioned or not, to form complete and fully operational systems. Include the delivery, unloading, placement, fastening to walls, floors, ceiling, or counters, other structures where required, interconnecting wiring of the systems components, equipment alignment, and all other work whether it is necessary to result in complete operational systems.
- F. All installation activities shall be in accordance with accepted broadcast and audio engineering practices. All efforts shall be invoked to ensure the owner's desire that the system have extended life.
- G. The AV Contractor shall be responsible for the complete and unconditional implementation of each system, even though he may have subcontracted a portion of the installation or had certain manufacturers install their own equipment.

3.02 INSTALLATION

- A. It shall be the responsibility of the AV Contractor to cooperate at all times and to the fullest extent with all trades and contractors doing work on site, to the end that lost time, work stoppages, interference, and inefficiencies do not occur. Coordinate with all other trades for all aspects of the work.
- B. AV Contractor shall remain aware of all project time schedules.
- C. AV Contractor bears the responsibility to verify all site conditions and coordinate with the Electrical Contractor to ensure a complete and functional system is provided to the Owner.
- D. During the installation, and up to the date of final acceptance, the AV Contractor shall be under obligation to protect his/her finished and unfinished work against damage and loss; such work shall be replaced or repaired at no cost to the Owner.
- E. Include delivery, storage, and handling of all products and materials to be delivered and installed.
- F. AV Contractor shall be responsible for providing on-site storage if necessary. AV Contractor may negotiate a storage facility with the Construction Manager or General Contractor, but shall still be responsible for his/her own materials.
- G. Cable within equipment racks shall be separated according to function. Plastic wire ties or other appropriate wire management devices shall be used for grouping of circuits.
- H. Cable in conduit or raceways shall be separated according to function. Except as indicated on drawings.
- I. At all cable termination points, labels of appropriate numbers shall be wrapped around each cable near its termination. These numbers shall be marked on the project audio functional diagrams and included on the audio diagrams of record.
- J. All audio circuits shall be two-wire (balanced) with shield. The high side of the line shall be connected to the "tip" or patch panel and phone jacks or to pin two of microphone connectors. The low side shall be connected to the "ring" of patch panel and phone jacks or to pin three of

microphone connectors. The shield wire shall be connected to the "sleeve" of phone jacks or pin one of microphone connectors.

- K. All shield wires shall be sheathed in PVC tubing. Circuits shall not connect to each other nor ground to electrical conduit at wall boxes etc. Microphone circuit shields shall be grounded only at mixer inputs.
- L. In order to minimize problems resulting from improper grounding, and to achieve maximum signal-to-noise ratios, the following grounding procedures shall be adhered to:
 - 1. Under no circumstances shall the racks contact the raceway system, the steel structure of the building or ventilation ducts.
 - 2. All ground cables shall be insulated, especially if the cable is enclosed in a conduit or has any possibility of contact with metallic boxes or a conduit system.
 - 3. The system ground copper conductor must not touch any metallic object or device between the main building electrical ground point, and the audio racks. Similarly, with any extension of this ground, caution must be observed to preserve the audio system ground potential by insulating the ground wire at all times.
 - 4. Under no conditions shall the AC neutral conductor, at any location, be used for a system ground.
- M. All equipment shall be installed in equipment racks with tamper resistant square-drive 10/32 x 3/4" screws as type Middle Atlantic part# HS. The AV Contractor shall provide a total of eight (8) Middle Atlantic part# SBIT square-drive bits to the owner for their use. Note equals as manufactured by Atlas and Lowell Manufacturing are allowed.
- N. Loudspeakers shall be installed so there is a clear line of sight to all coverage areas with no obstruction to the coverage pattern.
- O. All rigging and support steel required for installation of loudspeakers shall be provided by the AV Contractor. AV Contractor is responsible to verify weight and load conditions for all rigging to ensure structural integrity of the building. Any additional structural enhancements shall be performed at the expense of the AV Contractor without claim for additional payment. If significant structural adjustments are necessary, a Structural Engineer licensed to work in the State of Nebraska shall be retained by the AV Contractor to certify the proposed hanging methods.
- P. All loudspeakers shall be installed per plans and arranged as shown on the drawings. All conflicts shall be reported and satisfactorily worked out with other trades.
- Q. If significant changes are required, verify with the Consultant prior to making changes. Failure to verify with the Consultant shall result in the AV Contractor assuming full liability for speaker placement. If a changed speaker placement is deemed unacceptable by the Owner, the AV Contractor shall rectify the problems to the Owner's satisfaction without claim for additional payment.
- R. Any changes or revisions must be accompanied with EASE data showing the effect of the resulting configuration as compared to the original design. If a changed speaker placement is deemed unacceptable by the Owner, the AV Contractor shall rectify the problems to the owner's satisfaction without claim for additional payment.
- S. All loudspeakers shall be installed with the ability to adjust speakers +/- 8 degrees vertically and +/- 6 degrees horizontally. Some adjustment may be necessary at the system commissioning with the Consultant
- T. Paint all exposed loudspeakers, baffles, and hardware, color and method as approved by Architect.
- U. All equipment in racks shall be identified on front and rear panels by engraved nameplates.
- V. All projectors shall be color calibrated and/or color matched in accordance with ITU-R Recommendation BT.709. AV Contractor shall use an appropriate colorimeter or

spectroradiometer. Accepted equipment shall be: Konica Minolta CS100A, CL200, CS2000 and PhotoResearch PR-655 or approved equal.

- W. All control panels, patch panels and all controls, jacks, microphone receptacles, switches, etc. (except for controls, etc., on audio equipment which are properly identified by the manufacturer) shall be suitably identified by engraved panels, engraved plates, metal-photo panels, or metal-photo plates. Engraved plates or panels shall be filled with a suitably contrasting color, as approved on shop drawings.
- X. All nameplate nomenclature shall be reviewed by the consultant prior to panel or plate engraving, or metal-photo finishing.

3.03 TESTS AND ADJUSTMENTS

- A. It shall be the responsibility of the AV Contractor to perform preliminary tests and adjustments of the AV system prior to final system commissioning.
- B. These tests and adjustments shall include but not be limited to the following:
 - 1. Testing of each loudspeaker to ascertain that none of the units "rattle" with a nominal pink noise input of 2 watts.
 - 2. Functional tests of all audio equipment.
 - 3. Gain staging of the signal chains for all systems.
 - 4. Testing of all video signal inputs and outputs for proper level and operation.
 - 5. Alignment of all displays to insure even and true color reproduction and a picture of proper brightness and contrast.
 - 6. Testing of all control and controlled equipment for proper operation.
 - 7. Programming of all Control systems and controls to provide functions as called out on drawings or required for proper operation of the controlled systems.
- C. The AV Contractor shall provide the following equipment on site prior to commissioning; a laptop computer with all software installed required to program all DSP's, any other equipment requiring a computer to adjust, along with all interfaces and cables required to connect the computer to the aforementioned equipment or system(s).
- D. The AV Contractor shall program all control systems to provide functions as required to operate the AV system in total, with all AV equipment, sources and displays available as needed.
- E. The AV Contractor shall ensure all video devices are operating at the optimum native resolution for the AV system and proper EDID data is provided.

3.04 OWNER TRAINING AND SYSTEM OPERATING ASSISTANCE

- A. The AV Contractor shall provide on-the-job training sessions on each major system for Owner-designated personnel, instructing them in the operation and maintenance of the system. The training sessions shall take place after the system is operational, at a time prearranged with the Owner. The Owner may elect to video tape these training sessions for future reference. The training time shall be part of the total of the installation and shall be included in the installation charges.
- B. The major systems for which the above mentioned training shall be provided as well as the length of these sessions are as follows:
 - 1. A/V System (Two (2) 2-hour sessions).
- C. The AV Contractor shall instruct the owner in the proper use of all equipment. The owner shall be instructed in the proper techniques of microphone use.
- D. Contractor shall have a knowledgeable representative present for the first official use of each theatre system. AV Contractor's Representative shall have sufficient knowledge of the systems as installed so as to troubleshoot any problems that may arise during the first usage. AV Contractor's Representative shall be present for the entire first usage of the systems unless other arrangements are made with the Owner.

3.05 AV SYSTEMS MANUALS AND DOCUMENTATION

- A. Notebooks as described below shall be assembled by the AV Contractor for all AV systems furnished under this contract. The AV Contractor shall forward the notebooks and field drawings, with all wire numbers, to the Consultant for review.
- B. The following information shall be placed in the notebooks; table of contents, section tabs with labels, final as built wiring diagrams of all systems, system operating instructions and manufacturer's manuals.
- C. A copy of all DSP settings shall be burned to data CD and placed in the rack that houses the respective DSP after the completion and acceptance of all work and testing

END OF SECTION

AV SYSTEM SCHEDULE				
SYMBOL	AV CONTRACTOR	ELECTRICAL CONTRACTOR	DESCRIPTION	NOTES
IG 1	INSTALLED BY ELECTRICAL CONTRACTOR. COORDINATE WITH ELECTRICAL CONTRACTOR WHERE REQUIRED.	INDICATES ISOLATED (TECHNICAL) GROUND.	DUPLEX OUTLET. 120 VOLT, 20AMP, ISOLATED GROUND.	VERIFY LOCATION ON SITE. POWER CIRCUITS SHALL BE PART OF ELECTRICAL CONTRACTORS BASE BID.
IG 1	INSTALLED BY ELECTRICAL CONTRACTOR. COORDINATE WITH ELECTRICAL CONTRACTOR WHERE REQUIRED.	INDICATES ISOLATED (TECHNICAL) GROUND.	QUAD OUTLET. 120 VOLT, 20AMP, ISOLATED GROUND.	VERIFY LOCATION ON SITE. POWER CIRCUITS SHALL BE PART OF ELECTRICAL CONTRACTORS BASE BID.
IG 220	INSTALLED BY ELECTRICAL CONTRACTOR. COORDINATE WITH ELECTRICAL CONTRACTOR WHERE REQUIRED.	INDICATES ISOLATED (TECHNICAL) GROUND.	220 VOLT, ISOLATED GROUND POWER CIRCUIT.	VERIFY LOCATION ON SITE. POWER CIRCUITS SHALL BE PART OF ELECTRICAL CONTRACTORS BASE BID.
Ⓜ	AC POWER TO SCREEN MOTOR WIRED BY ELECTRICAL CONTRACTOR. COORDINATE WORK WITH ELECTRICAL CONTRACTOR.	ROUTE AC POWER TO ELECTRIC SCREEN MOTOR AND TERMINATE. COORDINATE WITH AV CONTRACTOR.	SCREEN MOTOR AC POWER.	
1 XXXX			CONNECTION DESIGNATOR. INDICATES CONNECTION NUMBER.	
1 XXXX			INDICATES DRAWING SHEET.	
1 XXXX			CONNECTION DESIGNATOR. INDICATES CONNECTION NUMBER.	
1 XXXX			INDICATES DRAWING SHEET.	
AV1	LOCATION OF MAIN EQUIPMENT RACK.	24"x18"x4" DEEP FLUSH MOUNT BOX. MOUNT AT 1'-0" A.F.F. PROVIDE FOUR (4) 120 VOLT, 20 AMP, AC POWER CIRCUITS ON DUPLEX RECEPTACLES NEARBY BOX. COORDINATE WITH AV CONTRACTOR. BOND RACK TO PANEL GROUND WITH A MINIMUM 10AWG CONDUCTOR.	MIDDLE ATLANTIC ERK-3525 OR APPROVED EQUAL.	LOCATE AS INDICATED ON DRAWINGS. REQUIRED CONDUITS AND PULL LINES SHALL BE PART OF ELECTRICAL CONTRACTORS BID.
HA	LOCATION OF HEARING ASSISTANCE ANTENNA.	SINGLE-GANG 2 1/2" DEEP BOX SURFACE MOUNT BOX. MOUNT 13'-0" A.F.F. IN LOCATION SHOWN ON DRAWINGS. COORDINATE WITH AV CONTRACTOR.		LOCATE AS INDICATED ON DRAWINGS. REQUIRED CONDUITS AND PULL LINES SHALL BE PART OF ELECTRICAL CONTRACTORS BID.
IP1	LOCATION OF SPEAKER INPUT PLATE.	12"x12"x4" DEEP FLUSH MOUNT BOX. MOUNT AT 1'-0" A.F.F. IN LOCATION SHOWN ON DRAWINGS. COORDINATE WITH AV CONTRACTOR.	12"x12" PANEL WITH TWO (2) NEUTRIK NL4MP SPEAKON CONNECTORS.	LOCATE AS INDICATED ON DRAWINGS. REQUIRED CONDUITS AND PULL LINES SHALL BE PART OF ELECTRICAL CONTRACTORS BID.
IP2	LOCATION OF SPEAKER INPUT PLATE.	12"x12"x4" DEEP FLUSH MOUNT BOX. MOUNT AT 1'-0" A.F.F. IN LOCATION SHOWN ON DRAWINGS. COORDINATE WITH AV CONTRACTOR.	12"x12" PANEL WITH TWO (2) NEUTRIK NL4MP SPEAKON CONNECTORS.	LOCATE AS INDICATED ON DRAWINGS. REQUIRED CONDUITS AND PULL LINES SHALL BE PART OF ELECTRICAL CONTRACTORS BID.
P1	LOCATION OF PROJECTORS. COORDINATE WORK WITH ELECTRICAL CONTRACTOR.	DUAL-GANG 2 1/2" DEEP BOX. SURFACE MOUNT ABOVE CEILING IN LOCATION SHOWN ON DRAWING. PROVIDE ONE (1) 220 VOLT, IG AC POWER CIRCUIT WIRED TO PROJECTOR. INSTALL DEDICATED EARTH GROUND TO PROJECTOR. COORDINATE WITH AV CONTRACTOR.	CHRISTIE DIGITAL SOLARIA ONE+ PROJECTOR WITH 108-495109-01 1.33-2.1:1 ZOOM LENS, IMB-S2 INTEGRATED MEDIA BLOCK, AND CDXL-2151 XENON LAMP. MOUNT AT LOCATION SHOWN ON DRAWINGS. PROVIDE ONE (1) CUSTOM MOUNTING PEDESTAL THAT ENSURES PROPER HORIZONTAL AND VERTICAL MOUNTING LOCATION. PROVIDE ALL NECESSARY MOUNTING BRACKETS.	LOCATE AS INDICATED ON DRAWINGS. REQUIRED CONDUITS AND PULL LINES SHALL BE PART OF ELECTRICAL CONTRACTORS BID.
SC1	LOCATION OF PROJECTION SCREEN. COORDINATE WORK WITH GENERAL CONTRACTOR AND ELECTRICAL CONTRACTOR.	ROUTE AC POWER TO PROJECTION SCREEN MOTOR AND CONDUIT FOR LOW VOLTAGE CONTROL WIRING TO PROJECTION SCREEN. LOCATE LVC IN PROJECTION BOOTH. COORDINATE WITH AV CONTRACTOR. LOW VOLTAGE CONTROL SHALL ROUTE TO RACK LOCATION.	DRAPER PARAGON SERIES V 114613SD 133"x236" MOTORIZED PROJECTION SCREEN WITH CLEARSOUNDPERF XT900V SCREEN SURFACE AND LOW VOLTAGE CONTROL.	LOCATE AS INDICATED ON DRAWINGS. GENERAL CONTRACTOR SHALL MOUNT PROJECTION SCREENS AND COORDINATE WORK WITH AV CONTRACTOR. ANY ADDITIONALLY REQUIRED RIGGING HARDWARE SHALL BE SUPPLIED BY THE GENERAL CONTRACTOR. REQUIRED CONDUITS AND PULL LINES SHALL BE PART OF ELECTRICAL CONTRACTORS BASE BID.
SP1	LEFT, CENTER, RIGHT LOUSPEAKERS CLUSTERS. MOUNT LOUSPEAKERS ON DOLLIES TO ALLOW EASY REMOVAL FROM STAGE IN LOCATIONS SHOWN.		THREE (2) JBL 3722N LOUSPEAKER OR APPROVED EQUALS. PROVIDE ALL NECESSARY MOUNTING HARDWARE.	LOCATE AS INDICATED ON DRAWINGS.
SP2	LEFT AND RIGHT SURROUND LOUSPEAKERS.	DUAL-GANG 2 1/2" DEEP BOX. SURFACE MOUNT ON WALL 10'-0" A.F.F. FROM BOTTOM OF LOUSPEAKER AT LOCATION SHOWN ON DRAWING. COORDINATE WITH AV CONTRACTOR.	SIX (6) JBL 8320 LOUSPEAKERS OR APPROVED EQUALS. PROVIDE ALL NECESSARY MOUNTING BRACKETS.	LOCATE AS INDICATED ON DRAWINGS. REQUIRED CONDUITS AND PULL LINES SHALL BE PART OF ELECTRICAL CONTRACTORS BID.
SP3	LEFT AND RIGHT SURROUND LOUSPEAKERS.	DUAL-GANG 2 1/2" DEEP BOX. SURFACE MOUNT ON WALL 9'-0" A.F.F. FROM BOTTOM OF LOUSPEAKER AT LOCATION SHOWN ON DRAWING. COORDINATE WITH AV CONTRACTOR.	SIX (6) JBL 8320 LOUSPEAKERS OR APPROVED EQUALS. PROVIDE ALL NECESSARY MOUNTING BRACKETS.	LOCATE AS INDICATED ON DRAWINGS. REQUIRED CONDUITS AND PULL LINES SHALL BE PART OF ELECTRICAL CONTRACTORS BID.
SP4	SUBWOOFER. MOUNT LOUSPEAKERS ON DOLLIES TO ALLOW EASY REMOVAL FROM STAGE IN LOCATIONS SHOWN.		ONE (1) JBL 3635 LOUSPEAKER OR APPROVED EQUALS. PROVIDE ALL NECESSARY MOUNTING HARDWARE.	LOCATE AS INDICATED ON DRAWINGS.

A1 AV SYSTEMS SCHEDULE
NO SCALE

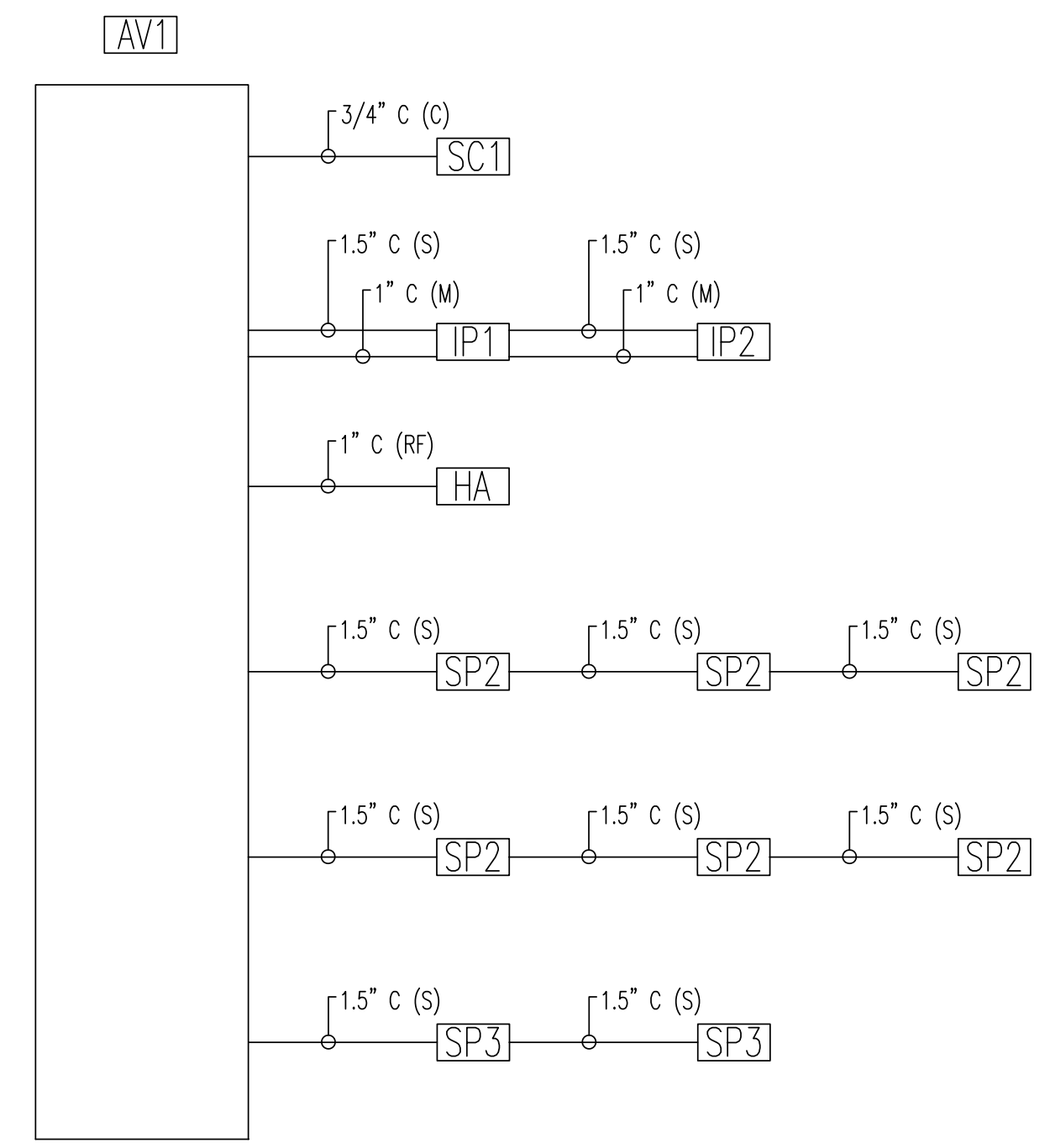

P11 AV SYSTEMS CONDUIT RISER
NO SCALE

AV SYSTEM SIGNAL TYPES:

(M) INDICATES MICROPHONE LEVEL SIGNALS. (0 TO 100mV)
(L) INDICATES LINE LEVEL SIGNALS. (100mV TO 10V)
(C) INDICATES INTERCOM SIGNALS.
(V) INDICATES VIDEO SIGNALS. (BASEBAND/COMPOSITE TV P-P)
(S) INDICATES LOUSPEAKER LEVEL SIGNALS. (10V TO 70V)
(C) INDICATES CONTROL SIGNALS.
(D) INDICATES DIGITAL SIGNALS (UTP HIGH FREQUENCY, FIBER OPTIC, ETC.)

CONDUIT SEPARATION FOR RUNS >40'-0\"/>

GROUP 1 = SIGNAL TYPE (M)
GROUP 2 = SIGNAL TYPE (L),(C)
GROUP 3 = SIGNAL TYPE (S)
GROUP 4 = SIGNAL TYPE (V)
GROUP 5 = SIGNAL TYPE (R),(D)&(C)

	GROUP 1	GROUP 2	GROUP 3	GROUP 4	GROUP 5
GROUP 1	ADJACENT	0'-6"	1'-0"	1'-0"	1'-0"
GROUP 2	0'-6"	ADJACENT	1'-0"	0'-6"	ADJACENT
GROUP 3	1'-0"	1'-0"	ADJACENT	0'-6"	ADJACENT
GROUP 4	1'-0"	0'-6"	0'-6"	ADJACENT	ADJACENT
GROUP 5	1'-0"	ADJACENT	ADJACENT	ADJACENT	ADJACENT
220V/440V CIRCUITS	6'-0"	6'-0"	4'-0"	5'-0"	2'-0"
DIMMER CONTROLLED LIGHTING	2'-0"	1'-0"	0'-6"	1'-0"	0'-6"
SCR CONTROLLED CIRCUITS	3'-0"	2'-0"	0'-6"	1'-0"	0'-6"
OTHER SERVICES	1'-0"	1'-0"	0'-6"	0'-6"	0'-6"

GENERAL NOTES

- IN ALL CASES, WHERE A SPECIFIC JUNCTION BOX SIZE IS NOT PROVIDED, SIZE ALL JUNCTION BOXES AS REQUIRED FOR THE NUMBER OF CONDUITS. IF A SPECIFIC STATED SIZE IS INSUFFICIENT, SIZE BOX UP AS NEEDED. HOWEVER, DO NOT DOWN SIZE ANY JUNCTION BOXES FROM THE INDICATED SIZE.
- JUNCTION BOXES WHICH MOUNT AV SYSTEM PANELS OR SPECIFIC EQUIPMENT SHALL NOT BE RESIZED IN THE FIELD.
- INSTALL PULL BOX OR PULL FITTING FOR EACH 125'-0" OF STRAIGHT RUN AND FOR EVERY 270' OF TOTAL BEND.
- INSTALL LENGTH MARKED PULL CORDS IN ALL CONDUITS AS TYPE BY KLIEN OR GREENLEE.
- ALL AV SYSTEM CONDUITS SHALL BE METAL EMT ABOVE SLAB AND PVC BELOW SLAB.
- WHERE DIFFERING SIGNAL GROUPS ARE INSTALLED IN CLOSE PROXIMITY TO EACH OTHER, THESE CONDUITS SHALL CROSS AT A 90° ANGLE TO EACH OTHER.
- ALL DIGITAL (D) CABLE/CONDUIT RUNS SHALL NOT EXCEED 200' TOTAL LENGTH FROM OUTPUT OF SENDING DEVICE TO INPUT OF RECEIVING DEVICE. CONDUITS CARRYING THESE SIGNALS SHALL BE RAN IN THE MOST DIRECT ROUTE TO ALLOW THIS LENGTH TO BE MAINTAINED.

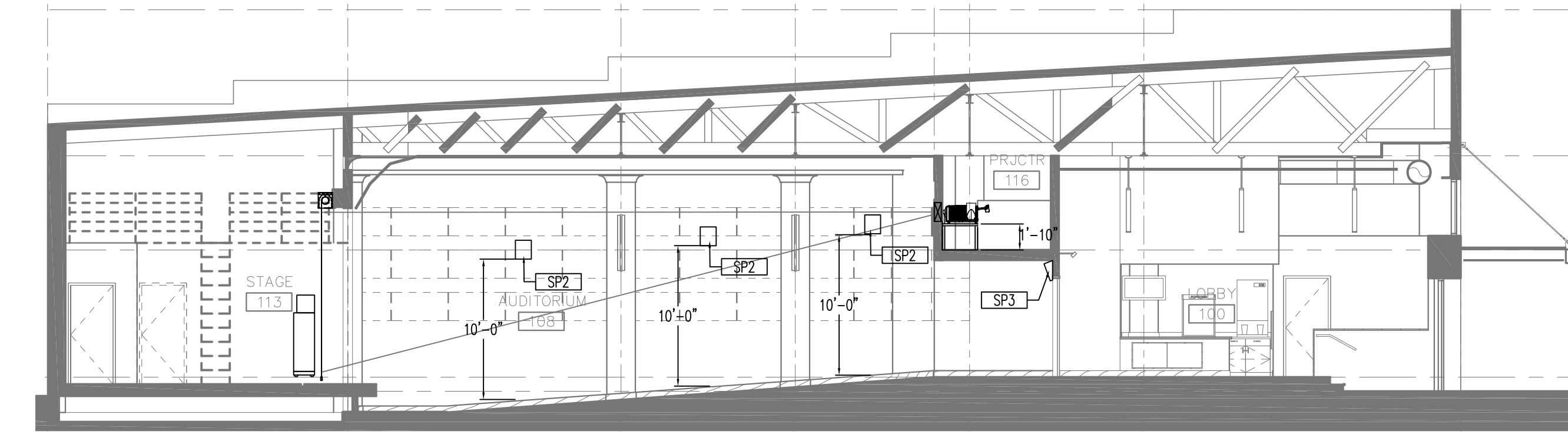

L11 TRANSVERSE SECTION
SCALE: 1/8" = 1'-0"



F11 FIRST FLOOR PLAN
SCALE: 1/8" = 1'-0"

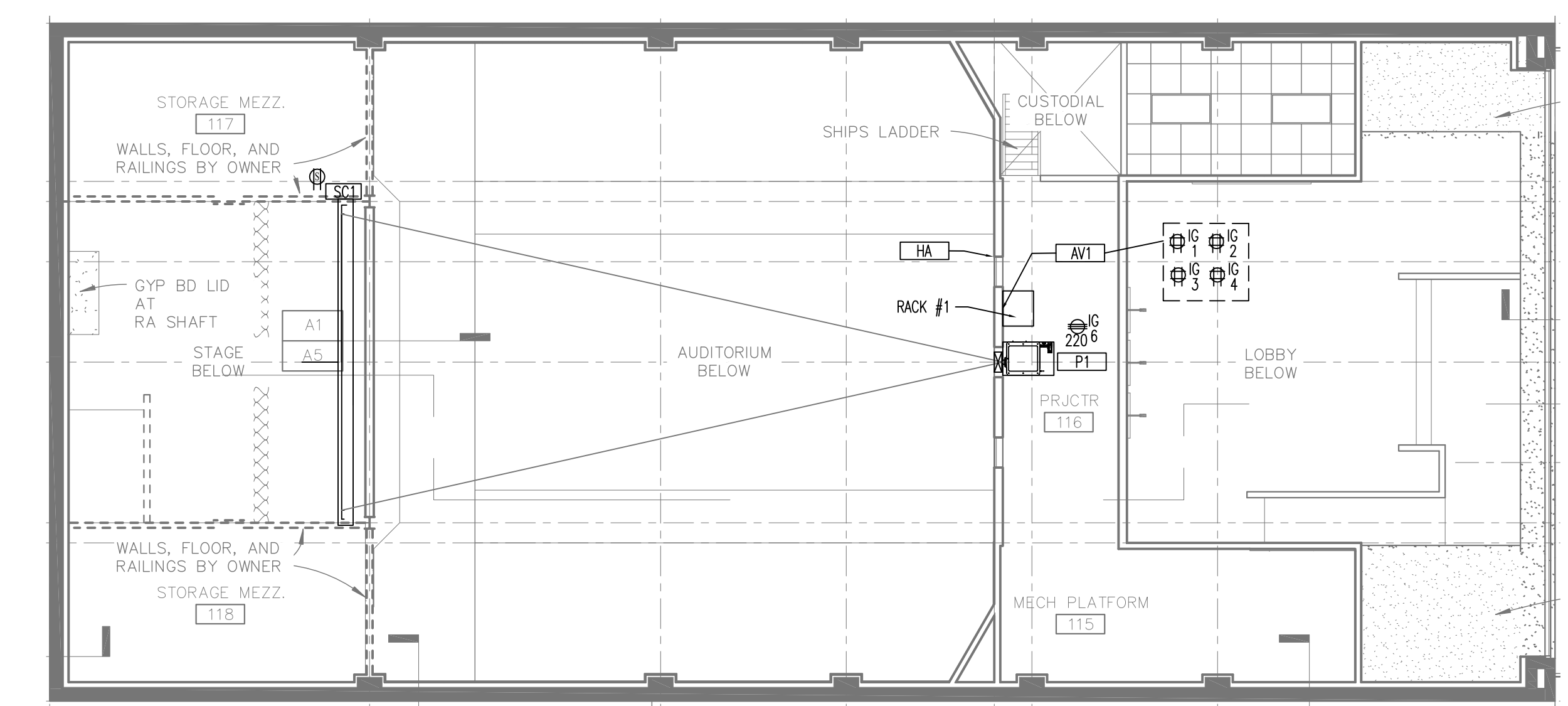

A11 MEZZANINE FLOOR PLAN
SCALE: 1/8" = 1'-0"



ARCHITECT
BAHR VERMEER HAECKER ARCHITECTS
440 N 8TH ST STE 100
LINCOLN, NE 68508
V 402 475 4651
F 402 475 5226
bvh.com

STRUCTURAL ENGINEER
R.O. YOYKER, INC.
1201 O STREET, STE 510
LINCOLN, NE 68508
V 402 477 7640
F 402 477 7631
ROYYOYKER.COM

MECHANICAL ENGINEER
ENGINEERING TECHNOLOGIES, INC.
825 M STREET, STE 200
LINCOLN, NE 68508
V 402 476 1773
F 402 476 1274
ETH-ENGINEERS.COM

ELECTRICAL ENGINEER
ENGINEERING TECHNOLOGIES, INC.
825 M STREET, STE 200
LINCOLN, NE 68508
V 402 476 1273
F 402 476 1274
ETH-ENGINEERS.COM

REVISIONS SCHEDULE		
MARK	DATE	DESCRIPTION
SHEET AV1	3-28-2014	ADDENDUM 1

MAJESTIC THEATRE REHABILITATION

PROJECT: L13542 DATE: MARCH 13, 2014

AV PLANS AND SECTION, SYSTEM SCHEDULE AND CONDUIT RISER

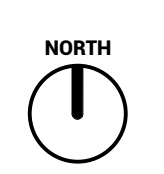



ARCHITECT
BVH VERMEER HAECKER ARCHITECTS
 440 N 8TH ST STE 100
 LINCOLN, NE 68508
 V: 402.475.4551
 F: 402.475.0226
 bvh.com

STRUCTURAL ENGINEER
R.O. YOYKER, INC.
 1201 O STREET, STE 310
 LINCOLN, NE 68508
 V: 402.477.7640
 F: 402.477.7631
 ROYOYOKER.COM

MECHANICAL ENGINEER
ENGINEERING TECHNOLOGIES, INC.
 825 M STREET, STE 200
 LINCOLN, NE 68508
 V: 402.476.1273
 F: 402.476.1274
 ETI-ENGINEERS.COM

ELECTRICAL ENGINEER
ENGINEERING TECHNOLOGIES, INC.
 825 M STREET, STE 200
 LINCOLN, NE 68508
 V: 402.476.1273
 F: 402.476.1274
 ETI-ENGINEERS.COM

REVISIONS SCHEDULE		
MARK	DATE	DESCRIPTION
SHEET AV2	3-28-2014	ADDENDUM 1

MAJESTIC THEATRE REHABILITATION

PROJECT: L13542 DATE: MARCH 13, 2014

AV SYSTEMS POWER DISTRIBUTION DIAGRAM, RACK AND PANEL DIAGRAM

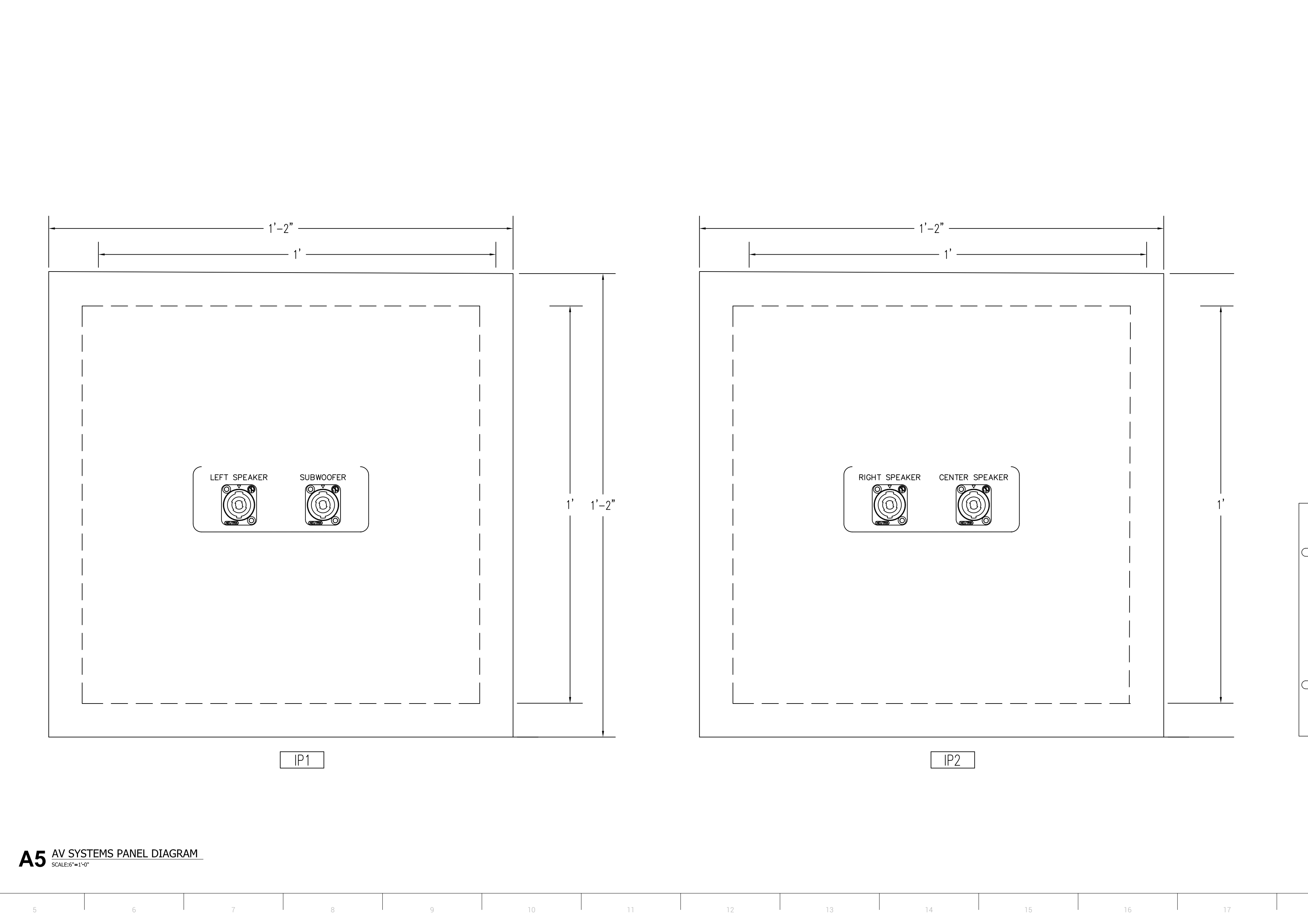
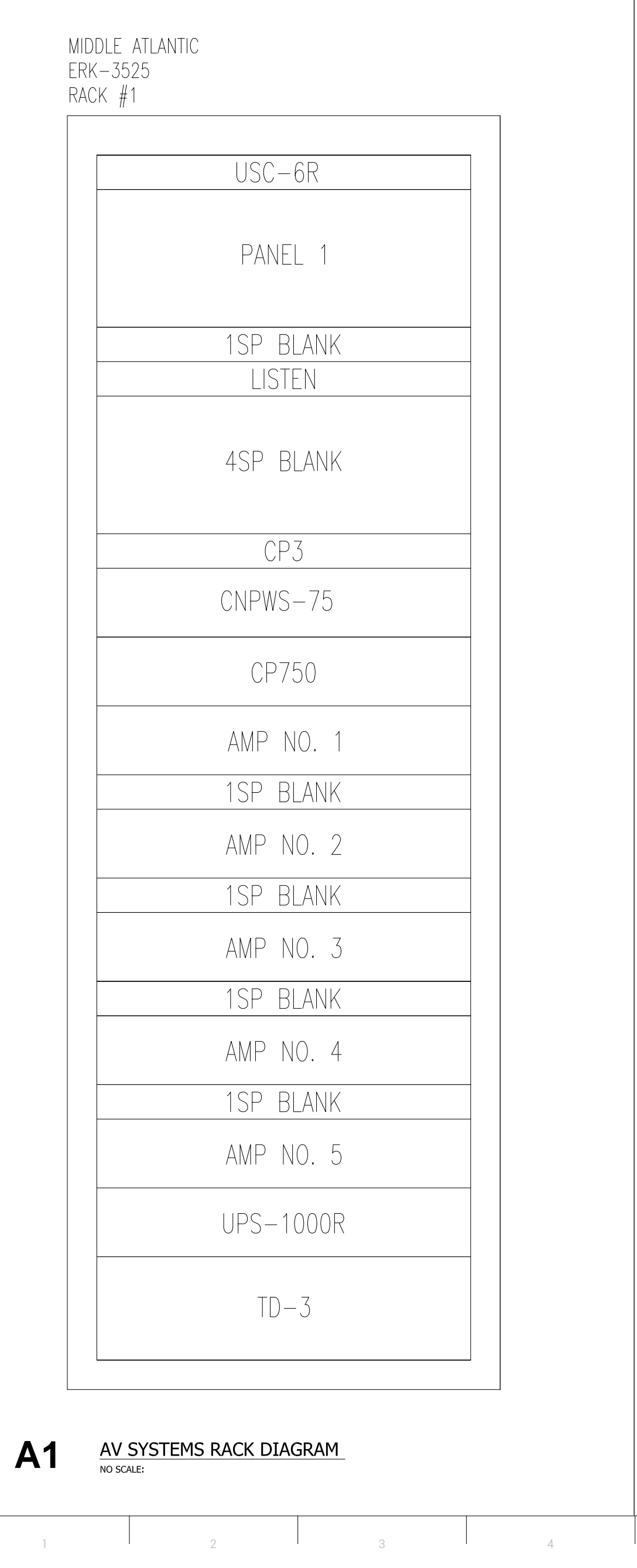
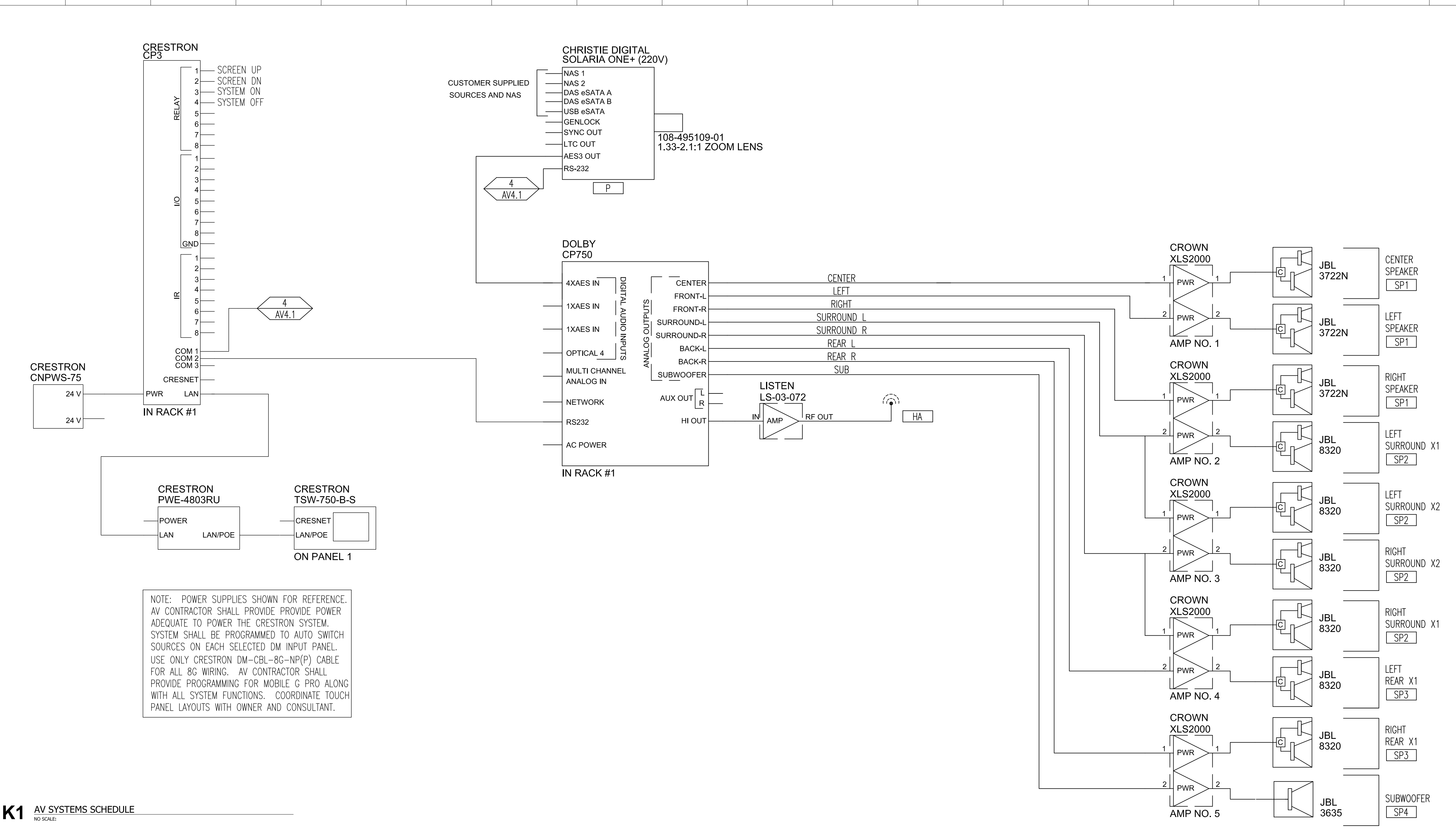
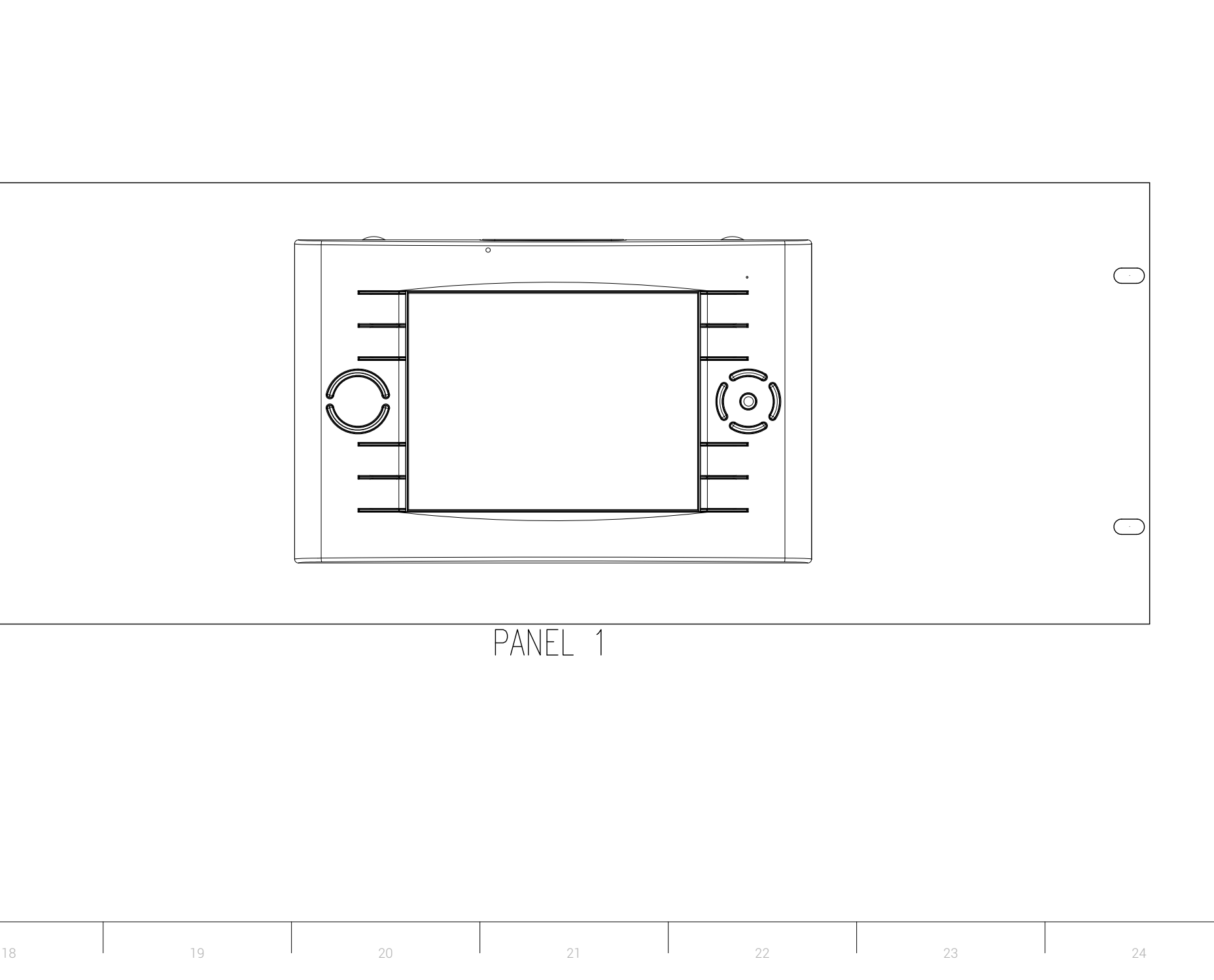
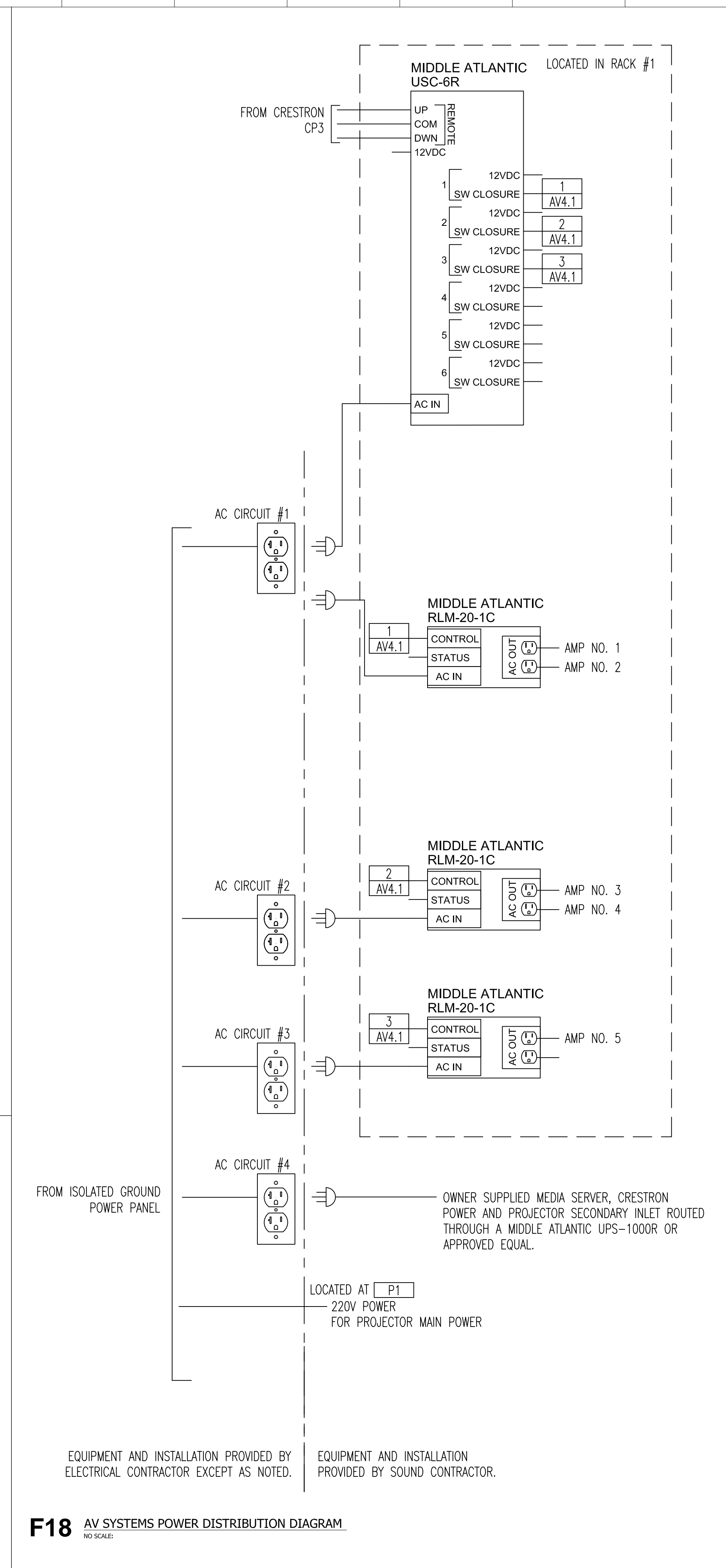

A1 AV SYSTEMS RACK DIAGRAM
NO SCALE

A5 AV SYSTEMS PANEL DIAGRAM
SCALE: 1/4"=1'-0"

F18 AV SYSTEMS POWER DISTRIBUTION DIAGRAM
NO SCALE

K1 AV SYSTEMS SCHEDULE
NO SCALE

NOTE: POWER SUPPLIES SHOWN FOR REFERENCE. AV CONTRACTOR SHALL PROVIDE ADEQUATE POWER TO POWER THE CRESTRON SYSTEM. SYSTEM SHALL BE PROGRAMMED TO AUTO SWITCH SOURCES ON EACH SELECTED DM INPUT PANEL. USE ONLY CRESTRON DM-CBL-BG-NP(P) CABLE FOR ALL 8G WIRING. AV CONTRACTOR SHALL PROVIDE PROGRAMMING FOR MOBILE G PRO ALONG WITH ALL SYSTEM FUNCTIONS. COORDINATE TOUCH PANEL LAYOUTS WITH OWNER AND CONSULTANT.