



Engineering Technologies Inc

### Pre-Bid Addendum #1

DATE ISSUED

ARCHITECT

ENGINEER

ADDENDUM #

PROJECT

PROJECT #

The Architect/ Engineer issues this Addendum to all known bidders before receipt of bid/ proposals. Bidder shall acknowledge the receipt of this addendum on their bidding sheet and all information contained herein shall become a part of the contract documents.

#### ADDENDUM:

##### GENERAL ITEMS- CONSTRUCTION STAGING

Questions about lift size allowed over the structured floor (where basement occurs below the gym floor at the east end, near the stage) and wood floor protection were raised. The Owner has used a scissor lift in the gym for lighting maintenance. Contractor may assume that a single scissor lift no larger than a typical 30" wide, 19' reach, weight up to 2,900 pounds may be used over the structured floor.

Multiple lifts may be used over the slab-on-grade gym floor.

Contractor shall take precautions to protect the existing wood floor from construction damage resulting from lifts or any other operation. Any damage that occurs shall be repaired and returned to the previous condition.

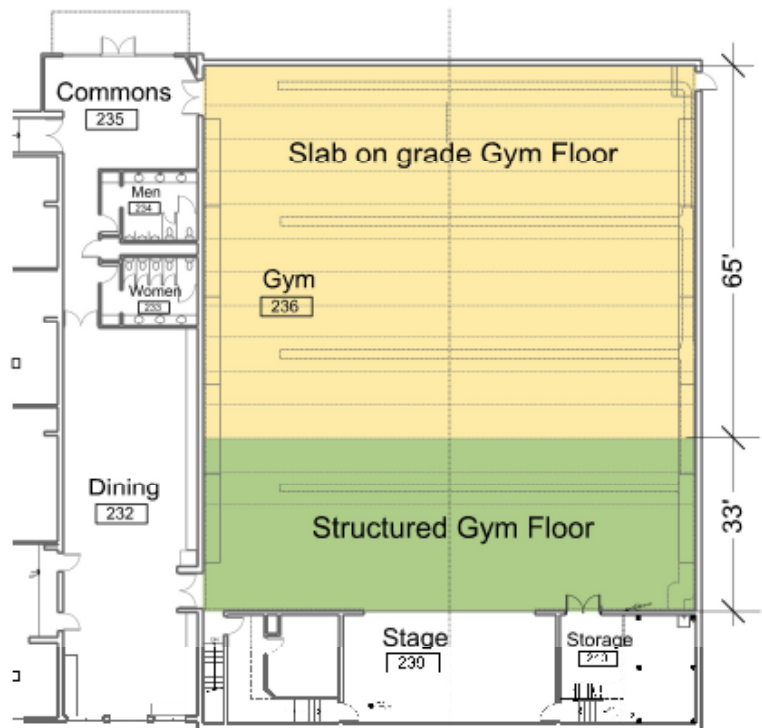

Partial Plan

## GENERAL ITEMS – MECHANICAL

### 1. Glycol – Existing/New and Intent

- A. It was brought up in the pre-bid walk-thru to reclaim and re-use the existing glycol. For clarification we are staying with the original intent to remove the existing glycol water solution in its entirety, flush and chemically treat the system and replace with a new 50% propylene glycol and deionized water solution. The current service provider indicated that the existing water solution is at 20% propylene glycol. The existing glycol shall be disposed of properly per the requirements of the state and not be sent down the drain to the city sewer system. The system volume shall be determined by the contractor from the plans.
- B. If the alternate deduct is chosen to not replace the boiler, pumps, etc. it is still the intent to remove the existing glycol solution, clean and flush and replace with new 50% solution as specified.

### 2. Insulation – Existing Piping/New Piping and PVC Jacket

- A. During the pre-bid walk-thru it was brought up that the existing hydronic hot water piping in the basement is currently spaced to handle 1 inch insulation. For clarification it is the intent that the existing exposed hydronic piping is to remain in place and to be re-insulated with 1" insulation and new PVC jacket to protect the insulation. All new piping will be insulated with thicker insulation per the specifications. The existing exposed domestic water piping shall continue to be insulated per the specifications.
- B. For clarification it is the intent that the existing exposed hydronic and domestic water piping in the basement shall be provided with new hangers to allow insulation to travel through the hanger. In areas that cannot receive larger hangers without adjusting the piping it will be acceptable to insulate up to the existing hangers and not through a new larger hanger.
- C. During the pre-bid walk-thru a concern was brought up if PVC jacket will hold up to 180 degree hydronic hot water piping with 1" insulation. For clarification the surface temperature on the outside of 1" insulation will be 85 degree F, therefore PVC jacket shall be installed on the existing piping.

### 3. Additional Walk-Thru for Insulator Contractors

- A. An additional walk-thru for the insulating contractors shall be scheduled for Thursday March 20<sup>th</sup> at 1:30pm at the school. Please RSVP to Derek Kotschwar at [dkotschwar@eti-engineers.com](mailto:dkotschwar@eti-engineers.com) by the Wednesday 19<sup>th</sup> at noon.

### 4. Existing Boiler – Asbestos

- A. For clarification at this time we can only assume that the existing boiler contains asbestos. Prior to the project starting the Owner will solicit a contractor to verify and remove any asbestos relating to the boiler.

## PRIOR APPROVAL – MECHANICAL

- 1. The following manufacturers have received prior approval for bidding purposes subject to shop drawing review:

<u>List Equipment Here</u>	<u>List Manufacturer Here</u>
Spiral Ductwork	Spiral Pipe of Texas, Lewis & Lambert
Boiler	Peerless Purefire
Grilles, Registers, Diffusers	Price Industries
Louvers	Ruskin

## SPECIFICATIONS – MECHANICAL

### 1. Section 22 0719 – Plumbing Piping Insulation

- A. Replace 3.02 Installation, paragraph "G" with the following:
  - G. All new and existing Domestic water piping in the basement Mechanical Room 119 shall receive PVC jacket on the fittings only. All existing domestic water piping in (Shower, Locker 118, Storage 117, Locker 116, Hall 115, Practice 113, Office 112, Boys Locker & Shower 110, Office 108, Girls Locker & Shower 107 and Office 108) shall receive PVC jacket on both the fittings and the piping to protect the insulation from damage.

### 2. Section 23 0719 – HVAC Piping Insulation

- A. Replace 3.02 Installation, paragraph "H" with the following:
  - H. All new and existing hydronic piping in the basement (Mechanical Room 119 & Mechanical 106) shall receive PVC jacket on the fittings only. All existing hydronic piping in (Shower, Locker 118, Locker 116, Hall 115, Practice 113 & Office 112) shall receive PVC jacket on both the fittings and the piping to protect the insulation from damage.

- A. Change the 3.03 Heating System insulation schedule to the following:
  - New Glycol Heating Supply and Return (PGHWS & PGHWR) above Grade:
    - Above Grade Application – Glass Fiber Insulation:
      - Pipe Size Range: Up to 1-1/2", 1-1/2 inch thickness.
      - Pipe Size Range: 2 inch and over, 2 inch thickness.
  - Existing Glycol Heating Supply and Return (PGHWS & PGHWR) above Grade:
    - Above Grade Application – Glass Fiber Insulation:
      - Pipe Size Range: Up to 4", 1 inch thickness.

**DRAWINGS – MECHANICAL**

**1. Sheet M4.1 – Symbols, Schedules and Details**

- A. Under the Mechanical Equipment Schedule for Boiler Type 1 & 2 (B-1, B-2), change verbiage from “stainless steel vertical fire tube design” to “stainless steel water tube design”.
- B. Remove Condensing Unit Sheet Note #9. For clarification CU-1 serving the Locker Rooms shall be provided with a digital scroll lead compressor, CU-2 serving the Gym shall not be provided with a digital scroll lead compressor. CU-2 shall be provided with hot gas bypass on the lead compressor.

**DRAWINGS – ELECTRICAL**

**1. Sheet E2.2 – First Floor Plan - Electrical**

- A. Existing fire alarm horn/strobe outside of Storage 240 in Gym 236 will need to be removed and re-installed in same location to accommodate new door being installed for Storage 240. Extend fire alarm circuit as necessary.

END OF ADDENDUM