

TCEP No.: 439-050-13

## **ADDENDUM NO. 2**

The Architect/ Engineer issues this addendum, applicable to the above named project, to all known Contractors before receipt of proposal.

This addendum includes Item Number 2-1 thru 2-25. This addendum item shall be fully incorporated into the Bidding/Contract Documents and have the same force and effect as though originally included.

The Bidder shall acknowledge receipt of this Addendum No. 2 on the Bid Proposal Form in the place provided.

### **GENERAL**

#### **Drawings**

**Item 2-1: Refer to Sheet G0.00 Title Sheet & Drawing Index**

Insert newly issued sheet F1.21 Interior Signage under Interior Finishes

### **ARCHITECTURAL**

#### **Specifications**

**Item 2-2: Section 08 41 13 ALUMINUM-FRAMED ENTRANCES AND STOREFRONTS**

Refer to paragraph 2.4, A, 1. Omit sub-paragraph a. Thermal Construction: High-Performance plastic connectors separate aluminum members exposed to the exterior from members exposed to the interior.

Thermally broken aluminum doors are not required.

**Item 2-3: Section 08 44 13 - GLAZED ALUMINUM CURTAIN WALLS**

Insert new section, Section 08 44 13 - GLAZED ALUMINUM CURTAIN WALLS in its entirety.

**Item 2-4: Section 08 71 00 DOOR HARDWARE**

Refer to Paragraph 3.7, DOOR-HARDWARE SCHEDULE. Based on performance specs & subject to terms and conditions of the specifications, the following is an approved door closer manufacturer:

Sargent 351 Series Powerglide Door Closer

**Item 2-5: Section 10 14 00 – Signage**

This section has been revised and reissued in its entirety as part of this Addendum.

TCEP No.: 439-050-13

**Item 2-6: Section 12 36 23 PLASTIC-LAMINATE-CLAD COUNTERTOPS**

- Refer to paragraph 2.1, H. Modify Core Thickness to 1"
- Refer to paragraph 2.1, H. Omit Subparagraph H.1 reading " Build up countertop thickness to 1-1/2 inches at front, back, and ends with additional layers of core material laminated to top.
- Refer to paragraph 2.1, PLASTIC-LAMINATE COUNTERTOPS. Omit paragraph J

**Drawings**

**Item 2-7: Refer to Sheet A1.12 – Wall Sections**

Refer to MAIN LEVEL FLOOR PLAN; Modify plan as indicated in SDA-013.

**Item 2-8: Refer to Sheet A1.30 – Lower Level Reflected Ceiling Plan**

Refer to ceilings tagged as INFILL APC. It is the intention that this ceiling be installed from grid & panels salvaged during demolition (or at the contractors option, new grid can be supplied for INFILL APC, so long that the width & finish match, and visual continuity with the EXISTING APC is maintained). Infill grid should align with EXISTING APC that was not removed as part of demolition.

**Item 2-9: Refer to Sheet A1.31 – Main Level Reflected Ceiling Plan**

- Refer to ceilings tagged as INFILL APC. It is the intention that this ceiling be installed from grid & panels salvaged during demolition (or at the contractors option, new grid can be supplied for INFILL APC, so long that the width & finish match, and visual continuity with the EXISTING APC is maintained). Infill grid should align with EXISTING APC that was not removed as part of demolition.
- Refer to clouded window frame / GPDW cove at north side of communicating stair; modify plan as indicated in SDA-010.

**Item 2-10: Refer to Sheet A1.32 – Upper Level Reflected Ceiling Plan**

Refer to ceilings tagged as INFILL APC. It is the intention that this ceiling be installed from grid & panels salvaged during demolition (or at the contractors option, new grid can be supplied for INFILL APC, so long that the width & finish match, and visual continuity with the EXISTING APC is maintained). Infill grid should align with EXISTING APC that was not removed as part of demolition.

**Item 2-11: Refer to Sheet A4.10 – Wall Sections**

- Refer to 1/A4.10 WALL SECTION, revise note referencing aluminum storefront to read: ALUM. FRAME CURTAIN WALL WINDOW SYSTEM W/ 1" INSULATING GLASS; PROVIDE MINIMAL NOMINAL MULLION DEPTH TO ACOMODATE HEIGHT.
- Refer to 4/A4.10 WALL SECTION; Modify section as indicated in SDA-011.
- Refer to 6/A4.10 WALL SECTION; Modify section as indicated in SDA-014.

TCEP No.: 439-050-13

**Item 2-12: Refer to Sheet A5.10 – Vertical Circulation Enlarged Plans**

- Refer to 5/A5.10 - ENLARGED STAIR PLAN - COMMUNICATING STAIR MAIN LEVEL; modify plan as indicated in SDA-009.
- Refer to 3/A5.10 ENLARGED STAIR PLAN - SOUTH STAIR MAIN LEVEL, revise note referencing aluminum storefront to read: ALUM. FRAME CURTAIN WALL WINDOW SYSTEM W/ 1" INSULATING GLASS; PROVIDE MINIMAL NOMINAL MULLION DEPTH TO ACOMODATE HEIGHT.

**Item 2-13: Refer to Sheet A5.21 – Vertical Circulation Sections - Communicating Stair**

Sheet reissued in its entirety. Note clouded area modifications to stud wall assembly surrounding existing communicating stair, new solid surface wall caps, existing hollow metal window frame to remain with new glazing panels.

**Item 2-14: Refer to Sheet A5.22 – Vertical Circulation Sections - Communicating Stair**

Sheet reissued in its entirety. Note clouded area modifications to stud wall assembly surrounding existing communicating stair, new solid surface wall caps, existing hollow metal window frame to remain with new glazing panels.

**Item 2-15: Refer to Sheet A5.23 – Vertical Circulation Sections - Communicating Stair**

Sheet reissued in its entirety. Note clouded area modifications to stud wall assembly surrounding existing communicating stair, new solid surface wall caps, existing hollow metal window frame to remain with new glazing panels.

**Item 2-16: Refer to Sheet A6.21 – Interior Elevations**

Refer to 16/A6.21 ENTRANCE ALCOVE 110 (EAST); modify elevation as indicated in SDA-015.

**Item 2-17: Refer to Sheet A6.22 – Interior Elevations**

Refer to 1/A6.22 LOBBY 103 (SOUTH); modify elevation as indicated in SDA-012.

**Item 2-18: Refer to Sheets A6.40 – Door Schedule, Door Types, Frame Types**

- Refer to HOLLOW METAL FRAME TYPES; add hollow metal frame HMF-7 as indicated in SDA-008.
- Refer to the DOOR SCHEDULE; modify frame type of doors 001A, 004 & 037 from HMF-3 to HMF-1.

**Item 2-19: Refer to Sheet A7.10 – Plan Details**

Sheet reissued in its entirety. Note clouded area modifications to stud wall assembly to accommodate gpdw return / flat screen TV recess.

TCEP No.: 439-050-13

**Item 2-20: Refer to Sheet F1.20 – Interior Signage**

Sheet reissued in its entirety.

**Item 2-21: Refer to Sheet F1.21 – Interior Signage**

Insert newly issued sheet .

**STRUCTURAL**

**Specifications**

**Item 2-22: Section 05 12 00 – STRUCTURAL STEEL FRAMING**

- Refer to paragraph 2.9, A. Replace with the following: “Testing Agency: The Owner shall employ and the General Contractor shall coordinate with a qualified testing agency to perform shop tests and inspections.”
- Refer to paragraph 3.5, A. Replace with the following: “Special Inspections: The Owner shall employ and the General Contractor shall coordinate with a qualified special inspector to perform the following inspections:”
- Refer to paragraph 3.5, B. Replace with the following: “Testing Agency: The Owner shall employ and the General Contractor shall coordinate with a qualified testing agency to perform tests and inspections.”

**Drawings**

**Item 2-23: Sheet S1.01 – Structural Plans**

Sheet re-issued in its entirety.

Footing & Foundation Plan – Elevator. Note clouded area modifications at north wall of new elevator shaft. Column was added to support elevator rail.

Roof Framing Plan – Elevator. Note clouded area modifications at roof area north of new elevator shaft.

Details 1 and 2 have been added to this sheet

**Item 2-24: Sheet S2.01 – Structural Details**

Replace Detail 8 with revised Detail 8 shown on attached Supplemental Drawing SDS-001.

TCEP No.: 439-050-13

## **ELECTRICAL**

### **Drawings**

**Item 2-25: Refer to Sheet E1.01 – Main & Upper Level Lighting Plans**

Refer to Entrance Alcove 110. A display cabinet is being included as part of this addendum to be included in the construction of the east wall. Include in the top of the recess a recessed LED fixture: Focal Point FTRL AC LL1 L35 1C 120 LD1 XF FL WH 8'. Circuit the fixture with the normal lighting in Alcove 110.

END OF ADDENDUM NO. 2

TCEP No.: 439-050-13

## **SECTION 08 44 13 - GLAZED ALUMINUM CURTAIN WALLS**

### **PART 1 - GENERAL**

#### **1.1 RELATED DOCUMENTS**

- A. Drawings and general provisions of the Contract, including General and Supplementary Conditions and Division 01 Specification Sections, apply to this Section.

#### **1.2 SUMMARY**

- A. Section includes glazed aluminum curtain walls.

#### **1.3 PREINSTALLATION MEETINGS**

- A. Preinstallation Conference: Conduct conference at Project site.

#### **1.4 ACTION SUBMITTALS**

- A. Product Data: For each type of product.
  - 1. Include construction details, material descriptions, dimensions of individual components and profiles, and finishes.
- B. Shop Drawings: For glazed aluminum curtain walls. Include plans, elevations, sections, full-size details, and attachments to other work.
  - 1. Include details of provisions for assembly expansion and contraction and for draining moisture occurring within the assembly to the exterior.
  - 2. Include full-size isometric details of each vertical-to-horizontal intersection of glazed aluminum curtain walls, showing the following:
    - a. Joinery, including concealed welds.
    - b. Anchorage.
    - c. Expansion provisions.
    - d. Glazing.
    - e. Flashing and drainage.
  - 3. Show connection to and continuity with adjacent thermal, weather, air, and vapor barriers.
- C. Samples for Verification: For each type of exposed finish required, in manufacturer's standard sizes.

TCEP No.: 439-050-13

- D. Fabrication Sample: Of each vertical-to-horizontal intersection of assemblies, made from 12-inch lengths of full-size components and showing details of the following:
  - 1. Joinery, including concealed welds.
  - 2. Anchorage.
  - 3. Expansion provisions.
  - 4. Glazing.
  - 5. Flashing and drainage.
  
- E. Delegated-Design Submittal: For glazed aluminum curtain walls indicated to comply with performance requirements and design criteria, including analysis data signed and sealed by the qualified professional engineer responsible for their preparation.

#### 1.5 INFORMATIONAL SUBMITTALS

- A. Qualification Data: For Installer.
  
- B. Energy Performance Certificates: For glazed aluminum curtain walls, accessories, and components from manufacturer.
  - 1. Basis for Certification: NFRC-certified energy performance values for each glazed aluminum curtain wall.
  
- C. Product Test Reports: For glazed aluminum curtain walls, for tests performed by a qualified testing agency.
  
- D. Source quality-control reports.
  
- E. Field quality-control reports.
  
- F. Sample Warranties: For special warranties.

#### 1.6 CLOSEOUT SUBMITTALS

- A. Maintenance Data: For glazed aluminum curtain walls to include in maintenance manuals.

#### 1.7 QUALITY ASSURANCE

- A. Installer Qualifications: An entity that employs installers and supervisors who are trained and approved by manufacturer.

TCEP No.: 439-050-13

- B. Product Options: Information on Drawings and in Specifications establishes requirements for aesthetic effects and performance characteristics of assemblies. Aesthetic effects are indicated by dimensions, arrangements, alignment, and profiles of components and assemblies as they relate to sightlines, to one another, and to adjoining construction.
  - 1. Do not change intended aesthetic effects, as judged solely by Architect, except with Architect's approval. If changes are proposed, submit comprehensive explanatory data to Architect for review.

## 1.8 WARRANTY

- A. Special Assembly Warranty: Manufacturer agrees to repair or replace components of glazed aluminum curtain wall that do not comply with requirements or that fail in materials or workmanship within specified warranty period.
  - 1. Failures include, but are not limited to, the following:
    - a. Structural failures including, but not limited to, excessive deflection.
    - b. Noise or vibration created by wind and thermal and structural movements.
    - c. Deterioration of metals, metal finishes, and other materials beyond normal weathering.
    - d. Water penetration through fixed glazing and framing areas.
    - e. Failure of operating components.
  - 2. Warranty Period: 10 years from date of Substantial Completion.
- B. Special Finish Warranty: Standard form in which manufacturer agrees to repair finishes or replace aluminum that shows evidence of deterioration of factory-applied finishes within specified warranty period.
  - 1. Deterioration includes, but is not limited to, the following:
    - a. Color fading more than 5 Hunter units when tested according to ASTM D 2244.
    - b. Chalking in excess of a No. 8 rating when tested according to ASTM D 4214.
    - c. Cracking, checking, peeling, or failure of paint to adhere to bare metal.
  - 2. Warranty Period: 10 years from date of Substantial Completion.

## PART 2 - PRODUCTS

### 2.1 PERFORMANCE REQUIREMENTS

- A. Delegated Design: Engage a qualified professional engineer to design glazed aluminum curtain walls.

TCEP No.: 439-050-13

- B. General Performance: Comply with performance requirements specified, as determined by testing of glazed aluminum curtain walls representing those indicated for this Project without failure due to defective manufacture, fabrication, installation, or other defects in construction.
1. Glazed aluminum curtain walls shall withstand movements of supporting structure including, but not limited to, story drift, twist, column shortening, long-term creep, and deflection from uniformly distributed and concentrated live loads.
  2. Failure also includes the following:
    - a. Thermal stresses transferring to building structure.
    - b. Glass breakage.
    - c. Noise or vibration created by wind and thermal and structural movements.
    - d. Loosening or weakening of fasteners, attachments, and other components.
    - e. Failure of operating units.
- C. Structural Loads:
1. Wind Loads: As indicated on Drawings.
  2. Other Design Loads: As indicated on Drawings.
- D. Deflection of Framing Members: At design wind pressure, as follows:
1. Deflection Normal to Wall Plane: Limited to edge of glass in a direction perpendicular to glass plane not exceeding  $1/175$  of the glass edge length for each individual glazing lite or an amount that restricts edge deflection of individual glazing lites to  $3/4$  inch, whichever is less.
  2. Deflection Parallel to Glazing Plane: Limited to  $1/360$  of clear span or  $1/8$  inch, whichever is smaller.
  3. Cantilever Deflection: Where framing members overhang an anchor point, as follows:
    - a. Perpendicular to Plane of Wall: No greater than  $1/240$  of clear span plus  $1/4$ -inch for spans greater than 11 feet  $8\text{-}1/4$  inches or  $1/175$  times span, for spans less than 11 feet  $8\text{-}1/4$  inches.
- E. Structural: Test according to ASTM E 330 as follows:
1. When tested at positive and negative wind-load design pressures, assemblies do not evidence deflection exceeding specified limits.
  2. When tested at 150 percent of positive and negative wind-load design pressures, assemblies, including anchorage, do not evidence material failures, structural distress, or permanent deformation of main framing members exceeding 0.2 percent of span.
  3. Test Durations: As required by design wind velocity, but not less than 10 seconds.
- F. Air Infiltration: Test according to ASTM E 283 for infiltration as follows:
1. Fixed Framing and Glass Area:
    - a. Maximum air leakage of 0.06 cfm/sq. ft. at a static-air-pressure differential of 6.24 lbf/sq. ft..

TCEP No.: 439-050-13

- G. Water Penetration under Static Pressure: Test according to ASTM E 331 as follows:
  - 1. No evidence of water penetration through fixed glazing and framing areas when tested according to a minimum static-air-pressure differential of 20 percent of positive wind-load design pressure, but not less than 6.24 lbf/sq. ft..
- H. Energy Performance: Certify and label energy performance according to NFRC as follows:
  - 1. Thermal Transmittance (U-factor): Fixed glazing and framing areas shall have U-factor of not more than 0.45 Btu/sq. ft. x h x deg F as determined according to NFRC 100.
  - 2. Solar Heat Gain Coefficient: Fixed glazing and framing areas shall have a solar heat gain coefficient of no greater than 0.40 as determined according to NFRC 200.
  - 3. Condensation Resistance: Fixed glazing and framing areas shall have an NFRC-certified condensation resistance rating of no less than 15 as determined according to NFRC 500.
- I. Thermal Movements: Allow for thermal movements resulting from ambient and surface temperature changes:
  - 1. Temperature Change: 120 deg F, ambient; 180 deg F, material surfaces.

## 2.2 MANUFACTURERS

- A. Basis-of-Design Product: Subject to compliance with requirements, provide EFCO 5600 2" System (with minimal nominal mullion depth possible) or comparable product by one of the following:
  - 1. Manko Window Systems
  - 2. YKK AP America Inc.
- B. Source Limitations: Obtain all components of curtain wall system, including framing and entrances and accessories, from single manufacturer.

## 2.3 FRAMING

- A. Framing Members: Manufacturer's extruded- or formed-aluminum framing members of thickness required and reinforced as required to support imposed loads.
  - 1. Construction: Thermally broken.
  - 2. Glazing System: Retained mechanically with gaskets on four sides.
  - 3. Glazing Plane: Front.
  - 4. Finish: Clear Anodized. Match Finish of Adjacent Storefront
  - 5. Fabrication Method: Field-fabricated stick system.
- B. Pressure Caps: Manufacturer's standard aluminum components that mechanically retain glazing.
  - 1. Include snap-on aluminum trim that conceals fasteners.

TCEP No.: 439-050-13

- C. Brackets and Reinforcements: Manufacturer's standard high-strength aluminum with nonstaining, nonferrous shims for aligning system components.
- D. Materials:
  - 1. Aluminum: Alloy and temper recommended by manufacturer for type of use and finish indicated.
    - a. Sheet and Plate: ASTM B 209.
    - b. Extruded Bars, Rods, Profiles, and Tubes: ASTM B 221.
    - c. Extruded Structural Pipe and Tubes: ASTM B 429/B 429M.
    - d. Structural Profiles: ASTM B 308/B 308M.
  - 2. Steel Reinforcement: Manufacturer's standard zinc-rich, corrosion-resistant primer complying with SSPC-PS Guide No. 12.00; applied immediately after surface preparation and pretreatment. Select surface preparation methods according to recommendations in SSPC-SP COM, and prepare surfaces according to applicable SSPC standard.
    - a. Structural Shapes, Plates, and Bars: ASTM A 36/A 36M.
    - b. Cold-Rolled Sheet and Strip: ASTM A 1008/A 1008M.
    - c. Hot-Rolled Sheet and Strip: ASTM A 1011/A 1011M.

## 2.4 ENTRANCES

- A. Entrances: Comply with Section 08 41 13 "Aluminum-Framed Entrances and Storefronts."

## 2.5 GLAZING

- A. Glazing: Comply with Section 08 80 00 "Glazing."
- B. Glazing Gaskets: Manufacturer's standard sealed-corner pressure-glazing system of black, resilient elastomeric glazing gaskets, setting blocks, and shims or spacers.
- C. Glazing Sealants: As recommended by manufacturer.
- D. Weatherseal Sealants: ASTM C 920 for Type S; Grade NS; Class 25; Uses NT, G, A, and O; chemically curing silicone formulation that is compatible with structural sealant and other system components with which it comes in contact; recommended by structural-sealant, weatherseal-sealant, and structural-sealant-glazed curtain-wall manufacturers for this use.

TCEP No.: 439-050-13

## 2.6 ACCESSORIES

- A. Fasteners and Accessories: Manufacturer's standard corrosion-resistant, nonstaining, nonbleeding fasteners and accessories compatible with adjacent materials.
  - 1. Use self-locking devices where fasteners are subject to loosening or turning out from thermal and structural movements, wind loads, or vibration.
  - 2. Reinforce members as required to receive fastener threads.
  - 3. Use exposed fasteners with countersunk Phillips screw heads, finished to match framing system.
- B. Anchors: Three-way adjustable anchors with minimum adjustment of 1 inch that accommodate fabrication and installation tolerances in material and finish compatible with adjoining materials and recommended by manufacturer.
  - 1. Concrete and Masonry Inserts: Hot-dip galvanized cast-iron, malleable-iron, or steel inserts complying with ASTM A 123/A 123M or ASTM A 153/A 153M requirements.
- C. Concealed Flashing: Manufacturer's standard corrosion-resistant, nonstaining, nonbleeding flashing compatible with adjacent materials.
- D. Bituminous Paint: Cold-applied asphalt-mastic paint complying with SSPC-Paint 12 requirements except containing no asbestos, formulated for 30-mil thickness per coat.

## 2.7 FABRICATION

- A. Form or extrude aluminum shapes before finishing.
- B. Weld in concealed locations to greatest extent possible to minimize distortion or discoloration of finish. Remove weld spatter and welding oxides from exposed surfaces by descaling or grinding.
- C. Fabricate components that, when assembled, have the following characteristics:
  - 1. Profiles that are sharp, straight, and free of defects or deformations.
  - 2. Accurately fitted joints with ends coped or mitered.
  - 3. Physical and thermal isolation of glazing from framing members.
  - 4. Accommodations for thermal and mechanical movements of glazing and framing to maintain required glazing edge clearances.
  - 5. Provisions for field replacement of glazing from exterior.
  - 6. Fasteners, anchors, and connection devices that are concealed from view to greatest extent possible.

TCEP No.: 439-050-13

- D. Fabricate components to resist water penetration as follows:
  - 1. Internal guttering system or other means to drain water passing joints, condensation occurring within framing members, and moisture migrating within glazed aluminum curtain wall to exterior.
  - 2. Pressure-equalized system or double barrier design with primary air and vapor barrier at interior side of glazed aluminum curtain wall and secondary seal weeped and vented to exterior.
- E. Curtain-Wall Framing: Fabricate components for assembly using manufacturer's standard assembly method.
- F. After fabrication, clearly mark components to identify their locations in Project according to Shop Drawings.

## 2.8 ALUMINUM FINISHES

- A. Clear Anodic Finish: AAMA 611, AA-M12C22A41, Class I, 0.018 mm or thicker.

## PART 3 - EXECUTION

### 3.1 EXAMINATION

- A. Examine areas, with Installer present, for compliance with requirements for installation tolerances and other conditions affecting performance of the Work.
- B. Proceed with installation only after unsatisfactory conditions have been corrected.

### 3.2 PREPARATION

- A. Prepare surfaces that will contact structural sealant according to sealant manufacturer's written instructions to ensure compatibility and adhesion. Preparation includes, but is not limited to, cleaning and priming surfaces.

### 3.3 INSTALLATION

- A. General:
  - 1. Comply with manufacturer's written instructions.
  - 2. Do not install damaged components.
  - 3. Fit joints to produce hairline joints free of burrs and distortion.
  - 4. Rigidly secure nonmovement joints.

TCEP No.: 439-050-13

5. Install anchors with separators and isolators to prevent metal corrosion and electrolytic deterioration and to prevent impeding movement of moving joints.
6. Where welding is required, weld components in concealed locations to minimize distortion or discoloration of finish. Protect glazing surfaces from welding.
7. Seal joints watertight unless otherwise indicated.

B. Metal Protection:

1. Where aluminum is in contact with dissimilar metals, protect against galvanic action by painting contact surfaces with primer, applying sealant or tape, or installing nonconductive spacers as recommended by manufacturer for this purpose.
2. Where aluminum is in contact concrete or masonry, protect against corrosion by painting contact surfaces with bituminous paint.

C. Install components to drain water passing joints, condensation occurring within framing members, and moisture migrating within glazed aluminum curtain wall to exterior.

D. Install components plumb and true in alignment with established lines and grades.

E. Install operable units level and plumb, securely anchored, and without distortion. Adjust weather-stripping contact and hardware movement to produce proper operation.

F. Install glazing as specified in Section 08 80 00 "Glazing."

1. Prepare surfaces that will contact structural sealant according to sealant manufacturer's written instructions to ensure compatibility and adhesion. Preparation includes, but is not limited to, cleaning and priming surfaces.

G. Install weatherseal sealant according to Section 07 92 00 "Joint Sealants" and according to sealant manufacturer's written instructions to produce weatherproof joints. Install joint filler behind sealant as recommended by sealant manufacturer.

### 3.4 ERECTION TOLERANCES

A. Erection Tolerances: Install glazed aluminum curtain walls to comply with the following maximum tolerances:

1. Plumb: 1/8 inch in 10 feet; 1/4 inch in 40 feet.
2. Level: 1/8 inch in 20 feet; 1/4 inch in 40 feet.
3. Alignment:
  - a. Where surfaces abut in line or are separated by reveal or protruding element up to 1/2 inch wide, limit offset from true alignment to 1/16 inch.
  - b. Where surfaces are separated by reveal or protruding element from 1/2 to 1 inch wide, limit offset from true alignment to 1/8 inch.
  - c. Where surfaces are separated by reveal or protruding element of 1 inch wide or more, limit offset from true alignment to 1/4 inch.

TCEP No.: 439-050-13

4. Location: Limit variation from plane to 1/8 inch in 12 feet; 1/2 inch over total length.

### 3.5 FIELD QUALITY CONTROL

- A. Glazed aluminum curtain walls will be considered defective if they do not pass tests and inspections.
- B. Prepare test and inspection reports.

END OF SECTION 08 44 13

TCEP No.: 439-050-13

## **SECTION 10 14 00 - SIGNAGE**

### **1. GENERAL**

#### **1.1 RELATED DOCUMENTS**

- A. Drawings and general provisions of the Contract, including General and Supplementary Conditions and Division 1 Specification Sections, apply to this Section.

#### **1.2 SUMMARY**

- A. This section includes the following types of signs:
  - 1. Basis of Design: ASI Signage Innovations InTouch Interior Series ADA-Ready™ Signs including Tactile Plaque Signs.
  - 2. Basis of Design: ASI Signage Innovations Interior/Exterior LTV Vinyl Series.
  - 3. Basis of Design: ASI Signage Innovations Interior/Exterior LPP Cut Acrylic Series.
  - 4. Basis of Design: ASI Signage Innovations Interior/Exterior LPS Precision Cut Solid Metal Series.
  - 5. Basis of Design: ASI Signage Innovations PAP Series Double-Sided Overhead.

#### **1.3 SUBMITTALS**

- A. General: Submit the following in accordance with Conditions of the Contract and Division 1 Specification Sections.
- B. Product Data: Include Manufacturer's construction details relative to materials, dimensions of individual components, profiles, and finishes for each type of sign required.
- C. Color Chart: Manufacturer's Standard.

#### **1.4 QUALITY ASSURANCE**

- A. Single Source Responsibility: For each separate type of sign required, obtain signs from one source from a single manufacturer.
- B. Design Criteria: The Drawings indicate size, profiles, dimensional requirements, and graphics layout of signs and are based on the specific type and model indicated. Signs by other manufacturers may be considered, provided that deviations in dimensions and profiles are minor and do not change the design concept as judged by the Architect. The burden of proof of equality is on the proposer.

#### **1.5 DELIVERY, STORAGE AND HANDLING**

- A. Deliver components correctly packed to prevent damage.

SIGNAGE

10 14 00 - 1

TCEP No.: 439-050-13

- B. Store in secure areas, out of weather and protected from work of other trades.
- C. Handle IAW Manufacturer's instructions.

## 1.6 WARRANTY

- A. Provide Manufacturer's standard warranty covering manufacturing defects for each particular product specified.

## 2. PRODUCTS

### 2.1 MANUFACTURERS

- A. Basis of Design: ASI Signage Innovations, 6958 North 97<sup>th</sup> Circle, Omaha, NE 68122. Phone: (402) 572-5055. Fax: (402) 572-5155. Representative: Erin Carey / Todd Carey.
- B. Other manufacturers as approved by Addendum during the bidding period.

### 2.2 ASI SIGNAGE INNOVATIONS INTOUCH INTERIOR SERIES ADA-READY SIGNS

- A. Manufacturer's standard ASI Signage Innovations InTouch monolithic tactile plaque sign construction. To meet relevant ADA regulations and requirements indicated for materials, thickness, finish colors designs, shapes, sizes and details of construction. Installed dimensional tolerances to be plus/minus 1/16 inch.
- B. ADA Sign copy to be relieved 1/32" min. From plaque first surface by Manufacturer's standard process. Precisely formed, uniformly opaque text to meet relevant ADA guidelines and the requirements indicated for size, style, spacing, content, position and colors. Text color(s) to be surface applied as abrasion-resistant pigment with satin finish. Embossed graphics to be reinforced by backfilling per Manufacturer's standard process.
- C. ADA Grade 2 Braille to be relieved 1/32" min. from plaque first surface by Manufacturer's standard process. Precisely formed, uniformly opaque graphics to meet relevant ADA guidelines and the requirements indicated for size, style, spacing, content, position and colors. Text color(s) to be surface applied as abrasion-resistant pigment with satin finish. Color to be same as plaque background color. Translation of sign copy to be responsibility of the Manufacturer.
- D. ADA Surface Graphics: Background color(s) shall be surface applied to produce vandal resistant finish. Precisely formed, uniformly opaque graphics to comply with requirements indicated for size, style, content, position and colors.
- E. Finishes shall be water-based, non-toxic, zero-emissions, high temperature cured.
- F. Construction: As indicated on the drawings.

TCEP No.: 439-050-13

- G. Material: As indicated on the drawings.
  - 1. Thickness: As indicated on the drawings.
- H. Size: As indicated on the drawings.
- I. Inhouse™ Updatable Window (Paper Insert Panels): As indicated on the drawings or equal. Text: As indicated on the drawings.
- J. Font: As indicated on the drawings.
- K. Colors.
  - 1. Background Panel Color: To be selected by Architect from Manufacturer's standard colors.
  - 2. Text Color: To be selected by Architect from Manufacturer's standard colors.
  - 3. Symbol Color: To be selected by Architect from Manufacturer's standard colors.
- L. Mounting Method for attachment to GPDW: Vinyl High-Bond Tape (VHB) as recommended by manufacturer for permanent installation.
- M. Mounting Method for attachment to Glass (Sidelights): Vinyl High-Bond Tape (VHB), tape-mounted to glass with manufacturer provided SPM window backer for installation on glass.
- N. Mounting Height: As indicated on the drawings. Install signs within the following tolerances and in accordance with manufacturer's recommendations at heights to conform to Americans with Disabilities Act Accessibility Guidelines (ADAAG) and applicable local amendments and regulations.
  - 1. Interior Signs: Within 1/4 inch vertically and horizontally of intended location.
- O. Location: As indicated on the drawings.
- P. Quantity: As indicated on the drawings.

### 2.3 ASI SIGNAGE INNOVATIONS INTERIOR/EXTERIOR LTV VINYL SERIES

- A. Manufacturer's standard ASI Signage Innovations LTV Vinyl Series film applied to 1/4 inch clear tempered glass. Installed dimensional tolerances to be plus/minus 1/16 inch.
- B. Material: Precision cut vinyl film as indicated on the drawings.
  - 1. Thickness: 2 mil, laminated to 1/4" tempered glass as indicated on the drawings.
  - 2. Finish: High Gloss.
  - 3. Color: To be determined by Architect from manufacturer's standard colors.

TCEP No.: 439-050-13

- C. Text: As indicated on the drawings.
- D. Font: As indicated on the drawings.
- E. Mounting Method: Reverse Application. Self-adhesive material, bonded to clean, smooth, flat, dust and debris surface.
- F. Mounting Height: As indicated on the elevations.
  - 1. Interior Signs: Within 1/4 inch vertically and horizontally of intended location.
- G. Location: As indicated on the drawings.
- H. Quantity: As indicated on the drawings.

#### 2.4 ASI SIGNAGE INNOVATIONS INTERIOR/EXTERIOR LPP CUT ACRYLIC SERIES

- A. Manufacturer's standard ASI Signage Innovations LPP Series cut acrylic letters.
  - 1. Thickness: 1/4" as indicated on the drawings.
  - 2. Finish: High Gloss.
  - 3. Color: To be determined by Architect from manufacturer's standard colors.
  - 4. Size: As indicated on the drawings.
- B. Finishes shall be water-based, non-toxic, zero-emissions, high temperature cured.
- C. Text: See drawings for text and quantity of letters.
- D. Font: As indicated on the drawings.
- E. Mounting Method: As shown on drawings:
  - 1. Flush stud mount for permanent installation.
- F. Mounting Height: As indicated on the elevations.
  - 1. Interior Signs: Within 1/4 inch vertically and horizontally of intended location.
- G. Location: As indicated on the drawings.
- H. Quantity: As indicated on the drawings.

TCEP No.: 439-050-13

## 2.5 ASI SIGNAGE INNOVATIONS INTERIOR LPS PRECISION CUT SOLID METAL SERIES

- A. Manufacturer's standard ASI Signage Innovations LPS Series precision cut solid metal letters.
  - 1. Material: Brushed Aluminum.
  - 2. Thickness: 1/2".
  - 3. Size: As indicated on the drawings.
- B. Text: See drawings for text and quantity of letters.
- C. Font: As indicated on the drawings.
- D. Finishes shall be water-based, non-toxic, zero-emissions, high temperature cured.
- E. Mounting Method: As shown on drawings:
  - 1. Projecting Stud-Mounted for permanent installation. See drawings.
  - 2. Flush Stud-Mounted for permanent installation. See drawings.
- F. Mounting Height: As indicated on the elevations.
  - 1. Interior Signs: Within 1/4 inch vertically and horizontally of intended location.
- G. Location: As indicated on the drawings.
- H. Quantity: As indicated on the drawings.

## 2.1 ASI SIGNAGE INNOVATIONS PAP SERIES DOUBLE-SIDED OVERHEAD SIGNS

- A. Manufacturer's standard ASI Signage Innovations PAP Series Interior overhead and directional signs. To meet relevant ADA regulations and requirements indicated for materials, thickness, finish colors designs, shapes, sizes and details of construction.
  - 1. Material: Closed Cell foam core faced with expanded polystyrene sheet and PVC edgeband. Panels shall be smooth, and free of scratches, blemishes, and other imperfections.
  - 2. Thickness: As indicated on the drawings.
  - 3. Corners: Square as indicated on the drawings.
  - 4. Size: As indicated on the drawings.
- B. Finishes shall be water-based, non-toxic, zero-emissions, high temperature cured.
- C. Text: As indicated on the drawings.
- D. Font: As indicated on the drawings.

SIGNAGE

10 14 00 - 5

TCEP No.: 439-050-13

E. Graphics: As indicated on the drawings.

F. Colors:

1. Panel Color: To be selected by Architect from Manufacturer's standards.
2. Text Color: To be selected by Architect from Manufacturer's standards.
3. Symbol Color: To be selected by Architect from Manufacturer's standards.

G. Installation Method: Overhead.

1. GM6, Twist-Clip for Suspended Ceiling Mount as indicated on the drawings.

H. Mounting Height: As indicated on the drawings. Install signs within the following tolerances and in accordance with manufacturer's recommendations at heights to conform to Americans with Disabilities Act Accessibility Guidelines (ADAAG) and applicable local amendments and regulations.

1. Interior Signs: Within 1/4 inch vertically and horizontally of intended location.

I. Location: As indicated on the drawings.

J. Quantity: As indicated on the drawings.

## 2.2 FINISHES

A. Colors: As selected from the manufacturer's standards.

B. Finishes shall be water-based, non-toxic, zero-emissions, high temperature cured.

## 3. EXECUTION

### 3.1 INSTALLATION

A. General: Locate sign units where indicated, using mounting methods in compliance with the Manufacturer's instructions.

B. Cleaning and Protection: At completion of the installation, clean soiled sign surfaces IAW the Manufacturer's instructions. Protect units from damage until acceptance by the Owner.

END OF SECTION 10 14 00

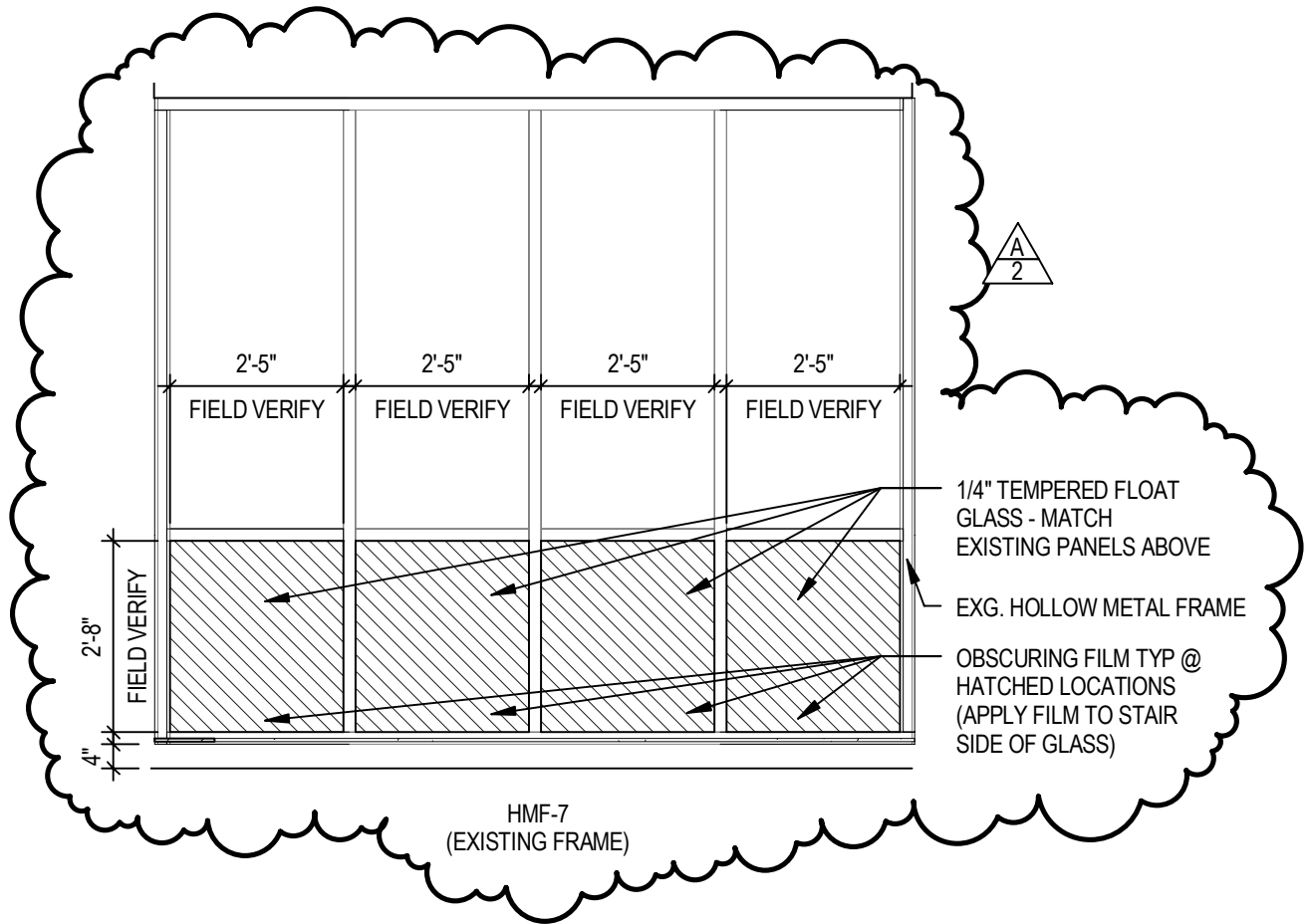

# HOLLOW METAL FRAME TYPES

SCALE: 3/8" = 1'-0"

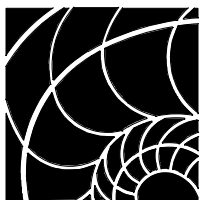

The  
Clark  
Enersen  
Partners

Architecture + Landscape Architecture + Engineering + Interiors  
1010 Lincoln Mall, Suite 200 Lincoln, NE 68508-2883  
402 477.9291 Fax 402 477.6542  
Kansas City, MO Fairway, KS www.clarkenersen.com

Doane College Library Learning Commons  
Crete, Nebraska  
TCEP No.: 439-050-13

Addendum #2  
Supplemental Drawing: SDA-008  
Revision of Sheet: A6.60  
Date: 02/04/14

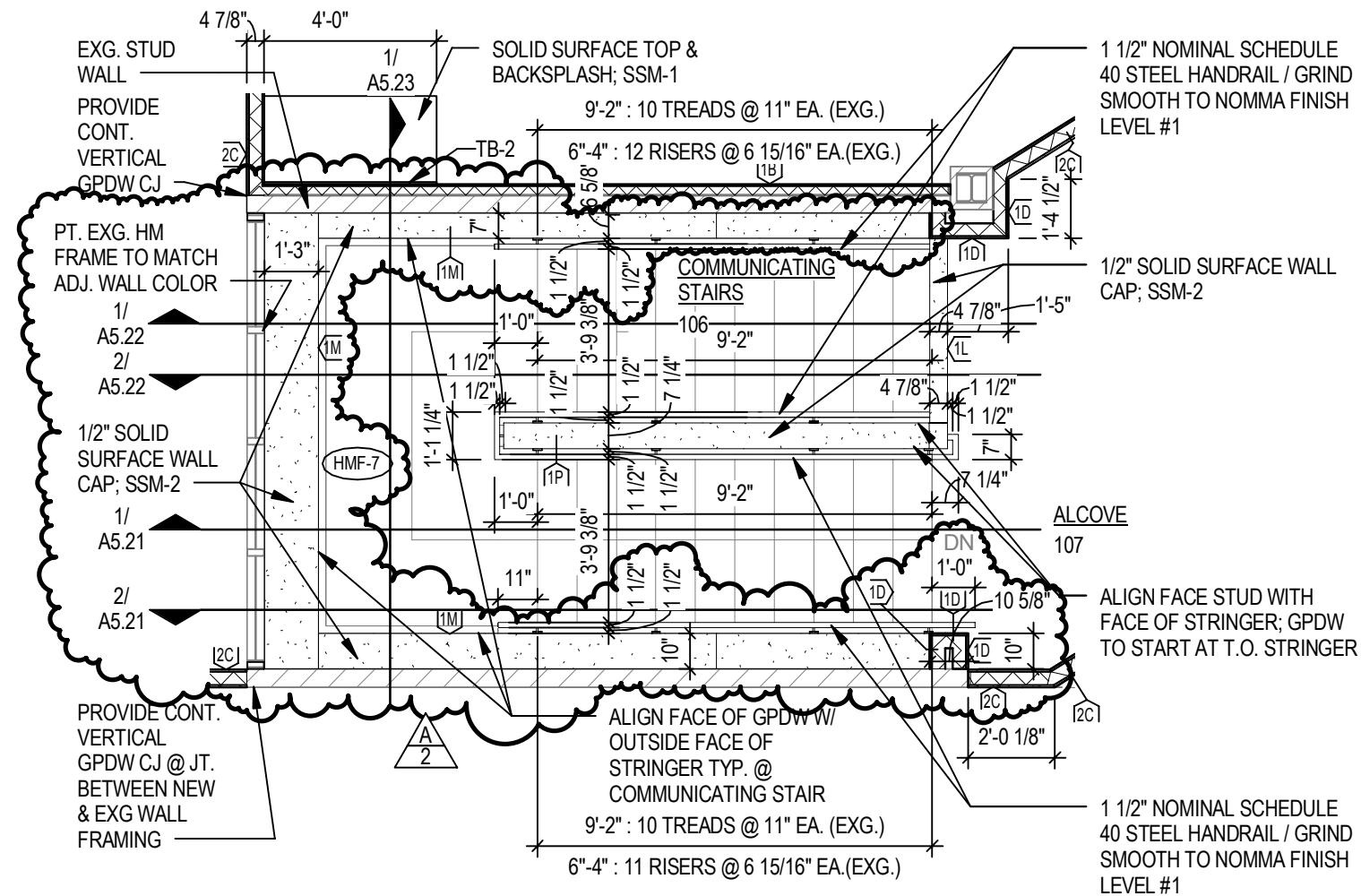

**5**

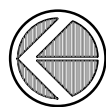

**ENLARGED STAIR PLAN - COMMUNICATING STAIR MAIN LEVEL**

SCALE: 1/4" = 1'-0"

Doane College Library Learning Commons  
Crete, Nebraska  
TCEP No.: 439-050-13

Addendum #2  
Supplemental Drawing: SDA-009  
Revision of Sheet: A5.10  
Date: 02/04/14

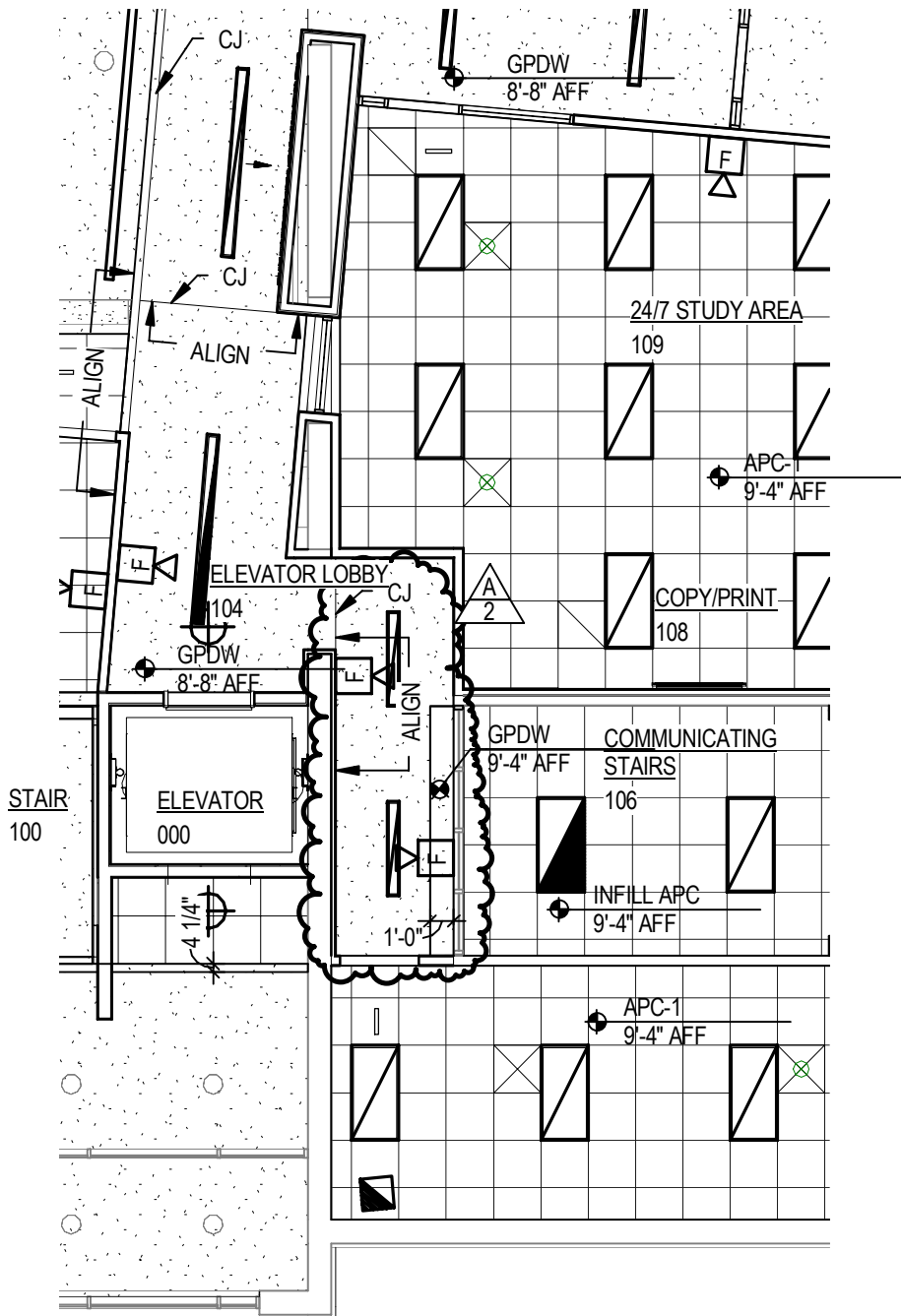

# MAIN LEVEL REFLECTED CEILING PLAN

SCALE: 1/8" = 1'-0"

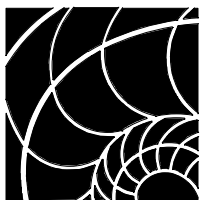

**The  
Clark  
Enersen  
Partners**

Architecture + Landscape Architecture + Engineering + Interiors  
 1010 Lincoln Mall, Suite 200 Lincoln, NE 68508-2883  
 402 477.9291 Fax 402 477.6542  
 Kansas City, MO Fairway, KS www.clarkenersen.com

Doane College Library Learning Commons  
 Crete, Nebraska  
 TCEP No.: 439-050-13

Addendum #2  
 Supplemental Drawing: SDA-010  
 Revision of Sheet: A1.31  
 Date: 02/04/14

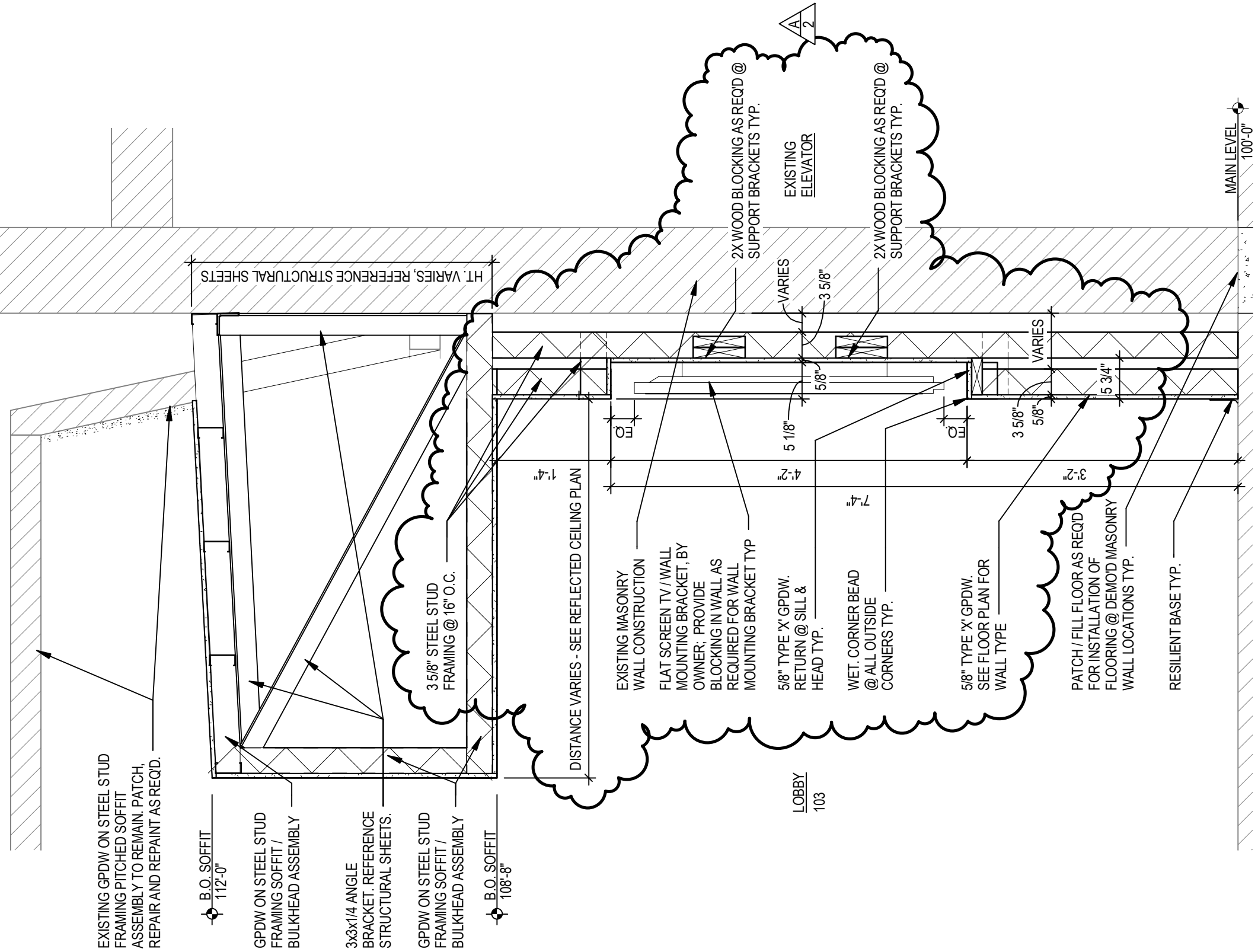

**4 WALL SECTION**  
SCALE: 3/4" = 1'-0"

Doane College Library Learning Commons  
Crete, Nebraska  
TCEP No.: 439-050-13

Addendum #2  
Supplemental Drawing: SDA-011  
Revision of Sheet: A4.10  
Date: 02/04/14

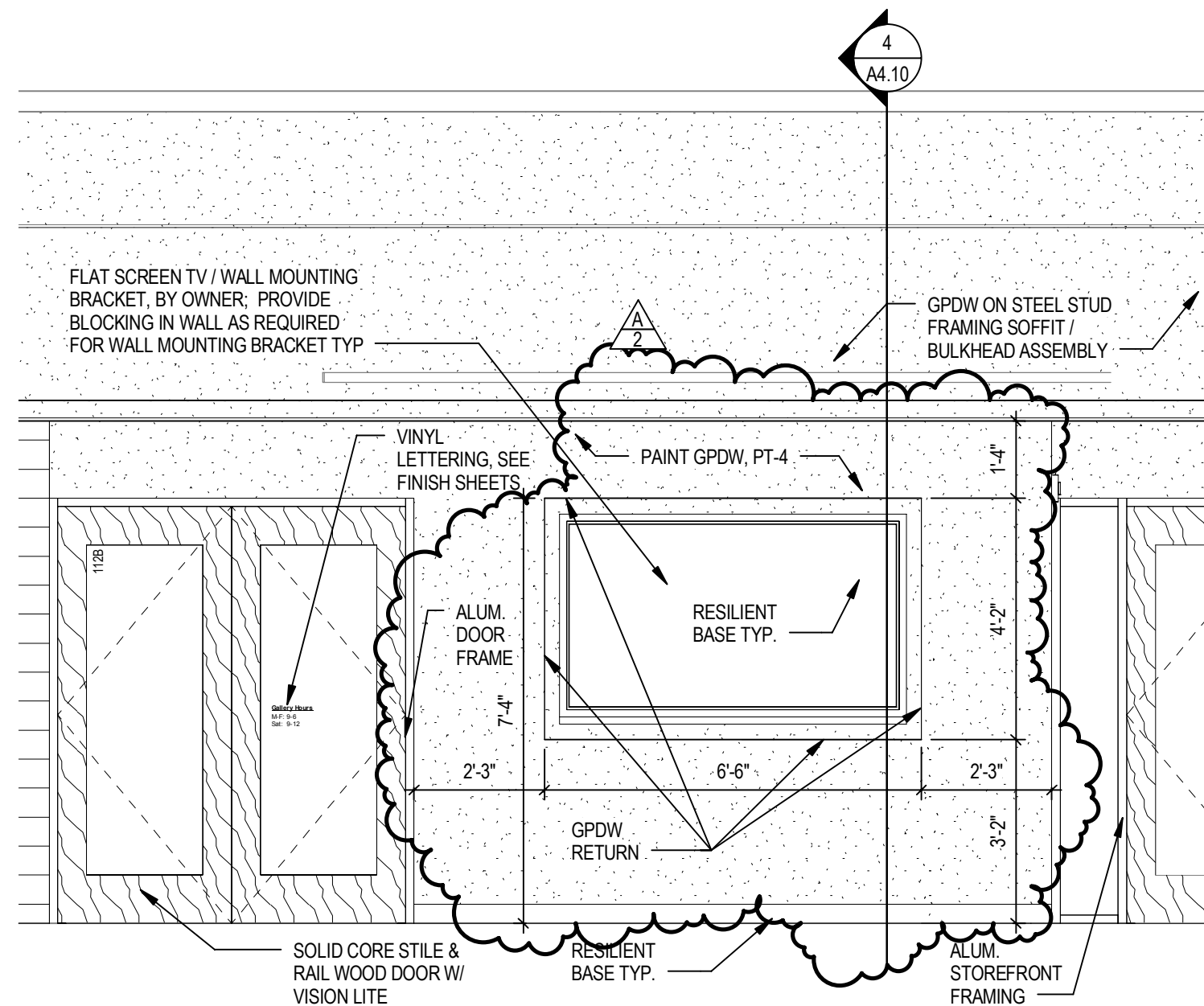

**1 LOBBY 103 (SOUTH)**

SCALE: 3/8" = 1'-0"

Doane College Library Learning Commons  
Crete, Nebraska  
TCEP No.: 439-050-13

Addendum #2  
Supplemental Drawing: SDA-012  
Revision of Sheet: A6.22  
Date: 02/04/14



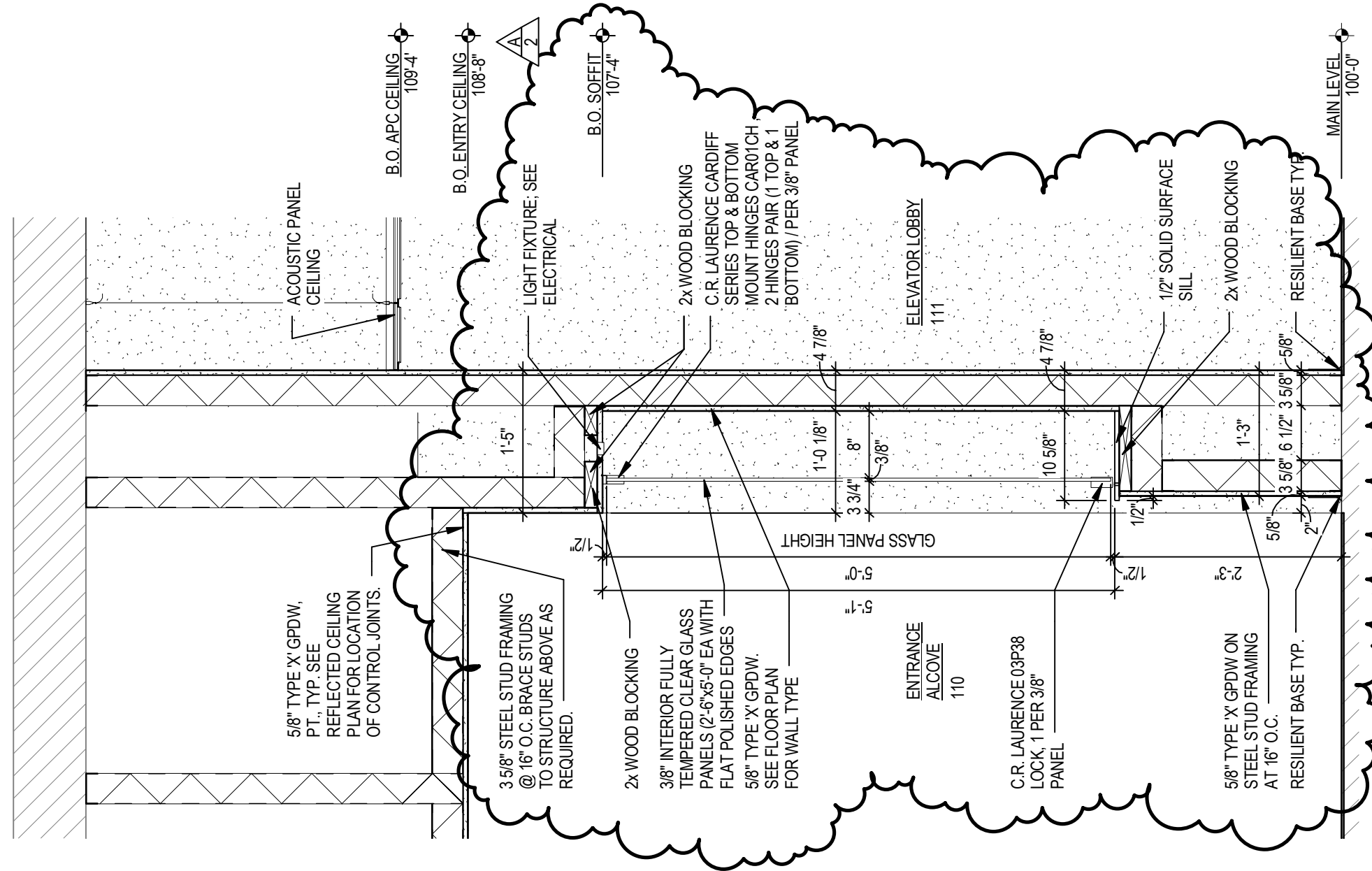

**6 WALL SECTION**

SCALE: 3/4" = 1'-0"

Doane College Library Learning Commons  
Crete, Nebraska  
TCEP No.: 439-050-13

Addendum #2  
Supplemental Drawing: SDA-014  
Revision of Sheet: A4.10  
Date: 02/04/14

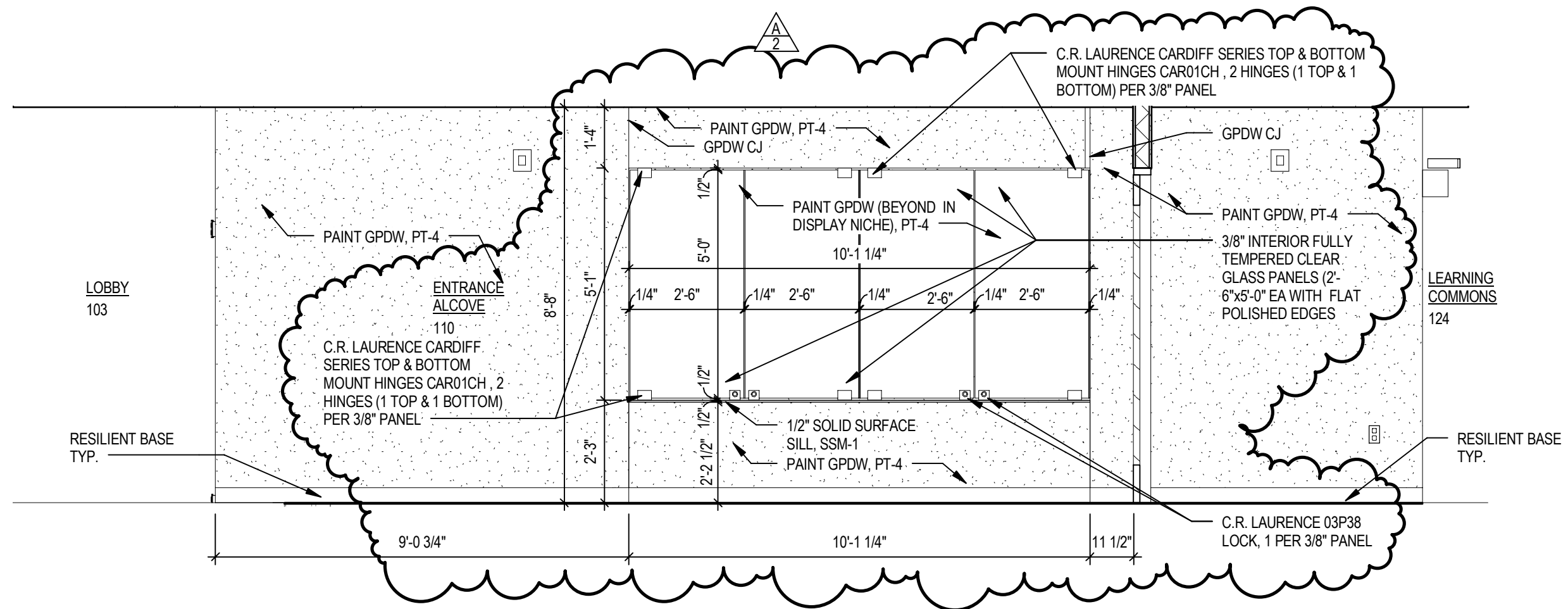

**16** **ENTRANCE ALCOVE 110 (EAST)**

SCALE: 3/8" = 1'-0"

Doane College Library Learning Commons  
Crete, Nebraska  
TCEP No.: 439-050-13

Addendum #2  
Supplemental Drawing: SDA-015  
Revision of Sheet: A6.21  
Date: 02/04/14

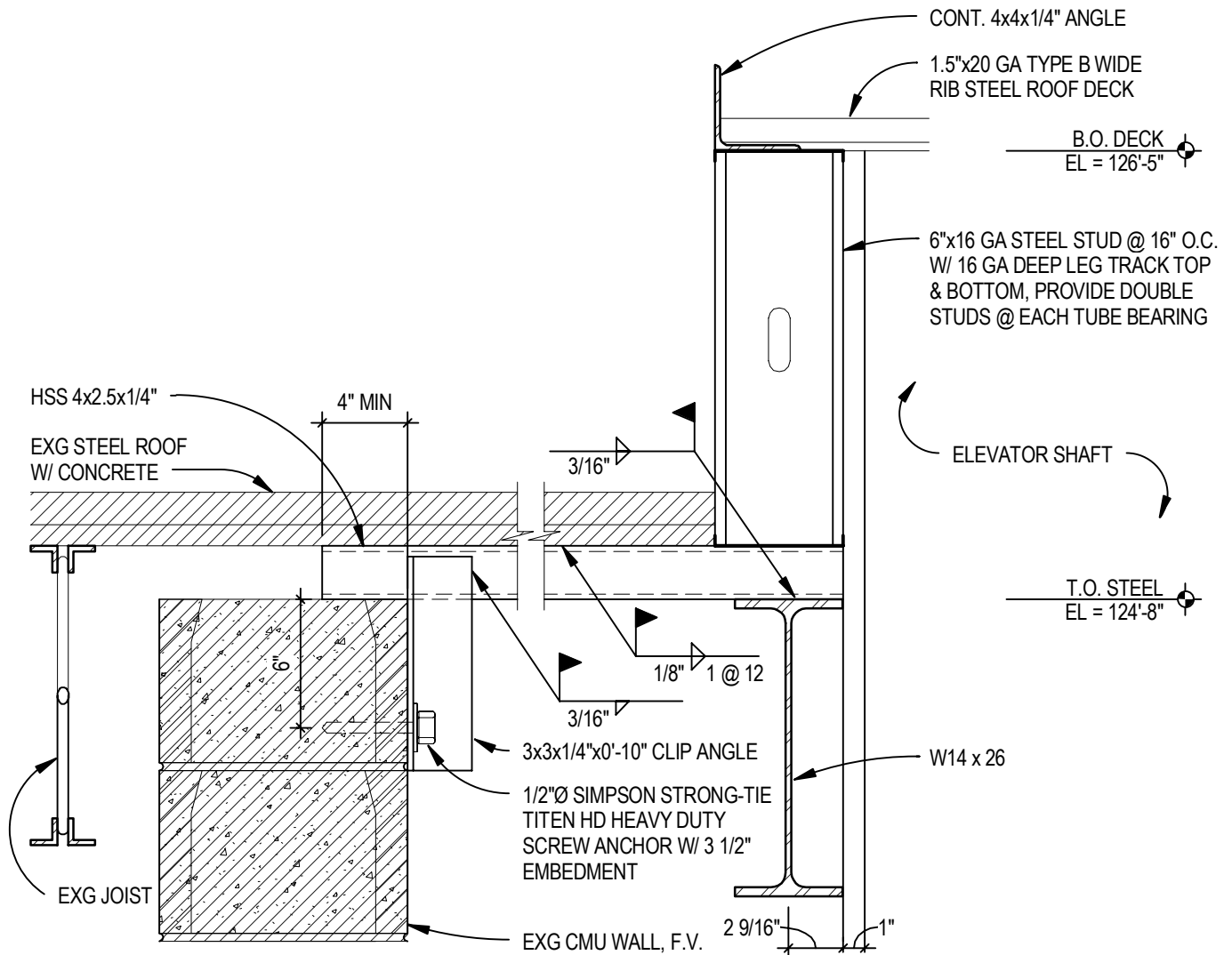

**8 SECTION DETAIL**  
 SCALE: 1 1/2" = 1'-0"

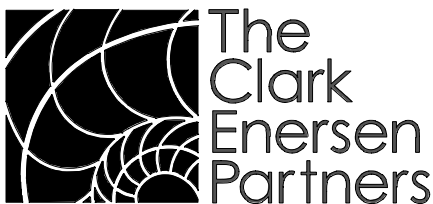

The  
 Clark  
 Enersen  
 Partners

Architecture + Landscape Architecture + Engineering + Interiors  
 1010 Lincoln Mall, Suite 200 Lincoln, NE 68508-2883  
 402 477.9291 Fax 402 477.6542  
 Kansas City, MO Fairway, KS www.clarkenersen.com

Doane College Library Learning Commons  
 Crete, Nebraska  
 TCEP No.: 439-050-13

Addendum #02  
 Supplemental Drawing: SDS-001  
 Revision of Sheet: S2.01  
 Date: 02/04/14

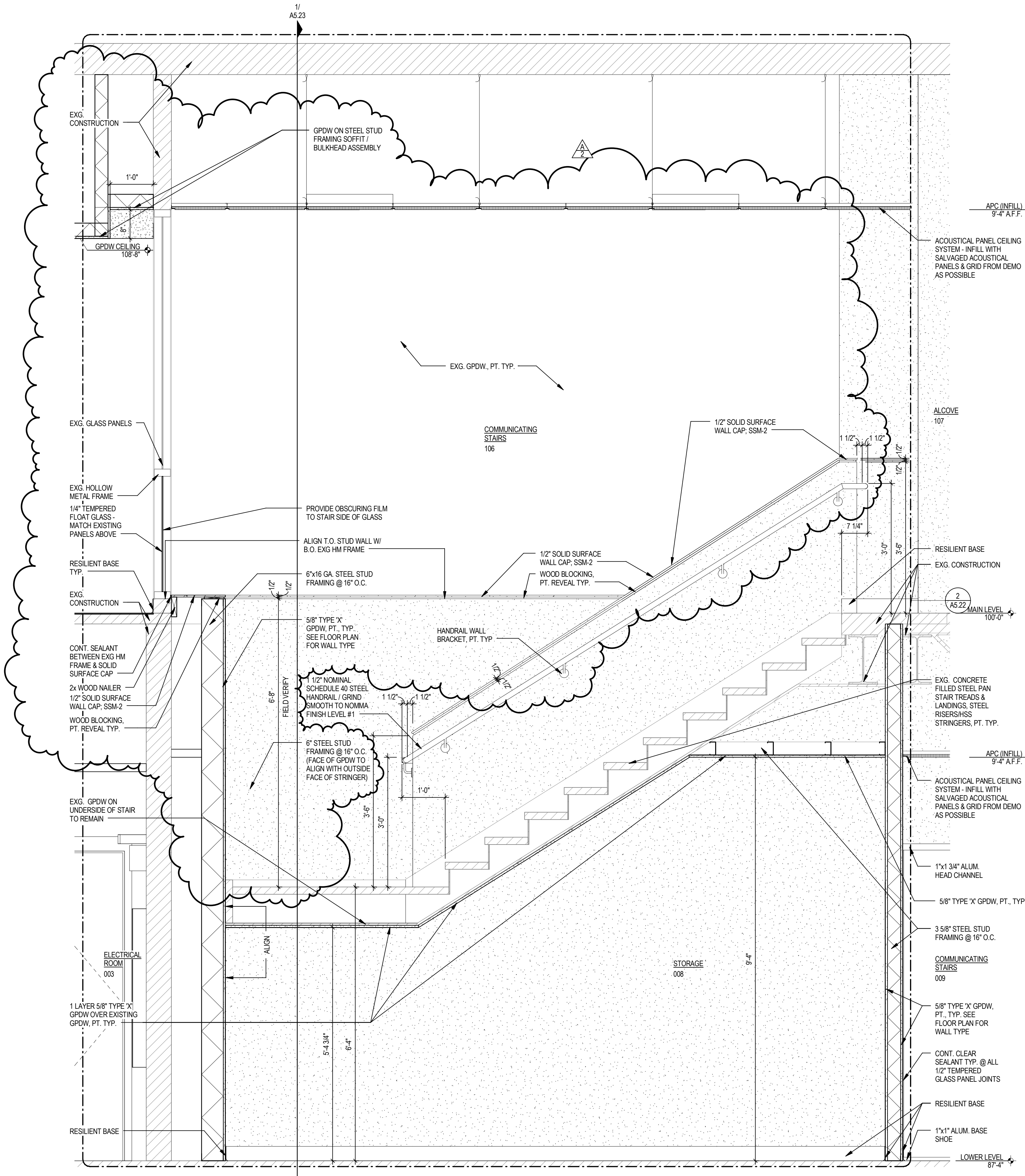

**1 COMMUNICATING STAIR SECTION**  
 SCALE: 3/4" = 1'-0"

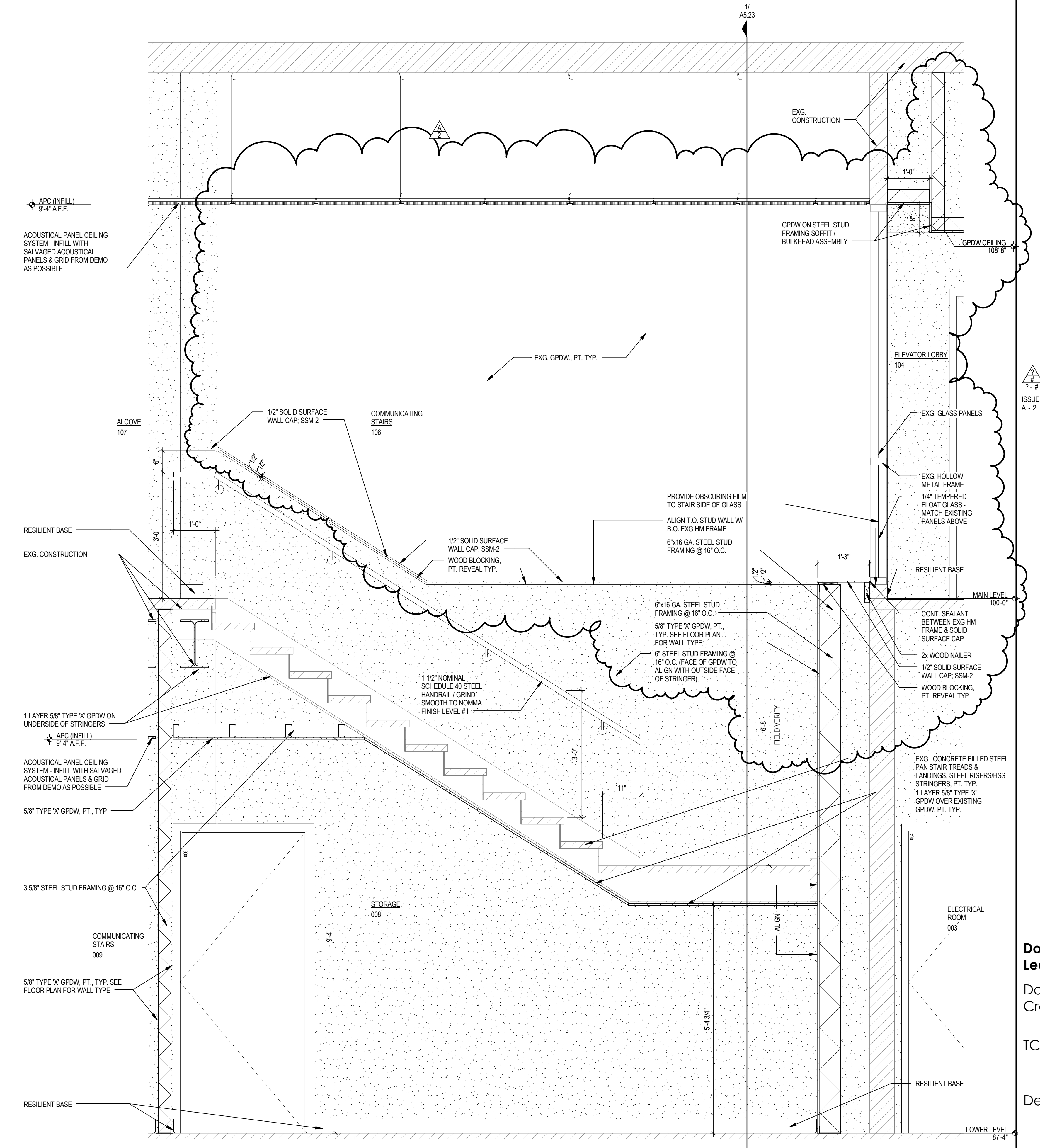

**2 COMMUNICATING STAIR SECTION**  
 SCALE: 3/4" = 1'-0"

**SHEET HISTORY:**

ISSUED	12/20/2013	AS PER CONSTR. DOCUMENTS
A - 2	02/04/14	AS PER ADDENDUM #2

**Doane College Library Learning Commons**  
 Doane College  
 Crete, Nebraska  
 TCEP No.: 439-050-13  
 December 20, 2013

Plot Time Stamp: 2/4/2014 11:51 AM  
 File Location/Name: C:\1\Revit\Projects\2013\439050-DC-A-12\_rick\_pichler.rvt

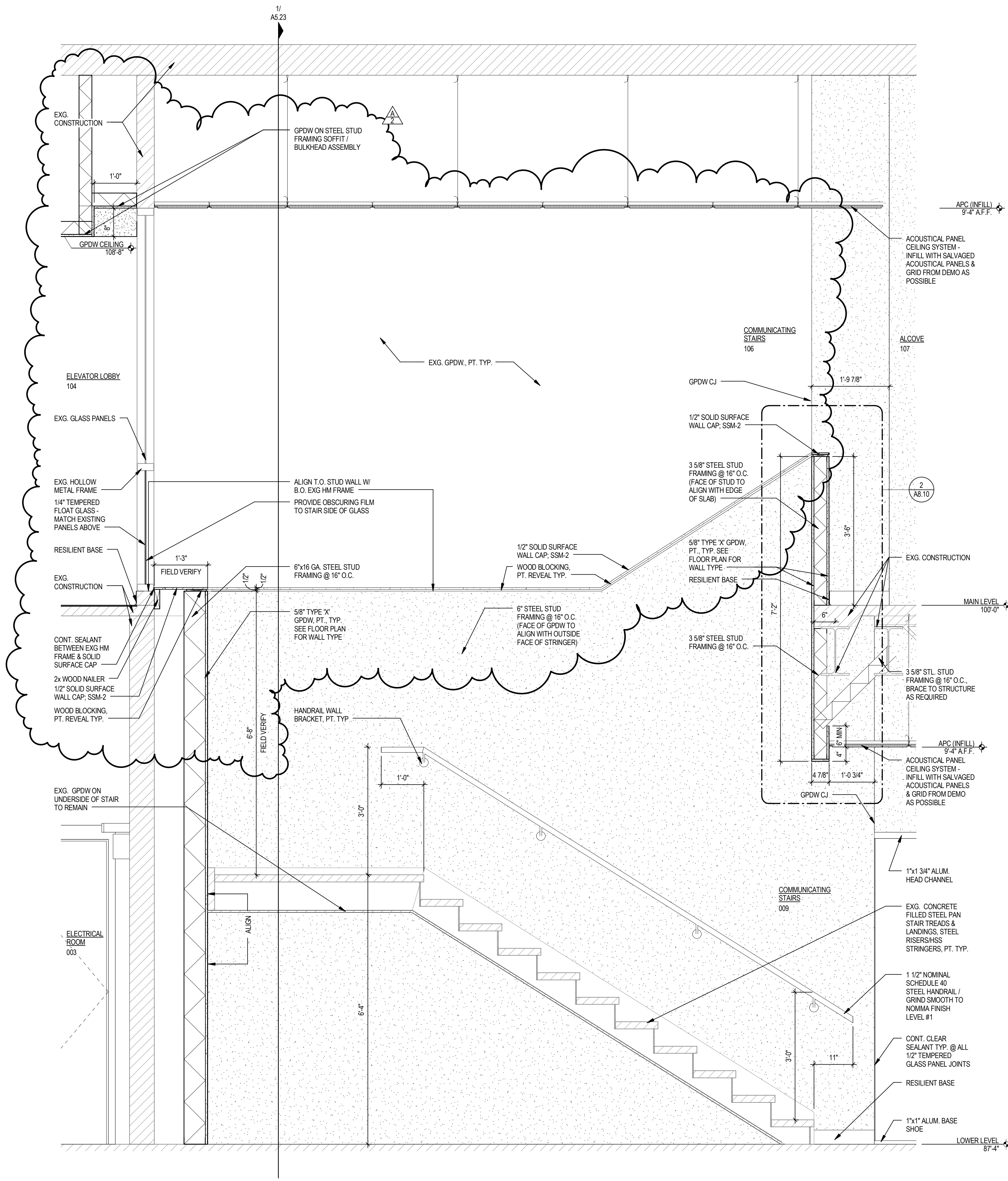

**1 COMMUNICATING STAIR SECTION**  
 SCALE: 3/4" = 1'-0"

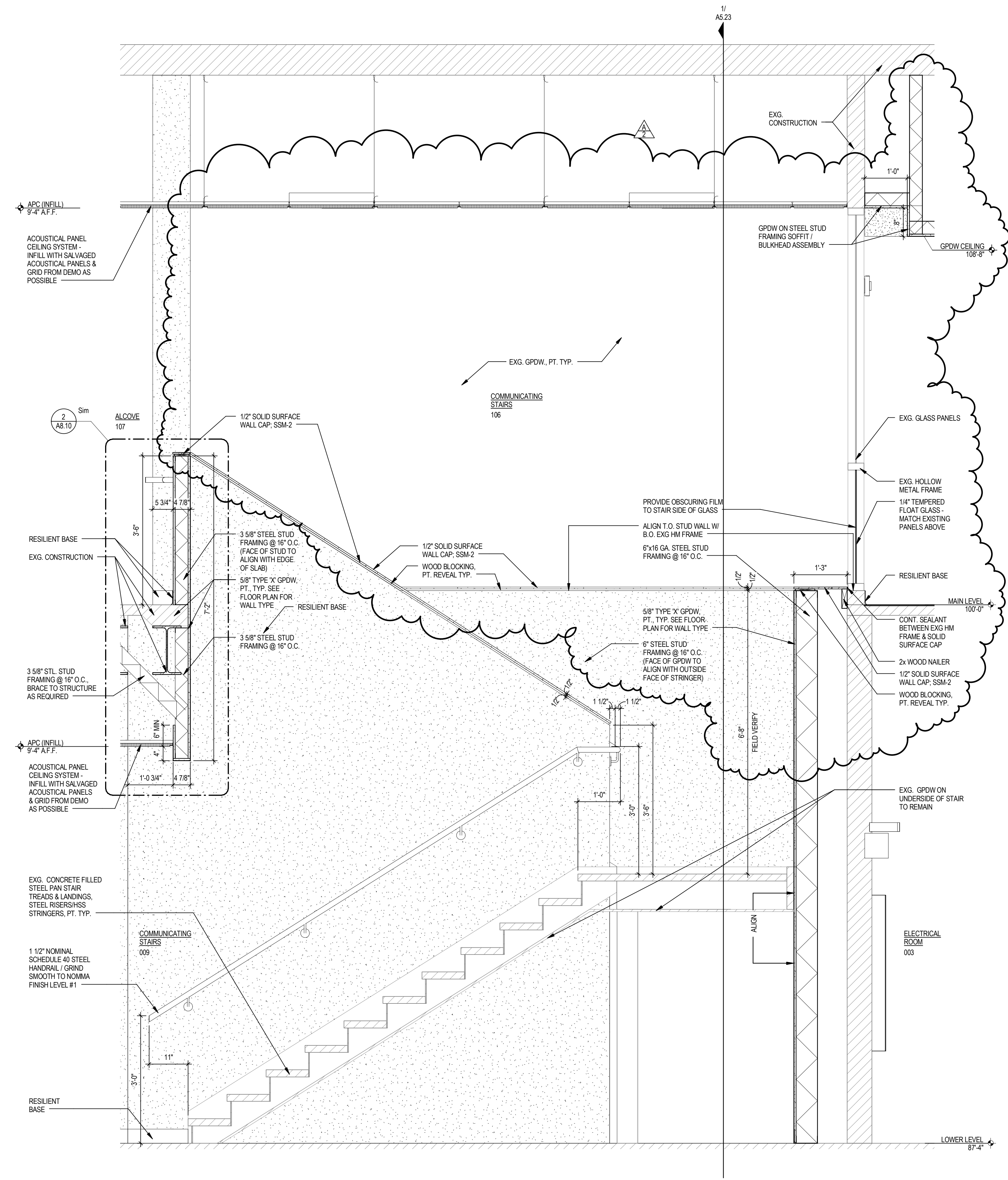

**COMMUNICATING STAIR SECTION**  
 SCALE: 3/4" = 1'-0"

**SHEET HISTORY:**

ISSUED	12/20/2013	AS PER CONSTR. DOCUMENTS
A - 2	02/04/14	AS PER ADDENDUM #2

**Doane College Library Learning Commons**

Doane College  
 Crete, Nebraska

TCEP No.: 439-050-13

December 20, 2013

Vertical Circulation  
 Sections -  
 Communicating Stair

**A5.22**

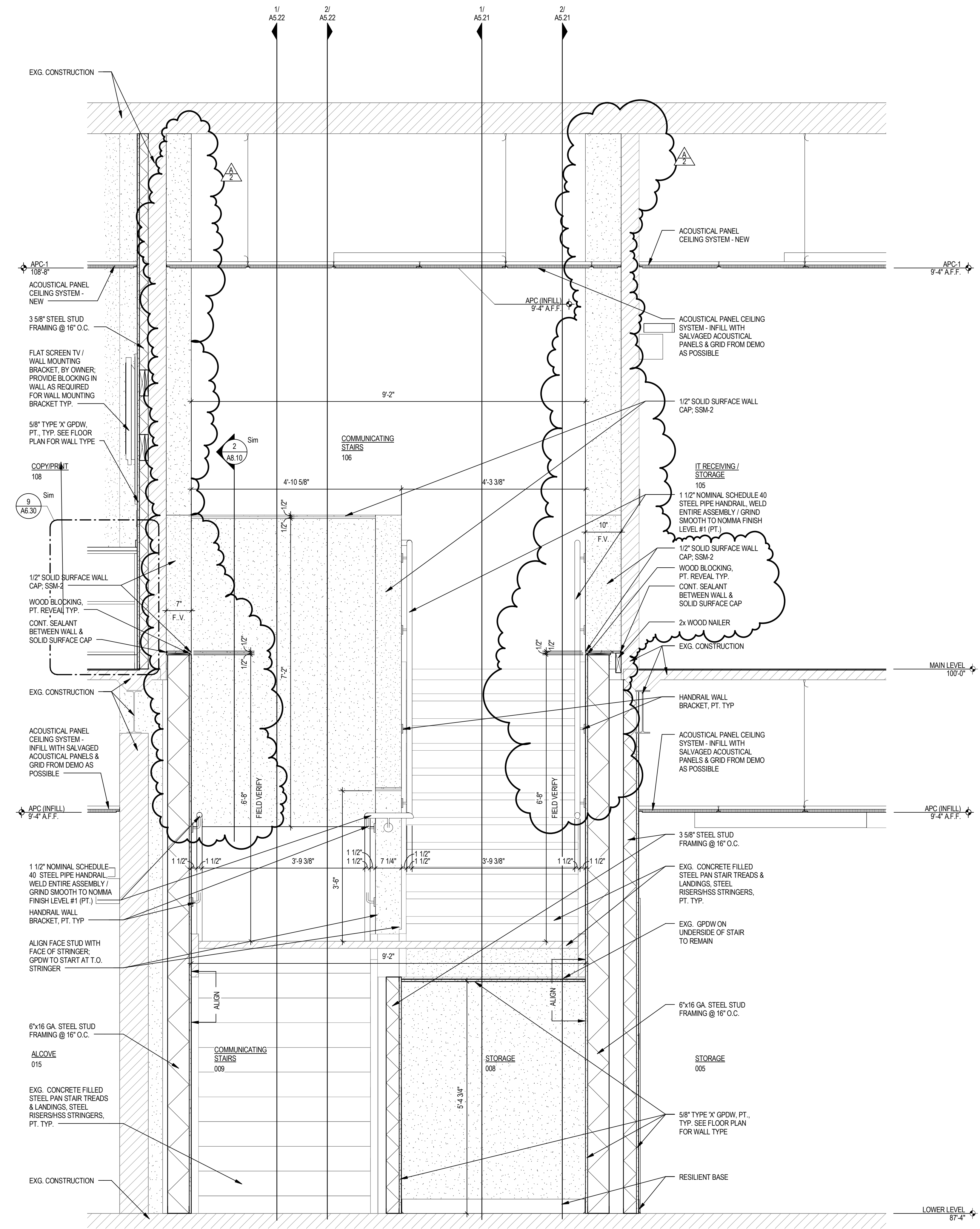

**1 COMMUNICATING STAIR SECTION**  
 SCALE: 3/4" = 1'-0"

**SHEET HISTORY:**

ISSUED	12/20/2013	AS PER CONSTR. DOCUMENTS
A - 2	02/04/14	AS PER ADDENDUM #2

**Doane College Library Learning Commons**  
 Doane College  
 Crete, Nebraska  
 TCEP No.: 439-050-13  
 December 20, 2013

Plot Time Stamp: 2/4/2014 12:06 AM  
 File Location/Name: C:\1\Kevin\Projects\2013\439050-DCC-A-12\_nick\_pischel.rvt





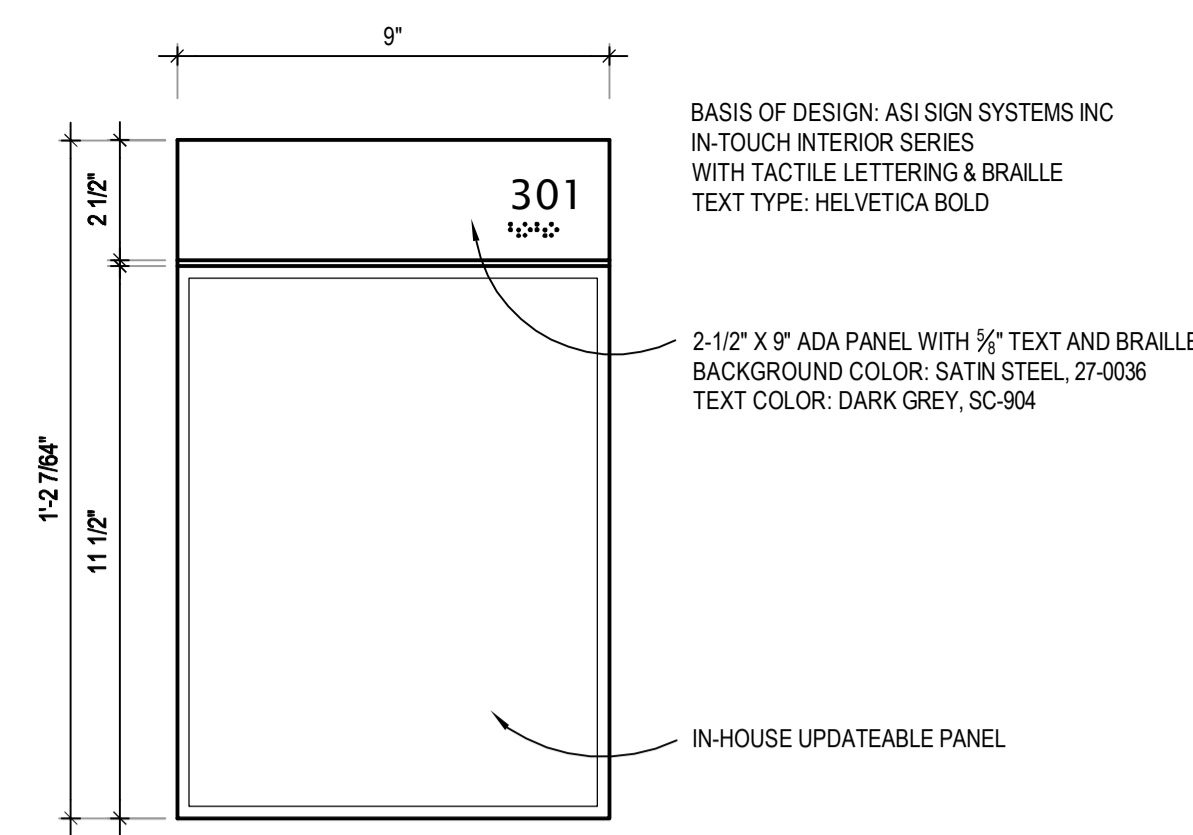

**E SIGN DETAIL (Classroom / Meeting Room)**  
 SCALE: 3/8"=1'-0"

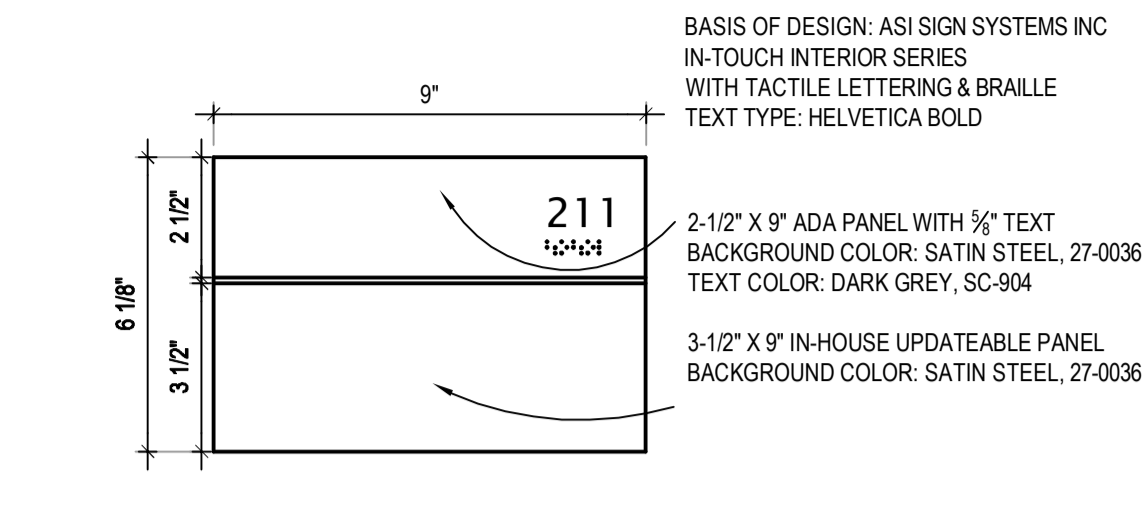

**F SIGN DETAIL**  
 SCALE: 3/8"=1'-0"

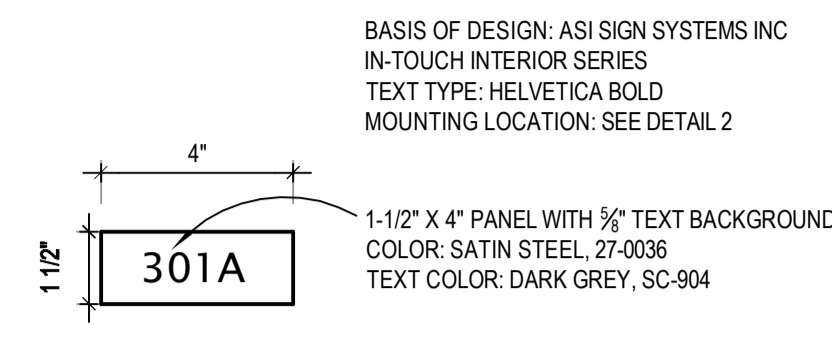

**G SIGN DETAIL**  
 SCALE: 3/8"=1'-0"

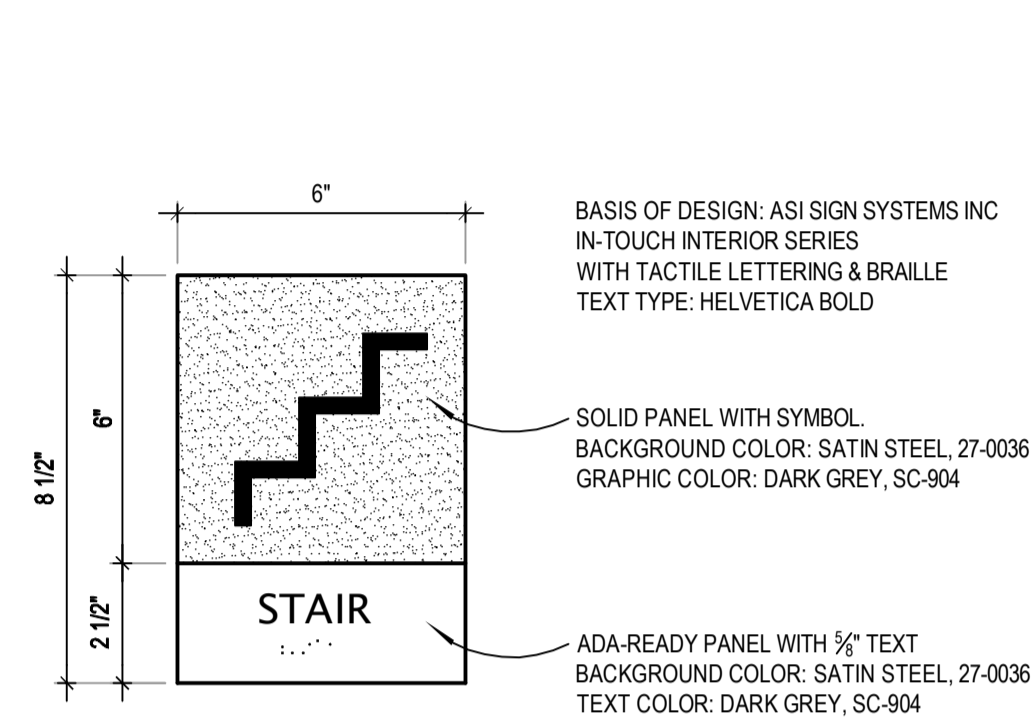

**H SIGN DETAIL**  
 SCALE: 3/8"=1'-0"

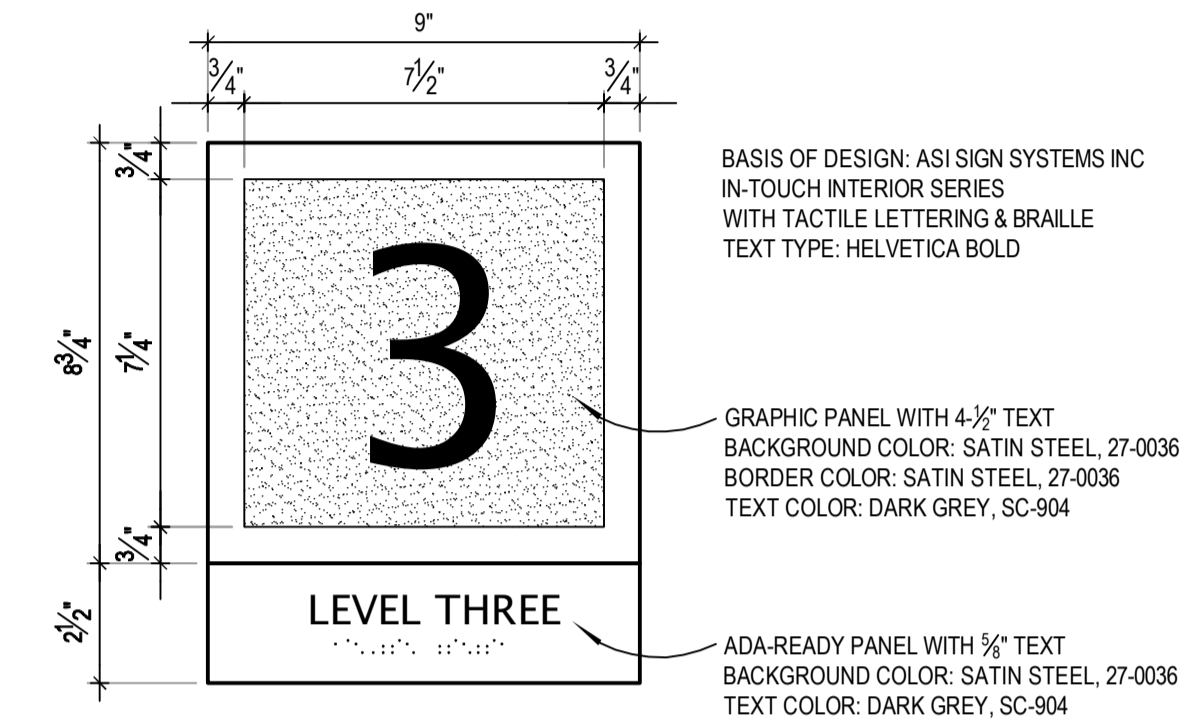

**J SIGN DETAIL**  
 SCALE: 3/8"=1'-0"

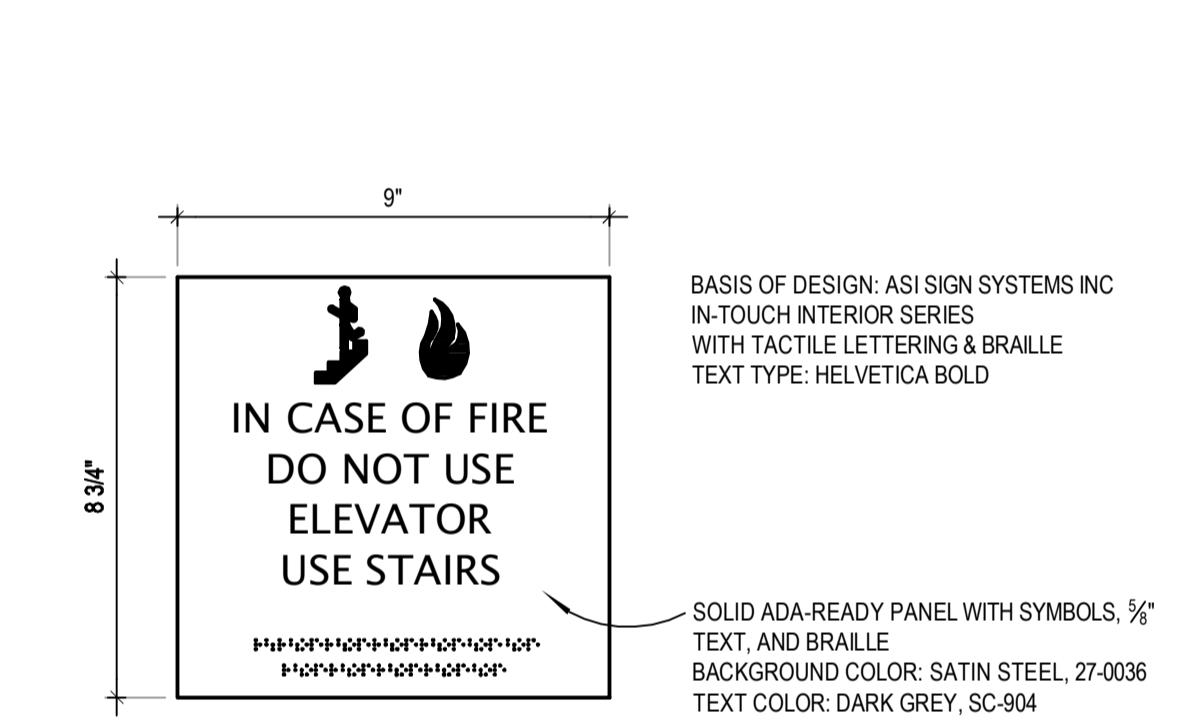

**K SIGN DETAIL**  
 SCALE: 3/8"=1'-0"

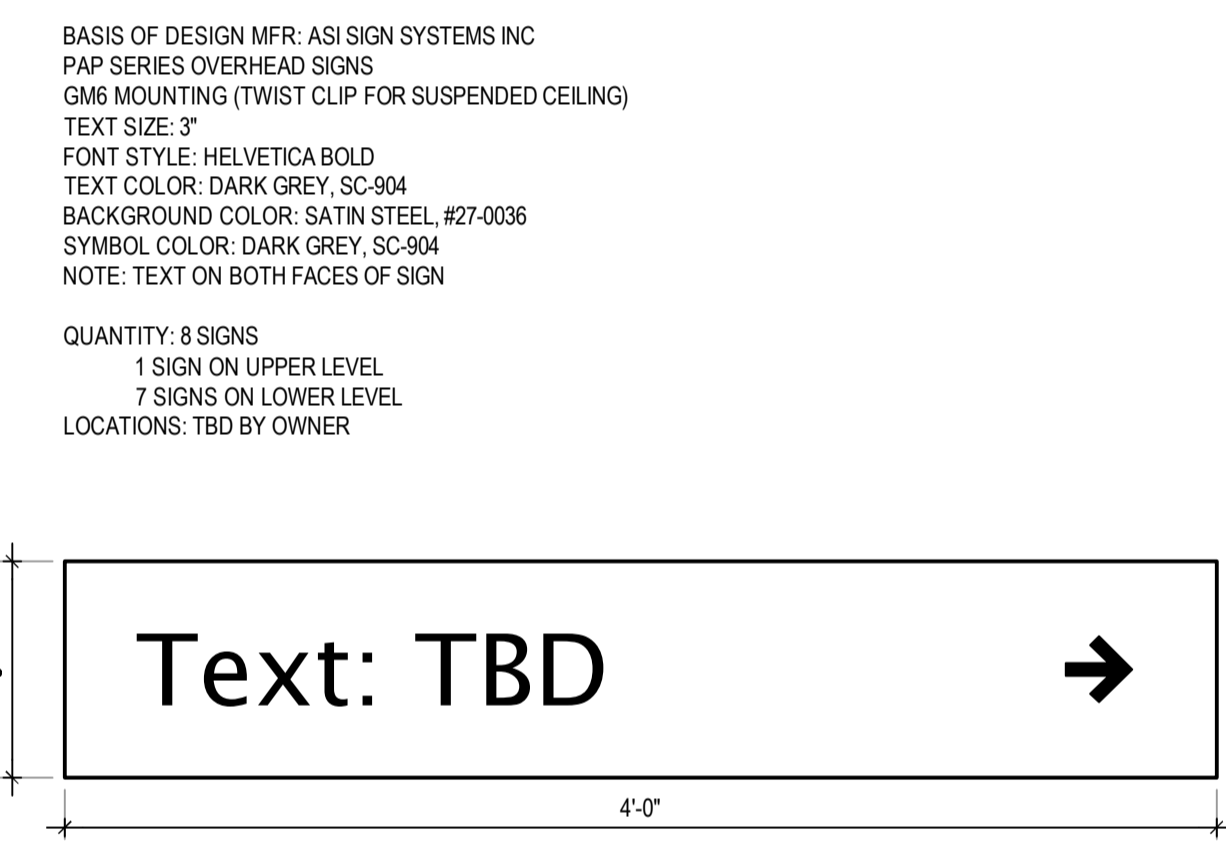

**L SIGN DETAIL**  
 SCALE: 1/4"=1'-0"

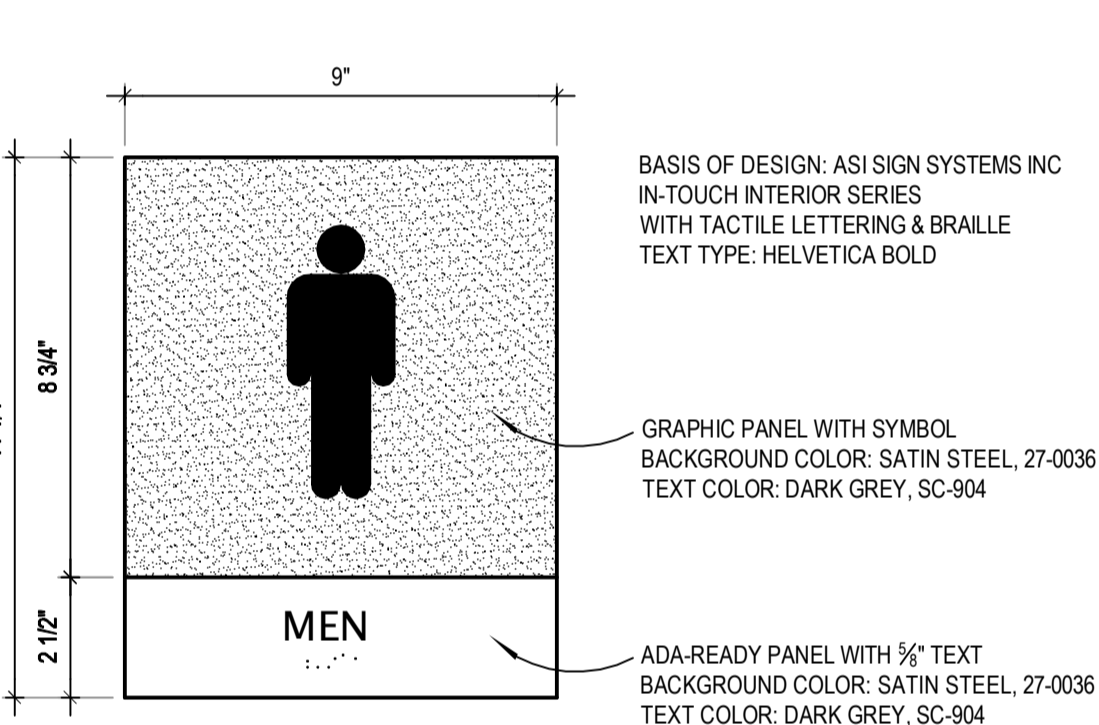

**M SIGN DETAIL**  
 SCALE: 3/8"=1'-0"

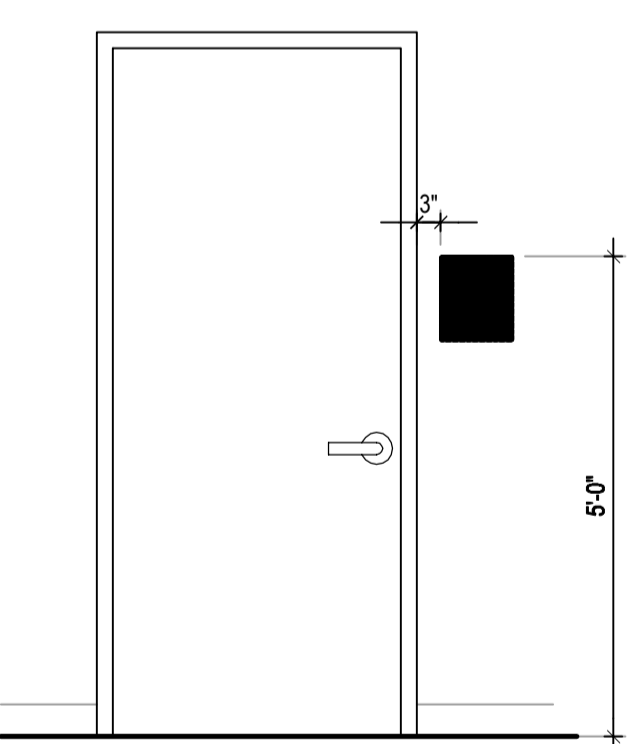

**1 TYPICAL MOUNTING LOCATION**  
 SCALE: 3/8"=1'-0"

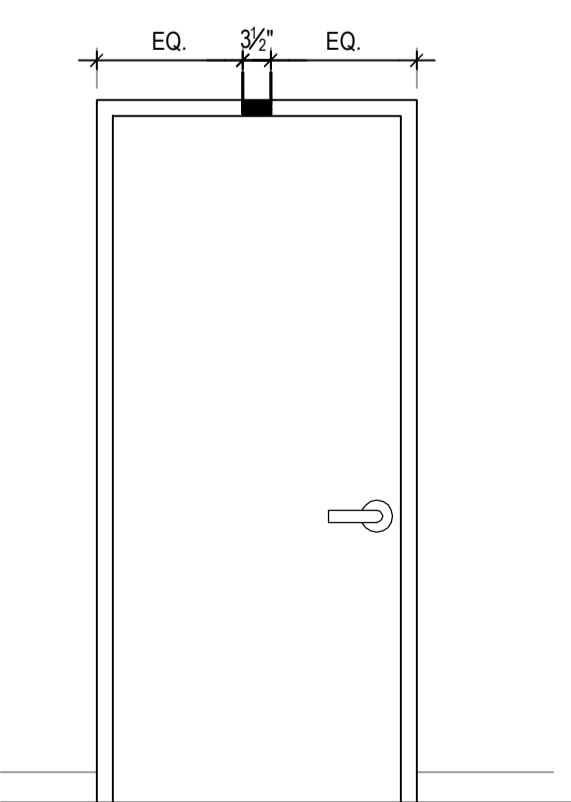

**2 ROOM NUMBER SIGNS: TYPICAL MOUNTING LOCATION**  
 SCALE: 3/8"=1'-0"

**SIGNAGE SCHEDULE**

SIGN NUMBER	SIGN LOCATION ROOM NUMBER ROOM	ROOM NUMBER ON SIGN	SIGN TYPE A	SIGN TYPE B	SIGN TYPE C	SIGN TYPE D	SIGN TYPE E	SIGN TYPE F	SIGN TYPE G	SIGN TYPE H	SIGN TYPE I	SIGN TYPE J	SIGN TYPE K	SIGN TYPE L	SIGN TYPE M	SIGN TYPE N	SIGN TEXT
1	EXG CORRIDOR	-															STAR
2	001 STAIRS	-															MEN
3	001 STAIRS	-															LOWER LEVEL
4	002 CORRIDOR	-															STAR
5	002 CORRIDOR	-															IN CASE OF FIRE DO NOT USE ELEVATOR USE STAIRS
6	002 CORRIDOR	003															ELECTRICAL
7	015 ALCOVE	016															MEETING ROOM
8	006 WORKROOM	008															STORAGE
9	014 OPAC STATIONS	-															STAR
10	014 OPAC STATIONS	007															
11	013 STUDY AREA	010															STUDY ROOM
12	013 STUDY AREA	011															STUDY ROOM
13	013 STUDY AREA	012															STUDY ROOM
14	001 STUDY AREA	-															STAR
15	005 STAIRS	-															LOWER LEVEL
16	000 COLLECTION	027															STUDY ROOM
17	000 COLLECTION	028															STUDY ROOM
18	000 COLLECTION	029															STUDY ROOM
19	006 EXG CORRIDOR	-															STAR
20	007 STAIRS	-															LOWER LEVEL
21	006 EXG CORRIDOR	023															STORAGE
22	020 ALCOVE	021															STUDY ROOM
23	006 EXG CORRIDOR	019															GALLERY STORAGE
24	006 EXG CORRIDOR	041															MECHANICAL
25	006 EXG CORRIDOR	041															MECHANICAL
26	018 ELEVATOR LOBBY	-															GALLERY STORAGE
27	000 COLLECTION	018															ELEVATOR
28	000 COLLECTION	017															STORAGE
29	006 EXG CORRIDOR	002															
30	006 EXG CORRIDOR	-															WOMEN
31	102 EXG CORRIDOR	-															STAR
32	103 LOBBY	-															STAR
33	101 STAR LOBBY	-															FIRST LEVEL
34	104 ELEVATOR LOBBY	-															IN CASE OF FIRE DO NOT USE ELEVATOR USE STAIRS IN CASE OF FIRE DO NOT USE ELEVATOR USE STAIRS
35	103 LOBBY	-															SEE SIGN TYPE C.1
36	110 ENTRANCE ALCOVE	109															247 STUDY AREA
37	104 LEARNING COMMONS	111															ELEVATOR
38	104 LEARNING COMMONS	-															SEE SIGN TYPE B.2
39	129 OPAC STATIONS	109															247 STUDY AREA
40	139 IT SERVICES	103															IT RECEIVING / STORAGE
41	129 OPAC STATIONS	-															SEE SIGN TYPE D.1
42	129 OPAC STATIONS	-															SEE SIGN TYPE D.2
43	128 COPY/PRINT	-															SEE SIGN TYPE C.3
44	130 GENIUS BAR/SERVICE POINT	139															
45	139 IT SERVICES	137															
46	139 IT SERVICES	138															
47	131 HOLDS	136															STAFF WORKROOM
48	131 HOLDS	132															
49	133 CORRIDOR	135															
50	133 CORRIDOR	134															
51	127 CAFE CART	133															
52	125 AUDIOVISUAL COLLECTION	-															STAR
53	126 STAIRS	-															FIRST LEVEL
54	125 AUDIOVISUAL COLLECTION	123															INFORMATION LITERACY
55	125 AUDIOVISUAL COLLECTION	123															INFORMATION LITERACY
56	121 WRITING LAB	122															
57	104 LEARNING COMMONS	121															WRITING LAB
58	119 SOUND VESTIBULE	120															RECORDING STUDIO
59	119 SOUND VESTIBULE	117															MEDIA LAB
60	104 LEARNING COMMONS	120															RECORDING STUDIO
61	104 LEARNING COMMONS	117															MEDIA LAB
62	124 LEARNING COMMONS	118															
63	117 MEDIA LAB	116															AV STORAGE
64	124 LEARNING COMMONS	115															
65	104 LEARNING COMMONS	114															STUDY ROOM
66	112 GALLERY	113															GALLERY WORKROOM
67	103 LOBBY	-															STAR
68	140 STAIRS	-															FIRST LEVEL
69	103 LOBBY	TBD															
70	103 LOBBY	112															PAUL GALLERY
71	103 LOBBY	-															SEE SIGN TYPE C.2
72	103 LOBBY	-															SEE SIGN TYPE B.1
73	111 LOBBY	-															IN CASE OF FIRE DO NOT USE ELEVATOR USE STAIRS
74	202 EXG CORRIDOR	-															STAR
75	202 EXG ELEVATOR LOBBY	-															IN CASE OF FIRE DO NOT USE ELEVATOR USE STAIRS

NOTES:  
 ALL SIGN TEXT SHALL BE CONFIRMED BY OWNER IN SHOP DRAWINGS.

**GENERAL FOUNDATION NOTES:**

2. CONTINUOUS FOOTINGS AND PAD FOOTINGS SHALL BE CONSTRUCTED W/ 3000 PSI CONCRETE (THIS DOES NOT INCLUDE GRADE BEAMS).
3. GRADE BEAMS, STEM WALLS, TOPPING SLABS, SLABS ON GRADE, MECHANICAL PADS, CAST-IN-PLACE WALLS AND COLUMNS SHALL BE CONSTRUCTED W/ 4000 PSI CONCRETE.
4. THE GENERAL CONTRACTOR SHALL VERIFY ALL EXISTING DIMENSIONS AND CONDITIONS PRIOR TO COMMENCEMENT OF THE WORK. IT SHALL BE THE CONTRACTOR'S RESPONSIBILITY TO COORDINATE THE INSTALLATION OF THE NEW WORK WITHIN THE EXISTING CONDITIONS. ANY DEVIATION IN THE EXISTING CONDITIONS OR DIMENSIONS INDICATED SHALL BE COORDINATED WITH THE ENGINEER/ARCHITECT IN ORDER TO MODIFY THE PLAN ACCORDINGLY.
4. INDICATES TOP OF FOOTING ELEVATION.
5. INDICATES TOP OF EXISTING FOOTING ELEVATION.
6. INDICATES STEP IN THE FOUNDATION ELEVATION, TYP.
11. BEFORE STARTING EXCAVATION, ESTABLISH THE LOCATION AND EXTENT OF UNDERGROUND UTILITIES IN THE WORK AREA. EXERCISE CARE TO PROTECT EXISTING UTILITIES DURING EARTHWORK OPERATIONS. PERFORM EXCAVATION WORK NEAR UTILITIES BY HAND AND PROVIDE NECESSARY SHORING AND SUPPORTS AS THE WORK PROGRESSES. SEE SPECIFICATIONS FOR ADDITIONAL REQUIREMENTS REGARDING EXISTING UNDERGROUND UTILITIES. SEE MECHANICAL AND CIVIL/LANDSCAPE DRAWINGS FOR APPROXIMATE LOCATIONS OF EXISTING UTILITIES.
21. A 4" (MIN) THICK GRANULAR BASE LAYER UNDER CLASS A VAPOR BARRIER UNDER THE NEW 4" CONCRETE SLAB ON GRADE IS DETAILED THROUGHOUT THIS SET OF CONSTRUCTION DOCUMENTS. IF THE FLOORING MANUFACTURER (S) RECOMMEND A THICKER LAYER OF GRANULAR MATERIAL OR A MORE STRINGENT TYPE OF VAPOR BARRIER, THEN THEIR RECOMMENDATIONS SHALL BE FOLLOWED. CONTACT CONSTRUCTION MANAGER OR GENERAL CONTRACTOR TO COORDINATE.
22. AT ALL RE-ENTRANT CORNERS IN THE SLAB, PLACE 2x3 x 2x6" LONG DOWELS @ 2' O.C. LOCATE BARS AT MID-DEPTH IN THE SLAB, TYPICAL.

**GENERAL FRAMING NOTES:**

1. THE GENERAL CONTRACTOR SHALL VERIFY ALL EXISTING DIMENSIONS AND CONDITIONS PRIOR TO COMMENCEMENT OF THE WORK. IT SHALL BE THE CONTRACTOR'S RESPONSIBILITY TO COORDINATE THE INSTALLATION OF THE NEW WORK WITHIN THE EXISTING CONDITIONS. ANY DEVIATION IN THE EXISTING CONDITIONS OR DIMENSIONS INDICATED SHALL BE COORDINATED WITH THE ENGINEER / ARCHITECT IN ORDER TO MODIFY THE PLAN ACCORDINGLY.
2. FLOOR DECK ATTACHMENT (1 1/2" - 20 GA - V.L. GALVANIZED COMPOSITE FLOOR DECK): ATTACH DECK TO SUPPORTING MEMBERS PERPENDICULAR TO SPAN OF DECK W/ 5/8" DIA. PUDDLE WELDS AT ALL END LAP VALLEYS, IN SIDE LAP VALLEYS BETWEEN DECK UNITS AND AT ALTERNATE VALLEYS BETWEEN AT SUPPORTING MEMBERS PARALLEL TO DECK SPAN. PLACE WELDS AT 12" O.C. MAXIMUM. ATTACH DECK UNITS TO EACH OTHER WITH #12 SELF-DRILLING, SELF-TAPPING SCREWS @ 12" O.C. MAXIMUM. ATTACH FLOOR DECK TO SUPPORTING CONCRETE USING POWDER ACTUATED FASTENERS WHICH HAVE A MINIMUM DIAMETER OF 0.15" AND A MINIMUM PENETRATION OF 1.5" SPACED AT 6" ON CENTER MAXIMUM AND 2" ON CENTER MINIMUM. THE DISTANCE FROM CENTER OF THE FASTENER TO THE EDGE OF THE CONCRETE SHALL NOT BE LESS THAN 2".
3. ROOF DECK ATTACHMENT (1 1/2" - 20 GA - TYPE B ROOF DECK): ATTACH DECK TO SUPPORTING MEMBERS PERPENDICULAR TO SPAN OF DECK W/ 5/8" DIA. PUDDLE WELDS AT ALL END LAP VALLEYS, IN SIDE LAP VALLEYS BETWEEN DECK UNITS AND ALL VALLEYS BETWEEN AT SUPPORTING MEMBERS PARALLEL TO DECK SPAN. PLACE WELDS AT 12" O.C. MAXIMUM. ATTACH DECK UNITS TO EACH OTHER WITH #10 SELF-DRILLING, SELF-TAPPING SCREWS @ 12" O.C. MAXIMUM.

**GENERAL NOTE:**

FIELD VERIFY CONDITION OF ALL EXISTING STEEL WIDE FLANGE BEAMS THAT SUPPORT NEW STAIR FRAMING. BEAM FLANGES AND WEBS SHALL NOT CONTAIN EXCESSIVE BOLT HOLES FROM PREVIOUS CONNECTIONS. BEAMS SHALL BE REPAIRED AS REQUIRED AT LOCATIONS OF PREVIOUS CONNECTIONS. CONTACT ENGINEER PRIOR TO CONSTRUCTION FOR REPAIR REQUIREMENTS.

ISSUED	DATE	REVISION
A - 02	02/04/04	AS PER ADDENDUM #02

**NEW LINTELS IN EXISTING CONCRETE MASONRY WALLS:**

1. NEW OPENINGS IN CONCRETE MASONRY WALLS ON LOWER LEVEL. SEE SHEETS A0.11 AND A1.11
  - A. NEW 5'-4" WIDE OPENING, TYPICAL 2 PLACES. PROVIDE 2 - W8x18's WITH 8" BEARING AT EACH END. GROUT CELLS FULL HEIGHT AT BEARING
  - B. NEW 3'-4" WIDE OPENING, TYPICAL 1 PLACE. PROVIDE 2 - W8x18's WITH 8" BEARING AT EACH END. GROUT CELLS FULL HEIGHT AT BEARING
2. NEW OPENINGS IN CONCRETE MASONRY WALLS ON MAIN LEVEL. SEE SHEETS A0.13 AND A1.12
  - A. NEW 8'-0" WIDE OPENING, TYPICAL 1 PLACE. PROVIDE W10 x 33 WITH 12" x 11" WIDE TOP FLANGE PLATE WITH 16" BEARING AT EACH END. GROUT CELLS FULL HEIGHT AT BEARING
  - B. NEW 9'-4" WIDE OPENING, TYPICAL 1 PLACE. PROVIDE W10 x 33 WITH 12" x 11" WIDE TOP FLANGE PLATE WITH 16" BEARING AT EACH END. GROUT CELLS FULL HEIGHT AT BEARING
  - C. NEW 5'-4" WIDE OPENING, TYPICAL 1 PLACE. FIELD VERIFY EXISTING LINTEL(S). CONTACT ENGINEER / ARCHITECT IF LINTEL(S) IS NOT OF ADEQUATE WIDTH FOR NEW OPENING
  - D. NEW 6'-0" WIDE OPENING, TYPICAL 1 PLACE. FIELD VERIFY EXISTING LINTEL. CONTACT ENGINEER / ARCHITECT IF LINTEL IS NOT OF ADEQUATE WIDTH FOR NEW OPENING

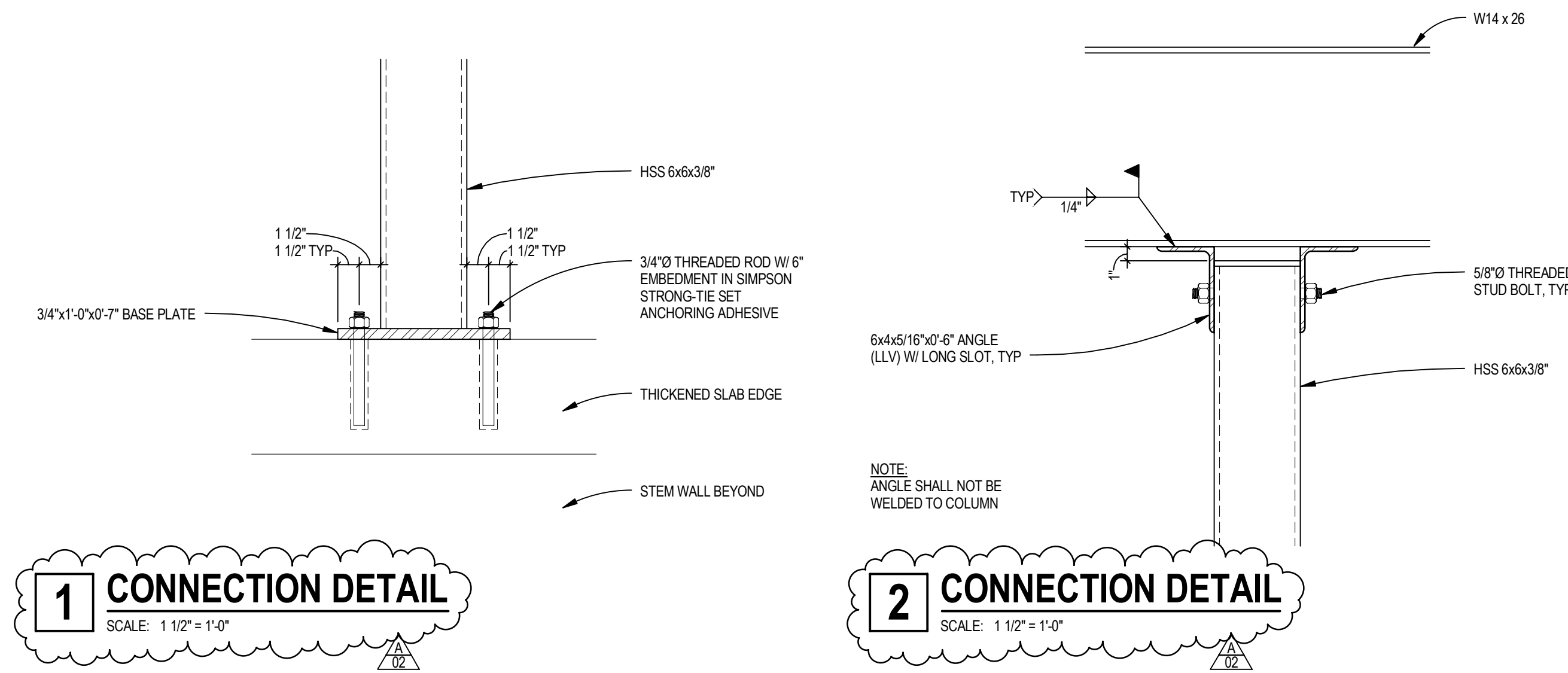

**1 CONNECTION DETAIL**  
SCALE: 1 1/2" = 1'-0"

**2 CONNECTION DETAIL**  
SCALE: 1 1/2" = 1'-0"

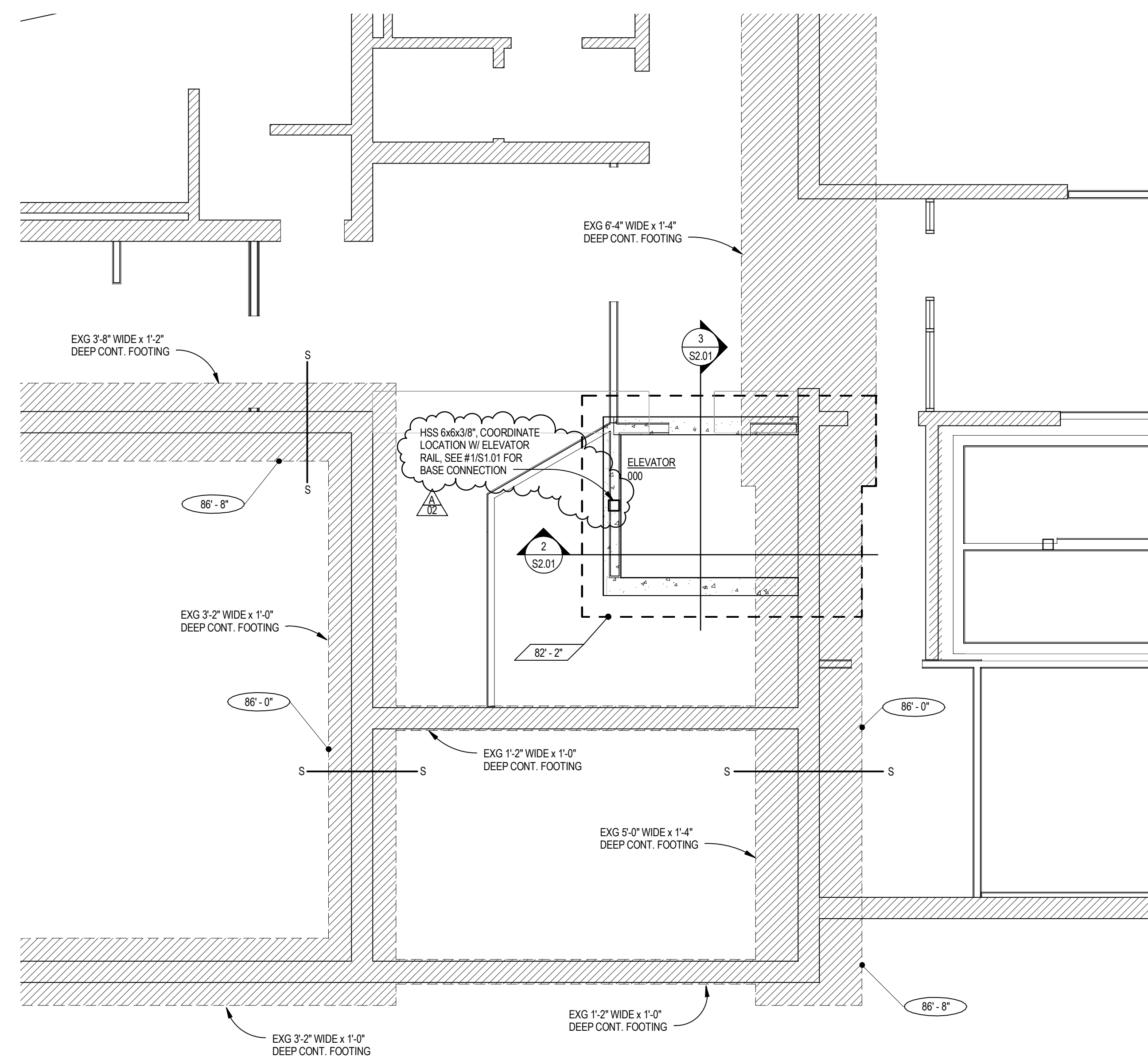

**FOOTING & FOUNDATION PLAN - ELEVATOR**  
SCALE: 1/4" = 1'-0"

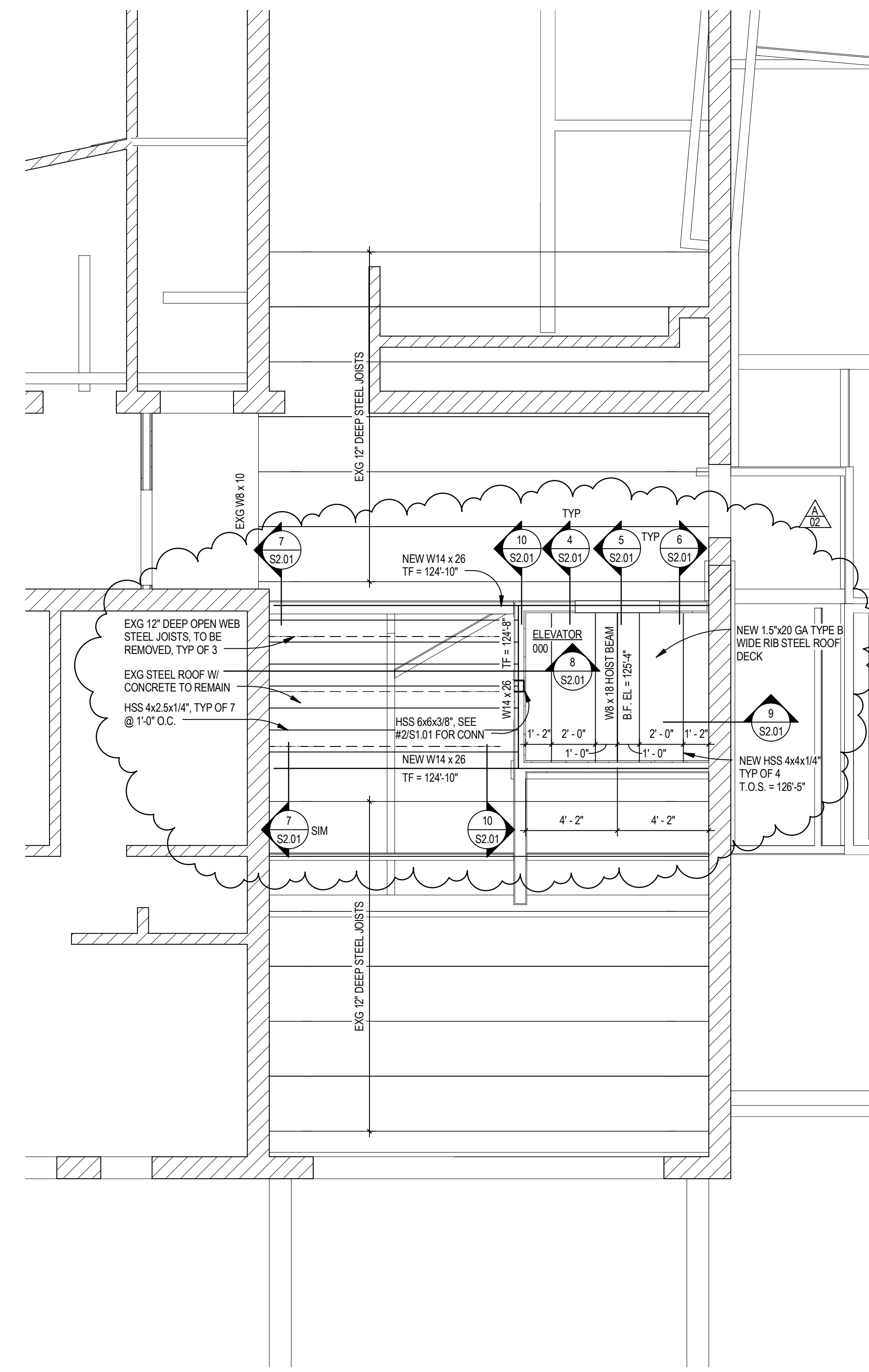

**ROOF FRAMING PLAN - ELEVATOR**  
SCALE: 1/4" = 1'-0"

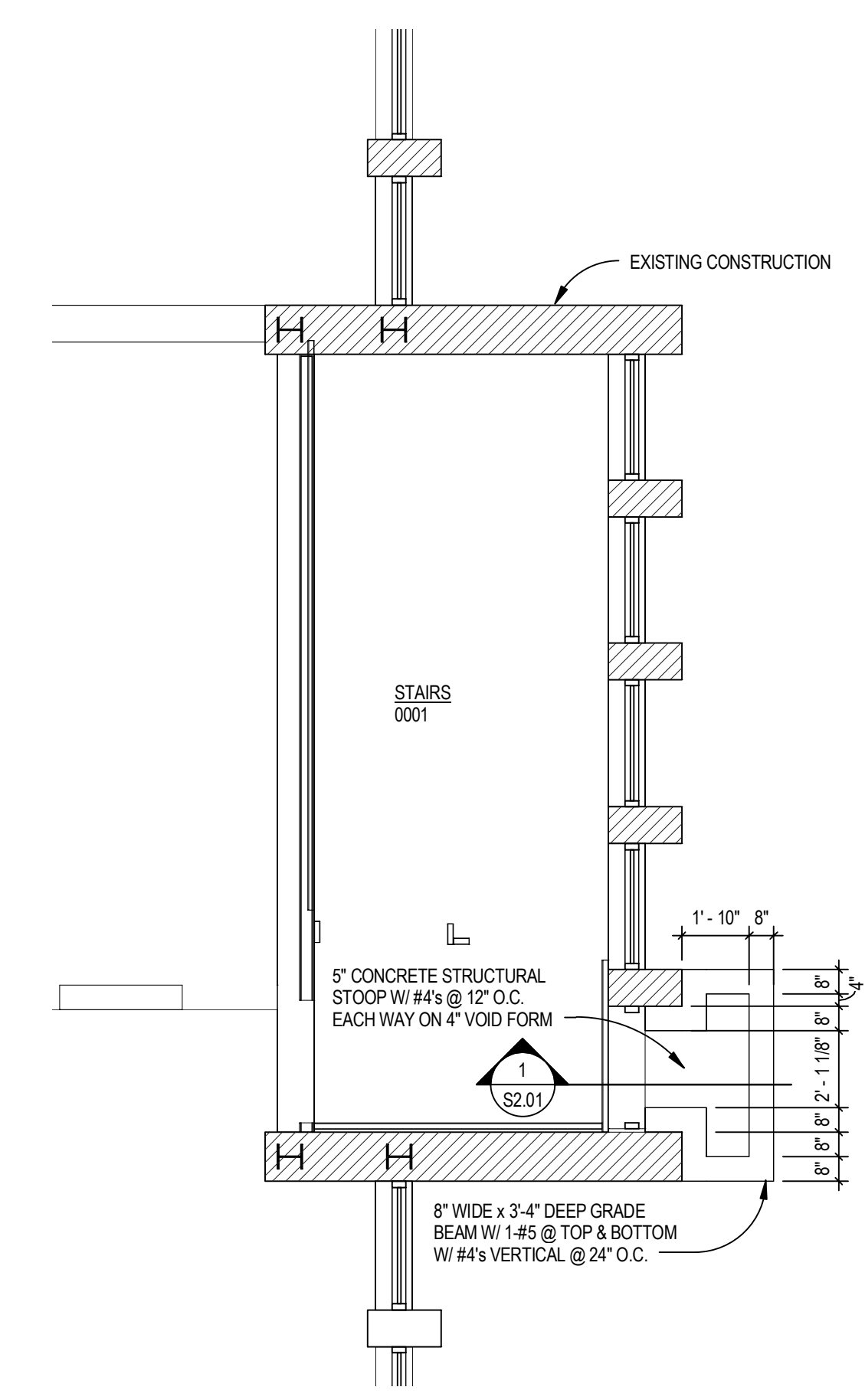

**FOOTING & FOUNDATION PLAN - STOOP**  
SCALE: 1/4" = 1'-0"

**Doane College Library Learning Commons**  
 Doane College  
 Crete, Nebraska  
 TCEP No.: 439-050-13  
 December 20, 2013