

**Sampson Construction Co., Inc.**  
**3730 South 14<sup>th</sup> Street**  
**Lincoln, NE 68502**  
**Phone: (402) 434-5450**  
**FAX: (402) 434-5466**

**Bid Bulletin #03**

PROJECT: Baldwin Filters Distribution Facility (Bid Package #04)  
Kearney, NE

DATE: November 18, 2013

This Bid Bulletin includes items 1-1 through 1-8. Each item shall be fully incorporated into the Bidding/Contract Documents and have the same force and effect as though originally included. Bidders shall acknowledge receipt of this Bid Bulletin on the bid form.

- Item 1-1      **Specification section 00 01 40- Summary of work #04B- Footings/CIP Walls**
- A. This summary of work shall include the base of the tunnel pit as shown in 12/S-501.
  - B. This summary of work shall include the ledge as shown in 2/S-301.
  - C. This summary of work shall not include the concrete pad at the bottom of the sewage ejector pit/acid pit. Concrete pad will be the responsibility of the plumbing contractor.
  - D. This summary of work shall include all additives and winter protection necessary to install footings and walls per the project schedule.
  - E. As clarification, the only exterior footings and walls are the retaining wall on the east side of the building south of gridline 1 (8/S-502) and the retaining wall on the east side of the building between grid 15.5 and 16. Plans sheets indicate other potential exterior walls/ramps on the east side of the building; however, these other walls/ramps are not to be included at this time.
  - F. The electrical generator pad and transformer pad are by the electrician.
  - G. This summary of work shall include all below grade insulation against footings or cast in place walls.
- Item 1-2      **Specification section 00 01 40- Summary of work #04C- Slabs**
- A. The base of the tunnel pit (12/S-501) is by the foundation contractor.
  - B. The base of the sewage ejector pit/acid pit is by the plumbing contractor.
  - C. Remove item #27 from the original summary of work. There is no rigid insulation between the slab edge and the exterior wall.
  - D. This summary of work shall include the stoop slabs.
  - E. This summary of work shall be responsible for the column block-outs and shall pour back the column block-outs after the slab is poured.
  - F. The electrical generator pad and transformer pad are by the electrician.
- Item 1-3      **Specification section 00 01 40- Summary of work #04R- Plumbing**
- A. Site utilities have already been bid and shall not be included with the plumbing bids.
  - B. Bidders shall note that the site utility scope of work includes the following work which appears on the plumbing plans: 1. The new 24" storm sewer and connection to the existing storm drains as shown on P-101A. 2. The 10" storm drain up from below grade for connection to the downspouts on the east side of the building.
  - C. Bidders shall note that the fire service and water service shall be brought inside the exterior wall and turned up 1'-0" above grade by the utility contractor.

**D.** This summary of work shall include construction of all pits (sewage ejector, acid, etc) complete including excavation, cast in place concrete work, precast pipe, and backfill.

Item 1-4

**Specification section 00 01 40- Summary of work #04Q- Fire Suppression**

**A.** Along gridline A.2 at approximately gridline 2.9 and 5.4, the plans note to connect new fire sprinkler main piping to existing piping. This work is being completed by others and shall not be part of the fire suppression bids.

Item 1-5

**Specification section 00 01 40- Summary of work #04S- Exterior paving & walks**

**A.** Bidders shall note that exterior stoop slabs are included in summary of work #04C-slabs.

**B.** The electrical generator pad and transformer pad are by the electrician.

Item 1-6

**Specification section 012300- Alternates**

**A.** Alternate #6 has been added to the project. In this alternate, bidders shall provide a price for PVC roof drains in lieu of cast iron.

Item 1-7

Attached is Addendum #1 dated 11/18/13 from Davis Design.

Item 1-8

Bid date remains 11/21/13 at 2:00 PM.

END OF BID BULLETIN #03



ARCHITECTURE • ENGINEERING • INTERIOR DESIGN

## ADDENDUM

**PROJECT:** Baldwin Filters  
Main Distribution Center  
Final Construction Package - Big Box  
Kearney, Nebraska

### ADDENDUM NUMBER

AD-1

### ISSUED BY:

Mike Wachal, Coordinating Professional  
Greg Smith, Architect

**PROJECT #:** 13-0061

**DATE ISSUED:** Monday, November 18, 2013

*This addendum is issued by the Architect to all known bidders before receipt of proposals, for the purpose of explaining, interpreting, or modifying the original plans and specifications. When enumerated by the bidder upon the proposal sheet, the information or instructions given hereon will be equally binding upon all parties as if included in the original plans and specifications.*

**BIDDER MUST ENTER THE NUMBER OF THIS ADDENDUM ON HIS PROPOSAL SHEET**

### THE FOLLOWING ITEMS ARE APPLICABLE TO THE SPECIFICATIONS:

#### AD-1, ITEM 1:

In reference to Section 033000 – Cast-in-place concrete, under section 2.6 Vapor Barriers, delete reference to paragraph 2.6, article D.

#### AD-1, ITEM 2:

In reference to Section 083323 - Overhead Coiling Doors, all fire-rated coiling doors shall be steel, not aluminum as specified.

#### AD-1, ITEM 3:

In reference to Section 083323 - Overhead Coiling Doors, delete reference to specified r-value of insulation in core, all doors to be min. of 1 3/4" thick, r-value to follow accordingly.

#### AD-1, ITEM 4:

In reference to Section 085113 – Aluminum Windows, add Manko Window Systems as an approved material supplier.

#### AD-1, ITEM 5:

In reference to Section 085113 – Aluminum Windows, The design intent for all windows shown on the exterior to be a Kawneer 451T framing or approved equal.

**AD-1, ITEM 6:**

In reference to Section 095113 - Acoustical Panel Ceilings, section is attached.

**AD-1, ITEM 7:**

In reference to Section 111300 - Loading Dock Equipment, at this time, the only other allowed option is Kelley/Serco.

**AD-1, ITEM 8:**

In reference to Section 221316 – Sanitary Waste and Vent Piping, for underground sanitary sewage force mains smaller than 3”, the piping material shall be Schedule 80 PVC pressure rated piping. Piping and fittings shall be made from virgin rigid PVC compounds with a cell class of 12454 as identified in ASTM D 1784. Piping shall be IPS conforming to ASTM D 1785. Fittings shall conform to ASTM D 2467. Piping and fittings shall be manufactured as a system, and shall be the product of a single manufacturer. Buried pipe shall be installed in accordance with ASTM F 1668. Solvent weld joints shall conform to ASTM D 2564.

**AD-1, ITEM 9:**

In reference to Section 221413 – Facility Storm Drainage Piping, for storm drainage piping 12” and smaller, to a point not less than 10’ above the finished floor, PVC piping shall be acceptable. Piping shall be solid wall PVC, ASTM D 2665 DWV, with ASTM D 2665 socket fittings, made to ASTM D 3311 DWV patterns for Schedule 40 pipe. Primer shall be ASTM F 656, and solvent cement shall be ASTM D 2564. Use non-pressure transition couplings for transitions from PVC to cast iron at or above 10’ AFF.

**AD-1, ITEM 10:**

In reference to Section 221413 – Facility Storm Drainage Piping, for storm drainage piping 15” and larger inside the building footprint and to a point five feet outside the building, piping shall be ADS “HP Storm.” Refer to attached information and specifications.

**AD-1, ITEM 11:**

In reference to Section 233300 – Air Duct Accessories, the following manufacturers shall be included for dampers:

United Enertech  
NCA Manufacturing

**THE FOLLOWING ITEMS ARE APPLICABLE TO THE DRAWINGS:**

**AD-1, ITEM 12:**

In reference to Sheet S-103B, add the following to the 12” floor slab note: Floor Flatness Requirement F[F] = 65.

**AD-1, ITEM 13:**

In reference to Sheet S-106A, double joists will be required at the first joist north of grid 7.9 in all bays. Coordinate with the steel erector.

**AD-1, ITEM 14:**

In reference to Sheet S-106A, extend the two W8x10 steel beams that span east-west between grid J and grid K one joist space south.

**AD-1, ITEM 15:**

In reference to Sheet S-106A, in bay J-K, change the fourth joist north of grid 6.9 to a 48LHSP-8. This joist will be supporting pallet storage beams.

**AD-1, ITEM 16:**

In reference to Sheet S-106A, delete the double joists shown at the ventilators. Provide a single joist of the type shown on the drawings at the location of each ventilator. Add a 600 pound load to the joist load diagrams for each type of joist supporting a ventilator. The 600 pound load should be accounted for at the joists supporting the ventilators only.

**AD-1, ITEM 17:**

In reference to Sheet S-106A and S-106B, joists in bay J-K shall be 48" deep. See the following for new joist type designations:

| EXISTING  | NEW       |
|-----------|-----------|
| 44LHSP-1  | 48LHSP-8  |
| 44LHSP-2  | 48LHSP-9  |
| 44LHSP-6  | 48LHSP-10 |
| 44LHSP-7  | 48LHSP-11 |
| 44LHSP-17 | 48LHSP-12 |
| 44LHSP-18 | 48LHSP-13 |
| 44LHSP-19 | 48LHSP-14 |
| 44LHSP-20 | 48LHSP-15 |
| 44LHSP-3  | 48LHSP-16 |
| 44LHSP-8  | 48LHSP-17 |

**AD-1, ITEM 18:**

In reference to Sheet S-108A, add the following drift to the sheet:

Pf = 20 psf  
Pd = 88 psf  
Total = 108 psf  
W = 20'-5"

Add this drift load to the following joist loading diagrams and add the end reactions (kips) shown to the joist load tables (see Sheets S-507 and S-508):

| JOIST TYPE           | R1 / R2     |
|----------------------|-------------|
| 44LHSP6              | 13.9 / 15.1 |
| 44LHSP7              | 14.1 / 15.2 |
| 44LHSP6 w/ FIRE MAIN | 14.7 / 16.0 |
| 44LHSP17             | 31.0 / 32.3 |
| 44LSHP18             | 25.7 / 27.0 |
| 44LHSP19             | 20.5 / 21.7 |
| 44LHSP20             | 15.3 / 16.5 |
| 48LHSP7              | 18.9 / 21.1 |

**AD-1, ITEM 19:**

In reference to **Sheet S-504**, see attached detail 25/S-504 pertaining to the support of the fire sprinkler lines and design of the steel joists.

**AD-1, ITEM 20:**

In reference to **Sheet A-103A**, delete reference to doors 150 & 151

**AD-1, ITEM 21:**

In reference to **Sheet A-402**, wall section 2, see attached detail A402.1 for additional reinforcing requirements for dock leveler pit.

**AD-1, ITEM 22:**

In reference to **Sheet A-601**, delete reference to doors 150 & 151

**AD-1, ITEM 23:**

In reference to **Sheet P-101A and P-101B**, all below slab/grade storm drain piping within the building footprint and to a point five feet outside the building footprint that is 15" or larger in size shall be ADS "HP Storm" piping. Refer to attached information and specifications.

**END AD-1**

**BALDWIN FILTERS  
MAIN DISTRIBUTION FACILITY  
FINAL CONSTRUCTION PACKAGE - BIG BOX  
KEARNEY, NEBRASKA**

SECTION 095113 - ACOUSTICAL PANEL CEILINGS

PART 1 - GENERAL

1.1 SUMMARY

- A. Section includes acoustical panels and exposed suspension systems for ceilings.

1.2 ACTION SUBMITTALS

- A. Product Data: For each type of product.
- B. Samples: For each exposed product and for each color and texture specified.

1.3 INFORMATIONAL SUBMITTALS

- A. Product test reports.
- B. Evaluation reports.
- C. Field quality-control reports.

1.4 CLOSEOUT SUBMITTALS

- A. Maintenance data.

PART 2 - PRODUCTS

2.1 PERFORMANCE REQUIREMENTS

- A. Surface-Burning Characteristics: Comply with ASTM E 84; testing by a qualified testing agency. Identify products with appropriate markings of applicable testing agency.
  - 1. Flame-Spread Index: Comply with ASTM E 1264 for Class A materials.
  - 2. Smoke-Developed Index: 450 or less.

2.2 ACOUSTICAL PANEL CEILINGS, GENERAL

- A. Glass-Fiber-Based Panels: Made with binder containing no urea formaldehyde.
- B. Acoustical Panel Standard: Comply with ASTM E 1264.

**BALDWIN FILTERS  
MAIN DISTRIBUTION FACILITY  
FINAL CONSTRUCTION PACKAGE - BIG BOX  
KEARNEY, NEBRASKA**

- C. Metal Suspension System Standard: Comply with ASTM C 635.
- D. Attachment Devices: Size for five times the design load indicated in ASTM C 635, Table 1, "Direct Hung," unless otherwise indicated.

2.3 ACOUSTICAL PANELS

- A. Manufacturers: Subject to compliance with requirements, provide products by one of the following:
  - 1. Armstrong World Industries, Inc; Fine Fissured 895.
  - 2. CertainTeed Corp; Fissured FH 197.
  - 3. Chicago Metallic Corporation.
  - 4. USG Interiors, Inc.; Subsidiary of USG Corporation.
- B. Classification: Fine fissured; **5/8 inch** thick.
- C. Color: White.
- D. LR: .82.
- E. NRC: .60.
- F. CAC: 35.
- G. Edge/Joint Detail: Square.
- H. Thickness: **5/8 inch**.
- I. Modular Size: **24 by 48 inches**.

2.4 METAL SUSPENSION SYSTEM

- A. Manufacturers: Subject to compliance with requirements, provide products by one of the following:
  - 1. [Armstrong World Industries, Inc.](#)
  - 2. [CertainTeed Corp.](#)
  - 3. [Chicago Metallic Corporation.](#)
  - 4. [USG Interiors, Inc.; Subsidiary of USG Corporation.](#)

**BALDWIN FILTERS  
MAIN DISTRIBUTION FACILITY  
FINAL CONSTRUCTION PACKAGE - BIG BOX  
KEARNEY, NEBRASKA**

- B. Narrow-Face, Capped, Double-Web, Steel Suspension System: Main and cross runners roll formed from cold-rolled steel sheet; prepainted, electrolytically zinc coated, or hot-dip galvanized according to ASTM A 653/A 653M, not less than **G30** coating designation; with prefinished **9/16-inch** wide metal caps on flanges.
  - 1. Structural Classification: Heavy-duty system.
  - 2. End Condition of Cross Runners: Override (stepped) or butt-edge type.
  - 3. Face Design: Flat, flush.
  - 4. Cap Material: Steel or aluminum cold-rolled sheet.
  - 5. Cap Finish: Painted white.
  
- C. Roll-Formed, Sheet-Metal Edge Moldings and Trim: Type and profile indicated or, if not indicated, manufacturer's standard moldings for edges, penetrations, and outside corners; formed from sheet metal of same material, finish, and color as that used for exposed flanges of suspension-system runners.

**PART 3 - EXECUTION**

**3.1 INSTALLATION**

- A. Install acoustical panel ceilings to comply with ASTM C 636/C 636M and seismic design requirements indicated, according to manufacturer's written instructions and CISCA's "Ceiling Systems Handbook."
  
- B. Measure each ceiling area and establish layout of acoustical panels to balance border widths at opposite edges of each ceiling and per reflected ceiling plans. Avoid using less-than-half-width panels at borders, and comply with layout shown on reflected ceiling plans.
  - 1. Arrange directionally patterned acoustical panels as indicated on reflected ceiling plans.
  
- C. Install pre-manufactured outside corners accurately and connect securely. Field formed outside corners are not acceptable.

END OF SECTION 095113

## ADS HP STORM 12”–60” PIPE SPECIFICATION

### SCOPE

This specification describes 12- through 60-inch (300 to 1500 mm) ADS HP Storm pipe for use in gravity-flow storm drainage applications.

### PIPE REQUIREMENTS

- 12- through 30-inch (300 to 750 mm) pipe shall have a smooth interior and annular exterior corrugations and meet or exceed ASTM F2736 and AASHTO M330.
- 36- through 60-inch (900 to 1500 mm) pipe shall have a smooth interior and annular exterior corrugations and meet or exceed ASTM F2881 and AASHTO M330.
- Manning’s “n” value for use in design shall be 0.012.

### JOINT PERFORMANCE

Pipe shall be joined with a gasketed integral bell & spigot joint meeting the requirements of ASTM F2736 or F2881, for the respective diameters.

12- through 60-inch (300 to 1500 mm) shall be watertight according to the requirements of ASTM D3212. Spigots shall have gaskets meeting the requirements of ASTM F477. Gasket shall be installed by the pipe manufacturer and covered with a removable, protective wrap to ensure the gasket is free from debris. A joint lubricant available from the manufacturer shall be used on the gasket and bell during joint assembly.

12- through 60-inch (300 to 1500 mm) diameters shall have a reinforced bell with a polymer composite band installed by the manufacturer.

### FITTINGS

Fittings shall conform to ASTM F2736, ASTM F2881 and AASHTO M330, for the respective diameters. Bell and spigot connections shall utilize a spun-on, welded or integral bell and a spigot with gaskets meeting ASTM F477. Bell & spigot fittings joint shall meet the watertight joint performance requirements of ASTM D3212. Corrugated couplings shall be split collar, engaging at least 2 full corrugations.

### FIELD PIPE AND JOINT PERFORMANCE

To assure watertightness, field performance verification may be accomplished by testing in accordance with ASTM F2487. Appropriate safety precautions must be used when field testing any pipe material. Contact the manufacturer for recommended leakage rates.

### MATERIAL PROPERTIES

Polypropylene compound for pipe and fitting production shall be impact modified copolymer meeting the material requirements of ASTM F2736, section 4, ASTM F2881, Section 5 and AASHTO M330, Section 6.1, for the respective diameters.

### INSTALLATION

Installation shall be in accordance with ASTM D2321 and ADS recommended installation guidelines, with the exception that minimum cover in traffic areas for 12- through 48-inch (300 to 1200 mm) diameters shall be one foot (0.3 m) and for 60-inch (1500 mm) diameters, the minimum cover shall be 2 feet (0.6 m) in single run applications. Backfill for minimum cover situations shall consist of Class 1, Class 2 (minimum 90% SPD) or Class 3 (minimum 95%) material. Maximum fill heights depend on embedment material and compaction level; please refer to Technical Note 2.04. Contact your local ADS representative or visit our website at [www.ads-pipe.com](http://www.ads-pipe.com) for a copy of the latest installation guidelines.

### PIPE DIMENSIONS

| Nominal Diameter in.<br>(mm)  | 12<br>(300)   | 15<br>(375)   | 18<br>(450)   | 24<br>(600)   | 30<br>(750)   | 36<br>(900)    | 42<br>(1050)   | 48<br>(1200)   | 60<br>(1500)   |
|---|---------------|---------------|---------------|---------------|---------------|----------------|----------------|----------------|----------------|
| Average Pipe I.D. in.<br>(mm)   | 12.1<br>(307) | 14.9<br>(378) | 18.0<br>(457) | 24.1<br>(612) | 30.1<br>(765) | 35.7<br>(907)  | 41.8<br>(1062) | 47.3<br>(1201) | 59.3<br>(1506) |
| Average Pipe O.D. in.<br>(mm)   | 14.5<br>(368) | 17.6<br>(447) | 21.2<br>(538) | 28.0<br>(711) | 35.4<br>(899) | 41.1<br>(1044) | 47.2<br>(1199) | 53.8<br>(1367) | 66.5<br>(1689) |
| Minimum Pipe Stiffness at 5%<br>Deflection* #/in/in. (kN/m <sup>2</sup> ) | 75<br>(520)   | 60<br>(411)   | 56<br>(385)   | 50<br>(343)   | 46<br>(320)   | 40<br>(275)    | 35<br>(240)    | 35<br>(240)    | 30<br>(205)    |

\*Minimum pipe stiffness values listed; contact a representative for maximum values.

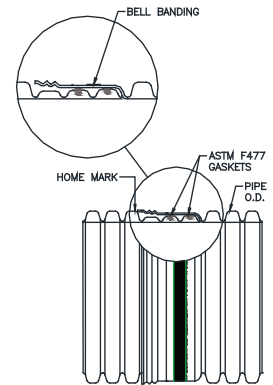

(Check with a sales representative for regional product configuration.)



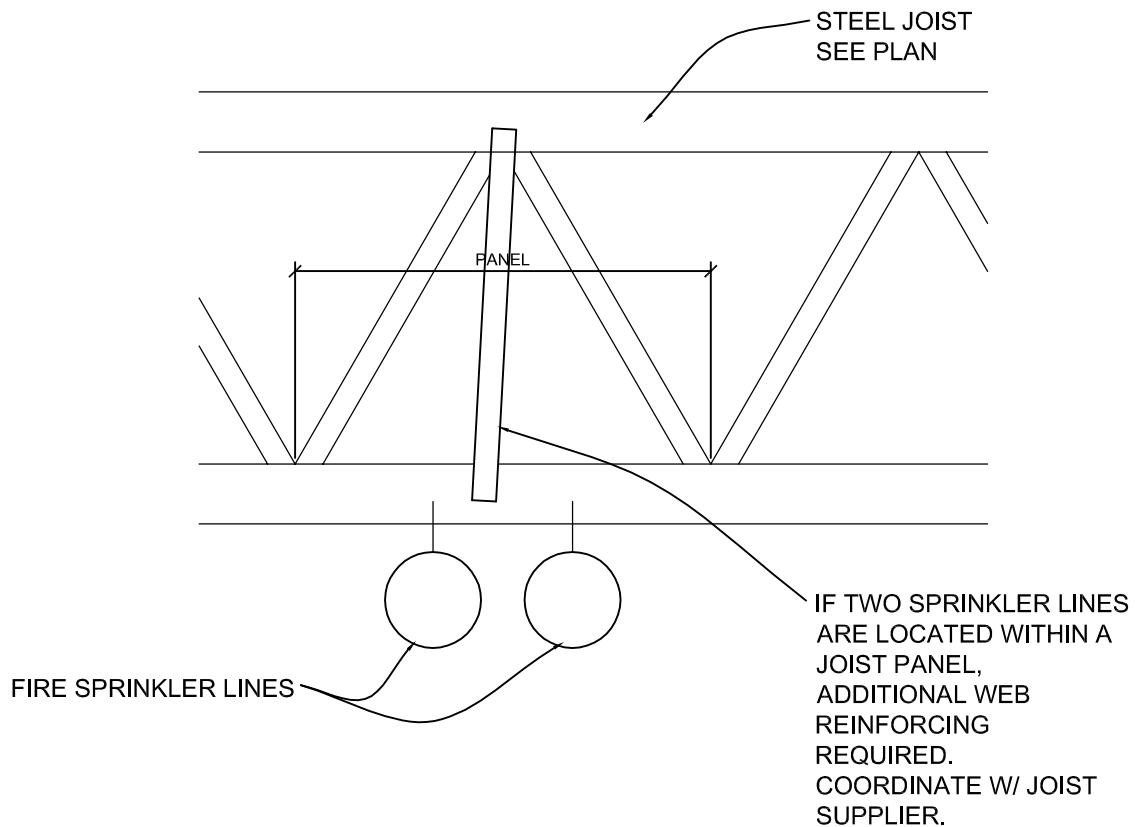

THE CONTRACTOR SHALL COORDINATE THE LOCATION, SIZE, & WEIGHT OF THE FIRE SPRINKLER LINES W/ THE JOIST SUPPLIER.

## 25 Fire Lines & Joist Detail

Scale: No Scale

|   |  |   |   |   |
|---|--|---|---|---|
|  <p><b>DAVIS</b><br/>DESIGN<br/>ARCHITECTURE ENGINEERING INTERIOR DESIGN</p> | <p>Lincoln<br/>1221 N Street, Suite 600<br/>Lincoln NE 68508<br/>Phone 402-476-9700<br/>Fax 402-476-9722</p> | <p>Client Information<br/><b>Baldwin Filters</b></p>        | <p>Issue Date 11-11-2013<br/>Job # 13-0061<br/>Drawn by: ...<br/>CADD file: rev11lnks-504</p> |   |
|   | <p>Vermillion<br/>15 East Main, Suite 201<br/>Vermillion SD 57069<br/>Phone 605-624-1081</p>                 | <p>4400 East Highway 30<br/>Kearney, Nebraska 68847</p>     | <p>COPYRIGHT © DAVIS DESIGN ALL RIGHTS RESERVED</p>   | <p>Drawing Title<br/>Drawing Title and Subtitle</p> |
|   |  | <p>Project Information<br/><b>Distribution Facility</b></p> | <p>From Sheet: S-504 for CA use:<br/>Drawing # 25</p>   |   |
|   |  |   |   |   |

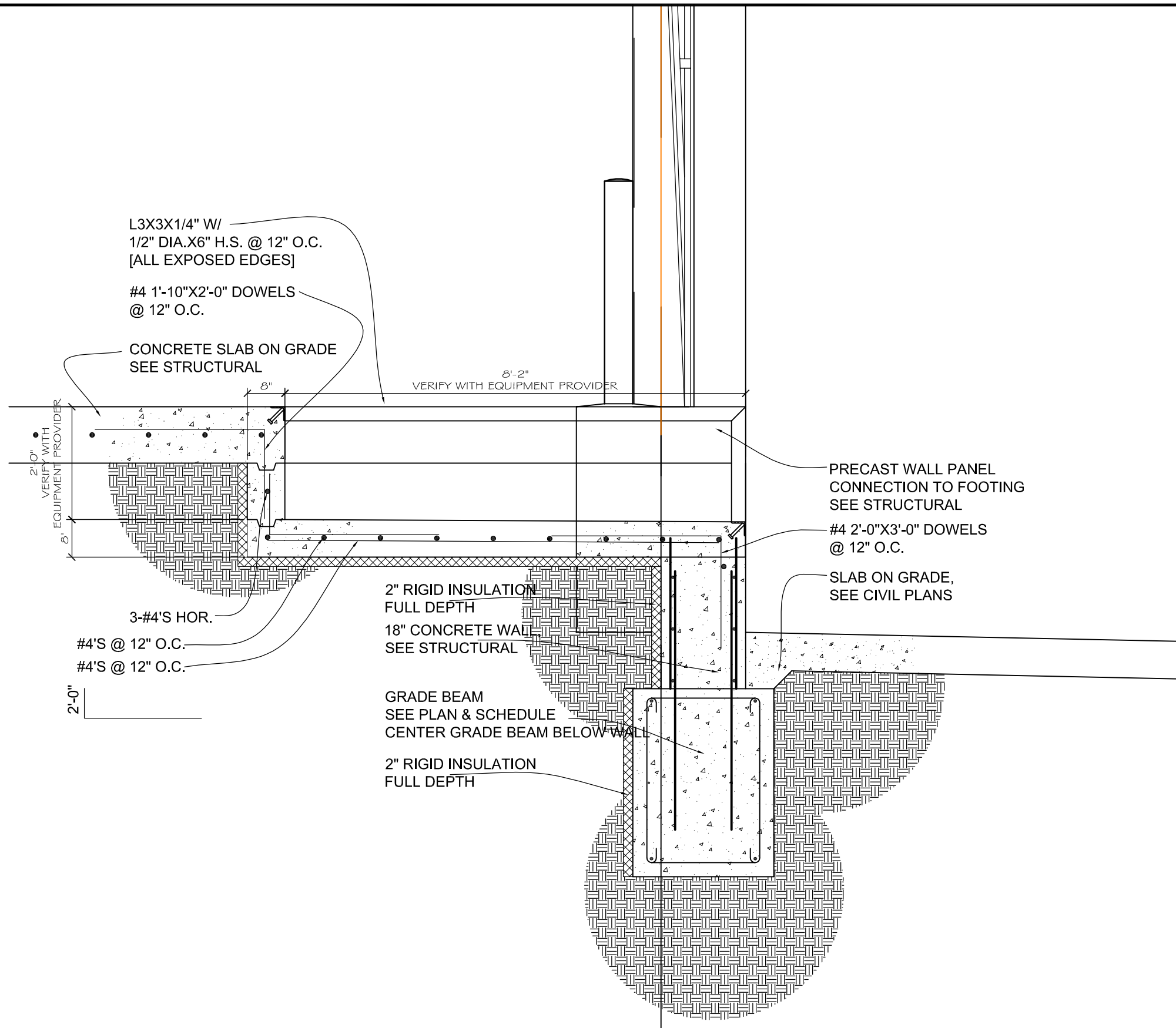

2

# Dock Leveler Pit Section

Scale: 1/2" = 1'-0"

Lincoln  
1221 N Street, Suite 600  
Lincoln, NE 68508  
Phone 402-476-9700  
Fax 402-476-9722

Vermillion  
15 East Main, Suite 201  
Vermillion, SD 57069  
Phone 605-624-1081

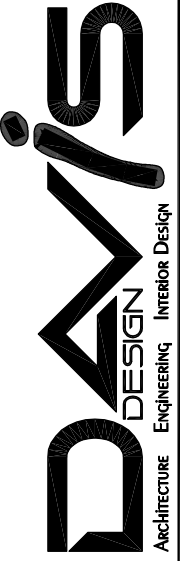

Client Information  
**Baldwin Filters**  
  
4400 East Highway 30  
Kearney, Nebraska 68847

Project Information  
**Distribution Facility**

|            |          |
|------------|----------|
| Issue Date | 11-15-13 |
| Job #      | 13-0061  |
| Drawn by:  |          |
| CADD file: |          |

Copyright © DAVIS DESIGN ALL RIGHTS RESERVED  
Drawing Title  
Additional Dock Leveler Pit  
Reinforcing Information

|                      |             |
|----------------------|-------------|
| From Sheet:<br>A-402 | for CA use: |
| Drawing #<br>A-402.1 |             |