

796-001-12

ADDENDUM NO. 2

The Architect/Engineer issues this addendum, applicable to the above named project, to all known Contractors before receipt of proposal.

This addendum includes Item Number 2-1 thru 2-35. This addendum item shall be fully incorporated into the Bidding/Contract Documents and have the same force and effect as though originally included.

The Bidder shall acknowledge receipt of this Addendum No. 2 on the Bid Proposal Form in the place provided.

GENERAL BIDDING REQUIREMENTS AND CONDITIONS OF THE CONTRACT

Item 2-1: Pre-Bid Questions

Question: How long do unit prices need to be held?

Answer: 90 days

Question: Who provides the transformer pad?

Answer: Dawson Public Power provides the vault and sets the vault that the pad-mount transformer sits on. Your electrical contractor is responsible for all of the secondary work, including hooking up the customer secondary to Dawson's pad-mount transformer, The electrical contractor is also responsible for the secondary connector's.

Question: Who takes down the existing overhead power lines and disconnects / removes the existing transformer?

Answer: Dawson Public Power will remove all of the overhead power line's including the meter and meter loop. Anything below the meter is customer owned and it is their responsibility to remove.

Item 2-2: Alternate Clarification Question

Question: Alternate # 1 says to delete exterior access control. Will this include the electrified hardware items that would not be required without the access control? Such as replace the electrified exit devices with standard exit devices and delete power supplies from 08 71 00.

Answer: Correct

CIVIL

Item 2-3: C3.02 – Storm Sewer Plan

Replace sheet C3.02 in its entirety.

796-001-12

ARCHITECTURAL

Specifications

Item 2-4: Section 03 30 00 – Cast-In-Place Concrete

Refer to paragraph 2.6, B Granular Fill: At contractor's option, it would be acceptable to provide Nebraska Department of Roads gravel for surfacing (road gravel) Sub base material shall be level and plate compacted immediately prior to placement of the vapor barrier and concrete.

Item 2-5: Section 08 41 13 – Aluminum-Framed Entrances and Storefronts

Refer to paragraph 2.2 contractor questions.

Question: We need to know what type of storefront system to use. The specs call out the glass location to be center-plane and have the basis-of-design product being Manko's 2450 system (a center-plane system according to their website).

All of the details in your architectural drawings, however, show everything being front-plane storefront and call out Kawneer's 451T framing system (front and center plane system). Should we follow the specifications and quote a center-plane system (EFCO's 403 storefront) or the drawings and quote a front-plane system (EFCO's 433 storefront)??

Answer: Storefront system shall be front-glazed.

Question: The specifications call for the frames at the Wrestling A162 and Weights A163 to be an SSG curtain wall equal to Manko's 257 curtain wall system. This would be frames AL-143A and AL-143B. These are very small punched opening frames, so I was questioning why they would need to be curtain wall. Then I found on sheet A6.34 where their description says, "*window to be designed for blast resistance.*" However, there is no mention anywhere in the storefront or glazing spec sections (or in the structural general notes) about any kind of blast load. If these frames need to be blast mitigation compliant, we need to know what blast load criteria to design for.

Answer: The Wrestling / Weight room area is to be a hardened storm shelter space not full blast resistance. Hardened space to be designed for increased wind speed of 250 mph, Exposure C, importance factor of 1.0. Refer to section 08 80 00 section 3.11 for insulated laminated glass to be used in these openings. Structurally glazed window, anchor requirements by manufacturer.

Item 2-6: Section 08 11 13 – Hollow Metal Door and Frames

Refer to paragraph 2.1, A. Subject to compliance with the requirements of this section, add West Central Manufacturing as an acceptable manufacturer.

796-001-12

Item 2-7: Section 09 22 16 – Non-Structural Metal Framing

Refer to paragraph 2.2, E. Firestop Tracks can be used where the installer plans to utilize the track system as part of the smoke or fire wall assembly. If this material is not intended to be utilized as part of the assembly, the use of the standard slip head joint / deflection track is acceptable. Deflection track is required and must be accommodated as part of the rated wall assemblies.

Item 2-8: Section 09 30 00 – Tile

- Refer to paragraph 2.1.G.3.a. CHANGE text to read: Porcelain Ceramic Tile: American Olean Tile Company [Sales Rep- Andrea Owen, Midwest Tile & Granite, (800) 818-6813].
- Refer to paragraph 2.1.G.3.a. CHANGE text to read: PCT-1, Decorum, 12” x 12” Porcelain Ceramic Tile, Color—Ideal White, DR01.

Item 2-9: Section 09 51 13 – Acoustical Panel Ceilings

- Refer to paragraph 2.2, H. Subject to compliance with the requirements of this section, add Gordon Contura as an acceptable manufacturer.
- Refer to paragraph 2.3, A, 1. Subject to compliance with the requirements of this section, add Sound Concepts Pyramid Diffuser as an acceptable manufacturer.

Item 2-10: Section 09 65 00 – Resilient Flooring

- Refer to paragraph 2.2.A.1. CHANGE text to read: Dinoflex Product: Sport Mat for Sport Recycled Rubber 4-Sided Interlocking (NO GLUE) Tile Flooring, 37” x 37” x 1/2” (940 x 940 x 12 mm) with associated reducer strips. Material shall be non-laminated tile composed of 100% post-consumer recycled SBR and 100% virgin EPDM granules, bound with a polyurethane binder, and precision cut using computerized numerically controlled (CNC) water-based equipment. Reducer strips shall be installed with manufacturer’s approved adhesive. Technical Rep: Craig Robinson, Phone: (877) 713-1899, Ext. 207, crobinson@dinoflex.com. Sales Rep—Shannon Sales: Tony Barzycki, Phone: (414) 687-2067.
- Refer to paragraph 2.2.A.1. Subject to compliance with the requirements of this section, add Dynamic Sports Construction, Inc. as an acceptable manufacturer.

Item 2-11: Section 12 36 61 – Simulated Stone Countertops and Sills

Refer to paragraph 2.2.D.1. Subject to compliance with the requirements of this section, add Hanex Solid Surface as an acceptable manufacturer.].

796-001-12

Drawings

Item 2-12: Sheet A6.06 – Interior Elevations – Area B

Question: On some of the interior elevations, see A6.06 for example, there are several areas where they list “WC-2” (3,4,5,6,7,8 for that matter). This “WC-#” labels appear to be over casework, but on other interior elevations, the “WC-#” note appears to be calling out wall covering.

Can you please clarify whether or not the “WC-#” is wall cabinetry / casework or wall covering?

Answer: Yes, it appears that the designation WC-x is duplicated.

In locations where the designation is located at casework, refer to the cabinet section details on sheet A6.20 for clarification.

In areas where the WC-x is pointing to a wall in elevation or plan, the material refers to tackable or acoustic wall covering. The wall covering material area is identified with a hatch pattern on the interior elevations for clarity. All wall covering locations are also identified on the F1.01 through F1.03 Finish sheets.

Item 2-13: Sheet A6.30 – Door Schedule

Refer to the fire rating column of the door schedule. The following door ratings shall be modified from 20 minute to smoke rated. The Classroom doors do not require a fire rating per the Code Compliance Plan, sheet G0.02.

Area ‘A’:

A111, A113, A127, A134, A134.1, A134.2, A137.2, A151, A152, A152.1, A153, A156, A158, A159, A159.1, A162, A162.1, A163, A163.1, A164

Area ‘B’:

B100, B101, B103, B103.1, B105, B106, B106.1, B107, B108, B109, B111, B112, B113, B116, B117, B118, B118.1

Area ‘C’:

C100, C101, C102, C105, C107, C107.1

Area ‘D’:

D108, D108.1, D116.1

Area ‘E’:

E104, E106.1, E106.2, E107, E112, E113, E116, E116.1, E120, E121

796-001-12

FINISHES/INTERIORS

Drawings

Item 2-14: Sheet F1.00 Finish Materials List

Porcelain tile product **PCT-1** shall be American Olean, Product: Decorum, in color Ideal White (DR01), size 12" x 12".

STRUCTURAL

Drawings

Item 2-15: Sheet S0.0 Structural Notes

Reference Structural Design Criteria, Wind Design Criteria. Add the following line item: Special Wind Criteria at Wrestling and Weight rooms Area 'A': Wind Speed = 250 mph.

Item 2-16: Sheet S0.01 Precast Lateral Load Plan Area 'A'

- Reference load indicated adjacent to Grid AA, revise "EW1" to read "61".
- Reference load indicated adjacent to Grid AB, revise "EW2" to read "61".
- Reference loads indicated adjacent to Grid A2, revise "NS2" and "NS3" to read "13.5".
- Reference load indicated adjacent to Grid A3, revise "NS1" to read "27".

Item 2-17: Sheet S0.02 Precast Lateral Load Plan Areas 'B', 'C', 'D', 'E'

Reference load indicated adjacent to Grid D1, revise "25" to read "13".

Item 2-18: Sheet S1.01 Footing & Foundation Plan - Area 'A'

- Reference 3'-6" wide continuous footings running east-west between Grids AA and AB, adjacent to the existing building. At footing step locations add top of footing elevation tag with elevation = 96'-8" match existing at portion of footing directly adjacent to existing construction, typical 4 places.
- Reference section cut 1D/S3.01 on Grid AC between Grids A1 and A2. Revise this section cut so that it is looking east.
- Reference pad footing on Grid A1, approximately 20' south of Grid AA, add the following note to this footing: "6'-0"x6'-0"x1'-0" DEEP PAD FOOTING W/ 7-#5's EA WAY @ BOTTOM.
- Reference pad footings on Grid A1, approximately 44' and 72' south of Grid AA, add the following note to these footings: "8'-0"x6'-0"x1'-0" DEEP PAD FOOTING W/ 9-#5's LONGITUDINAL & 7-#5'S TRANSVERSE @ BOTTOM.
- Reference pad footing approximately 5' west of Grid A1 and 15' north of Grid AB, add the following note to this footing: "6'-0"x6'-0"x1'-0" DEEP PAD FOOTING W/ 7-#5's EA WAY @ BOTTOM.
- Reference match line south of Grid X.C. Revise "AREA 'B'" notation at east end of match line to read "AREA 'C'". Delete mid area designation note.

796-001-12

Item 2-19: Sheet S1.02 Footing & Foundation Plan - Areas 'B' & 'C'.

- Reference Footing & Foundation Plan – Area 'C', section cut 11/S3.02 near grid intersection C4-CD, revise "TYP" to "SIM".
- Reference Footing & Foundation Plan – Area 'B':
 - Section cut 11/S3.02 near grid intersection BC-B6. Move section cut so that it is east of Grid B7, cutting through the precast panel.
 - Section cut 11/S3.02 near grid intersection BM-B6. Move section cut so that it is west of Grid B6, cutting through the precast panel.
 - Reference Grid Intersection BH-B4. Add section cut 16/S3.02 SIM, south of grid intersection looking north.
 - Delete area designation note on Grid BL east of Grid B2.4.

Item 2-20: Sheet S2.01 Roof Framing Plan – Area 'A'

- Reference General Framing Notes 1, 2 and 11. Revise "GENERAL CONTRACTOR" TO "CONTRACTOR".
- Reference match line south of Grid X.C. Revise "AREA 'B'" notation at east end of match line to read "AREA 'C'".

Item 2-21: Sheet S2.02 Roof Framing Plan – Areas 'B' & 'C'

- Reference General Framing Notes 1, 2 and 11. Revise "GENERAL CONTRACTOR" TO "CONTRACTOR".
- Reference Roof Framing Plan – Area 'B', roof joist note north of Grid BD between Grids B11 and C1. Revise number of joists from 4 to 5.
- Reference Roof Framing Plan – Area 'B', roof joist note south of Grid BD between Grids B9 and E3. Revise number of joists from 17 to 18.
- Reference Roof Framing Plan – Area 'B', roof joist dimensions south of Grid BJ between Grids B4 and B5. Revise dimension string to read "EQ, 4'-0", 4'-0", EQ.". Delete the 11'-9" dimension.

Item 2-22: Sheet S2.03 Roof Framing Plan – Areas 'D' & 'E'

- Reference General Framing Notes 1, 2 and 11. Revise "GENERAL CONTRACTOR" TO "CONTRACTOR".
- Reference roof joist note south of Grid DC between Grids D1 and D2. Revise number of joists from 7 to 8.
- Reference section cut 14/S4.01 near Grid Intersection DA-E3. Revise section cut number from 14 to 15 and change direction of cut to be looking west.
- Reference connection detail mark 5 near Grid Intersection BL-E2. Delete mark.

796-001-12

Item 2-23: Sheet S2.04 Enlarged Canopy Roof Framing Plans

- Reference General Framing Notes 1, 2 and 11. Revise "GENERAL CONTRACTOR" TO "CONTRACTOR".
- Reference East Canopy Roof Framing Plan:
 - HSS 20x12x5/8" between grids CD & EA approximately 7' east of grid C2. Add elevation tag to read, T.O.S EL = 113'-8"
 - HSS 20x12x5/8" between grids CD & EA approximately 9' east of grid E6. Add elevation tag to read, T.O.S EL = 114'-6 1/2"
 - HSS 20x12x5/8" between grids CD & EA approximately 6' west of grid C4. Add elevation tag to read, T.O.S EL = 115'-5"
- Reference West Canopy Roof Framing Plan
 - HSS 12x12x1/2" between grids BK & DA 1'-7" east of grid D1. Add elevation tag to read, T.O.S EL = 114'-1"
 - HSS 12x12x1/2" between grids BK & DA 8'-3" west of grid D2. Add elevation tag to read, T.O.S EL = 113'-5 1/2"
- Reference West Canopy Roof Framing Plan, section cut 3/A4.03 on Grid D2, revise section cut number to 4/A4.03.
- Reference Connection Detail 1. Revise 20x12 tube thickness from 1/2" to 5/8".

Item 2-24: Sheet S3.01 Column & Footing Schedule, Baseplate Details and Foundation Details

- Reference Stoop Detail 1C. Revise top of grade beam elevation from 99'-4" to 99'-0". Revise bottom of grade beam elevation from 95'-10" to 95'-6".
- Reference Stoop Detail 1D. Revise 1'-7" dimension on left hand side of footing to be 4 5/8" and revise 4 5/8" dimension on right hand side of footing to be 1'-7".
- Reference Column & Footing Schedule. Add the following notes to the Remarks for Grids D4-DC and E1-EC respectively, 2'-6" FOOTING DIM PARALLEL TO GRID DC, 2'-8" FOOTING DIM PARALLEL TO GRID EC.
- Reference Base Plate Detail Type B. Revise baseplate note to read: "18"x12"x3/4" BASE PLATE".

Item 2-25: Sheet S3.02 Foundation Details

Reference Section Details 6 and 9, cmu wall note on right hand side of detail, delete the word "BEARING".

796-001-12

Item 2-26: Sheet S4.02 Framing Details

- Reference Section Detail 1, double tee note. Delete "O.C."
- Reference Section Details 2 and 3. Add the following note to both sections: "NOTE: WIND UPLIFT LOAD @ END OF DOUBLE TEE = 53 K" and revise double tee note to read: "12'-0" WIDE x 2'-8" DEEP DOUBLE TEE."
- Reference Section Detail 5. Revise the "W8x35" note to read "WIDE FLANGE BEAM, SEE FRAMING PLAN FOR SIZE" and Revise the "8" or 10" HOLLOWCORE" note to read: "8" HOLLOWCORE".
- Reference Section Detail 6. Revise cmu wall note to read: "8" CMU WALL, SEE FTG & FNDN PLAN FOR REINF".
- Reference Section Detail 7. Revise the precast plank note to read: "8" DEEP SOLID PRECAST INFILL PLANK OR 8" HOLLOWCORE".

MECHANICAL

Specifications

Item 2-27: Specification Section 23 09 00 – Digital Control System

Digital Control System to include Honeywell Access Control System so that Building Management System shall operate card access system throughout buildings. Provide all necessary components and accessories for complete installation of card access system.

Drawings

Item 2-28: Sheet M7.01 Mechanical Schedules – Heat Pump Schedule

Revise note 6 on the schedule to read, "Heat pump to be provided with modulating hot gas reheat".

Item 2-29: Sheet M7.01 Mechanical Schedules – Roof Top Unit Schedule

Revise note 7 to read, "Provide unit with hot gas reheat".

Item 2-30: Sheet M7.01 Mechanical Schedules – Air Cooled Condensing Unit Schedule

McQuay is an approved alternate. The mechanical contractor and supplier to assume all responsibility to ensure the new coil will fit in the existing unit.

Item 2-31: Sheet M7.01 Mechanical Schedules – Energy Recovery Unit

CONSERV, by Venmar is an approved energy recovery alternate. The mechanical contractor and supplier to assume all responsibility to ensure the units will fit within the limited space constraints in the mechanical rooms.

Item 2-32: Sheet M7.02 Mechanical Schedules – Package Fluid Cooler Schedule

BAC is an approved alternate.

796-001-12

ELECTRICAL

Specifications

Item 2-33: Section 26 51 00 – Lighting Fixtures

The following lighting fixtures have been reviewed in accordance with paragraph 2, and are included in the Contract Documents for bidding purposes. All fixtures, lamps, and ballasts are required to meet the specification requirements regardless of prior approval. Prior approval does not waive any requirements indicated on the drawings or the specifications. Some fluorescent fixtures require dimming or multiple levels of switching. The required number and types of ballasts shall be provided to meet the switching requirements shown on the drawings.

<u>Type</u>	<u>Manufacturer and Catalog Number</u>	
F	Metalux	2ALNG-332-UNV-ER8
G	Portfolio	LD615D010 ERM6835 6LM1L1 HB26
G1	Portfolio	LD615D010 ERW6835 6LW1L1 HB26 HSA6 XX
K	Axis Ltg	B6R-F-RG-4-EX4-T8-2-W-UNV-ERS-1-TB15
L	Metalux	VT3-232DR-UNV-ER8-WL
M	National Ltg	S66 D 2(32T8) A P UNV 4'
	Axis Ltg	RAY8P-VL-RG-4-EX-T8-2-W-UNV-ERS-1-SA
N	Metalux	2GR8-432A125-UNV-ER8-**
P	Metalux	2ALNG-232-UNV-ER8
Q	Axis Ltg	B6R-F-RG-4-EX4-T8-2-W-UNV-ERS-1-DF
T	Emergi-Lite	PGLUXAC-H
V	Axis Ltg	RAY8P-VL-RG-4-EX-T8-3-W-UNV-ERS-1-SA
W	Metalux	CFF-12-232-UNV-IK12-ALP
BB	Axis Ltg	RAY8P-VL-RG-4-EX-T8-2-W-UNV-ERS-1-SA

Item 2-34: Section 27 51 23 – Intercom System

Teradon is an approved manufacturer of the intercom system subject to compliance with the specifications.

Drawings

Item 2-35: Sheet E5.01 Electrical Schedules

Refer to the light fixture schedule: Type 'M' shall be changed to a Alera catalog number: S6-4-2D-T8-PM**-A12-EPU-MW or engineer approved equal.

END OF ADDENDUM NO. 2

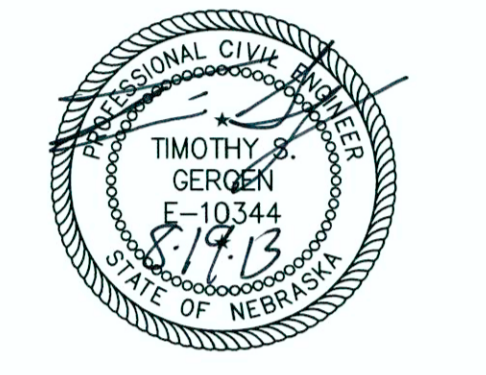

STORM SEWER CONSTRUCTION NOTES

- A** N: 415579.52
E: 1892099.77
END OF FLARED END SECTION
FL(15")=2101.00
- B** ~~N: 415520.45
E: 1892058.15~~
BUILD
1-22" STRAIGHT CURB INLET
TC EL.=~~2110.82~~ 2110.82
FL(15")=2107.00
- C** ~~N: 415475.45
E: 1892073.17~~
BUILD
1-22" STRAIGHT CURB INLET
TC EL.=~~2110.30~~ 2110.30
FL(15")=~~2107.15~~ 2107.24
- D** N: 415499.35
E: 1891994.22
END OF FLARED END SECTION
FL(15")=2108.80
- E** N: 415489.97
E: 1891959.72
END OF FLARED END SECTION
FL(15")=2109.00
- F** N: 415403.10
E: 1891764.66
BUILD
1-TYPE "H" GRATE INLET
PER DETAILS ON SHEET C3.04
RIM EL.=2114.00
FL(15")=2111.00
FL(12")=2111.00
- G** N: 415373.04
E: 1891670.11
BUILD
1-TYPE "H" GRATE INLET
PER DETAILS ON SHEET C3.04
RIM EL.=2114.00
FL(12")=2112.00
- H** ~~N: 415241.98
E: 1891667.51~~
BUILD
1-STORM SEWER MANHOLE
PER DETAILS ON SHEET C3.04
RIM EL.=~~2113.50~~ 2115.00
FL(15")=2106.70
FL(12")=2106.95
FL(8")=2107.28
- I** N: 415229.64
E: 1891590.39
BUILD
1-22" STRAIGHT CURB INLET
TC EL.=2116.50
FL(12")=2113.20
- J** ~~N: 415288.80
E: 1891646.05~~
INSTALL
2-12" X 10" TEE
1-CLEANOUT PER DETAIL ON THIS SHEET
INSTALL 18 LF OF DUAL 10" STORM
SEWER PIPE EAST
RIM EL.=~~2114.00~~ 2116.30
FL(12")=2108.50
FL(10")=2108.58
- K** ~~N: 415288.50
E: 1891759.81~~
BUILD
1-2216 CATCH BASIN
PER DETAILS ON SHEET C3.04
RIM EL.=~~2114.00~~ 2114.15
FL(12")=2109.00
- L** ~~N: 415307.97
E: 1891792.69~~
BUILD
1-2216 CATCH BASIN
PER DETAILS ON SHEET C3.04
INSTALL 33 LF OF DUAL 10" STORM
SEWER PIPE EAST
RIM EL.=~~2114.00~~ 2114.15
FL(12")=2109.34
FL(10")=2109.34
- M** N: 415295.97
E: 1891661.69
CONNECT TO 10" STORM SEWER
ROOF DRAIN AND OVERFLOW
FL(10")=2109.67
- N** REMOVE EXISTING STORM SEWER
STRUCTURES AND STORM SEWER PIPE
- O** CONVERT EXISTING STORM SEWER INLET
TO MANHOLE
- P** N: 415314.51
E: 1891922.98
CONNECT TO 10" STORM SEWER
ROOF DRAIN AND OVERFLOW
FL(10")=2109.67
- Q** N: 415295.97
E: 1891661.69
CONNECT TO 10" STORM SEWER
ROOF DRAIN AND OVERFLOW
FL(10")=2109.67
- R** N: 415257.30
E: 1891697.91
INSTALL 12" X 6" TEE, ROTATE
TEE TO TOP OF PIPE
CONNECT TO TRENCH DRAIN, REFER TO
ARCHITECTURAL PLANS FOR TRENCH
DRAIN SPECIFICATIONS
FL(12")=2107.63
6" INVERT AT DRAIN=2112.50

- BENCHMARKS**
- #1. ROD NEAR GROUND
EL.=2117.08
 - #2. T.O.A. FIRE HYDRANT
EL.=2087.29
 - #3. T.O.A. FIRE HYDRANT
EL.=2123.99

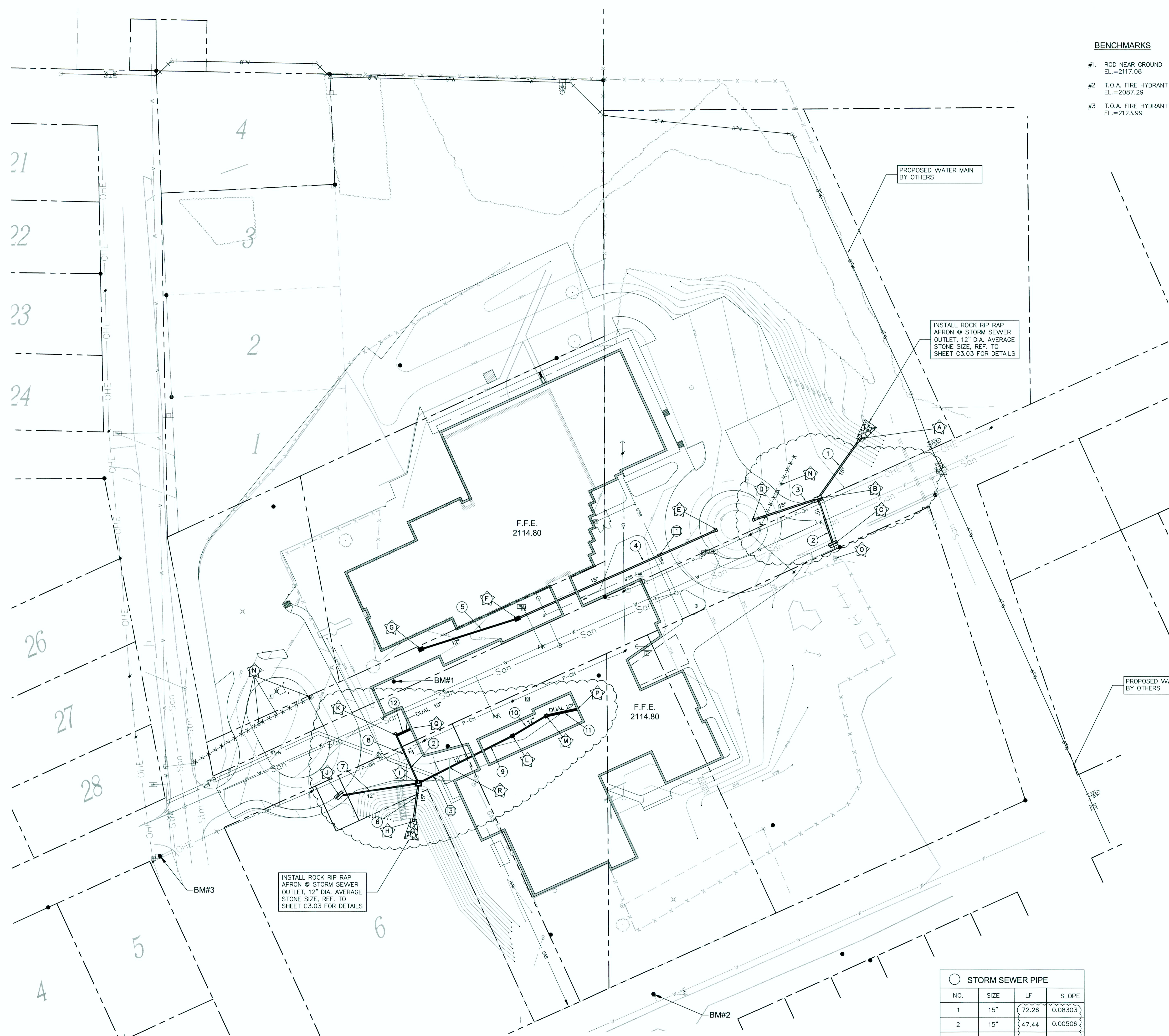

INSTALL ROCK RIP RAP APRON @ STORM SEWER OUTLET, 12" DIA. AVERAGE STONE SIZE, REF. TO SHEET C3.03 FOR DETAILS

INSTALL ROCK RIP RAP APRON @ STORM SEWER OUTLET, 12" DIA. AVERAGE STONE SIZE, REF. TO SHEET C3.03 FOR DETAILS

PROPOSED WATER MAIN BY OTHERS

LEGEND

- 184 ——— EXISTING CONTOUR
- 184 ——— PROPOSED CONTOUR
- OHE ——— EXISTING OVERHEAD ELECTRICAL
- SAN ——— EXISTING SANITARY SEWER LINE
- W ——— EXISTING WATER LINE
- X ——— EXISTING FENCE LINE
- STM ——— EXISTING STORM DRAIN LINE
- PROPOSED STORM DRAIN PIPE
- XXXXXXXXXXXXX STORM SEWER PIPE TO BE REMOVED

CROSSING TABLE

NO.	PROF.	PROP.
1	PROP. 6" SANITARY SEWER = 2108.39	PROP. 15" STORM SEWER = 2109.78
2	PROP. 6" & 4" WATER = 2110.00	PROP. 12" STORM SEWER = 2107.46
3	PROP. 6" & 4" WATER = 2109.25	PROP. 12" STORM SEWER = 2107.25

STORM SEWER PIPE

NO.	SIZE	LF	SLOPE
1	15"	72.26	0.08303
2	15"	47.44	0.00506
3	15"	67.31	0.02674
4	15"	213.53	0.00937
5	12"	99.21	0.01008
6	15"	37.71	0.09812
7	12"	78.11	0.08002
8	12"	51.50	0.03010
9	12"	103.35	0.01984
10	12"	38.22	0.00890
11	DUAL 10"	31	0.01065
12	DUAL 10"	14.92	0.06702

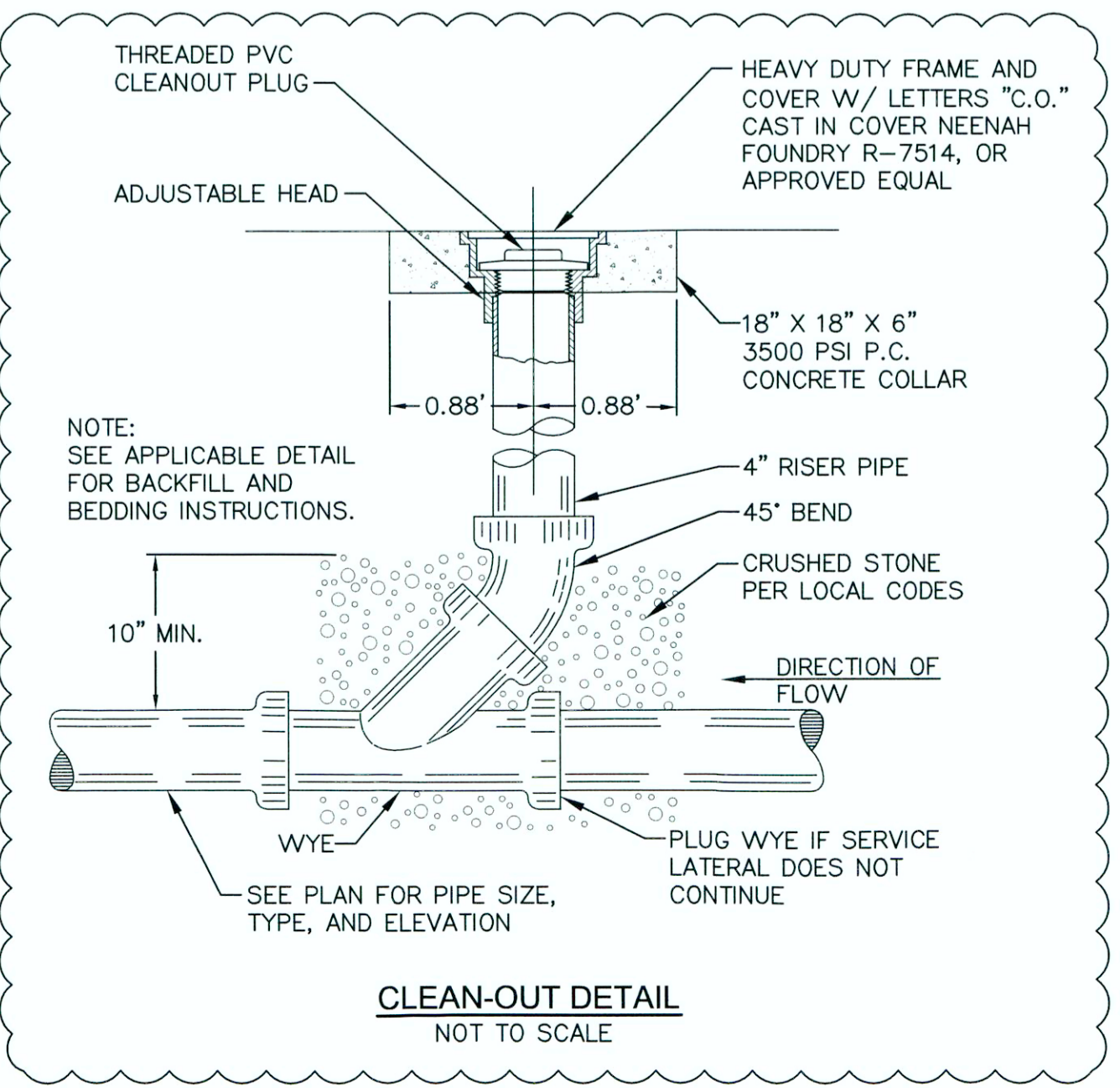

FINISH MATERIALS LIST	
CARPET TILE	
CPT-1	MANUFACTURER: INTERFACE PRODUCT: CUBIC COLOR: STRAIGHT, 4854 INSTALLATION METHOD: NON DIRECTIONAL
CPT-2	MANUFACTURER: INTERFACE PRODUCT: ON LINE COLOR: LINE, 103786 INSTALLATION METHOD: ASHLAR
CPT-3	MANUFACTURER: INTERFACE PRODUCT: ON LINE COLOR: LAPS, 103789 INSTALLATION METHOD: ASHLAR
CPT-4	MANUFACTURER: INTERFACE PRODUCT: ON LINE COLOR: MANDARIN, 103803 INSTALLATION METHOD: ASHLAR
CPT-5	MANUFACTURER: INTERFACE PRODUCT: SQUARED OFF, CONFIGURATION COLOR: SPARKLERS INSTALLATION METHOD: NON DIRECTIONAL
CPT-6	MANUFACTURER: INTERFACE PRODUCT: ENTRY LEVEL COLOR: BLACK, 7187 INSTALLATION METHOD: NON DIRECTIONAL
CPT-7	MANUFACTURER: INTERFACE PRODUCT: ON LINE COLOR: POPPY, 103801 INSTALLATION METHOD: ASHLAR
CPT-8	MANUFACTURER: INTERFACE PRODUCT: ON LINE COLOR: PEWTER, 103787 INSTALLATION METHOD: ASHLAR
MARMOLEUM COMPOSITION FLOORING	
MCS-1	MANUFACTURER: FORBO PRODUCT: MCS - MARMOLEUM COMPOSITION SHEET GOODS COLOR: CONCRETE, 3136
MCS-2	MANUFACTURER: FORBO PRODUCT: MCS - MARMOLEUM COMPOSITION SHEET GOODS COLOR: CHARTREUSE, 3224
MCS-3	MANUFACTURER: FORBO PRODUCT: MCS - MARMOLEUM COMPOSITION SHEET GOODS COLOR: LAGUNA, 3238
MCS-4	MANUFACTURER: FORBO PRODUCT: MCS - MARMOLEUM COMPOSITION SHEET GOODS COLOR: KYOTO, 3126
MCS-5	MANUFACTURER: FORBO PRODUCT: MCS - MARMOLEUM COMPOSITION SHEET GOODS COLOR: BLEECKER STREET, 3127
MCS-6	MANUFACTURER: FORBO PRODUCT: MCS - MARMOLEUM COMPOSITION SHEET GOODS COLOR: SERENE GREY, 3146
CERAMIC TILE	
PCT-1	MANUFACTURER: AMERICAN OLEAN PRODUCT: DECORUM COLOR: IBEA, WHITE, DR01 SIZE: 12" x 12"
PCT-2	MANUFACTURER: AMERICAN OLEAN PRODUCT: KAJAHARI COLOR: GREY, SEM-POLISHED SIZE: 12" x 24"
PCT-3	MANUFACTURER: AMERICAN OLEAN PRODUCT: ULTRA TECH COLOR: GRAY SCALE J023, UNPOLISHED SIZE: 24" x 24"
PCT-4	MANUFACTURER: DALITILE PRODUCT: GALLERY NEXT BY DALITILE, COLORBODY PORCELAIN COLOR: RED, J504, UNPOLISHED SIZE: 12" x 24"
PCT-5	MANUFACTURER: DALITILE PRODUCT: GALLERY NEXT BY DALITILE, COLORBODY PORCELAIN COLOR: YELLOW, J501, UNPOLISHED SIZE: 12" x 24"
PCT-6	MANUFACTURER: DALITILE PRODUCT: GALLERY NEXT BY DALITILE, COLORBODY PORCELAIN COLOR: LINE, J502, UNPOLISHED SIZE: 12" x 24"
PCT-7	MANUFACTURER: DALITILE PRODUCT: GALLERY NEXT BY DALITILE, COLORBODY PORCELAIN COLOR: BLUE, J505, UNPOLISHED SIZE: 12" x 24"
CERAMIC TILE	
CT-1	MANUFACTURER: AMERICAN OLEAN PRODUCT: BRIGHT FIELD TILE COLOR: ICE WHITE, A005 SIZE: 6" x 6" FIELD TILE & CORRESPONDING SURFACE BULLNOSE S-4669
CT-2	MANUFACTURER: EPOCA CERAMICHE PRODUCT: DESIGN POSITIVE HOME COLOURS COLOR: JAUNE ANIS 03 SIZE: 8" x 20"
CT-3	MANUFACTURER: EPOCA CERAMICHE PRODUCT: DESIGN POSITIVE HOME COLOURS COLOR: BLEU ATOLL 05 SIZE: 8" x 20"
CT-4	MANUFACTURER: EPOCA CERAMICHE PRODUCT: DESIGN POSITIVE HOME COLOURS COLOR: ROUGE ROUGE 05 SIZE: 8" x 20"
CT-5	MANUFACTURER: AMERICAN OLEAN PRODUCT: BRIGHT FIELD TILE COLOR: RUBY RED, 0121 SIZE: 6" x 6" FIELD TILE
CT-6	MANUFACTURER: AMERICAN OLEAN PRODUCT: CERAMIC MOSAICS COLOR: BUFF GRANITE, 0402 SIZE: 2" x 2" FIELD TILE
QUARRY TILE	
QT-1	MANUFACTURER: AMERICAN OLEAN PRODUCT: QUARRY NATURALS COLOR: SHADOW GRAY, 146 SIZE: 8" x 8" x 1/2" FIELD TILE
QB-1	MANUFACTURER: AMERICAN OLEAN PRODUCT: QUARRY NATURALS, QUARRY BASE COLOR: SHADOW GRAY, 146 SIZE: 8" x 8" COVE BASE, Q-385U
WALL COVERING	
WC-1	MANUFACTURER: D.L. COUCH PRODUCT: ACUSTICORD COLOR: SUNBURST, ACS-16
WC-2	MANUFACTURER: D.L. COUCH PRODUCT: ACUSTICORD COLOR: CITRUS, ACS-26
WC-3	MANUFACTURER: D.L. COUCH PRODUCT: ACUSTICORD COLOR: OCEAN, ACS-22
WC-4	MANUFACTURER: D.L. COUCH PRODUCT: ACUSTICORD COLOR: CANARY, ACS-11
WC-5	MANUFACTURER: D.L. COUCH PRODUCT: ACUSTICORD COLOR: SAPPHIRE, ACS-14

PAINT	
PT-1	MANUFACTURER: SHERWIN WILLIAMS (GENERAL WALLS) COLOR: SHOU WHITE, SW 7042
PT-2	MANUFACTURER: SHERWIN WILLIAMS COLOR: OPTICAT GREEN, SW 6708
PT-3	MANUFACTURER: SHERWIN WILLIAMS COLOR: SLICK BLUE, SW 6949
PT-4	MANUFACTURER: SHERWIN WILLIAMS COLOR: DAREDEVEL, SW 6882
PT-5	MANUFACTURER: SHERWIN WILLIAMS COLOR: GUSTO GOLD, SW 6904
PT-6	MANUFACTURER: SHERWIN WILLIAMS COLOR: BLUE CHIP, SW 6959
PT-7	MANUFACTURER: SHERWIN WILLIAMS COLOR: MINDFUL GRAY, SW 7016
PT-8	MANUFACTURER: SHERWIN WILLIAMS COLOR: REAL RED, SW 6868
PT-9	MANUFACTURER: SHERWIN WILLIAMS (CEILING) COLOR: CEILING BRIGHT WHITE, SW 7007
PT-10	MANUFACTURER: SHERWIN WILLIAMS COLOR: METALLIC COLOR TO MATCH CLEAR ANODIZED ALUM.
PT-11	MANUFACTURER: SHERWIN WILLIAMS COLOR: SFTWALD, SW 7074
WOOD STAIN	
ST-1	MANUFACTURER: SHERWIN WILLIAMS WOOD SPECIES: MAPLE STAIN COLOR: TO MATCH MARSHFIELD DOORS 'CLEAR 0-95'
WOOD	
WD-1	WOOD SPECIES: MAPLE CUT: QUARTER SAWN
SOLID SURFACE	
SS-1	MANUFACTURER: CORIAN (SILLS) PATTERN: CAKED WHITE
PLASTIC LAMINATE	
PL-1	MANUFACTURER: WILSONART PATTERN/COLOR: CRISP LINEN, 4942-38
PL-2	MANUFACTURER: WILSONART PATTERN/COLOR: MISTED ZEPHYR, 4843-40
PL-3	MANUFACTURER: WILSONART PATTERN/COLOR: MISTED ZEPHYR, CHEMSURF 390, 4843-40
PL-4	MANUFACTURER: NEVAMAR PATTERN/COLOR: SMOKY WHITE TEXTURED, S-7-27T
PL-5	MANUFACTURER: ABET LAMINATI PATTERN/COLOR: 46 (SE)
PL-6	MANUFACTURER: ABET LAMINATI PATTERN/COLOR: 42 (SE)
PL-7	MANUFACTURER: PONITE PATTERN/COLOR: ROYAL BLUE, SB009
PL-8	MANUFACTURER: PONITE PATTERN/COLOR: FORSYTHA, SY913
PL-9	MANUFACTURER: PONITE PATTERN/COLOR: BITTERSWEET, SQ312
RESILIENT BASE	
RB-1	MANUFACTURER: JOHNSONITE PRODUCT: 4" RUBBER BASE COLOR: PEARL, 22
RB-2	MANUFACTURER: JOHNSONITE PRODUCT: 4" RUBBER BASE COLOR: LEAFY, 263
RB-3	MANUFACTURER: JOHNSONITE PRODUCT: 4" RUBBER BASE COLOR: TIDEWATER, 192
RB-4	MANUFACTURER: JOHNSONITE PRODUCT: 4" RUBBER BASE COLOR: CARROT, 140
RB-5	MANUFACTURER: JOHNSONITE PRODUCT: 4" RUBBER BASE COLOR: GOLD RUSH, 134
RB-6	MANUFACTURER: JOHNSONITE PRODUCT: 4" RUBBER BASE COLOR: MARINE, 140
RB-7	MANUFACTURER: JOHNSONITE PRODUCT: 4" RUBBER BASE COLOR: MYSTIFY, 469
RB-8	MANUFACTURER: JOHNSONITE PRODUCT: 4" RUBBER BASE COLOR: BUCKLE, 294
RESILIENT STAIR NOSING/RESILIENT TREADS AND RISERS	
RTR-1/RSN-1	MANUFACTURER: JOHNSONITE PRODUCT: RUBBER TREADS AND RISERS HTR-469 AND VINYL STAIR NOSING RCN-469-B SIZE: SEE SPECIFICATION COLOR: MYSTIFY, 469
RESILIENT FLOORING	
RF-1	MANUFACTURER: DINO FLEX PRODUCT: RUBBER INTERLOCK TILES W/ ASSOCIATED REDUCER STRIPS SIZE: 37" x 37" x 1/2" COLOR: 30% RED, #318
VINYL COMPOSITION TILE	
VCT-1	MANUFACTURER: ARMSTRONG PRODUCT: STANDARD EXCELON VCT SIZE: 12" x 12" COLOR: PEWTER, S1908
ACOUSTICAL PANEL CEILING	
APC-1	MANUFACTURER: CERTAINTED PRODUCT: FINE FISSURED HIGH NRC, #HF 457 HRC SIZE: 24" x 24" x 1/2" LAY-IN FOR 15/16" GRID COLOR: WHITE
APC-2	MANUFACTURER: CERTAINTED PRODUCT: VINYL LOCK, #142-CRF-1 SIZE: 24" x 24" x 1/2" LAY-IN FOR 15/16" GRID COLOR: WHITE
APC-3	MANUFACTURER: CERTAINTED PRODUCT: Performa VOC Compliant Symphony I, #1342-KOF-1 SIZE: 24" x 24" x 1/2" LAY-IN FOR 15/16" GRID COLOR: WHITE
CUBICLE (CURTAIN) FABRIC	
CF-1	MANUFACTURER: DESIGNTX PATTERN: SYNERGY 8035-901 COLOR: CANYON
WINDOW COVERINGS	
WIC-1	MANUFACTURER: MECHOSHAD PRODUCT: MANUAL CLUTCH SINGLE ROLLER SHADE WITH RECESSED CEILING POCKET, 3% OPENNESS FABRIC/COLOR: EURO TWILL 6000 SERIES CHARCOAL 4012
WIC-2	MANUFACTURER: MECHOSHAD PRODUCT: MANUAL CLUTCH SINGLE ROLLER SHADE WITH SURFACE MTD. CEILING POCKET, 3% OPENNESS FABRIC/COLOR: EURO TWILL 6000 SERIES CHARCOAL 4012
TACKLE WALL SURFACE	
TWS-1	MANUFACTURER: FORBO PRODUCT: FORBO BULLETIN BOARD TACKLE SURFACE COLOR: 2162

- FINISH NOTES:**
- RESILIENT BASE TO COORDINATE WITH WALL ACCENT PAINT COLORS AS FOLLOWS:
 PT-1, RB-1 PT-2, RB-2
 PT-3, RB-3 PT-4, RB-4
 PT-5, RB-5 PT-6, RB-6
 PT-7, RB-7 PT-8, RB-8
 - INSTALL COVED RUBBER BASE OVER HARD SURFACE FLOORS, STRAIGHT OVER CARPET
 - REFER TO REFLECTED CEILING PLAN FOR CEILING DESIGN, HEIGHT, MATERIALITY
 - PAINT KITCHEN AND ASSOCIATED PREP AND DISH AREAS WITH EPOXY WALL PAINT (WHERE NOT RECEIVING CERAMIC TILE)
 - INFILL PRECAST PANEL JOINTS BEHIND RUBBER BASE WITH JOINT SEALANT, TYP.
 - INSTALL CT-1 ON TWO WALLS ADJACENT TO MOP SINKS, 12" PAST AND 48" ABOVE.

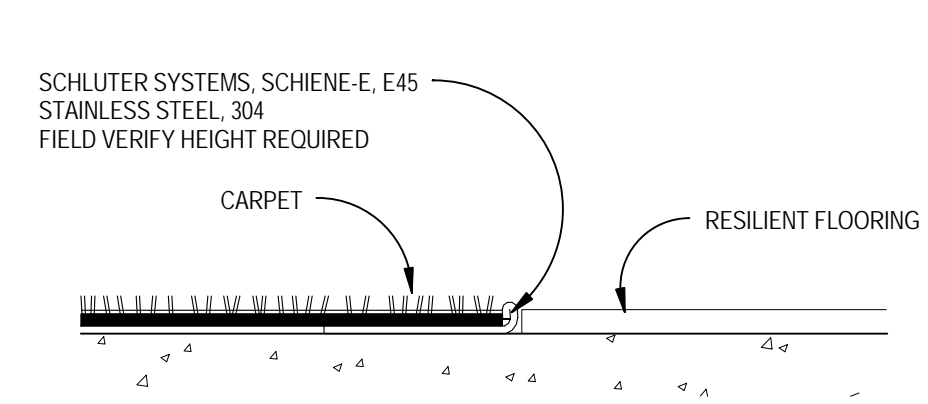

1 TE-1 CPT to MCS
SCALE: 12" = 1'-0"

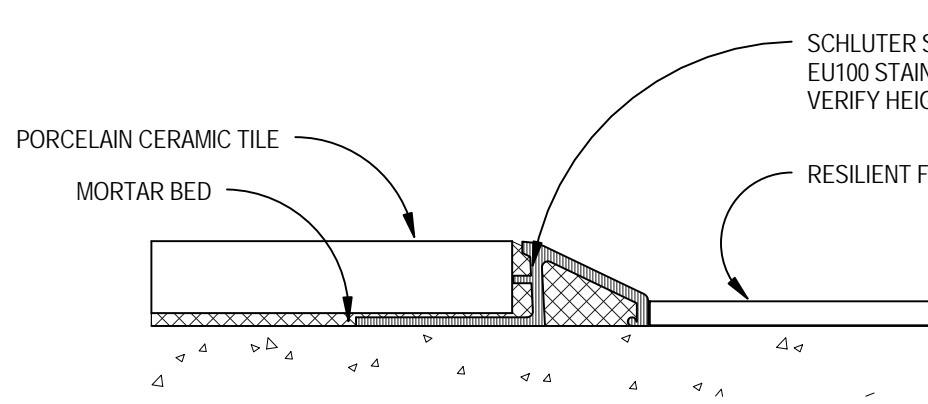

2 TE-2 PCT to MCS
SCALE: 12" = 1'-0"

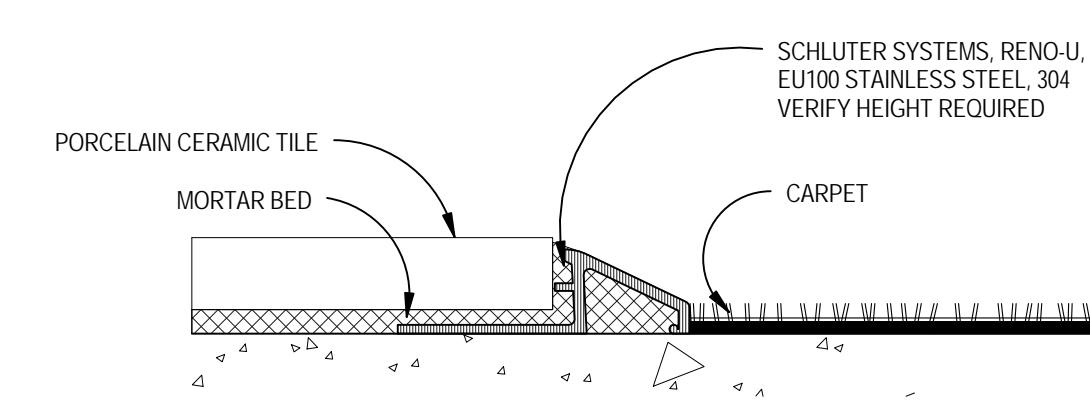

3 TE-3 PCT to CPT
SCALE: 12" = 1'-0"

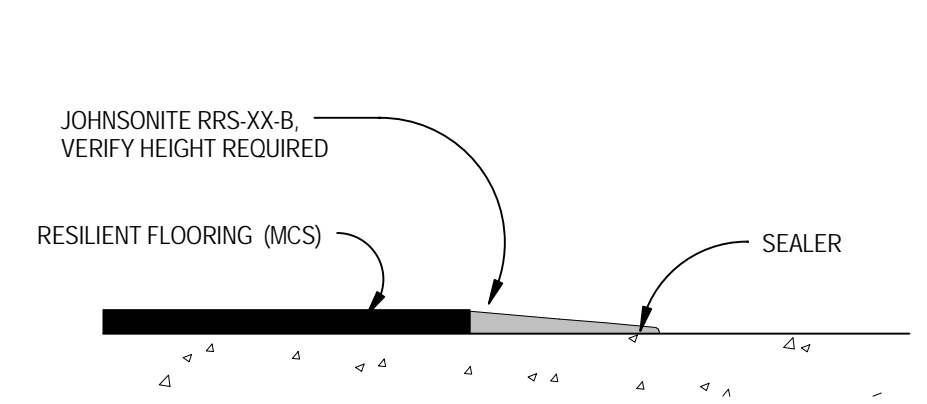

4 TE-4 MCS to SEALER
SCALE: 12" = 1'-0"

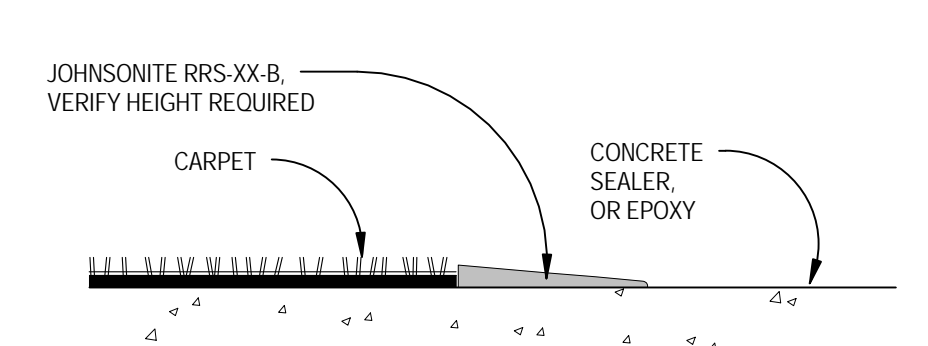

5 TE-5 CPT to SEALER
SCALE: 12" = 1'-0"

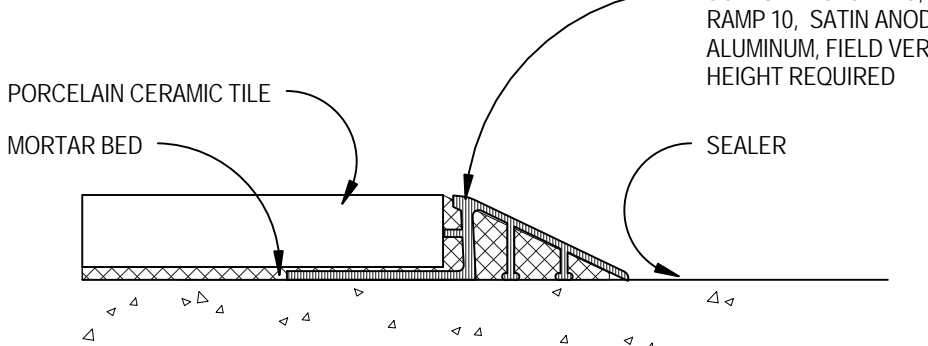

6 TE-6 PCT to SEALER
SCALE: 12" = 1'-0"

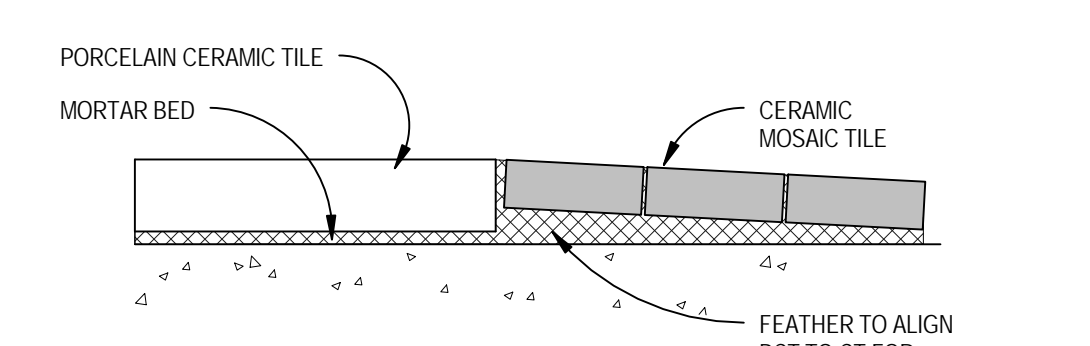

7 TE-7 PCT to CT
SCALE: 12" = 1'-0"

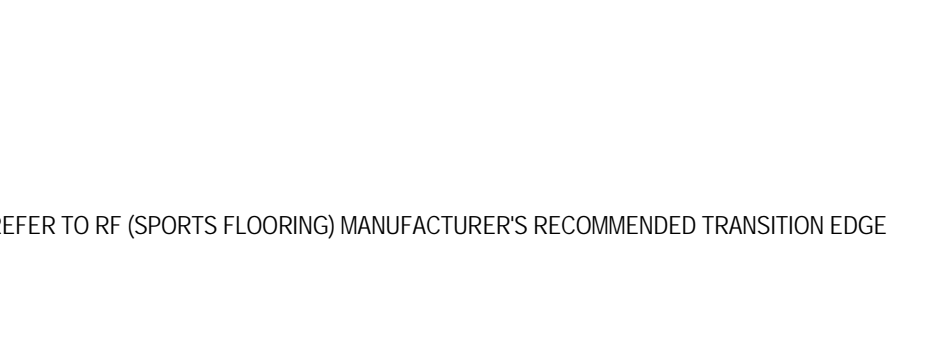

8 TE-8 RF to
SCALE: 12" = 1'-0"

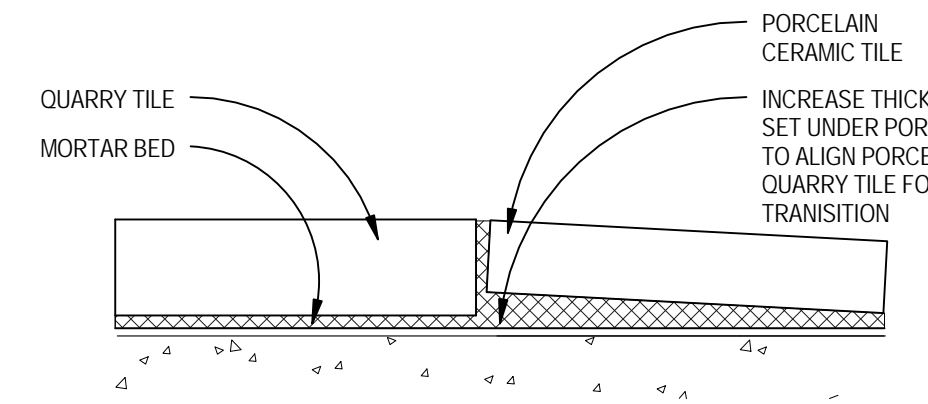

9 TE-9 PCT to QT
SCALE: 12" = 1'-0"

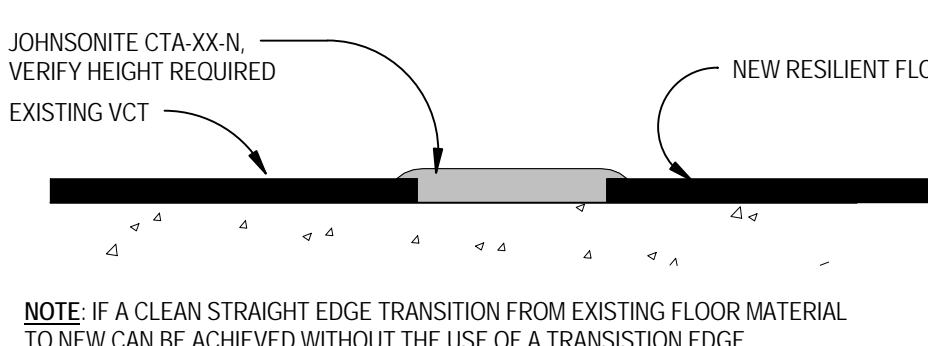

11 TE-11 EXG. VCT to MCS
SCALE: 12" = 1'-0"

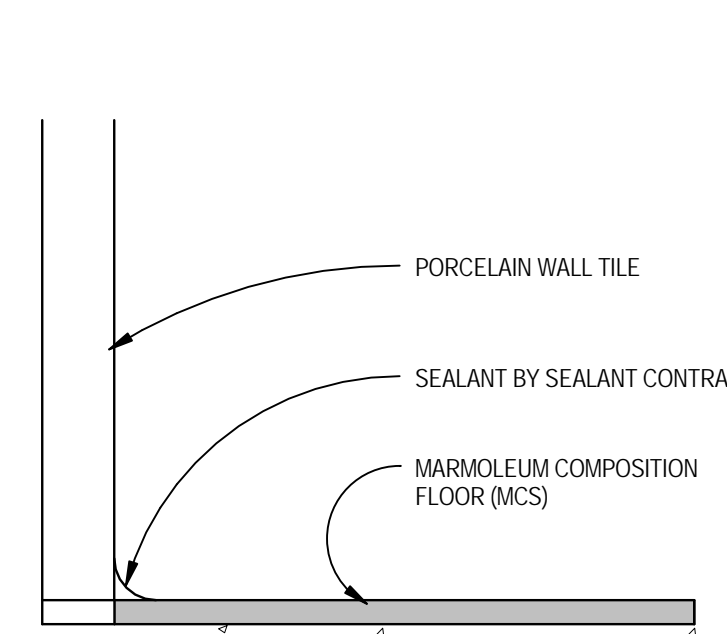

PCT Wall to MCS Floor Transition
SCALE: 12" = 1'-0"

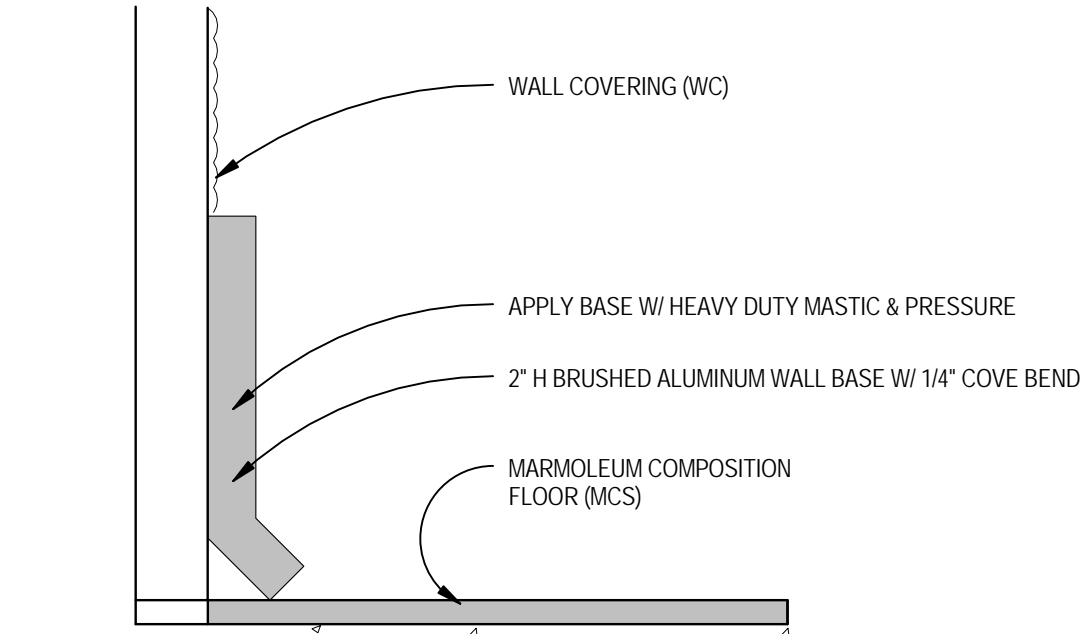

WC at Wall to MCS Floor Transition
SCALE: 12" = 1'-0"

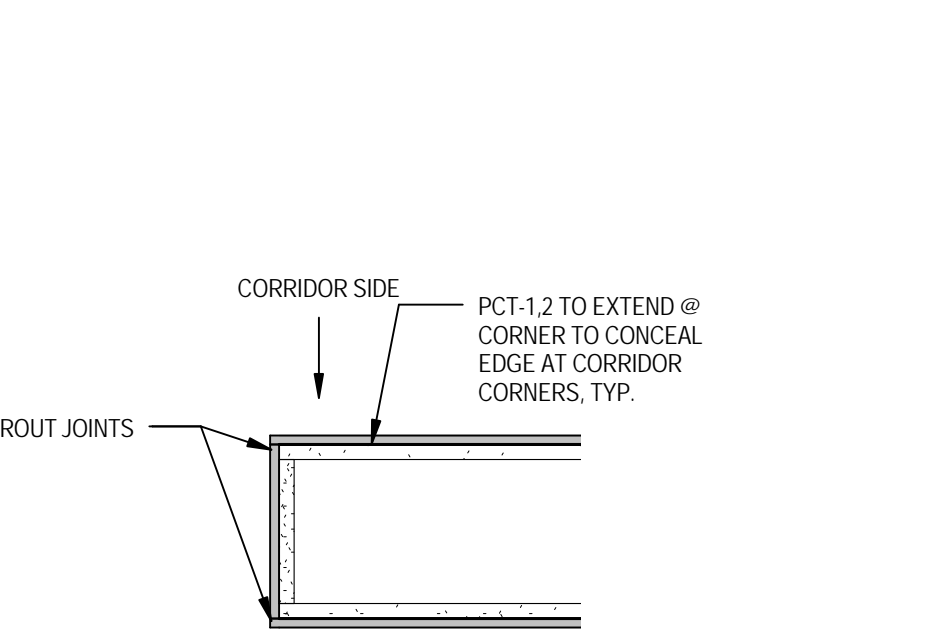

10 WALL PCT TYP. CORNER DETAIL
SCALE: 1 1/2" = 1'-0"

ROOM NUMBER	ROOM NAME	FLOOR		NORTH WALL		EAST WALL		SOUTH WALL		WEST WALL		CEILING		HT.	COMMENTS
		MTL.	FIN.	MTL.	FIN.	MTL.	FIN.	MTL.	FIN.	MTL.	FIN.	MTL.	FIN.		
A101	CLASSROOM	-	EXISTING	-	-	-	-	-	-	-	-	-	-	-	
A102	CLASSROOM	-	EXISTING	-	-	-	-	-	-	-	-	-	-	-	
A103	STORAGE	-	EXISTING	-	-	-	-	-	-	-	-	-	-	-	
A104	DARKROOM	-	EXISTING	-	-	-	-	-	-	-	-	-	-	-	
A104.1	FILM LOADING	-	EXISTING	-	-	-	-	-	-	-	-	-	-	-	
A105	CLASSROOM	-	EXISTING	-	-	-	-	-	-	-	-	-	-	-	
A106	CLASSROOM	-	EXISTING	-	-	-	-	-	-	-	-	-	-	-	
A106.1	STORAGE	-	EXISTING	-	-	-	-	-	-	-	-	-	-	-	
A107	CLASSROOM	-	EXISTING	-	-	-	-	-	-	-	-	-	-	-	
A108	SHOP	-	EXISTING	-	-	-	-	-	-	-	-	-	-	-	
A109	SHOP	-	EXISTING	-	-	-	-	-	-	-	-	-	-	-	
A110	CORRIDOR	-	EXISTING	-	-	-	-	-	-	-	-	-	-	-	
A110.1	VESTIBULE	-	EXISTING	-	-	-	-	-	-	-	-	-	-	-	
A111	PRODUCTION	-	EXISTING	-	-	-	-	-	-	-	-	-	-	-	
A112	CLASSROOM	EXISTING	CPT-1	RB-1.5	CMU	PT-1	GPW	PT-1	CMU	PT-1	CMU	PT-1	APC-17	-	RENOVATION
A113	CLASSROOM	EXISTING	CPT-1	RB-1.3	CMU	PT-1	GPW	PT-1	CMU	PT-1	GPW	PT-1	APC-17	-	RENOVATION
A114	FINISH ROOM	EXISTING	EXISTING	-	-	-	-	-	-	-	-	-	-	-	
A115	SHOP	-	EXISTING	-	-	-	-	-	-	-	-	-	-	-	
A116	SHOP	-	EXISTING	-	-	-	-	-	-	-	-	-	-	-	
A117	SHOP	-	EXISTING	-	-	-	-	-	-	-	-	-	-	-	
A118	VESTIBULE	-	EXISTING	-	-	-	-	-	-	-	-	-	-	-	
A119	CORRIDOR	EXISTING	EXISTING	-	CMU	PT-1	CMU	PT-1	-	CMU	PT-1	EXISTING	-	-	RENOVATION
A120	CORRIDOR	EXISTING	PCT-3	RB-1	EXG.	PT-1	-	-	EXG.	PT-1	EXG.	APC	-	-	RENOVATION
A121	GUIDANCE CONFERENCE	EXISTING	EXISTING	-	-	-	-	-	-	-	-	-	-	-	RENOVATION
A122	GUIDANCE OFFICE	EXISTING	EXISTING	-	-	-	-	-	-	-	-	-	-	-	RENOVATION
A123	CONFERENCE	EXISTING	CPT-1	RB-1.6	CMU	PT-1	CMU	PT-1	CMU	PT-1	CMU	PT-1	APC-1	-	RENOVATION
A124	MECHANICAL	EXISTING	EXISTING	-	-	-	-	-	-	-	-	-	-	-	RENOVATION
A125	CUSTODIAL	EXISTING	EXISTING	-	-	-	EXG. CMU	EXISTING	-	EXISTING	-	EXISTING	EXG. APC	-	RENOVATION
A126	CONCESSIONS	EXISTING	EXISTING	-	EXG. CMU	PT-1	EXG. CMU	PT-1	EXG. CMU	PT-1	EXG. CMU	PT-1	EXG. APC	-	RENOVATION
A127	WORKROOM	EXISTING	CPT-5	RB-1	EXG.	PT-1	GPW	PT-1	EXG.	PT-1	EXG.	APC-1	-	-	RENOVATION
A128	RESTROOM	EXISTING	EXISTING	-	-	-	-	-	-	-	-	-	-	-	RENOVATION
A129	MECHANICAL	EXISTING	EXISTING	-	-	-	-	-	-	-	-	-	-	-	RENOVATION
A130	GYMNASIUM	-	EXISTING	-	-	-	-	-	-	-	-	-	-	-	RENOVATION
A131	COMMONS	EXG. CONC/CONC	PCT-3	-	-	-	GPW/CMU	PCT-1,2,PT-1	CMU	PT-1	GPW/CMU	PCT-1,2,PT-1	EXG. APC/1,2,GPW	-/PT-9	RENOVATION
A132	MENS RESTROOM	EXISTING	EXISTING	-	-	-	-	-	-	-	-	-	-	-	RENOVATION
A133	WOMENS RESTROOM	EXISTING	EXISTING	-	-	-	-	-	-	-	-	-	-	-	RENOVATION
A134	WAREWASH	CONC	QT-1												