

LRC BUILDING #10 KITCHEN

2013 © COPYRIGHT
 PERMISSION TO REPRODUCE ANY PART OF THIS DOCUMENT IS HEREBY GRANTED SOLELY FOR THE PURPOSE OF THE CONSTRUCTION OF THE PROJECT OR THE ARCHIVING OF THIS PROJECT. UNAUTHORIZED USE OF THIS DOCUMENT WITHOUT THE WRITTEN PERMISSION OF SPECIALIZED ENGINEERING SOLUTIONS IS PROHIBITED BY COPYRIGHT LAW.
 DO NOT SCALE DRAWING. ALL DIMENSIONS AND CLEARANCES SHALL BE VERIFIED FROM APPROPRIATE SOURCES. ALL WORK SHALL BE COORDINATED PRIOR TO INSTALLATION. SEE SPECIFICATIONS.
 SPECIALIZED ENGINEERING SOLUTIONS
 10360 Ellison Circle Omaha, NE 68134
 Phone: 402.991.5520
 www.specializedeng.com
 SES PROJECT # 12205

INSTALL GREEN INSULATED GROUND WIRE WITH LIGHTING, RECEPTACLE AND EQUIPMENT BRANCH CIRCUITS.
 INSTALL INDIVIDUAL (DEDICATED) NEUTRAL CONDUCTORS FOR EACH 120V OR 277V PHASE CONDUCTOR SERVED FROM A SINGLE POLE CIRCUIT BREAKER

- SHEET NOTES**
- CONNECT HOOD ANSUL SYSTEM. COORDINATE WITH HOOD MANUFACTURER FOR EXACT LOCATION.
 - CONNECT HOOD LIGHTS. COORDINATE WITH HOOD MANUFACTURER FOR EXACT LOCATION.
 - PROVIDE HANGING CORD. SEE DETAIL 2 SHEET E3.3
 - COORDINATE WITH OWNER FOR SECURITY SYSTEM. PROVIDE WALL BOX AND ELECTRICAL STRIKE AS REQUIRED.
 - PROVIDE CONNECTION TO ROLLING DOOR MOTOR.
 - PROVIDE CONNECTION TO MUA-1 CONTROLS
 - PROVIDE CONNECTION TO HOOD CONTROLS

- GENERAL NOTES**
- REFER TO SHEET E3.1 FOR KITCHEN EQUIPMENT SCHEDULE AND MECHANICAL EQUIPMENT SCHEDULE.
 - COORDINATE ALL KITCHEN AND OWNER PROVIDED EQUIPMENT PRIOR TO ROUGHIN. COORDINATE POWER REQUIREMENTS.
 - REFER TO FS SERIES DRAWINGS AND CAPTIVE AIR APPENDIX DRAWINGS FOR MORE INFORMATION ON KITCHEN AND HOOD REQUIREMENTS.

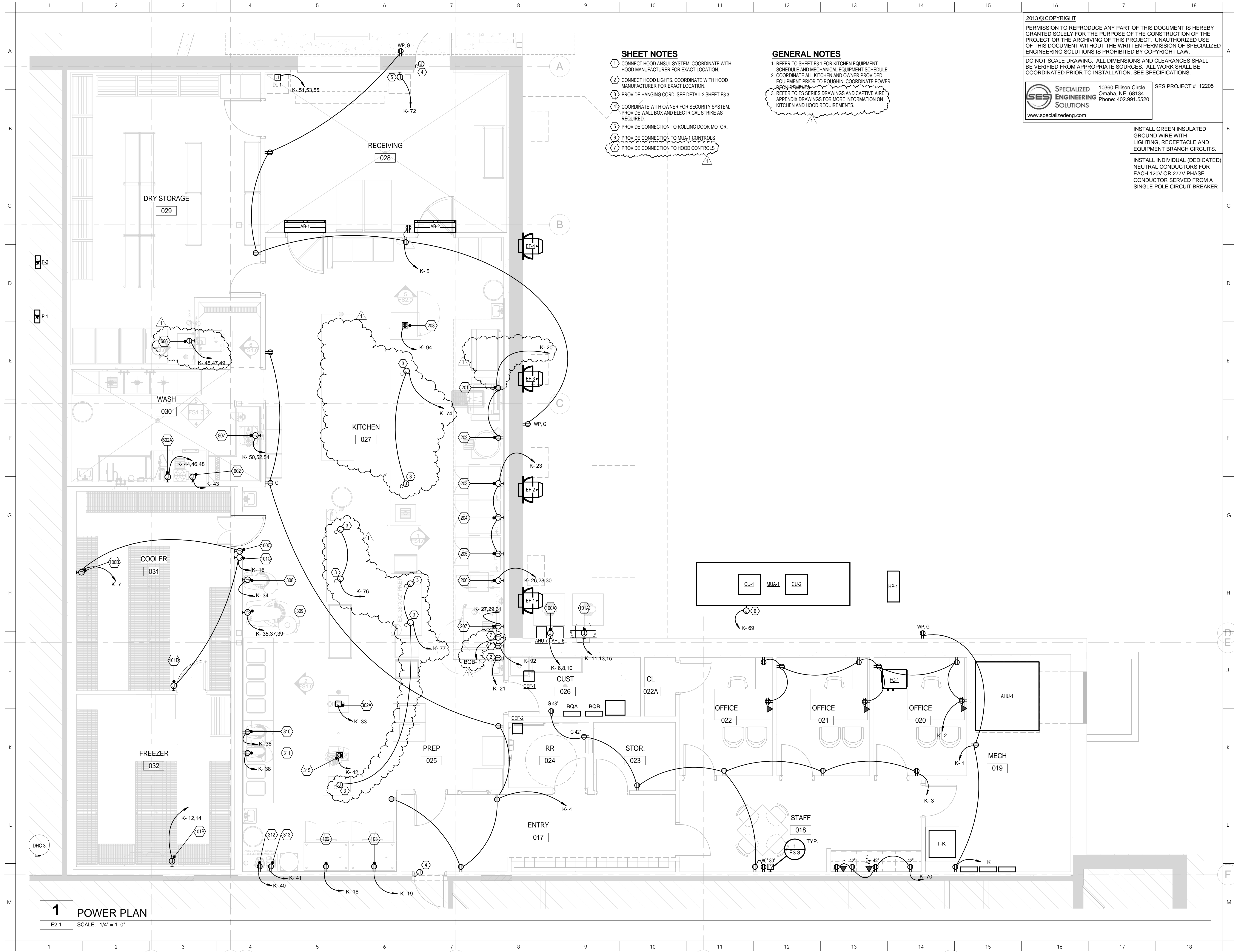

1 POWER PLAN
 E2.1 SCALE: 1/4" = 1'-0"

**ALLEY-POYNER
 MACCHIETTO
 ARCHITECTURE**
 1516 Cuming Street
 Omaha, NE 68102
 Ph: 402.341.1544
 Fx: 402.341.4735
 alleypoyner.com

CONSULTANTS

- CIVIL ENGINEER**
 Thompson, Dierssens, & Dornes, Inc.
 6341 Mill Road
 Omaha, NE 68154
 P (402) 330-8860 / F (402) 330-5866
- STRUCTURAL ENGINEER**
 Thompson, Dierssens, & Dornes, Inc.
 6341 Mill Road
 Omaha, NE 68154
 P (402) 330-8860 / F (402) 330-5866
- MECHANICAL ENGINEER**
 Specialized Engineering Solutions
 10360 Ellison Circle
 Omaha, NE 68134
 P (402) 991-5520 / F (402) 991-5394
- ELECTRICAL ENGINEER**
 Specialized Engineering Solutions
 10360 Ellison Circle
 Omaha, NE 68134
 P (402) 991-5520 / F (402) 991-5394
- FOOD SERVICE CONSULTANT**
 FOODLINES
 209 South 9th St
 Lincoln, NE 68508
 P (402) 475-1787 / F (402) 475-1800

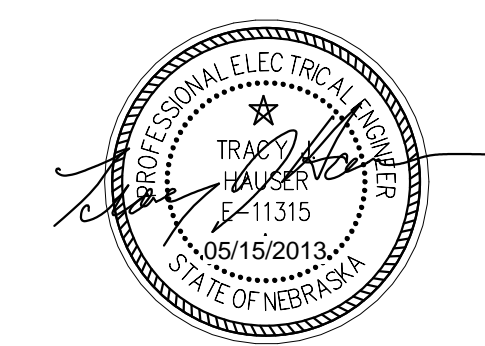

1 Addendum #1 05-28-2013
 REVISION DATE
 PROJECT NUMBER: 12166
 DATE: 05/15/2013
 COPYRIGHT © 2013
 ALLEY-POYNER MACCHIETTO ARCHITECTURE P.C.

POWER PLAN

E2.1