

TCEP No.: 787-002-12

### **ADDENDUM NO. 3**

The Architect/ Engineer issues this addendum, applicable to the above named project, to all known Contractors before receipt of proposal.

This addendum includes Item Number 3-1 thru 3-9. This addendum item shall be fully incorporated into the Bidding/Contract Documents and have the same force and effect as though originally included.

The Bidder shall acknowledge receipt of this Addendum No. 3 on the Bid Proposal Form in the place provided.

#### **GENERAL**

**Item 3-1: Section 00 70 00 – General Conditions**

- A. Plans have been submitted to the State Fire Marshal for review. Contractor shall coordinate with the City of Geneva for building permit requirements and process.
- B. Contractor to provide temporary fencing around the perimeter of all staging and dumpster areas. Size of area and location on site to be coordinate with the owner prior to construction. The parking lot to the east of the IT room or the grass areas to the north of the school are potential locations. All existing conditions disturbed by construction shall be repaired at the contractor's expense as part of the project.

**Item 3-2: Section 01 23 00 – Alternates**

Alternate Bid Item Clarifications:

- A. Refer to Alternate No. 1: Fire Sprinkler – Phase 1. This scope shall include all work associated with bringing the fire service into the building.
- B. Refer to Alternate No. 3: Provide and install mechanical system upgrades for IT room. Refer to sheet M1.01 IT HVAC Plan notes for additional information.
- C. Refer to Alternate No. 4: Provide and install ADA lift in IT Room: This alternates shall include all work associated with the installation of the lift including concrete, masonry, and steel work associated with the extension of the stair landing and the stairs.
- D. Refer to Alternate No. 5: Provide and install mechanical system upgrades for IT room. Refer to sheet M1.01 IT HVAC Plan notes for additional information.

TCEP No.: 787-002-12

## ARCHITECTURAL

### Drawings

#### Item 3-3: **Sheet A1.01 Floor Plans – Area A and B**

- A. Refer to Floor Plan – Area A, refer to sheet A2.01 and specification section 12 35 54 Wood Laboratory Casework for more information in regard to the student bench assemblies and the demonstration stations.
- B. Refer to Workroom 129; modify the designation of the marker board located on the south wall from MB-1 to MB-2.
- C. Refer to Wall Type Schedule, Type 2B, Rigid insulation shall be: Extruded Polystyrene Board Insulation: Rigid, cellular polystyrene thermal insulation with closed-cells and integral high density skin, formed by the expansion to comply with ASTM C 578.

#### Item 3-4: **Sheet A3.01 Building Cross Sections, Wall Sections & Stair Sections**

Add detail 9, supplemental drawing SDA-001 for a clarification of the construction of the stair extension construction south of the new ADA lift.

### Specifications

#### Item 3-5: **Section 04 20 00 – Unit Masonry**

Refer to section 3.14, A, contractor shall be responsible for all testing.

#### Item 3-6: **Section 11 53 13 – Laboratory Fume Hoods**

- A. Refer to section 2.1, A, subject to compliance with the requirements of the section, add Air Master Systems as an acceptable manufacturer.
- B. Refer to paragraph 2.5.A Acid Storage Cabinets. Replace “Where indicated acid storage cabinets shall be of wood construction.” With “Where indicated acid storage cabinets shall be of **metal** construction.”

#### Item 3-7: **Section 12 35 54 – Wood Laboratory Casework**

Refer to section 2.11, B, modify the title from Student Laboratory Tables to Student Bench Assembly. Refer to sheet A2.01 for more information.

#### Item 3-8: **Section 14 41 21 – Vertical Platform Lift**

Refer to section 2.1, F, please note that either battery operated drive with an automatic charging system or battery powered emergency lowering are both acceptable design solutions.

TCEP No.: 787-002-12

## **MECHANICAL**

### **Drawings**

#### **Item 3-9: Sheet M3.01 – First Floor Fire Protection Plan**

- A. Refer to the attached existing reflected ceiling plan sheet A-7 for general information in regard to the existing ceiling finish. Contractor shall verify all existing field conditions.
- B. All piping shall be routed concealed where possible. If there are locations at gypsum board or plaster ceilings where it is not feasible to conceal the piping or install side wall heads the piping may be routed exposed located in the most inconspicuous location possible. Review all exposed piping locations with the Architect / Engineer during the shop drawing phase for final acceptance.

END OF ADDENDUM NO. 3

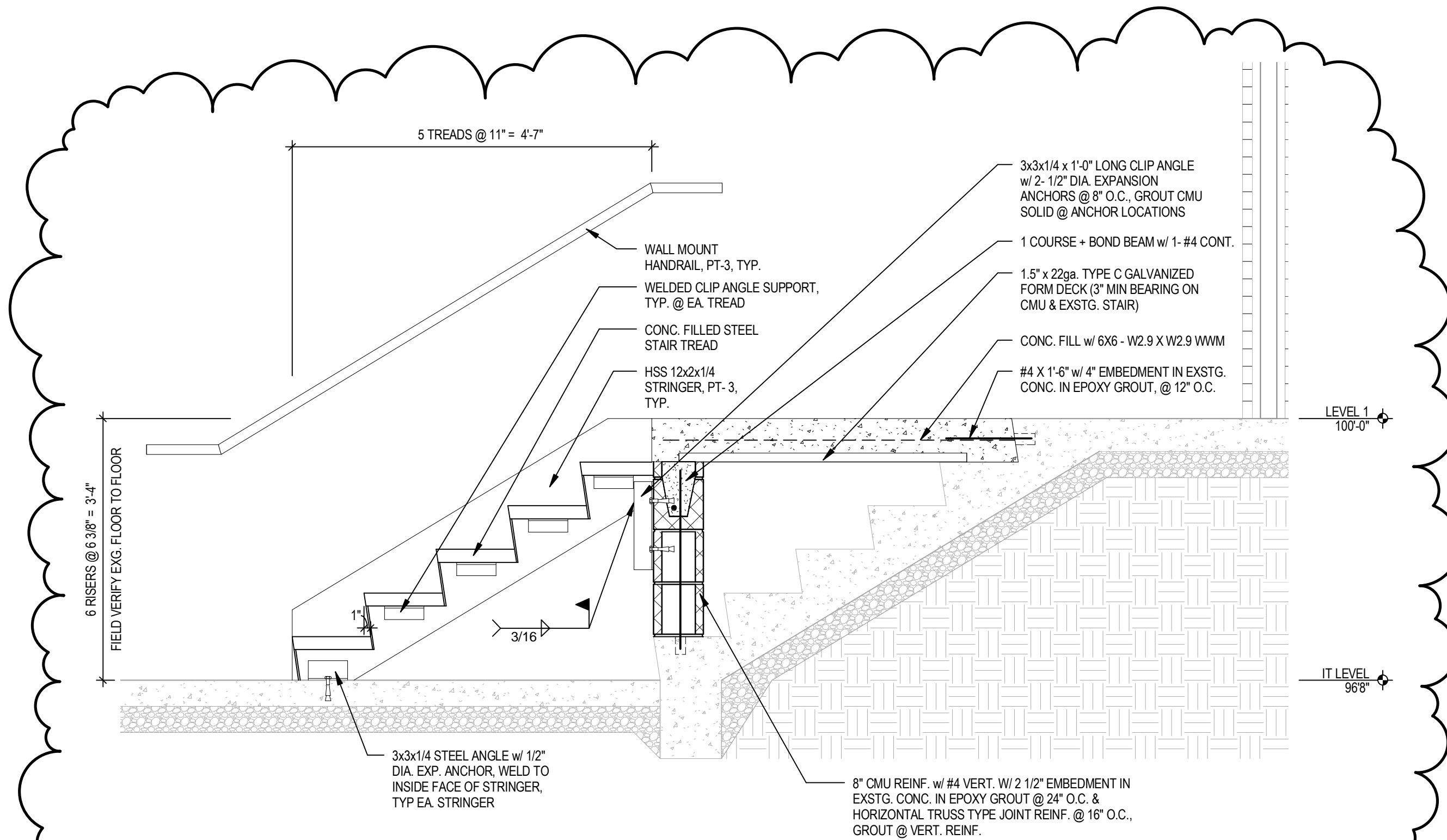

**9 STAIR & ADA LIFT SECTION**  
SCALE: 3/4" = 1'-0"

**Fillmore Central**  
1410 'L' Street  
Geneva, Nebraska 68361  
TCEP No.: 787-002-12

Addendum 3  
Supplemental Drawing: SDA #001  
Revision of Sheet: A3.01  
Date: 03/05/13

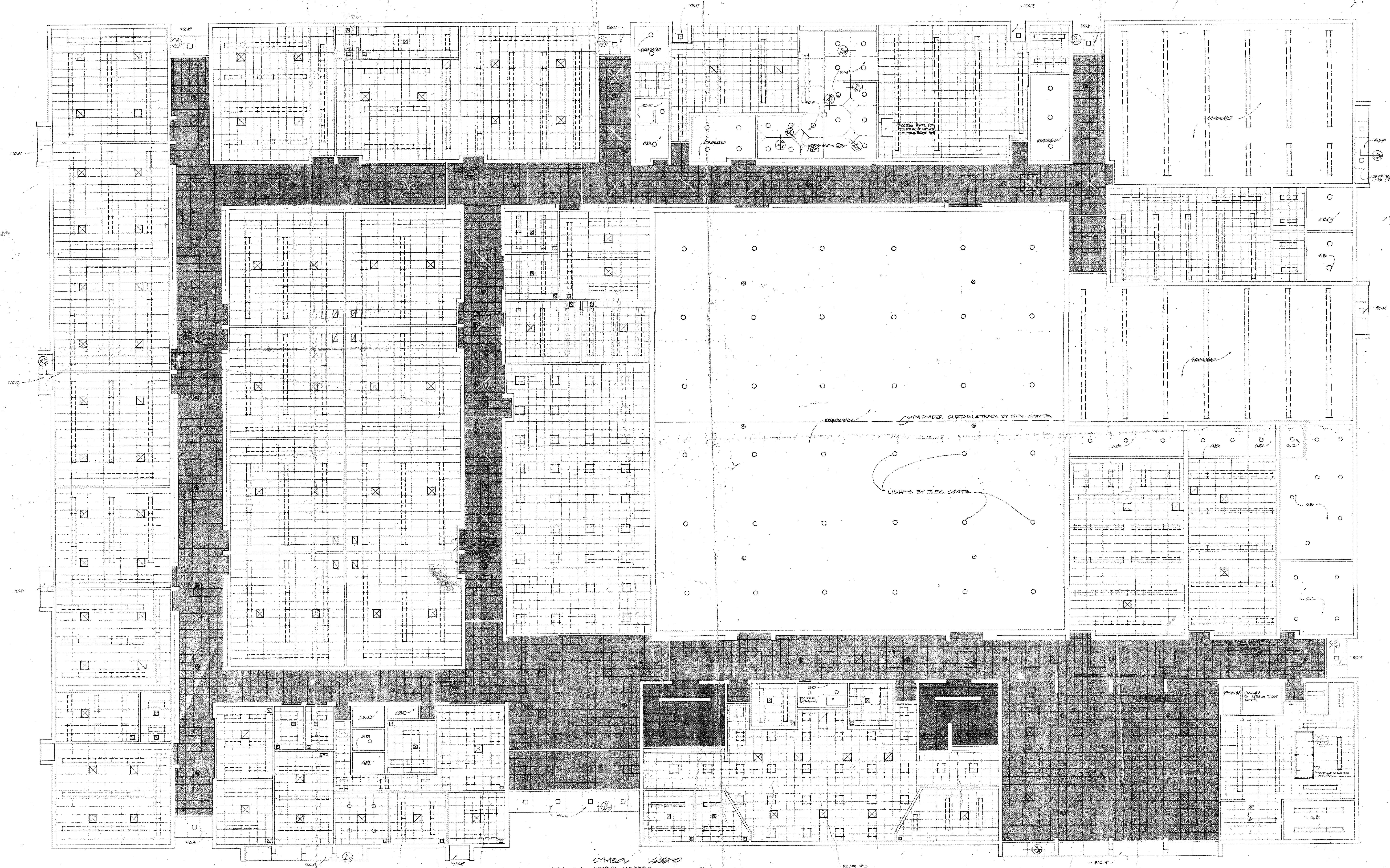

REFLECTED CEILING PLAN  
SCALE: 1/8" = 1'-0"

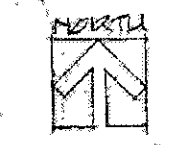

- SYMBOL LEGEND**
- SURFACE MOUNTED LIGHT FIXTURES
  - ⊗ DIMMER
  - ⊠ 5x2 ACOUSTIC BASKETS
  - 5x2 ACOUSTIC PANELS (FIRE RATED GIBB ASSEMBLY - UL DESIGN P-1616)
  - ▨ 5x4 ACOUSTIC PANELS

DETAIL 3"x3"