

# Letter of Transmittal



1102 Douglas on the Mall, Omaha, Nebraska 68102 (402) 346-7007

November 6, 2012      Omaha State Office Bldg Life Safety Upgrades 2012      Alvine No. 2011 2589

**To:**      See Bidders Lists      **From:**      Milena Palahanska Mavrov and Bob Foust

**Attn:**           **Re:**      Addendum 1

**cc:**

**Attached:**      Addendum      **Via:**      E-Mail

Copies	Date	No.	Description
1	11-06-12	1	Addendum 1- (15 Pages)

**Remarks:**

---

*If enclosures are not as noted, kindly notify us at once*

# Addendum 1



1800 O Street, Ste. 104, Lincoln, Nebraska 68508 (402) 477-6161

November 6, 2012 Life Safety Upgrades at Omaha State Office Building 2012

Alvine No. 2011 2589

**Bid Date:** November 13, 2012

*This addendum is hereby made a part of the contract documents to the same extent as though it were originally included therein. Specifications and drawings shall be considered modified or revised as hereinafter described. Revisions to the drawings are referenced by the drawing number.*

## Changes to the Project Manual

### General Items:

1. The Kiewit area of the building must have work done during off hours, which is 6:00 PM to 7:00 AM.
2. The Contractor may work in areas of the building other than the Kiewit area during normal business hours. Work performed between the hours of 9:00 PM and 6:00 AM must be scheduled with the Owner at least two days in advance. Work performed during weekend hours and State holidays must be scheduled with the Owner at least two days in advance.
3. The Contractor must get a State background check for all workers. There is no fee for this background check.
4. Smoking is not allowed in the building.
5. Replacement ceiling tiles may be obtained from Simpson Supply, Inc. The tile numbers are: Armstrong #A772A 2' x 5' x 5/8"; Armstrong #A769A 2' x 4' x 5/8".
6. The Lower Level has 6'-4" clearance. Vans and trucks with ladder racks are not allowed in this area.
7. If an area which has 5' ceiling tiles must have its grid and tiles removed in order to install new work, it would be permissible to replace with a standard 2' x 4' ceiling.
8. See attached Pre-bid Attendance Roster.

### Electrical Specification Items:

1ES1. Section 28 31 00 – Fire Detection and Alarm

1. 28 31 00-2, Article 2.01: Add the following:  
"H. Johnson Controls."

## **Changes to Drawings**

### Mechanical Drawing Items:

#### 1MD1. Sheet M000 – Mechanical Symbols, Abbreviations, Details, and Schedules – Mechanical

1. Revised Air Cooled Condensing Unit and DX Fan Coil Unit Schedules: See supplemental drawings MS-01 and MS-02 for additional information.

#### 1MD2. Sheet M101 – Floor Plans – Mechanical

1. Revised Lower Level Plan: See supplemental drawing MS-03 for additional information.
2. Revised Flag Notes 3, 4, and 5: See supplemental drawing MS-03 for additional information.

### Electrical Drawing Items:

#### 1ED1. Sheet E101 – Lower Level Plan – Lighting

1. See Sketch Sheet ES-01 for additional wiring to Condensing Unit CU-3.

#### 1ED2. Sheet E401 – Electrical Riser Diagram and Schedules

1. See Sketch Sheet ES-02 for revised Equipment Connection Schedule.
2. See Sketch Sheet ES-02 for revised Coordination Panel Schedule for 'LLSLL'.

RCF-MPM/mkm

Air Cooled Condensing Unit 2-15-2010

## AIR COOLED CONDENSING UNIT SCHEDULE

MARK		CU-1	CU-2	CU-3
SERVES		AC-2	AC-1	AC-3
LOCATION		WALL	WALL	WALL
CAPACITY (TONS)		1.5	1.0	1.0
COMPRESSOR TYPE		SCROLL	SCROLL	SCROLL
NUMBER OF COMPRESSORS		1	1	1
STEPS UNLOADING		-	-	-
REFRIGERANT		R-410A	R-410A	R-410A
AMBIENT TEMP (°F)		115	115	115
SOUND POWER (dBA) (1)		43	43	43
MINIMUM EER (AHRI)		8.0	10.1	10.1
ELECTRICAL DATA	UNIT KW	2.2	1.1	1.1
	VOLTS	208	208	208
	PHASE	1	1	1
	WIRE SIZING AMPS	13.0	13.0	13.0
	FUSE/BREAKER AMPS	20.0	15.0	15.0
DIMENSIONS (LxWxH) (IN)		32x12x24	32x12x24	32x12x24
OPERATING WEIGHT (LBS)		89	82	82
MANUFACTURER		mitsubishi	mitsubishi	mitsubishi
MODEL NUMBER		PUY-A18NHA4	PUY-A12NHA4	PUY-A12NHA4
REMARKS		(2) (3)	(2) (3)	(2) (3)

**REMARKS:**

- (1.) OVERALL "A" WEIGHTED SCALE IN ACCORDANCE WITH ARI STANDARD 370.
- (2.) PROVIDE WITH DEFROST / DEICING, RESTART DELAY, INVERTER, SELF DIAGNOSIS, SOFT START, AUTO RESTART, BUILT-IN LOW AMBIENT AND ANTI-CORROSION TREATMENT.
- (3.) PROVIDE WITH WALL MOUNTING BRACKETS.

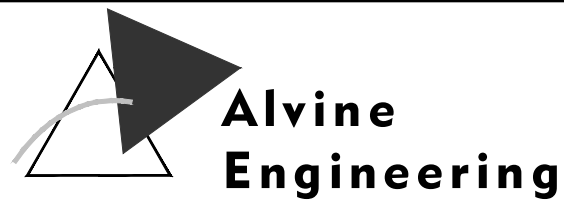

### LIFE SAFETY UPGRADES AT OMAHA STATE OFFICE BUILDING 2012

PROJECT NO.	DATE	REFERENCED:	M000	SKETCH
20112589	11/06/12	ADDENDUM NO.:	1	MS-01

FCUSCH 2-2-95

DX FAN COIL UNIT SCHEDULE				
MARK		AC-1	AC-2	AC-3
SERVES		SEE PLANS	SEE PLANS	SEE PLANS
LOCATION		WALL	WALL	WALL
TYPE		NON-DUCTED	NON-DUCTED	NON-DUCTED
MAX. WEIGHT (LBS)		29.0	29.0	29.0
AIRFLOW (CFM)		425	320	320
OUTDOOR AIR (CFM)		-	-	-
EXTERNAL SP (IN. W.C.)		-	-	-
COOLING COIL DATA	SENSIBLE COOLING (MBH)	-	-	-
	TOTAL COOLING (MBH)	18.00	12.00	12.0
	ENTERING AIR TEMP (WB/DB)(F)	80/67	80/67	80/67
	LEAVING AIR TEMP (WB/D)(F)	-	-	-
DIMENSIONS (LxWxH) (IN)		36x10x12	36x10x12	36x10x12
MOTOR DATA	VOLTS	208	208	208
	PHASE	1	1	1
	MCA	1.0	1.0	1.0
	MOP	-	-	-
	CONTROL DEVICE (BY OTHERS)	(1)	(1)	(1)
	REMARKS	-	-	-
ACCESSORIES		-	-	-
FILTERS		(3)	(3)	(3)
MANUFACTURER		MITSUBISHI	MITSUBISHI	MISTUBISHI
MODEL NUMBER		PKA-A18HA4	PKA-A12HA4	PKA-A12HA4
REMARKS		(2)	(2)	(2)

REMARKS:

- (1.) PROVIDE WITH WIRELESS 7 DAY PROGRAMMABLE REMOTE CONTROLLER.
- (2.) SINGLE POWER CONNECTION AT CONDENSING UNIT.
- (3.) PROVIDE WITH POLYPROPYLENE HONEYCOMB FILTER AND ACCESSORIES FOR INDOOR WALL MOUNTED UNIT.

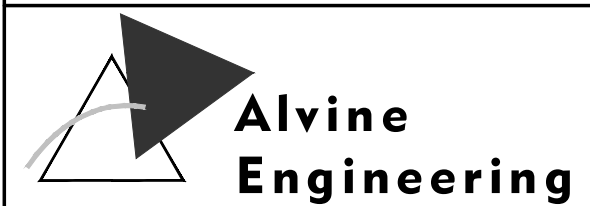

**LIFE SAFETY UPGRADES AT  
OMAHA STATE OFFICE BUILDING 2012**

PROJECT NO. 20112589	DATE 11/06/12	REFERENCED:	M000	SKETCH <b>MS-02</b>
		ADDENDUM NO.:	1	

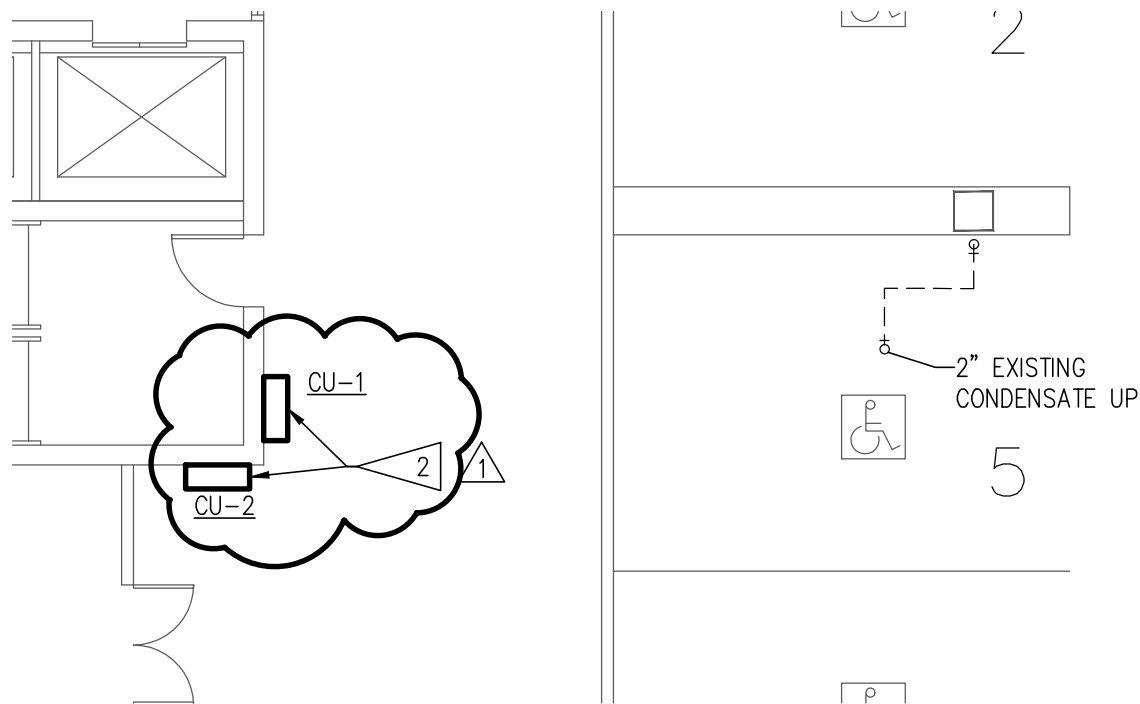

## FLAG NOTES

- 1 PROVIDE 3/4" CONDENSATE PIPE FROM AC-3 TO THIS LEVEL. EXTEND 3/4" CONDENSATE PIPE FROM FLOOR LEVEL WITH A FLEXIBLE PIPE TO FLOOR DRAIN IN THE SPACE.
- 2 INSTALL UNIT ON MOUNTING BRACKETS ON THE WALL. COORDINATE INSTALATION TO AVOID ANY CONFLICTS WITH OTHER WALL MOUNTED EQUIPMENT. INSTALL UNIT IN ACCORDANCE WITH MANUFACTURER'S REQUIREMENTS. PROVIDE ALL NECESSARY ACCESSORIES FOR A COMPLETE OPERATIONAL SYSTEM.
- 3 PROVIDE 1/4 RL AND 1/2 RS FROM UNIT AC-2 TO UNIT CU-2. INSTALL IN ACCORDANCE WITH MANUFACTURER'S RECOMMENDATIONS.
- 4 PROVIDE 1/4 RL AND 1/2 RS FROM UNIT AC-1 TO UNIT CU-1. INSTALL IN ACCORDANCE WITH MANUFACTURER'S RECOMMENDATIONS.
- 5 PROVIDE 1/4 RL AND 1/2 RS FROM UNIT AC-3 TO UNIT CU-3. INSTALL IN ACCORDANCE WITH MANUFACTURER'S RECOMMENDATIONS.
- 6 SEE SHEET EP101 FOR NEW WORK IN ELEVATOR SHAFTS.

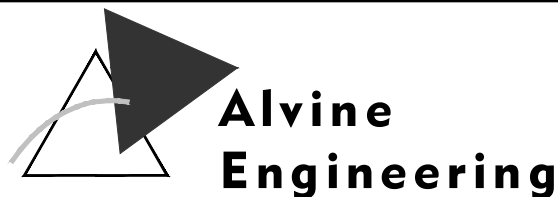

## LIFE SAFETY UPGRADES AT OMAHA STATE OFFICE BUILDING 2012

PROJECT NO.	DATE	REFERENCED:	M101	SKETCH
20112589	11/05/12	ADDENDUM NO.:	1	<b>MS-03</b>



# EQUIPMENT CONNECTION SCHEDULE

MARK	DESCRIPTION	HP	CIRCUIT BREAKER	VOLTS	PH	DISCONNECT (1)	FEEDER	REMARKS
AC-1	AIR CONDITIONING	-	-	208	1	30A. 3P NF	NOTE 1	NOTE 2
AC-2	AIR CONDITIONING	-	-	208	1	30A. 3P NF	NOTE 1	NOTE 3
AC-3	AIR CONDITIONING	-	-	208	1	30A. 3P NF	NOTE 1	NOTE 4
CU-1	CONDENSING UNIT	-	20/2	208	1	30A. 2P NF	2#10, #10 GND - 3/4"C.	
CU-2	CONDENSING UNIT	-	15/2	208	1	30A. 2P NF	2#12, #12 GND - 1/2"C.	
CU-3	CONDENSING UNIT	-	15/2	208	1	30A. 2P NF	2#12, #12 GND - 1/2"C.	

**NOTES:**

- 3#14, #14 GND, 600VOLT, DOUBLE INSULATED CABLE IN 3/4"C.
- AC-1 IS POWERED FROM CU-1.
- AC-2 IS POWERED FROM CU-2.
- AC-3 IS POWERED FROM CU-3.

## COORDINATION PANELS

PANEL DESIGNATION	QUANTITY AND SIZE BRANCHES		REMARKS
	ACTIVE	SPARE SPACE	
LLSL 208/120V 3 PH, 4 W 100A MLO W/ GND. BAR SURFACE MOUNTED 18 POLES	2 15/2 4 20/1 1 20/2	6 20/1	2

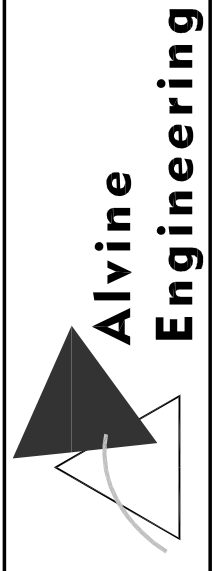

### LIFE SAFETY UPGRADES AT OMAHA STATE OFFICE BUILDING 2012

PROJECT NO. 20112589	DATE 11/06/12	DRAWING REFERENCED: E401	SKETCH ES-02
ADDENDUM NO.: 1			

# Attendance Roster



1800 O Street, Ste. 104, Lincoln, Nebraska 68508 (402) 477-6161

Date 11-1-2012

Project Name Omaha State Office Building Life Safety Upgrades

Alvine No. 20112589

Meeting Location: Omaha State Office Building Purpose: Pre Bid Meeting

✓	Name	Organization/ Company	E-Mail	Phone No.	Fax No.	Cell Phone No.
	MARK CLARKE	JOHNSON CONTRACTORS	MARK.A.CLARKE@JLI.COM	689.2894	331-1022	689.2894
	MIKE DENABER	PRAIRIE CONSTRUCTION COMPANY	MIKE@PRAIRIE-CONSTRUCTION.COM	330-8522	330-8544	306-5412
	MATT HOEKE	SIEMENS INDUSTRY	matthew.hoeke@siemens.com	402-658-2585	402-941-8175	658-2585
	BRYAN CAMPBELL	BIG-RED FIRE PROTECTION	BRYAN@BIG-RED-FIRE-PROTECTION.COM			402-253-3902
✓	Bob Faust	Alvine Engineering, Inc	r.foust@alvine.com	477-6161		990-6587
	Scott Campbells	AS/SBO	Scott.Campbells	402-4710413		
	Todd Aksemit	AS/SBO	Todd.Aksemit@eng.com	402-675-2172		402-670-7821
	Loren Miller	Prairie Technology Solutions	lorenne@jagwireless.net	402-615-3701		402-615-3701
	Bryan Sadler	SADLER GROUP	BRYAN.SADLER@SADLERGROUPINC.COM	402-531-3217	402-331-7428	402-670-2301
	JOEL WICHMANT	BAXTER KENWORTHY	JWICHMANT@BAXTERKENWORTHY.COM	(402) 932-9235		402-510-9403



	A	B	C	D	E	F	G	H
1	<b>Bid List Created in Newforma</b>							
2								
3	Name	Email Address	Company	Work Phone	Fax Number	City	State	Zip
4	Laura	laura@adtechsupply.com	A & D Technical Supply					
5	Bob Foust	bfoust@alvine.com	Alvine Engineering	(402) 323-5464	(402) 477-9616	Lincoln	NE	68508
6	Milena Palahanska-Mavrov	mpalahanska@alvine.com	Alvine Engineering	(402) 346-7007	(402) 346-9576	Omaha	NE	68102
7	Sheryl Lustgraaf	slustgraaf@alvine.com	Alvine Engineering	(402) 346-7007	(402) 346-9576	Omaha	NE	68102
8	Steven Alvine	salvine@alvine.com	Alvine Engineering	(402) 233-7511	(402) 346-9576	Omaha	NE	68102
9	Jacob Push	jacobpush@pushhvac.com	Art Push	402 551 5418		Omaha	NE	68110
10	Associated Fire Protection	rgraham@associatedfire.net	Associated Fire Protection	402 733 2800	402 344 7469	Omaha	NE	68108
11	Mike Kistler	mkistler@associatedfire.net	Associated Fire Protection					
12	Jeff Meurrens	jmeurrens@baxterkenworthy.com	Baxter-Kenworthy	402-339-2270	402-339-9243	Omaha	NE	68127
13	Jim Suiter	jsuiter3@baxterkenworthy.com	Baxter-Kenworthy	402 339 2270	402 339 9243	Omaha	NE	68127
14	Joel Wichman	jwichman@baxterkenworthy.com	Baxter-Kenworthy	402-339-2270	402-339-9243			
15	Brian Marinus	Brian@bigredfireprotection.com	Big Red Fire Protection					
16	Dennis Shannon	shannondd@peoplepc.com	Commerical Electric Co	402 558 9511	402 556 6033	Omaha	NE	68131
17	Cheryl Keyes	ckeyes@commonwealthelectric.com	Commonwealth Electric	402 331 1414	402 592 9036	Omaha	NE	68127
18	Rick Vaughn	rjvaughn@ecoo.com	Electric Company of Omaha	402 346 1881	402 346 6524	Omaha	NE	68103
19	Rodney Brungardt	rodney@elkhornwest.com	Elkhorn West Construction	402-315-9557	402-315-9415			
20	Zach Mart	zach@elkhornwest.com	Elkhorn West Construction	402 315 9557	402 315 9415	Elkhorn	NE	68144
21	Rick Fiscus	rick.fiscus@yahoo.com	Excel Plumbing & Heating	402-934-7322				
22	Steve Lusero	steve.lusero@fireguardusa.com	Fireguard	402-898-2237	402-592-1599			
23	Ryan Bang	rbang@fremontelectricinc.com	Fremont Electric	402 727 4932	402 727 8124	Fremont	NE	68025
24	Craig McGuire	craig@generalfiresafety.com	General Fire & Safety					
25	Dan Richardson	drich@hillerelectric.com	Hiller Electric	(402) 339-0524	(402) 331-3660			
26	Mark Clarke	Mark.A.Clarke@jci.com	Johnson Controls Inc.	402 331 6161	402 331 1022	Omaha	NE	68137
27	Kevin Hoffart	Kevin@jwsmithco.com	JW Smith Company	402 571 7590	402 571 2801	Omaha	NE	68122
28	Nick Petersen	kcp.ncpetersen@yahoo.com	K.C Petersen Construction Co. Inc	712 328 0123	712 323 5890	Council Bluffs	IA	51501
29	Jessie Paul	builders@cornhusker.net	Lincoln Builders Bureau	402-421-8332	402-421-8334			
30	Brian Cieslik	bcieslik@lueder.com	Lueder Construction	402 339 1000	402 592 4769	Omaha	NE	68127
31	John Walter	jwalter@lueder.com	Lueder Construction	402 339 1000	402 592 4769	Omaha	NE	68127
32	Bob Mahoney	bmahoney5@cox.net	Mahoney Fire Sprinkler Inc	(402) 553-1221	(402) 553-4545			
33	Mel McGinnis	mel@mcginnisconst.com	McGinnis Construction Inc	712 227 0008		Crescent	IA	51526
34	John McMahan	john.mcmahan@okelectric.net	OK Electric	402 393 8200	402 393 0269	Omaha	NE	68106
35	Omaha Builders Exchange	omahaplanroom-obe@mbionline.com	Omaha Builders Exchange	402-593-6908	402-593-6912	Omaha	NE	68127
36	Issac Davidson	idavidson@omahaelectric.com	Omaha Electric Service	402 597 3040	402 597 2992	Omaha	NE	68127
37	Mike Denaeyer	mike@prairie-construction.com	Prairie Construction Co	402 330 8522	402 330 8544	Omaha	NE	68144
38	Brett Lundin	lundin@prairiemech.com	Prairie Mechanical	402-331-4050	402-331-4078	Omaha	NE	68112
39	Loren Miller	lorenm@jagwireless.net	Prairie Technology					
40	Precision Enterprises	mike@precisionenterprise.com	Precision Enterprises	402 592 3323	402 592 2827	Omaha	NE	68138
41	Tim Peterson	tim.peterson@protexcentral.net	Protex Central	402 592 8225	402 592 8222			
42	Reed Construction Plan Room	docprocessing@reedbusiness.com	Reed Construction Plan Room	800-424-3996	800-317-0870			
43	Ben Lassek	ben@rifeconstruction.com	Rife Construction	402 551 7744		Omaha	NE	68104
44	Brian Sadler	briansadler@sadlerelectricinc.com	SADLER ELECTRIC, INC.	(402) 331-3217	402 331 7428	OMAHA	NE	68127
45	David Finney	david.finney@siemens.com	Siemens	402 827 4112		Omaha	NE	68137
46	Matt Hoeke	matthew.hoeke@siemens.com	Siemens					
47	Dave McCracken	davem@standardac.com	Standard Heating and A/C	402 339 6700	402 339 5809	Omaha	NE	68128
48	Scott Connors	scott.connors@nebraska.gov	State Building Division	402-471-0413		Lincoln	NE	68509
49	Todd Aksamit	Todd.Aksamit@nebraska.gov	State of Nebraska DAS/ State Building Division					
50	Greg Donahoe	gregd@stratelec.com	Strategic Electric	(402) 884-2999				
51	Rick Swarbrick	rswarbrick@superiorlight.com	Superior Lighting	402 345 0800	402 345 0815	Omaha	NE	68108
52	Darwin Mornan	darwin.mornan@syncquip.com	Syncquip	(402) 733-1747	(402) 408-2182	Omaha	NE	68107
53	Tim Vaughn	hd12b@cox.net	Vaughn Electric	402 345 8938	402 345 9255	Omaha	NE	68108
54	Jeff Bedel	Jeff.bedel@vikingsprinkler.us	Viking Sprinkler					
55	Williams Restoration Co	dena@wrc.omhcoxmail.com	Williams Restoration Co	402 597 1200	402 597 1296	Papillion	NE	68046

# Bid List at A & D

1/6/12

## Plan Holder List for 'Life Safety Upgrades at Omaha State Office Building 2012'

### Show Classifications

Company Information	CSI Codes	Contact Information	Status Date Filled Date Returned	Delivery Method Tracking Number	Sets Issued
Alvine Associates 1800 O Street Lincoln, NE 68508	Electrical Engineer	Robert Foust Phone: (402) 477-6161 Fax: (402) 477-9616	Filled 10/24/2012	Delivery - A & D Delivery Lincoln	001
Alvine and Associates Inc. 1102 Douglas St Omaha, NE 68102	Mechanical Engineer	Milena Palahanska Mavrov Phone: (402) 346-7007 Fax: (402) 346-9576	Filled 10/24/2012	Delivery - A & D Delivery Omaha	002
Baxter-Kenworthy Electric 4600 S 76th Circle Omaha, NE 68127	ELECTRICAL	Jim Suiter Phone: (402) 339-2270 Fax: (402) 339-9243	Filled 10/26/2012	Pickup - Customer Pick Up / Omaha	023
Commonwealth Electric 4225 S. 89th St Omaha, NE 68127	ELECTRICAL	Cheryl Keys Phone: (402) 331-1414 Fax: (402) 593-9036	Filled 11/06/2012	Pickup - Customer Pick Up / Omaha	037
Elkhorn West Construction 15022 A Circle 68127, Nebraska 68144	Construction	Rodney Brungardt Phone: (402) 315-9557 Fax: (402) 315-9415	Filled 10/25/2012	Pickup - Customer Pick Up / Omaha	018
Excel Plumbing Heating Air Inc. 1101 Locust Avenue Papillion, NE 68046	Plumbing & Heating	Marcella . Phone: (402) 934-7322 Fax: .	Filled 10/31/2012	Pickup - Customer Pick Up / Omaha	027
Fremont Electric Inc. 1245 Hills Rd Fremont, NE 68025	ELECTRICAL	Ryan Bang Phone: (402) 727-4932 Fax: (402) 727-8124	Filled 10/26/2012	Pickup - Customer Pick Up / Omaha	020
Hiller Electric 5404 Dayton St Omaha, NE 68117	ELECTRICAL	Dan Richardson Phone: (402) 339-0524 Fax: (402) 331-3660	Filled 11/05/2012	Pickup - Customer Pick Up / Omaha	036
Johnson Controls, Inc. 14238 Hillsdale Circle Omaha, NE 68137	MECHANICAL / HVAC	Mark Clarke Phone: (402) 331-6161 Fax: (402) 331-1022	Filled 10/29/2012	Pickup - Customer Pick Up / Omaha	024
JW Smith Company 14707 North 72nd Street Omaha, NE 68122	HVAC / Mechanical	Mark Smith Phone: (402) 571-7590 Fax: (402) 571-2801	Filled 10/31/2012	Pickup - Customer Pick Up / Omaha	028
KC Petersen Construction Co. Inc. 1305 Lew Ross Road PO Box 128 Council Bluffs, IA 51501	GENERAL	Nick Petersen Phone: (712) 328-0123 Fax: (712) 323-5890	Filled 11/05/2012	Pickup - Customer Pick Up / Omaha	033
Lincoln Builders Bureau 5910 S. 58 St Suite C Lincoln, NE 68516	PLAN ROOM	Rhonda Gutknecht Phone: (402) 421-8332 Fax: (402) 421-8334	Filled 10/24/2012	Delivery - A & D Delivery Lincoln	008
Lueder Construction 9999 J St Omaha, NE 68127	GENERAL	John Walter Phone: (402) 339-1000 Fax: (402) 592-4769	Filled 10/25/2012	Pickup - Customer Pick Up / Omaha	019
McGinnis Construction Inc P.O. Box 159 - 105 Grove Street Crescent, IA 51526	GENERAL	Mel McGinnis Phone: (712) 227-0008 Fax: (712) 227-0045	Filled 10/25/2012	Pickup - Customer Pick Up / Omaha	017
OK Electric Co. Inc. 3112 South 67th St Omaha, NE 68106	ELECTRICAL	John McMahon Phone: (402) 393-8200 Fax: (402) 393-0269	Filled 10/29/2012	Pickup - Customer Pick Up / Omaha	025
Omaha Builders Exchange 4255 S. 94th St Omaha, NE 68127	PLAN ROOM	Lisa Shockey Phone: (402) 593-6908 Fax: (402) 593-6912	Filled 10/24/2012	Delivery - A & D Delivery Omaha	009
Omaha Electric Service 8506 Madison Street Omaha, NE 68127	ELECTRICAL	Peter Osentoski Phone: (402) 597-3040 Fax: (402) 597-2992	Filled 10/25/2012	Pickup - Customer Pick Up / Omaha	016
Prairie Construction Company 13316 B Street 68127, Nebraska 68144	GENERAL	Mike Denaeyer Phone: (402) 330-8522 Fax: (402) 330-8544	Filled 10/24/2012	Pickup - Customer Pick Up / Omaha	012 & 013
Prairie Mechanical Corp. 2842 Tucker Street Omaha, NE 68112	MECHANICAL	Brett Lundin Phone: (402) 331-4050 Fax: (402) 331-1272	Filled 11/01/2012	Pickup - Customer Pick Up / Omaha	029

Omaha, NE 68112		Fax: (402) 331-4078		
Prairie Technology Solutions 1951 S. 298th Street Elmwood, Nebraska 68349	Technology	Mark S. Phone: (402) 994-2110 Fax: (000) 000-0000	Filled 11/02/2012	Pickup - Customer Pick 011 Up / Omaha
Reed Construction Data 30 Technology Pkwy So. Ste. 500 Norcross, GA 30092	PLAN ROOM	Bill Lee Phone: (800) 699-8640 Fax: (800) 508-5370	Filled 10/24/2012	Ship - UPS Ground 010 <a href="#">Track Item - 1Z6361580374095756</a>
Rife Construction Inc 4515 Military Ave Omaha, NE 68104	GENERAL	Ben Lassek Phone: (402) 551-7744 Fax: (888) 448-6144	Filled 10/25/2012	Pickup - Customer Pick 014 & 015 Up / Omaha
Sadler Electric 5855 South 77th Street Omaha, NE 68127	ELECTRICAL	Brian Sadler Phone: (402) 331-3217 Fax: (402) 331-7428	Filled 11/02/2012	Pickup - Customer Pick 031 Up / Omaha
Siemens Building Technologies Inc. 5708 S. 118th Circle Omaha, NE 68137	Temperature Controls	Matt Hoeke Phone: (402) 891-8174 Fax: (402) 891-8175	Filled 10/30/2012	Pickup - Customer Pick 026 Up / Omaha
Standard Heating & Air Conditioning 11746 Portal Road Omaha, NE 68128	HVAC	Dave McCracken Phone: (402) 339-6700 Fax: (402) 339-5809	Filled 11/05/2012	Pickup - Customer Pick 035 Up / Omaha
State of Nebraska Building Division 521 South 14th Suite 400 Lincoln, NE 68508	State Agency	Scott Connors Phone: (402) 471-0413 Fax: (402) 471-0421	Filled 10/24/2012	Delivery - A & D Delivery 003 - 007 Lincoln plus 021 & 022
Syncquip 4602 S 35th St Omaha, NE 68107	HVAC / Mechanical	Darwin Morman Phone: (402) 733-1747 Fax: (402) 408-2182	Filled 11/01/2012	Pickup - Customer Pick 030 Up / Omaha
TIJ Construction LLC 1 D Avenue Missouri Valley, IA 51555	GENERAL	Jim Henderson Phone: (402) 630-6607 Fax: (111) 111-1111	Filled 10/24/2012 11/02/2012	Pickup - Customer Pick 011 Up / Omaha Returned
Vaughn Electric 3222 S. 24th St. Omaha, NE 68108	ELECTRICAL	Tim Vaughn Phone: (402) 345-8938 Fax: (402) 345-9255	Filled 11/05/2012	Pickup - Customer Pick 034 Up / Omaha
Williams Restoration Co. 725 N. Frontier Rd. Papillion, NE 68046	Caulking & Waterproofing	Dena Berger Phone: (402) 597-1200 Fax: (402) 597-1296	Filled 11/02/2012	Pickup - Customer Pick 032 Up / Omaha



www.pushhvac.com

**Jacob Push**  
 TABB Supervisor  
 Fire Damper Supervisor  
 Phone: 402-551-5418  
 Cell: 402-301-6128  
 Fax: 402-551-9149  
 E-mail: jacobpush@pushhvac.com

Box 4189  
 6110 Binney  
 Omaha, NE 68104



**Rodney Brungardt**  
 Project Manager

**BUILD DESIGN CONSULT**

15022 A Circle • Omaha, Nebraska 68144

Office: 402.315.9557  
 Cell: 402.960.5494  
 Fax: 402.315.9415  
 mail: Rodney@elkhornwest.com  
 vw.elkhornwest.com

**Prairie Technology Solutions**

**Loren Miller**  
 Project Manager / Master Electrician



Prairie Technology Solutions

1951 S 298th Street  
 Elmwood, NE 68349

402-613-3401 Cell.  
 402-994-2110 Bus.  
 402-994-2028 Fax  
 lorenm@jagwireless.net



402-592-1999  
 Cell: 402-670-4718  
 Fax: 402-592-1599

**Steve Lusero**  
 Life Safety Division Manager

Direct: 402-898-2237 steve.lusero@fireguardusa.com

4404 S. 76th Circle • Omaha, NE 68127  
 www.fireguardusa.com

One Call One Source

5855 So. 77th St. Omaha, Nebraska 68127

**BRIAN SADLER**  
 Project Manager  
 briansadler@sodlerelectric.com



Bus: 331-3217  
 Fax: 331-7428  
 Cell: 670-2301



**MARK A. CLARKE CEM**  
 Fire & Security Account Manager  
 Building Efficiency

14238 Hillsdale Circle, Omaha, NE 68137-5557 USA  
 Direct 402 891 5856 Fax 402 331 1022  
 mark.a.clarke@jci.com  
 www.johnsoncontrols.com

Commercial • Residential • Electrical • Low Voltage • Security • Cabling • Fiber



electro - technology

4600 S. 76th Circle  
 Omaha, NE 68127-1879

**Joel Wichman**  
 Small Projects Manager

402.339.2270 Main  
 402.932.3235 Direct  
 402.339.9243 Fax

jwichman@baxterkenworthy.com  
 www.baxterkenworthy.com

**Kevin Hoffart**  
 Sales & Estimating  
 kevin@jwsmithco.com



**J.W. Smith & Company**

Mechanical Contractor Heating and Cooling

14707 N. 72nd Street Omaha, NE 68122  
 Office 402-571-7590 Fax 402-571-2801  
 Mobile 402-516-5216

Full Service Electrical & Data Contractor

**IOWA**  
 ELECTRIC

712-366-0588  
 FAX 712-366-0757



**OES**

OMAHA ELEC. SERV.  
 402-597-3040  
 FAX 402-597-2992

24 Hour Service

**ISAAC DAVIDSON**  
 1220 35th AVE. SUITE 100  
 COUNCIL BLUFFS, IA 51501

8506 MADISON STREET  
 OMAHA, NE 68127  
 idavidson@omahaelectric.com

lueder  
 construction  
 company

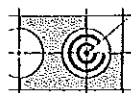

general contracting  
 construction management  
 design - build

**Brian Cieslik**  
 PROJECT ESTIMATOR

9959 "J" street / omaha, nebraska 68127-1125  
 Office: 402.339.1000 / fax 402.592.4769  
 bcieslik@lueder.com

Pre Bid Meeting Business Cards Info



**K.C. PETERSEN  
CONSTRUCTION CO., INC.**

General Contractors

**Nick Petersen**  
Project Manager

Cell: 402-960-7191

Ken Petersen  
Owner  
Cell: 402-306-6196

Joe Craig  
Project Manager  
Cell: 402-306-6194

Commercial • Industrial • Residential

1305 Lew Ross Rd. • P.O. Box 128 • Council Bluffs, Iowa 51501-0128

Phone: 712/328-0123 • Fax: 712/323-5090

kcp.petersen@yahoo.com

**SIEMENS**

Industry

Siemens Building Technologies, Inc.

5708 South 118th Circle  
Omaha, NE 68137  
USA

Mobile: +1 402 658-2585

Fax: +1 402 891-8175

Direct: +1 402 827-4183

matthew.hoeke@siemens.com

Matthew Hoeke

Life Safety Security Systems Sales

**JOHN T. McMAHON, P.E.**

**PRESIDENT**

Direct Phone: (402) 408.8202

John.mcmahon@okelectric.net

Cell Phone: (402) 415.6550

**OK ELECTRIC CO., INC.**

**ELECTRICAL CONTRACTORS**

P.O. Box 6086  
112 South 67 Street  
Omaha, NE 68106

Phone: (402) 393.8200  
Fax: (402) 393.0269  
www.okelectric.net



**ELECTRIC COMPANY OF OMAHA**

**RICK VAUGHN**  
346-1881

815 S. 21st  
Omaha, NE 68108

fax 346-6524  
direct line 943-1708  
rjvaughn@ecoo.com