



ADDENDUM NO. 1

1.01 NOTICE TO BIDDERS

- A. Date: 6 June 2012
- B. From: Bahr, Vermeer and Haecker Architects, Ltd.
- C. To: Prospective Bidders.
- D. Project: Lexington Public Schools
Lexington Middle School / Community Recreation Facility Addition
Bid Packages No. 1 – No. 3
Lexington, Nebraska
- E. This addendum is issued by the Architect to all bidders of record prior to receipt of proposals. Bidders shall acknowledge receipt of this addendum by so indicating on the Bid Form. Failure to do so may subject Bidder to disqualification.
- F. All information and instructions given herein shall become a part of the Contract Documents.
- G. This Addendum contains two (2) total pages with five (5) attachments.

1.02 PROJECT MANUAL – ARCHITECTURAL

- A. Advertisement for Bids
 - 1. See Attachment "A" for the Sign-Up Sheet for the REQUIRED Pre-Bid Meeting that was held on May 31, 2012.

1.03 DRAWINGS – CIVIL

- A. Sheet C1.1 – DEMOLITION PLAN
 - 1. See Attachment "B" for the revised drawing of the existing concrete pavement to be removed.
 - 2. Sheet Note #1 shall be deleted and replaced with the following:
 - a. 'NOT USED'
 - 3. Sheet Note Tag #1 has been deleted from the Site Utility Demolition Plan. The removal and salvage of light poles and light fixtures shall be completed by the electrical contractor and as shown on Sheet ME1.0 BP.1-.3.
- B. Sheet C1.5 – UTILITY PLAN
 - 1. See Attachment "C" for the revised drawing of the concrete paving that is required to be installed after site utilities are installed.

1.04 DRAWINGS – MECHANICAL / ELECTRICAL

- A. Sheet ME1.0 – MECHANICAL & ELECTRICAL UTILITY PLAN
 - 1. Reference the 'EXISTING GAS SERVICE RECONNECTION DETAIL'; the shutoff valve (not noted, symbol only) on the new 3" gas piping is not required and can be deleted.

2. Reference Drawing A1 – MECHANICAL & ELECTRICAL UTILITY PLAN; see Attachment “1E” for revised number of conduits from the secondary service pedestal and for the revised routing of the temporary gas piping along the roof and down the north side of the existing gymnasium.
3. Reference Sheet Notes;
 - a. See Attachment “2E” for revisions to Sheet Notes #8, #13, #15, #17, and #21.
 - b. Sheet Note #22 shall be deleted.
4. Reference the ‘PARTIAL ELECTRICAL SERVICE RISER’; see Attachment “2E” for the revised drawing of this detail which shows Sheet Note #22 deleted from this drawing.

END OF ADDENDUM No. 1

**Lexington Public Schools
Lexington Middle School / Community Recreation Facility Addition
Pre-Bid Meeting
May 31, 2012 - 3:00 pm
Sign-in Sheet**

Name	Company	Fax #	E-mail Address
Glen Hawks	City of Lexington		jkeim@cityoflex.com
Tom Nelson	City of Lexington		jkeim@cityoflex.com
Dave Fagot	Fagot Electric	308-324-5670	frae@cozadtel.net
Dave Waggoner	Waggoner Plumbing and Heating	308-237-6875	dwaggonerplbg@frontier.net
Dave Hofferber	Jones Plumbing and Heating Inc.	308-324-3405	plumberdave13@yahoo.com
Todd Morrison	Snell Services	308-534-0804	tmorrison@windstream.com
Nate Burnett	REGA Engineering		nburnett@regaengineering.com
Craig Wohlgemuth	BVH		cwohlgemuth@bvh.com
Joe Ripp	Anderson Bros		contact@andersonbros.com
Dan Smith	N.P.P.D	308-325-3877	DESmith@NPPD.com
Bill Dugger	N.P.P.D	308-238-5208	wgdugge@NPPD.com
Jim Mckeon	N.P.P.D	308-236-2223	jlmckeo@NPPD.com
Dan Butterfield	Butterfield Electric	308-529-1135	butterfieldelectric@hotmail.com
Jarrid Rickertson	Butterfield Electric		rickertsonelectric@yahoo.com
Guy Holloway	Holloway Electric	308-872-6158	ghollowayne@yahoo.com
Dan Schwartz	Paulsen Inc.		danielschwartz2010@hotmail.com
Dave Jeffrey	Paulsen Inc.		djeffrey@cozadtel.net
Joe Pepplichtsch	City of Lexington	308-324-2341	jpepp@cityoflex.com

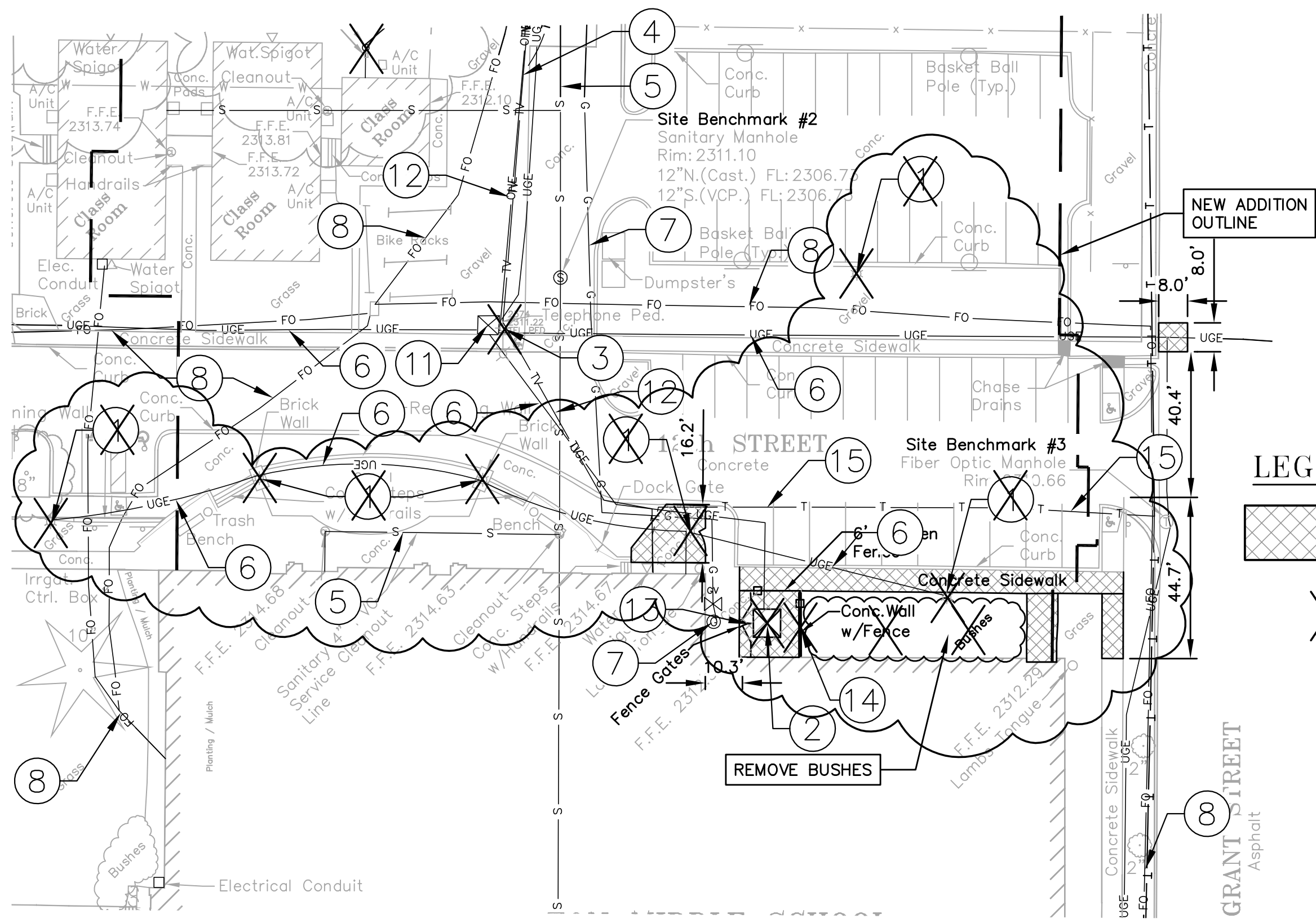

LEGEND

- REMOVE PAVEMENT
- REMOVE ITEMS

REGA NO. 111157		
ISSUED FOR:	DATE:	BY:
REVISED PAVEMENT REMOVAL	06/06/12	REGA

DEMOLITION PLAN
SCALE: 1"=30'

Addendum No. 1
Attachment "B"
Bid Packages 001 - 003 REF. SHT# C1.1



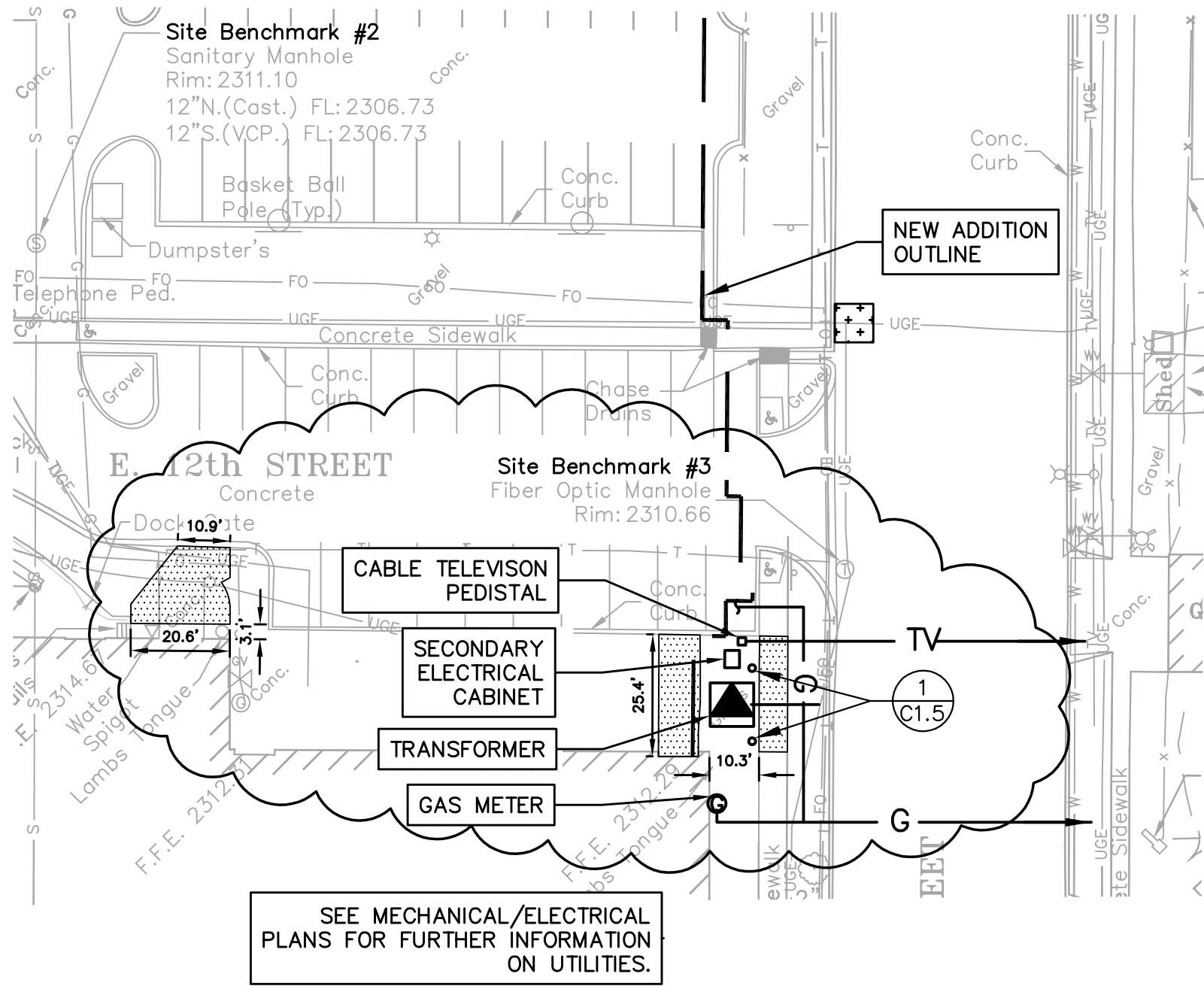

LEGEND

- G — G — UNDER GROUND GAS LINE
- ⊙ — GAS METER
- TV — TV — UNDERGROUND CABLE TELEVISION LINE
- ▲ — TRANSFORMER
- E — E — UNDERGROUND POWER
- FO — FO — FIBER OPTIC
- ⊕ — 7" CONCRETE PAVEMENT (2/C1.5)
- — 4" CONCRETE PAVEMENT

REGA NO. 111157

ISSUED FOR:	DATE:	BY:
ADDED 4" CONCRETE PAVEMENT	06/06/12	REGA

UTILITY PLAN

SCALE: 1" = 30'

Addendum No. 1
Attachment "C"
Bid Packages 001 - 003

REF. SHT# C1.5



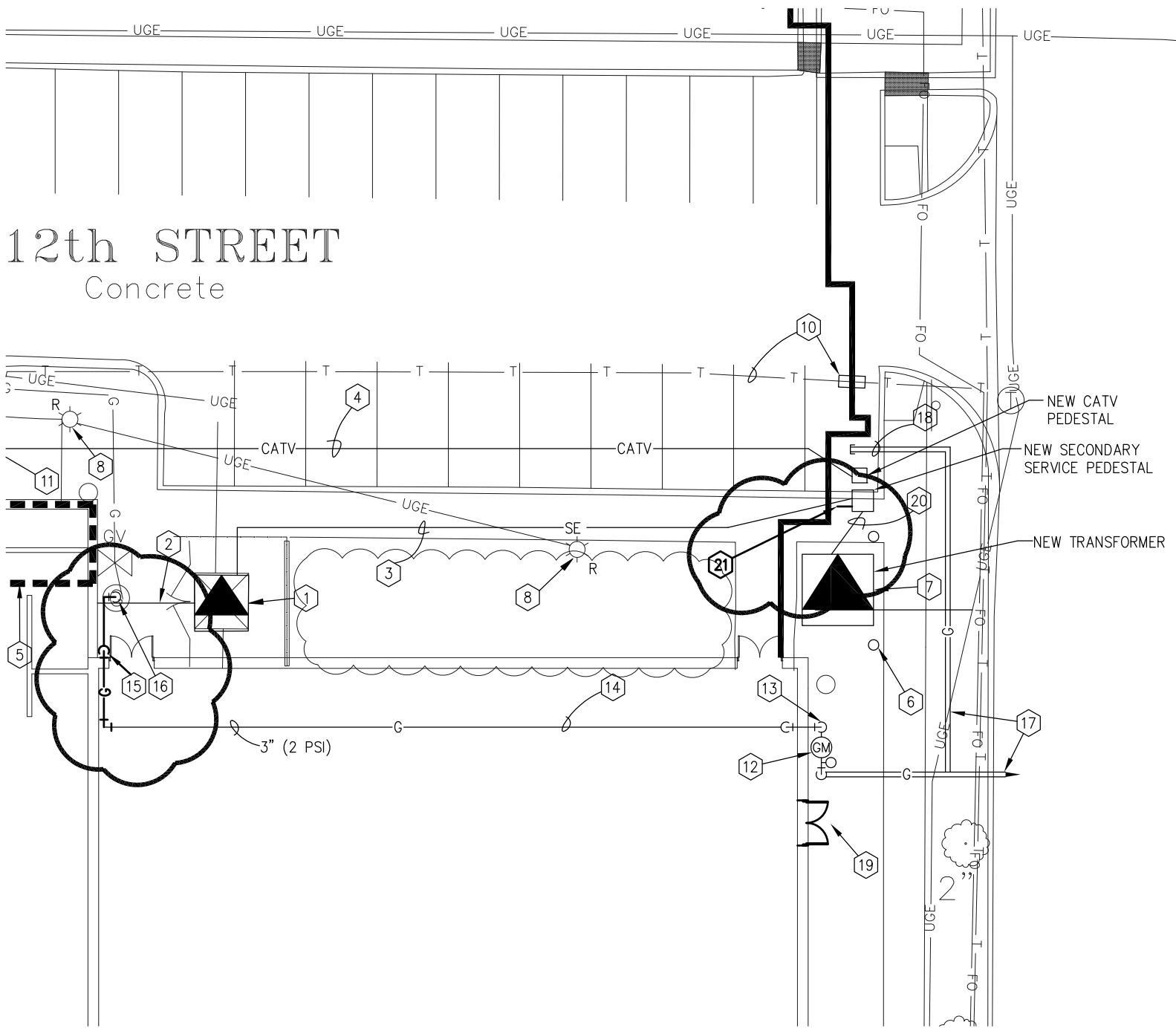

Addendum No. 1
 Bid Packages 001 - 003

LEXINGTON MIDDLE SCHOOL
 RECREATION ADDITION-
 UTILITY PLAN

SCALE: 1" = 20'-0"

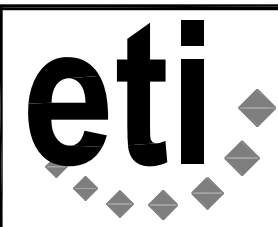

Engineering Technologies Inc.
 Mechanical & Electrical Building Solutions
 825 M Street, Suite 200 | Lincoln, NE 68508
 P 402.476.1273 | F 402.476.1274
 4559 South 133rd Street | Omaha, NE 68137
 P 402.330.2772 | F 402.330.2630
 ETI Project No: 2011-140

06/06/12
SHEET ME1.0
ATTACHMENT NO. 1E
TSK

SHEET NOTES

1. POWER COMPANY TO REMOVE EXISTING TRANSFORMER. THIS CONTRACTOR TO REMOVE EXISTING CONCRETE PAD AND INSTALL AN IN-GRADE JUNCTION BOX AND SPLICE THE NEW SECONDARY ELECTRICAL CONDUCTORS TO THE EXISTING SECONDARY ELECTRICAL CONDUCTORS. SIZE JUNCTION BOX PER NEC AND PROVIDE A VEHICLE TRAFFIC RATED BOX WITH THE WORD "ELECTRICAL" EMBOSSED ON THE COVER. COORDINATE DOWNTIME WITH OWNER AND POWER COMPANY.
2. SPLICE EXISTING SECONDARY ELECTRICAL CONDUCTORS TO NEW CONDUCTORS. THIS WILL BE TEMPORARY UNTIL THE NEW ELECTRICAL ROOM IS COMPLETED.
3. PROVIDE FIVE SETS OF 4-400 MCM CU. EACH SET IN A 3" CONDUIT. INSTALL A MINIMUM OF 36" BELOW GRADE. COORDINATE EXACT ROUTING IN THE FIELD.
4. PROVIDE 2" CONDUIT FOR CATV AND COORDINATE WITH UTILITY COMPANY TO REMOVE AND INSTALL SERVICES BACK INTO BUILDING. INTERCEPT EXISTING CONDUIT WHERE INDICATED.
5. EXISTING 1600A, 277/480V, 3-PHASE ELECTRICAL SERVICE, TELEPHONE SERVICE, AND CATV SERVICE TERMINATE IN ROOM ABOVE EXISTING KITCHEN.
6. PROVIDE CONCRETE FILLED VEHICLE PROTECTION BOLLARDS AROUND TRANSFORMER PER NPPD REQUIREMENTS.
7. COORDINATE WITH NPPD AND PROVIDE TRANSFORMER BASE PER NPPD REQUIREMENTS.

8. ELECTRICAL TO REMOVE LIGHT FIXTURE AND POLE, AND RETURN TO OWNER. GENERAL CONTRACTOR TO REMOVE CONCRETE BASE. THIS CONTRACTOR SHALL REMOVE CONDUCTORS BACK TO SOURCE AND ABANDON CONDUIT FOR DEMOLITION DURING CONSTRUCTION.

9. CONTRACTOR SHALL MAKE PROVISIONS TO GET FIBER OPTICS CABLE BACK INTO THE BUILDING AFTER FIBER IS RE-ROUTED. FOR BIDDING PURPOSES PROVIDE 2" CONDUIT FROM ACCESSIBLE CEILING IN BUILDING TO 10'-0" OUTSIDE OF BUILDING. INSTALL A MINIMUM OF 24" BELOW GRADE. IF EXISTING RACEWAY CAN BE REUSED THAT IS ACCEPTABLE.
10. PROVIDE SLEEVE THROUGH FOOTING TO PROTECT 4" TELEPHONE CONDUIT AND CABLE AS REQUIRED. CONDUIT AND CABLE TO BE PROTECTED THE ENTIRE ROUTE, POT HOLE TO VERIFY DEPTH AS REQUIRED TO ENSURE TELEPHONE SERVICE IS PROTECTED DURING ALL PHASES OF CONSTRUCTION.
11. INTERCEPT EXISTING CONDUITS AND CONNECT NEW CONDUIT. COORDINATE ALL WORK WITH UTILITY COMPANIES AS THEY WILL NEED TO REMOVE AND REINSTALL CABLES.
12. RELOCATE EXISTING GAS METER TO HERE. MAINTAIN MINIMUM 5 FEET CLEARANCE FROM NEW TRANSFORMER LOCATION PER NPPD. MAINTAIN REQUIRED CLEARANCE FROM NEW DOOR INTO GYM.

13. EXTEND TEMPORARY 3" GAS PIPING UP EXISTING GYMNASIUM WALL AND ON TO ROOF. SUPPORT PIPING AT EXISTING WALL PER THE SPECIFICATIONS. PAINT PIPING A COLOR THAT BLENDS IN WITH EXISTING BRICK.

14. ROUTE TEMPORARY GAS PIPING ALONG ROOF AS SHOWN ON THE PLANS. SUPPORT PIPING ALONG ROOF AS REQUIRED.

15. EXTEND PIPING DOWN WALL AND RECONNECT TO EXISTING GAS SERVICE FOR TEMPORARY CONNECTION TO EXISTING MIDDLE SCHOOL. PAINT PIPING A COLOR THAT BLENDS IN WITH EXISTING BRICK.

16. SEE GAS RISER DETAILS ON THIS SHEET FOR RECONNECTION TO EXISTING BUILDING GAS SERVICE.

17. UNDERGROUND GAS PIPING BY UTILITY COMPANY. COORDINATE EXACT LOCATION WITH CIVIL PLANS AND UTILITY COMPANY. GAS COMPANY IS SOURCE GAS, DOUG CUNNINGHAM, 308-325-2992.

18. NEW GAS METER TO BE LOCATED NORTH OF THE ELECTRICAL TRANSFORMER FOR FUTURE USAGE. UTILITY COMPANY TO EXTEND FUTURE LINE NORTH AT THIS TIME AND CAP PRIOR TO INSTALLATION OF TRANSFORMER.

19. FUTURE DOOR LOCATION. COORDINATE LOCATION OF TEMPORARY GAS SERVICE WITH NEW DOOR LOCATION AND PROVIDE THE REQUIRED CLEARANCE PER THE UTILITY COMPANY'S REQUIREMENTS.

20. CONDUITS AND CONDUCTORS BETWEEN TRANSFORMER AND SECONDARY SERVICE PEDESTAL BY NPPD.

21. STUB OUT 10-3" CONDUITS FOR FUTURE FEEDS TO THE TWO FUTURE NEW MAIN SWITCHES.

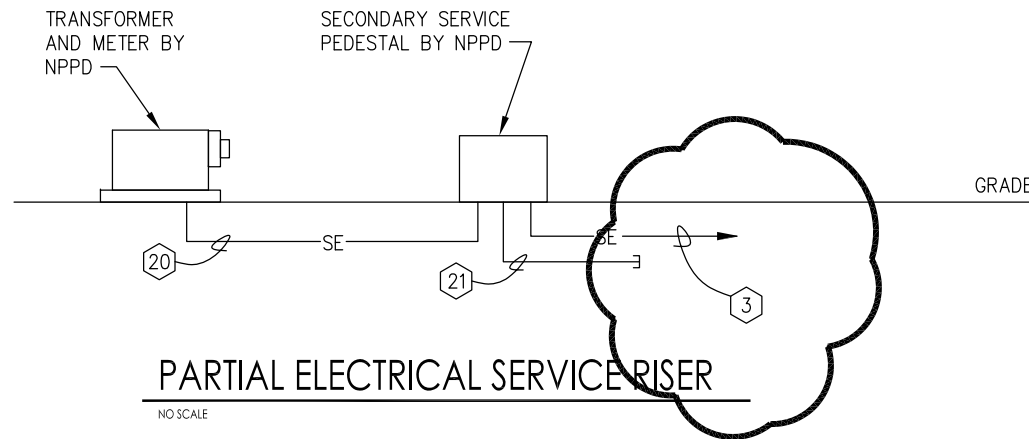

Addendum No. 1
Bid Packages 001 - 003

06/06/12
SHEET
MET.0
ATTACHMENT NO.
2E
TSK

Engineering Technologies Inc.
Mechanical & Electrical Building Solutions
825 M Street, Suite 200 | Lincoln, NE 68508
P 402.476.1273 | F 402.476.1274
4559 South 133rd Street | Omaha, NE 68137
P 402.330.2772 | F 402.330.2630
ETI Project No: 2011-140

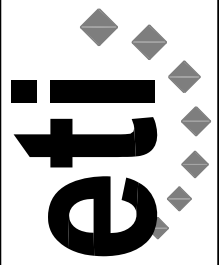

LEXINGTON MIDDLE SCHOOL
RECREATION ADDITION-
UTILITY PLAN
SCALE: NONE