

ADDENDUM

DATE: Friday April 20, 2012

PROJECT/JOB#: Dawes Middle School, Small IAQ Project/179.019

OWNER: Lincoln Public Schools

FROM: Andrew Thompson – M.E. GROUP, Inc.

SUBJECT: Addendum No. – **One (1)**

This addendum is issued by the Engineer to all known bidders before receipt of proposals. Bidders shall attach this bulletin to their proposal sheets and all information and instructions given herein shall become a part of the Contract Documents.

ARCHITECTURAL

Drawings

1. Sheet A1.1:

- A. Demolition Floor Plan notes revised/added, refer to supplemental drawing SD-A01
- B. Floor Plan notes added, refer to supplemental drawing SD-A02

Attachments: SD-A01, SD-A02

END OF ADDENDUM

Sincerely,

Andrew Thompson, PE, LEED-AP, CxA, HBDP, CEM
Principal/Vice President

2820 N. 48th Street
Lincoln, NE 68504
t: 402.464.3833
f: 402.464.3919
www.megroup.com

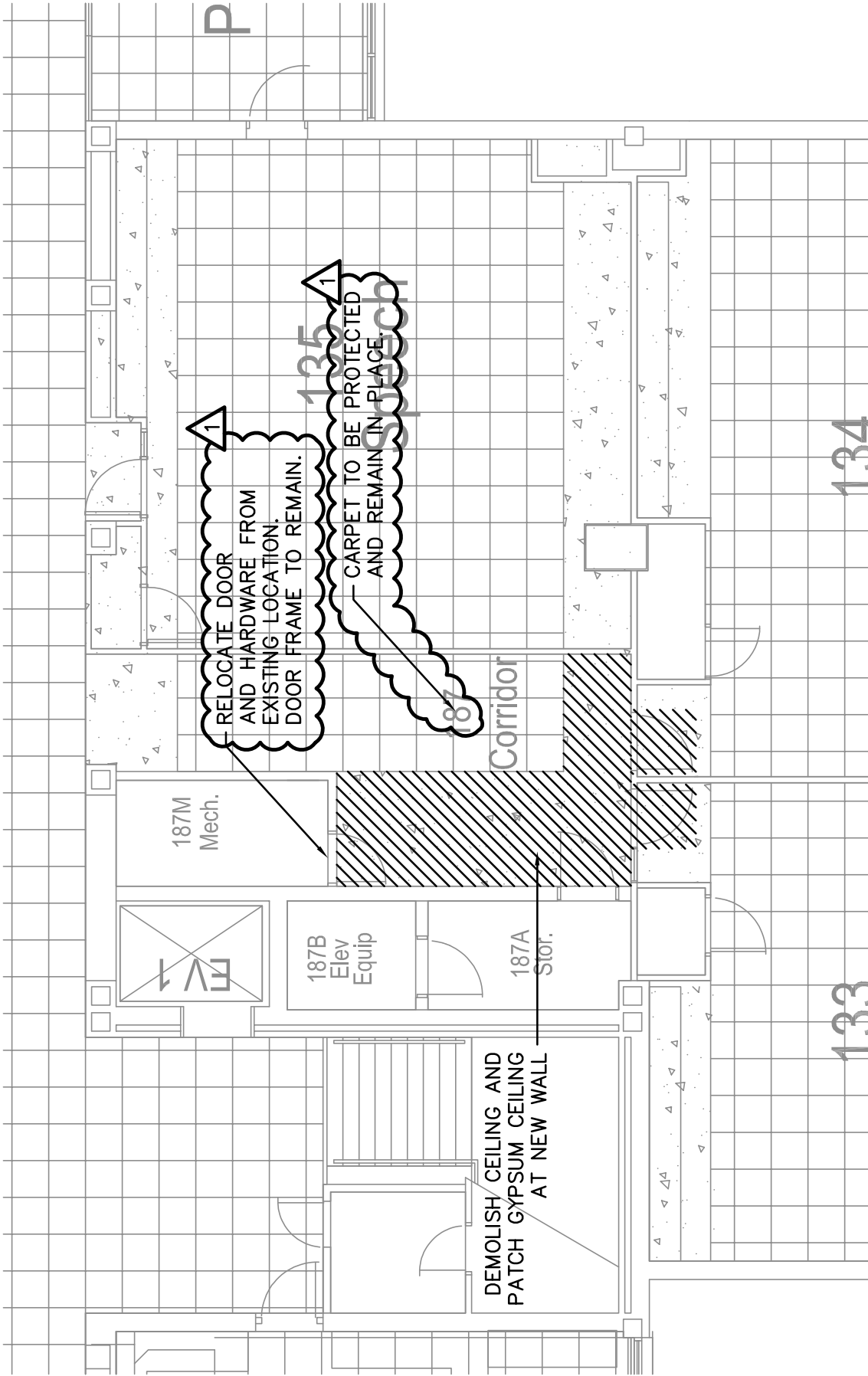

DEMOLITION FLOOR PLAN

1

SCALE: 1/8" = 1'-0"

The design and concepts illustrated here are the sole property of M.E. Group, Inc. (MEG), they may not be reproduced in whole or in part without express written permission.

MEG GROUP
design
www.megroup.com

DAWES MIDDLE SCHOOL SMALL IAQ
LINCOLN PUBLIC SCHOOLS
LINCOLN, NE 68504

Client/Architect: _____
Project No.: _____
Date: 04.20.2012
MEG File No.: 179.019
Scale: 1/8" = 1'-0"
Reference Sheet: A1.1

Supplemental
Drawing No.:
**SD-
A01**

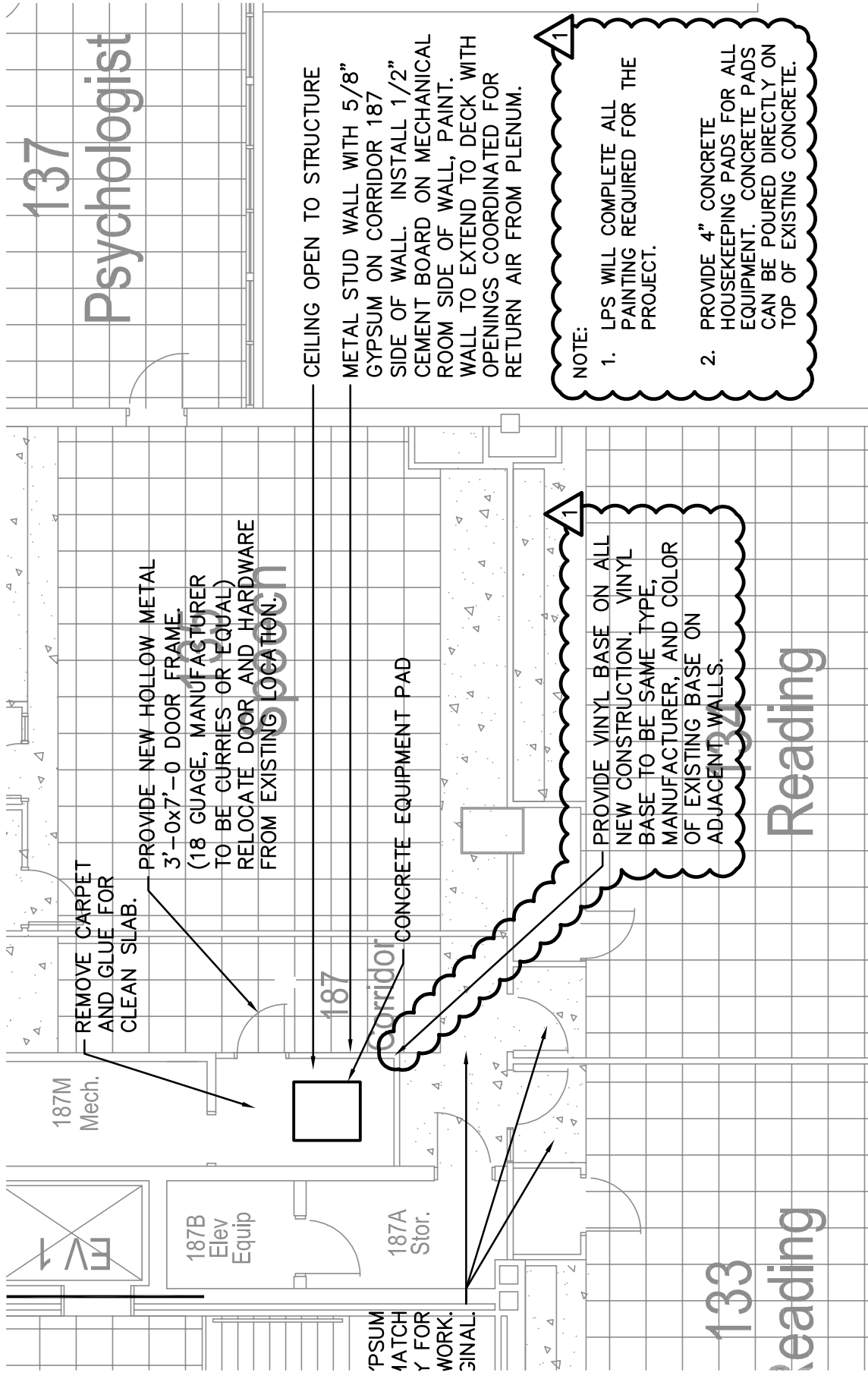

NOTE:

1. LPS WILL COMPLETE ALL PAINTING REQUIRED FOR THE PROJECT.
2. PROVIDE 4" CONCRETE HOUSEKEEPING PADS FOR ALL EQUIPMENT. CONCRETE PADS CAN BE POURED DIRECTLY ON TOP OF EXISTING CONCRETE.

PROVIDE VINYL BASE ON ALL NEW CONSTRUCTION. VINYL BASE TO BE SAME TYPE, MANUFACTURER, AND COLOR OF EXISTING BASE ON ADJACENT WALLS.

FLOOR PLAN

2

SCALE: 1/8" = 1'-0"

The design and concepts illustrated here are the sole property of M.E. Group, Inc. (MEG), they may not be reproduced in whole or in part without express written permission.



DAWES MIDDLE SCHOOL SMALL IAQ
 LINCOLN PUBLIC SCHOOLS
 LINCOLN, NE 68504

Client/Architect:	
Date:	04.20.2012
MEG File No.:	179.019
Project No.:	
Scale:	1/8" = 1'-0"
Reference Sheet:	A1.1

Supplemental Drawing No.:
 SD-A02