

LINCOLN PUBLIC SCHOOLS DISTRICT OFFICE RIGHT TURN LANE PUBLIC PAVING PLAN

NOTE:
DIAL BEFORE YOU DIG. CALL 1-800-331-5666
FOR LOCATION OF UNDERGROUND TELEPHONE,
ELECTRIC, GAS MAINS, CABLE TELEVISION AND CITY
OF LINCOLN UTILITIES.

SCHEDULE OF APPROXIMATE QUANTITIES

ITEM	UNIT	QUANTITY
8" P.C.C. PAVEMENT W/INTEGRAL CURB	SY	466
TYPE "B" SAW CUT	LF	376
TYPE "C" SAW CUT	LF	16
REMOVE & DISPOSE CONCRETE SIDEWALK	SF	2,174
REMOVE & DISPOSE CONCRETE PAVEMENT	SY	112
REMOVE & DISPOSE MODULAR BLOCK RETAINING WALL	SF	100
RELOCATE LIGHT POLE	EA	1
RELOCATE TYPE "V" HYDRANT	EA	1
CONCRETE MEDIAN NOSE	EA	1
RELOCATE SIGN	EA	1
4" THICK CONCRETE SIDEWALK	SF	761
* RELOCATE LIGHT POLE	EA	1

* COORDINATE W/LES ON CIRCUITING OF POLES

GENERAL NOTES

- CONTRACTOR TO PRESERVE ALL SURVEY CONTROL.
- PRIOR TO MOVING OFF THE JOB THE CONTRACTOR SHALL NOTIFY THE ENGINEER AND REQUEST A FINAL WALK-THROUGH OF THE CONSTRUCTION SITE.
- LOCATION AND ELEVATIONS OF IMPROVEMENTS TO BE MET (OR AVOIDED) BY WORK TO BE DONE SHALL BE CONFIRMED BY THE CONTRACTOR THROUGH FIELD EXPLORATIONS PRIOR TO CONSTRUCTION. CONTRACTOR SHALL REPORT TO THE DEVELOPER'S ENGINEER, CITY INSPECTOR, OR DEVELOPER'S ENGINEER FIELD REPRESENTATIVE ANY DISCREPANCIES BETWEEN HIS MEASUREMENTS AND THESE PLANS.
- THE EXISTENCE AND LOCATION OF UNDERGROUND UTILITY PIPES AND STRUCTURES SHOWN ON THESE PLANS WERE OBTAINED BY A SEARCH OF AVAILABLE RECORDS TO THE BEST OF OUR KNOWLEDGE CONSTITUTES ALL KNOWN FACILITIES. HOWEVER, THE CONTRACTOR IS REQUIRED TO TAKE DUE PRECAUTIONARY MEASURES TO PROTECT ANY EXISTING UTILITIES OR STRUCTURES LOCATED AT THE WORK SITE. IT IS THE CONTRACTOR'S RESPONSIBILITY TO CONTACT UNDERGROUND SERVICE ALERT @ 1-800-331-5666 IN ADVANCE OF ANY EXCAVATION FOR THE MARK-OUT OF THE LOCATION OF UTILITIES AND NOTIFICATION OF COMMENCEMENT OF WORK.
- BEFORE EXCAVATING FOR THIS CONTRACT, THE CONTRACTOR SHALL FIELD VERIFY LOCATION OF UNDERGROUND UTILITIES. CONTRACTOR SHALL MAKE EXPLORATION EXCAVATIONS AND LOCATE EXISTING UNDERGROUND UTILITIES SUFFICIENTLY AHEAD OF CONSTRUCTION TO PERMIT REVISIONS TO PLAN IF REVISIONS ARE NECESSARY BECAUSE OF ACTUAL LOCATION OF EXISTING FACILITIES.
- CONTRACTOR IS REQUIRED TO TAKE PRECAUTIONARY MEASURES TO PROTECT THE UTILITY LINES SHOWN AND ANY OTHER EXISTING LINES NOT OF RECORD OR NOT SHOWN ON THESE PLANS.
- THE CONTRACTOR SHALL USE CAUTION AROUND ANY EXISTING UTILITIES OR IMPROVEMENTS LOCATED ON SITE. HE SHALL BE RESPONSIBLE FOR THE REPAIRS OF SUCH STRUCTURES WHEN BROKEN OR OTHERWISE DAMAGED BY THE NEW CONSTRUCTION.
- ALL SPOIL MATERIAL SHALL BE REMOVED FROM THE STREET ROW, UTILITY EASEMENT, OR ACCESS EASEMENT BY THE CONTRACTOR. SPOIL MATERIAL SHALL BE DEPOSITED WITHIN THE SITE DEVELOPMENT BOUNDARY IN AREAS DESIGNATED BY THE DEVELOPER'S ENGINEER. THE MATERIAL SHALL BE STOCKPILED OR SPREAD AS DIRECTED BY THE ENGINEER. NO SEPARATE PAYMENT SHALL BE MADE FOR DISPOSAL OF SPOIL MATERIAL; IT SHALL BE CONSIDERED SUBSIDIARY TO THE PRICE BID.
- A PORTABLE RESTROOM FACILITY WILL BE REQUIRED ON-SITE DURING CONSTRUCTION ACTIVITIES.
- ANY ON-SITE FUELING WILL COMPLY WITH LOCAL, STATE, AND FEDERAL REQUIREMENTS.
- A CONCRETE TRUCK WASHOUT WILL BE LOCATED ON SITE.
- THE CONTRACTOR SHALL REPAIR OR REPLACE ALL EROSION CONTROL MEASURES DAMAGED BY CONSTRUCTION ACTIVITIES.

EO PAVING NOTES

- ALL INTERSECTION RADII SHALL BE 20' UNLESS OTHERWISE NOTED.
- MONUMENT BOXES SHALL BE INSTALLED AT THE LOCATIONS SHOWN ON THE PLANS, SEE LINCOLN STANDARD PLAN - 163.
- PROVIDE OPENINGS IN CURB FOR FUTURE WHEELCHAIR RAMP AS DIRECTED BY ENGINEER. SEE LINCOLN STANDARD PLAN - 600.
- FOR DETAILS OF COMBINED CURB AND GUTTER, SEE LINCOLN STANDARD PLAN - 651.
- FOR DETAILS OF PAVEMENT UNDER PINNING, SEE LINCOLN STANDARD PLAN - 660.
- FOR DETAILS OF CONCRETE PAVEMENT JOINTS, SEE LINCOLN STANDARD PLAN - 660.
- FOR DETAILS OF PAVEMENT CONSTRUCTION, SEE STANDARD SPECIFICATION, CHAPTER 1, 2011 EDITION, CITY OF LINCOLN, NEBRASKA. ALL STANDARD SPECIFICATIONS, ADDENDA SHALL APPLY.
- THE PAVING CONTRACTOR SHALL BE RESPONSIBLE FOR PLACING THE INLET TOP AND BUILDING THE COMBINED CURB AND GUTTER THROUGH THE CONCRETE INLET TOP.
- FOR DETAILS OF PAVEMENT MARKINGS, SEE STANDARD SPECIFICATION, CHAPTER 13, 2011 EDITION, CITY OF LINCOLN, NEBRASKA. ALL STANDARD SPECIFICATIONS AND ADDENDA SHALL APPLY.

AUTHORIZED FOR CONSTRUCTION

CITY ENGINEER'S OFFICE

I HEREBY CERTIFY THAT THESE PLANS WERE PREPARED BY ME OR UNDER MY DIRECT SUPERVISION AND THAT I AM A REGISTERED PROFESSIONAL ENGINEER UNDER THE LAWS OF THE STATE OF NEBRASKA. THESE PLANS MEET THE REQUIREMENTS OF THE CITY ENGINEER'S OFFICE DESIGN REQUIREMENTS.

TIMOTHY GERGEN

LEGEND

	BOLLARD
	CURB INLET
	CONTROL POINT/BENCHMARK
	DECIDUOUS TREE
	ELECTRIC BOX
	FIRE HYDRANT
	FIBER OPTIC BOX
	GAS VALVE
	GROUND LITE
	GUY WIRE
	LIGHT POLE
	POST INDICATOR VALVE
	POWER POLE
	SANITARY SEWER MANHOLE
	SIGN
	SPRINKLER CONTROL VALVE
	STORM DRAIN MANHOLE
	TRAFFIC SIGNAL W/ ARM
	WATER MANHOLE
	WATER VALVE
	CENTER LINE
	PROPERTY LINE
	WOOD FENCE
	CHAIN LINK FENCE
	WIRE FENCE
	SANITARY SEWER LINE
	STORM SEWER LINE
	WATER LINE
	UNDERGROUND GAS MAIN
	OVERHEAD POWER
	UNDERGROUND POWER

BENCH MARKS

- CHISELED SQUARE ON TOP OF CURB, NW. CORNER OF NORTH PARKING LOT.
ELEV.=1264.84 (N.A.V.D. 1988)
- CHISELED SQUARE ON TOP OF CURB, N. SIDE OF ENTRANCE TO LPS, IN CORNER OF PARKING MAGAZINE, E. OF INLET.
ELEV.=1246.81 (N.A.V.D. 1988)

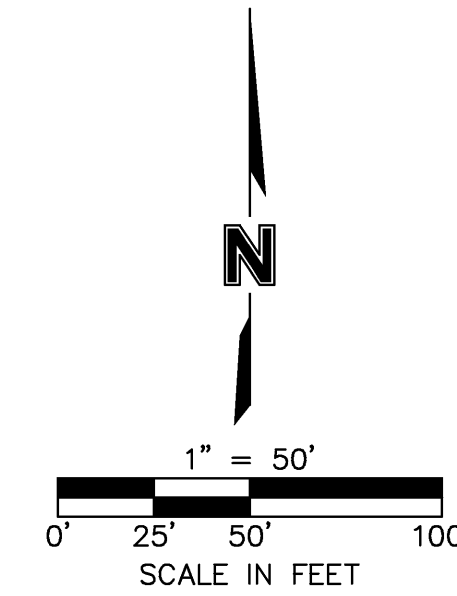

SHEET 2 OF 2

'O' STREET

SHEET 2 OF 2

LYNCREST DR.

BLDG.

COTNER BLVD.

DWG: F:\Projects\011-2489_LDVP\Final_Plans\112489_PUB_PAVPL.dwg
DATE: Mar 19, 2012 8:10am
USER: soosterhaus
property 112489-Dbase
XREFS: 0112489_PBASE

FOR BIDDING ONLY
NOT FOR
CONSTRUCTION

REVISIONS DESCRIPTION

DATE

REV. NO.

E.O.#

T.C.#

RIGHT TURN LANE
PAVING PLAN
LINCOLN PUBLIC SCHOOLS
DISTRICT OFFICE
LINCOLN, NEBRASKA

CAD
checked by: ENG
approved by: ENG
QA/QC by: ENG
project no.: 1234
drawing no.: ABC.DWG
date: 00.00.00

SHEET
1 of 2

XX-XX-XX

REVISIONS

2012

www.oaktonhilling.com
TEL: 402.474.6311
P.O. Box 94608
Lincoln, NE 68501-4608

OLSSON
ASSOCIATES

LINCOLN PUBLIC SCHOOLS DISTRICT OFFICE

PAVING PLAN

BENCHMARKS

- CHISELED SQUARE ON TOP OF CURB, NW. CORNER OF NORTH PARKING LOT. ELEV.=1264.84 (N.A.V.D. 1988)
- CHISELED SQUARE ON TOP OF CURB, N. SIDE OF ENTRANCE TO LPS, IN CORNER OF PARKING MAGAZINE, E. OF INLET. ELEV.=1246.81 (N.A.V.D. 1988)

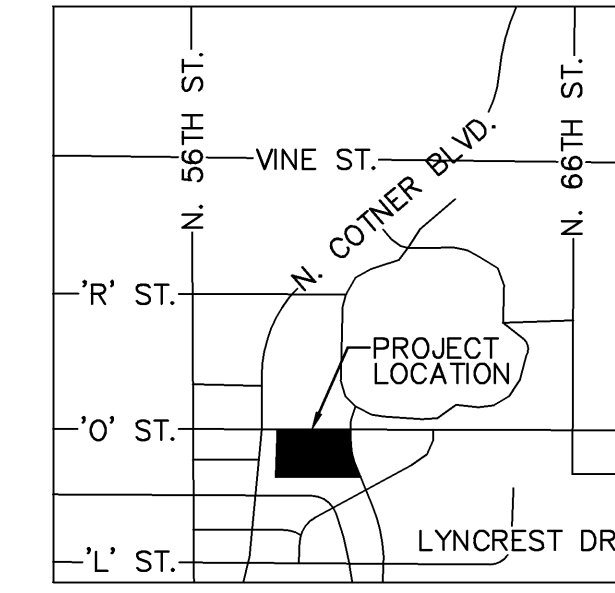

VICINITY MAP
NOT TO SCALE

PRIVATE PAVING NOTES

- ALL INTERSECTION RADII SHALL BE 20' UNLESS OTHERWISE NOTED.
- PROVIDE OPENINGS IN CURB FOR FUTURE WHEELCHAIR RAMP AS DIRECTED BY ENGINEER.
- PAVING CONTRACTOR SHALL BE RESPONSIBLE FOR PLACING THE INLET TOP AND BUILDING THE COMBINED CURB AND GUTTER THROUGH THE CONCRETE INLET TOP.
- THE CONTRACTOR SHALL VERIFY THE LOCATION AND ELEVATION OF THE EXISTING PAVEMENT.
- THE CONTRACTOR SHALL REFERENCE THE GEOTECHNICAL REPORT AND CONSTRUCT PAVEMENT SUBGRADE ACCORDING TO THE GEOTECHNICAL ENGINEER'S SPECIFICATIONS.
- CONTRACTOR SHALL FOLLOW GEOTECHNICAL REPORT RECOMMENDATIONS FOR SUBGRADE PREPARATION.
- THE CONTRACTOR SHALL COORDINATE ALL PAVEMENT TESTING.
- THE CONTRACTOR SHALL REFERENCE THE STRIPPING DETAIL FOR PAVEMENT MARKINGS.
- THE PAVING CONTRACTOR SHALL ADJUST ALL MANHOLES, VALVES, INLETS, AND CLEAN-OUTS TO GRADE. THE PAVING CONTRACTOR IS RESPONSIBLE FOR SETTING INLET TOPS.
- THE PAVING CONTRACTOR SHALL PLACE TRAFFIC RATED CAPS ON ALL CLEAN-OUTS WITHIN PAVED AREAS.
- CONTRACTOR SHALL STRIPE ALL PARKING LOTS AS SHOWN. PARKING STALL STRIPPING SHALL BE 4' WHITE MARKINGS.
- CONTRACTOR SHALL COMPLETE ALL NECESSARY PERMITS AND INSPECTIONS PRIOR TO CONSTRUCTION.
- ALL DIMENSIONS ARE TO BACK OF CURB UNLESS OTHERWISE NOTED.
- ALL COORDINATE POINTS ARE TO BACK OF CURB UNLESS SPECIFIED OTHERWISE.
- ALL ISLANDS SHALL BE CONSTRUCTED AS CONCRETE CURB AND GUTTER.
- ALL HANDICAPPED STALLS TO BE PAINTED AND SIGNPOST WITH SIGN INSTALLED.
- ALL ISLANDS AND SETBACK AREAS SHALL BE BACKFILLED WITH TOPSOIL.
- ALL CURB CUTS AND RAMPS SHALL BE IN COMPLIANCE WITH THE AMERICANS WITH DISABILITIES ACT (FEDERAL REGISTER/VOL. 58 NO. 144/RULES AND REGULATIONS).
- MAINTAIN 2% CROSS SLOPE ON SIDEWALKS UNLESS OTHERWISE NOTED. ALL SIDEWALKS TO BE 4" P.C.C. PAVEMENT.
- CONSTRUCTION OF CURB RAMPS CONSIDERED SUBSIDIARY TO THE PRICE BID FOR 4" CONCRETE SIDEWALK. (ALL CURB RAMPS SHALL BE 6" THICK W/ CROSS HATCH GROOVING ON ALL RAMP SURFACES)

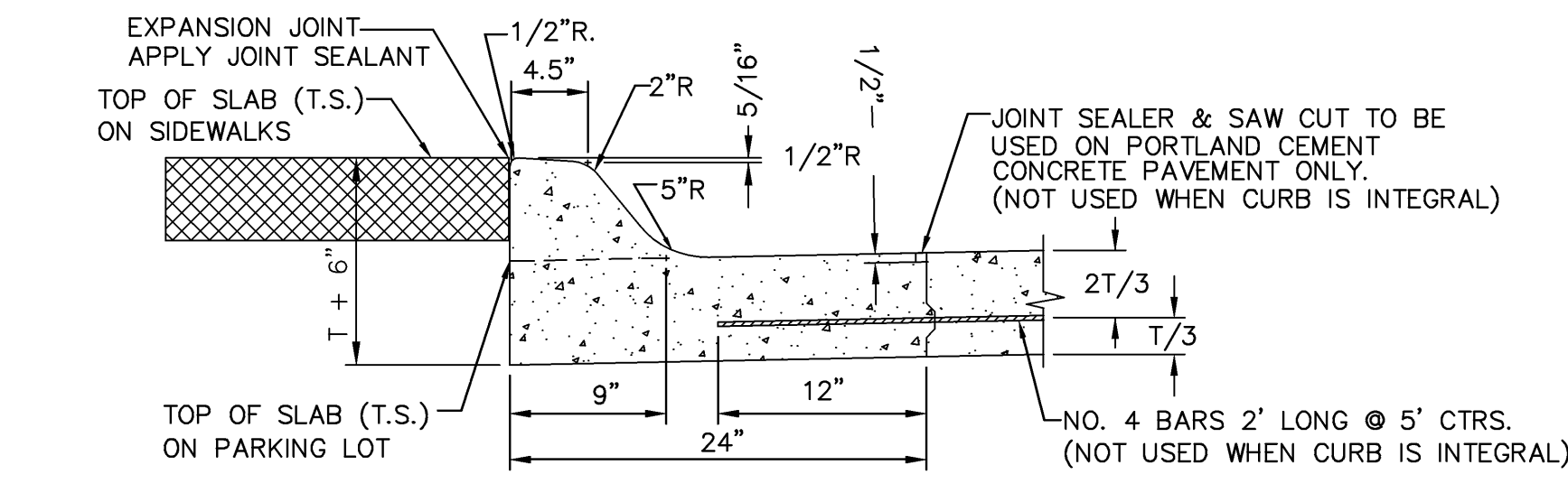

STANDARD 24" CURB & GUTTER DETAIL
NOT TO SCALE

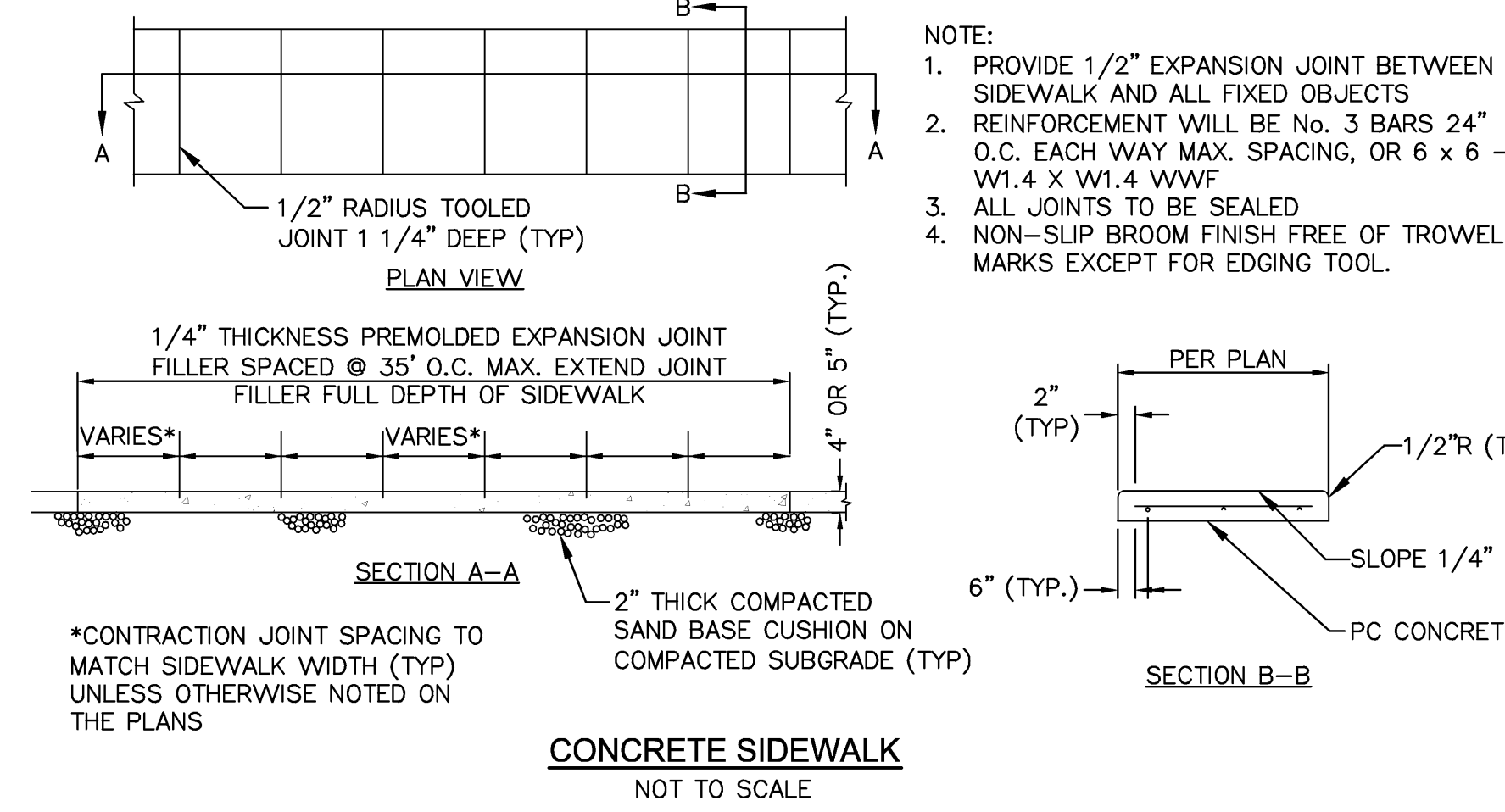

CONCRETE SIDEWALK
NOT TO SCALE

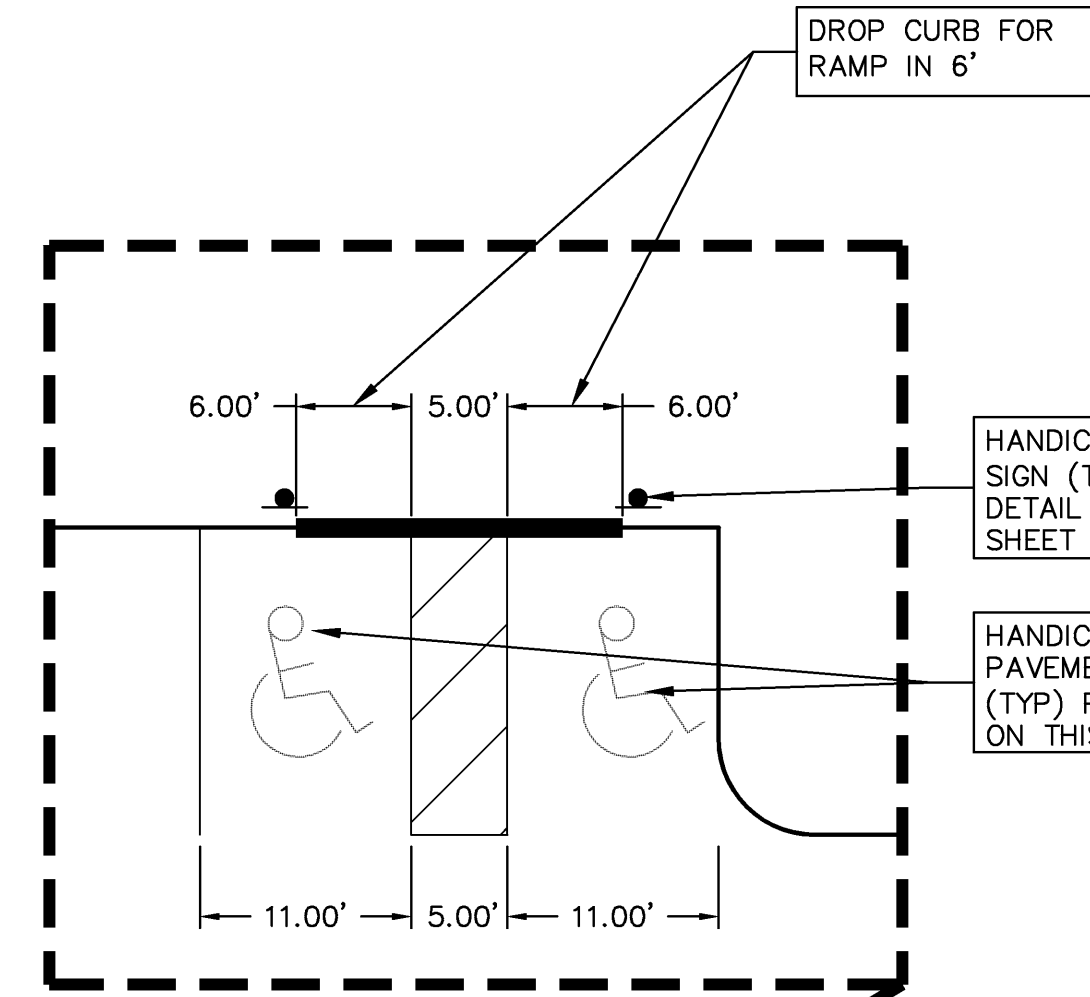

HANDICAP PARKING SIGN (TYP) PER DETAIL ON THIS SHEET

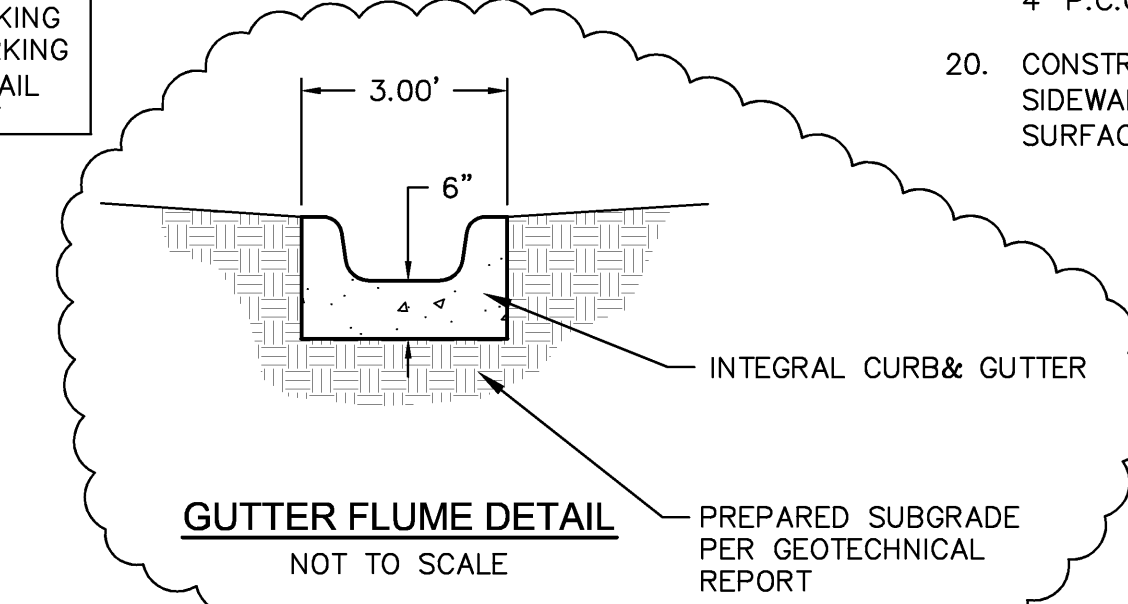

GUTTER FLUME DETAIL
NOT TO SCALE

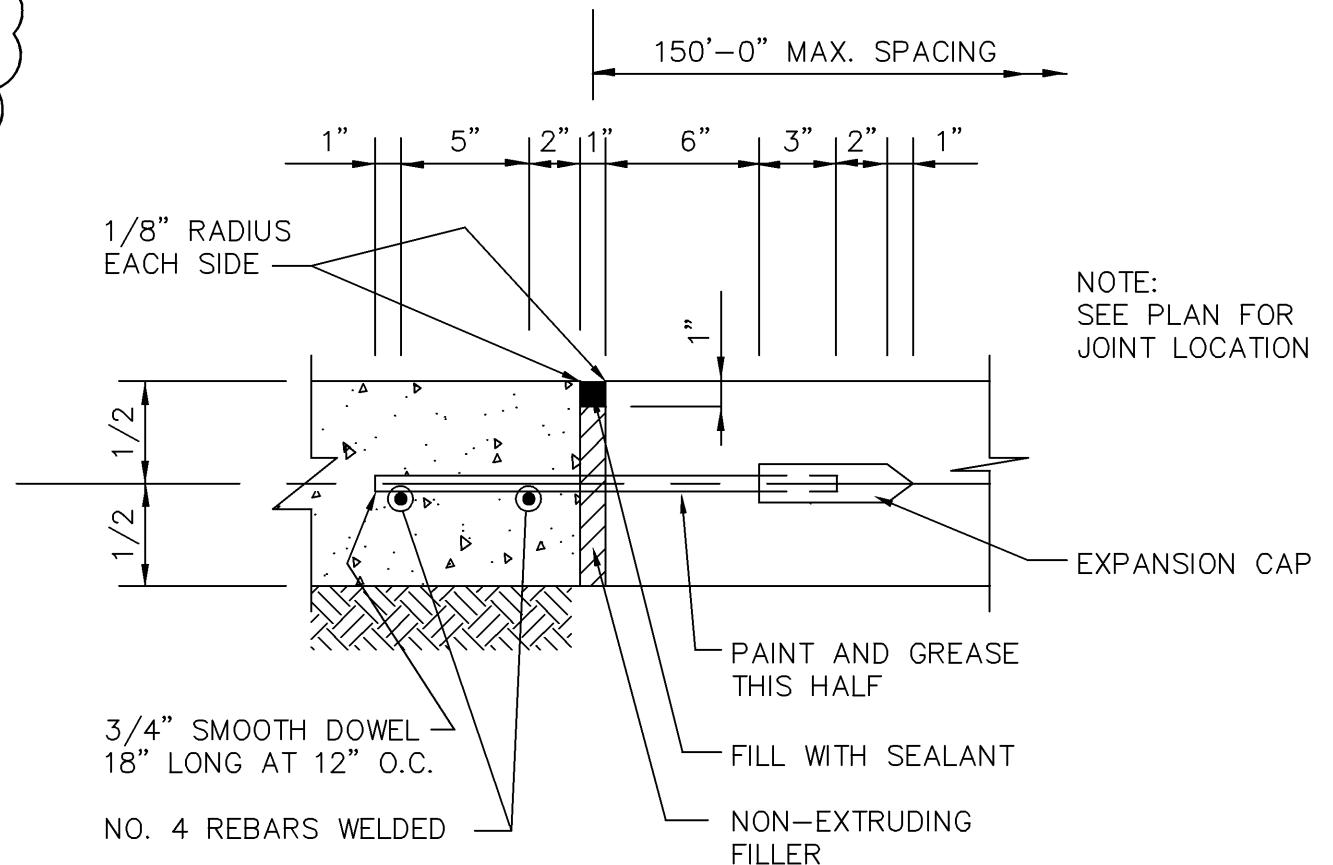

EXPANSION JOINT DETAIL
N.T.S.

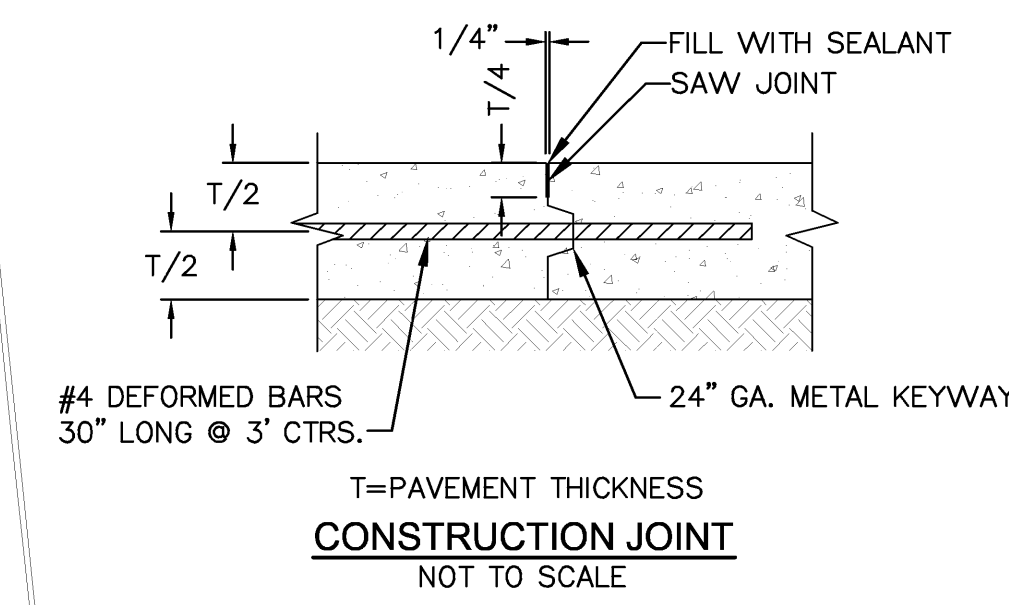

CONSTRUCTION JOINT
NOT TO SCALE

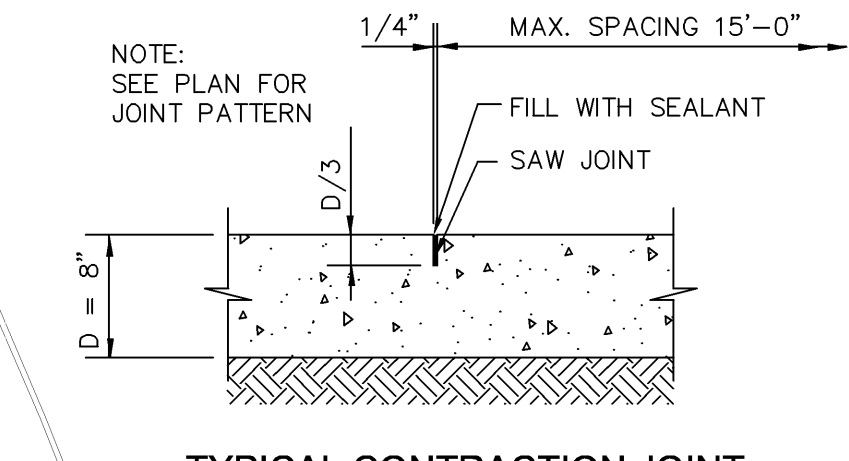

TYPICAL CONTRACTION JOINT
N.T.S.

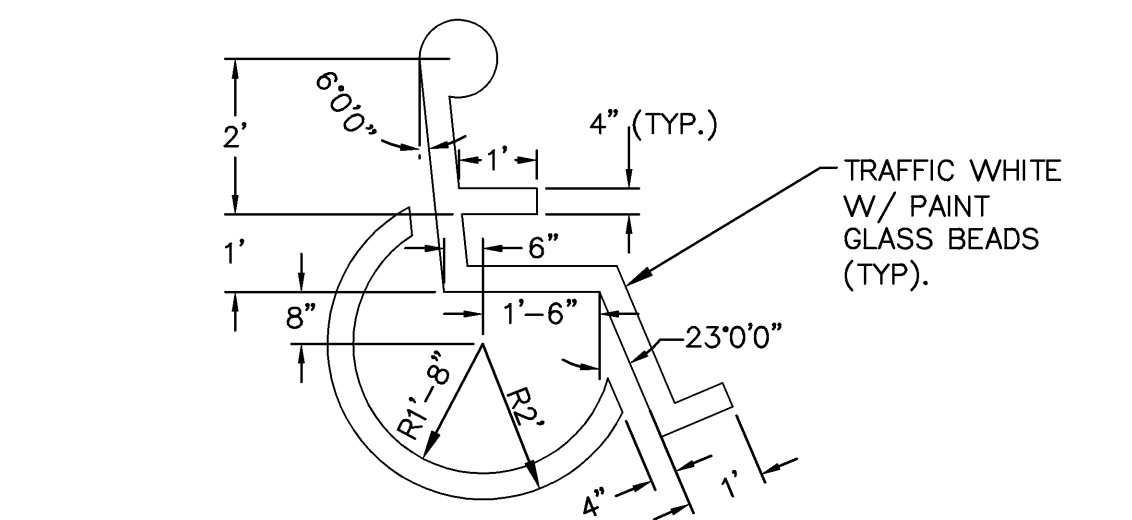

HANDICAP PARKING PAVEMENT MARKING DETAIL
NOT TO SCALE

PAVING LEGEND

- 4" THICK CONCRETE SIDEWALK
- 6" CONCRETE PAVEMENT W/CURB & GUTTER
- 8" CONCRETE PAVEMENT W/CURB & GUTTER
- 9" CONCRETE PAVEMENT W/CURB & GUTTER

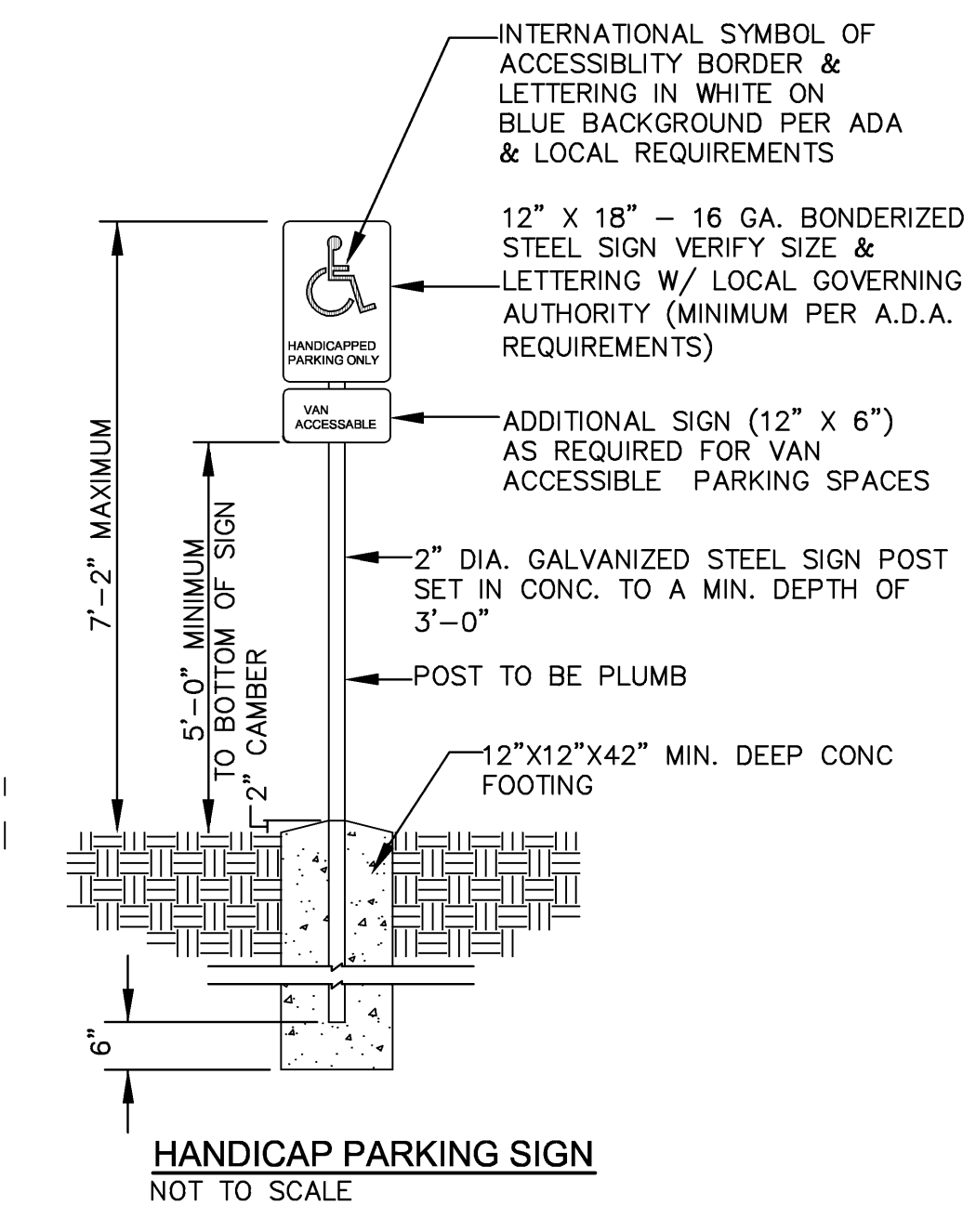

HANDICAP PARKING SIGN
NOT TO SCALE

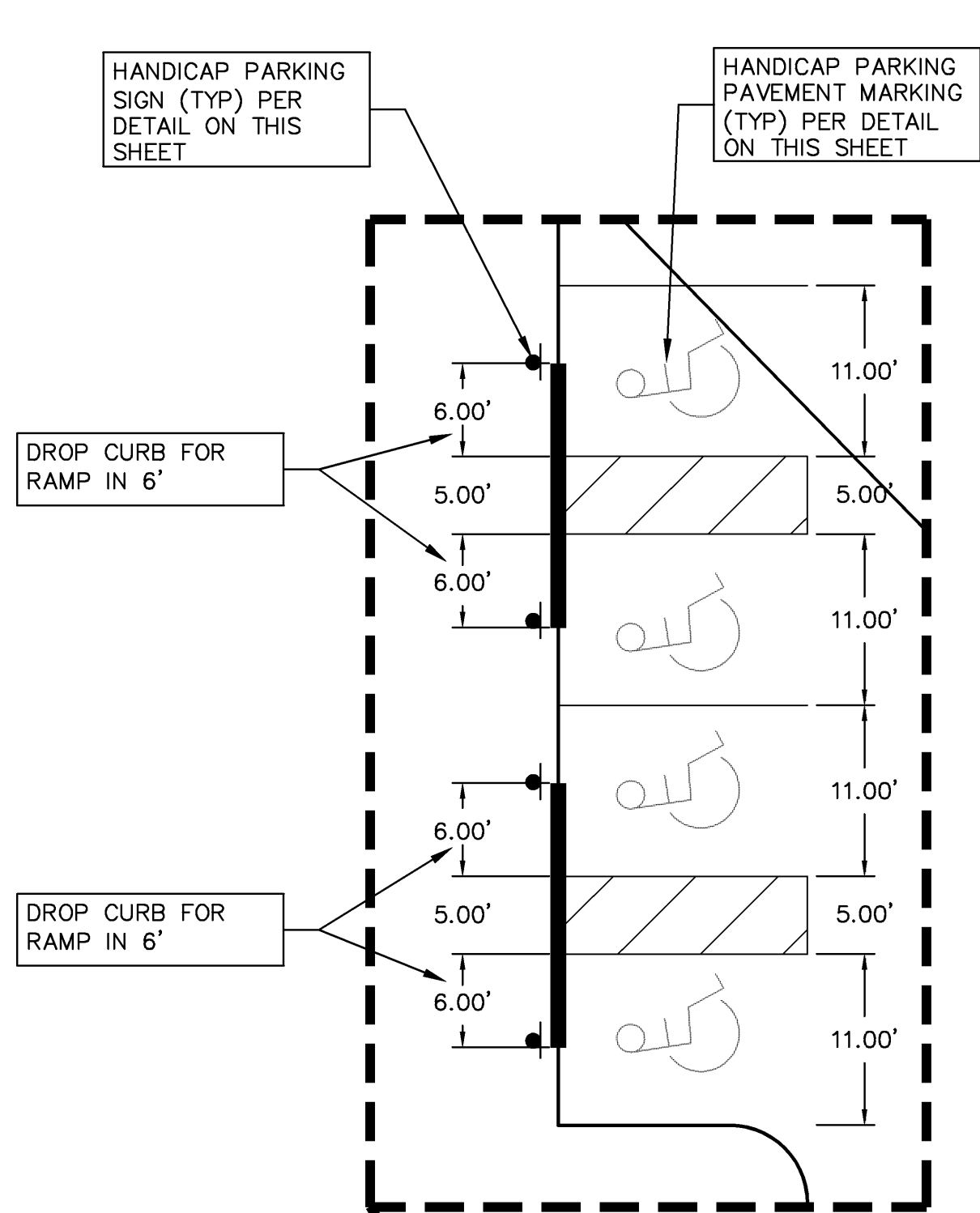

HANDICAP PARKING SIGN (TYP) PER DETAIL ON THIS SHEET

DROP CURB FOR RAMP IN 6'

DROP CURB FOR RAMP IN 6'

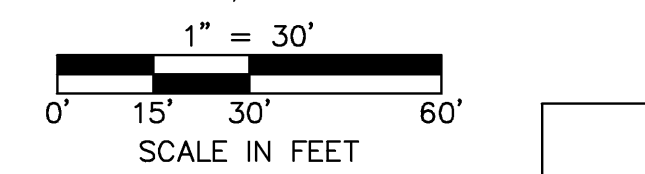
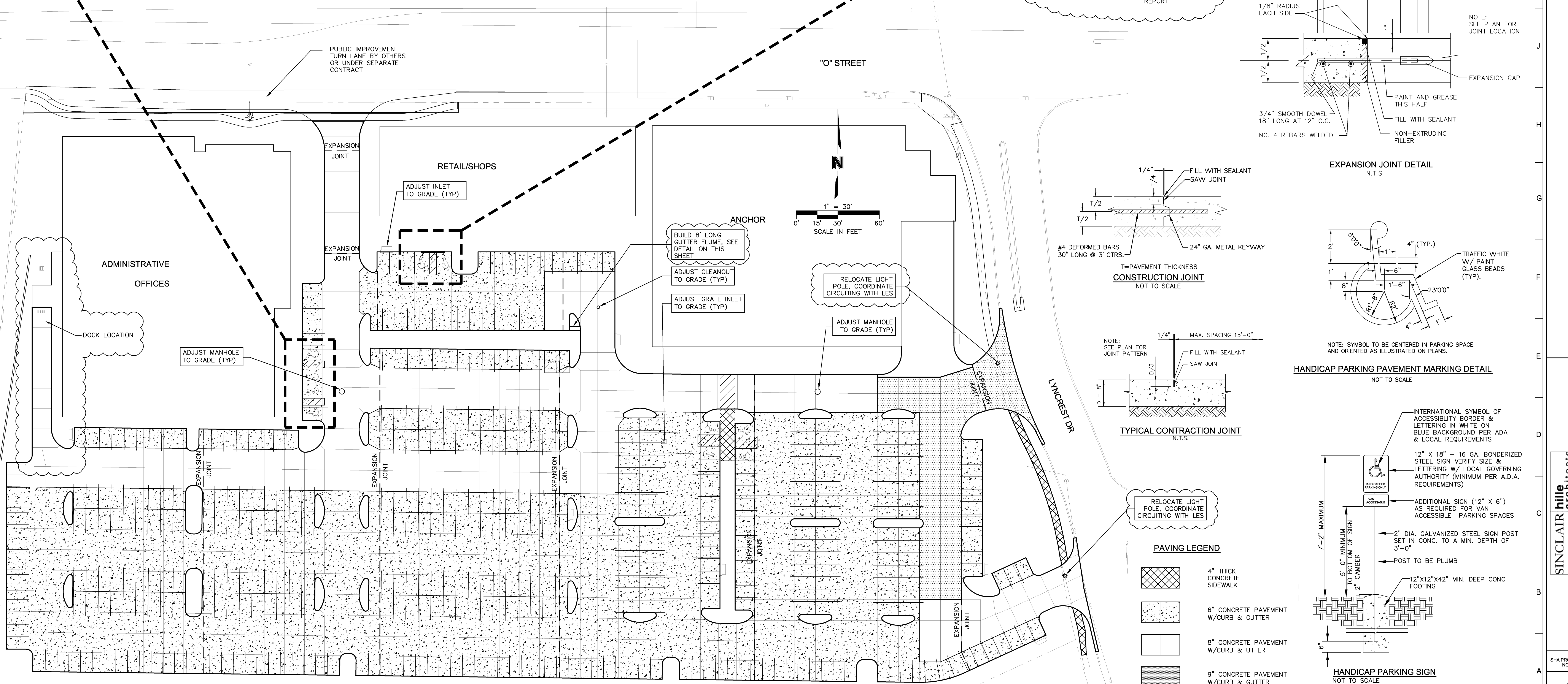

1" = 30'
SCALE IN FEET

REVISIONS	PROJECT ARCHITECT:	DRAWN BY:	AUTHOR:	DATE:
		March 9, 2012		
PROJECT CONSULTANTS	BID PACKAGE NOT TO BE USED FOR CONSTRUCTION 3/7/2012 9:35:53 AM			
	MECHANICAL ENGINEER ELECTRICAL ENGINEER CIVIL ENGINEER STRUCTURAL ENGINEER 1201 O' Street, Suite 310 Lincoln, NE 68508 T: 402.477.6600			
LPS District Office				
	SINCLAIR hill architects 700 O St. Lincoln, NE 68508 T: 402.476.8341			
SHA PROJECT NO.	11065			PAVING PLAN
C200				

DWG: F:\Projects\011-2489_LDVP\Final_Plan\12489_PRTV_PAVI.dwg
 DATE: Mar 15, 2012 11:24am
 USER: scatenious
 property: 112489-0base
 0112489_Tile Block

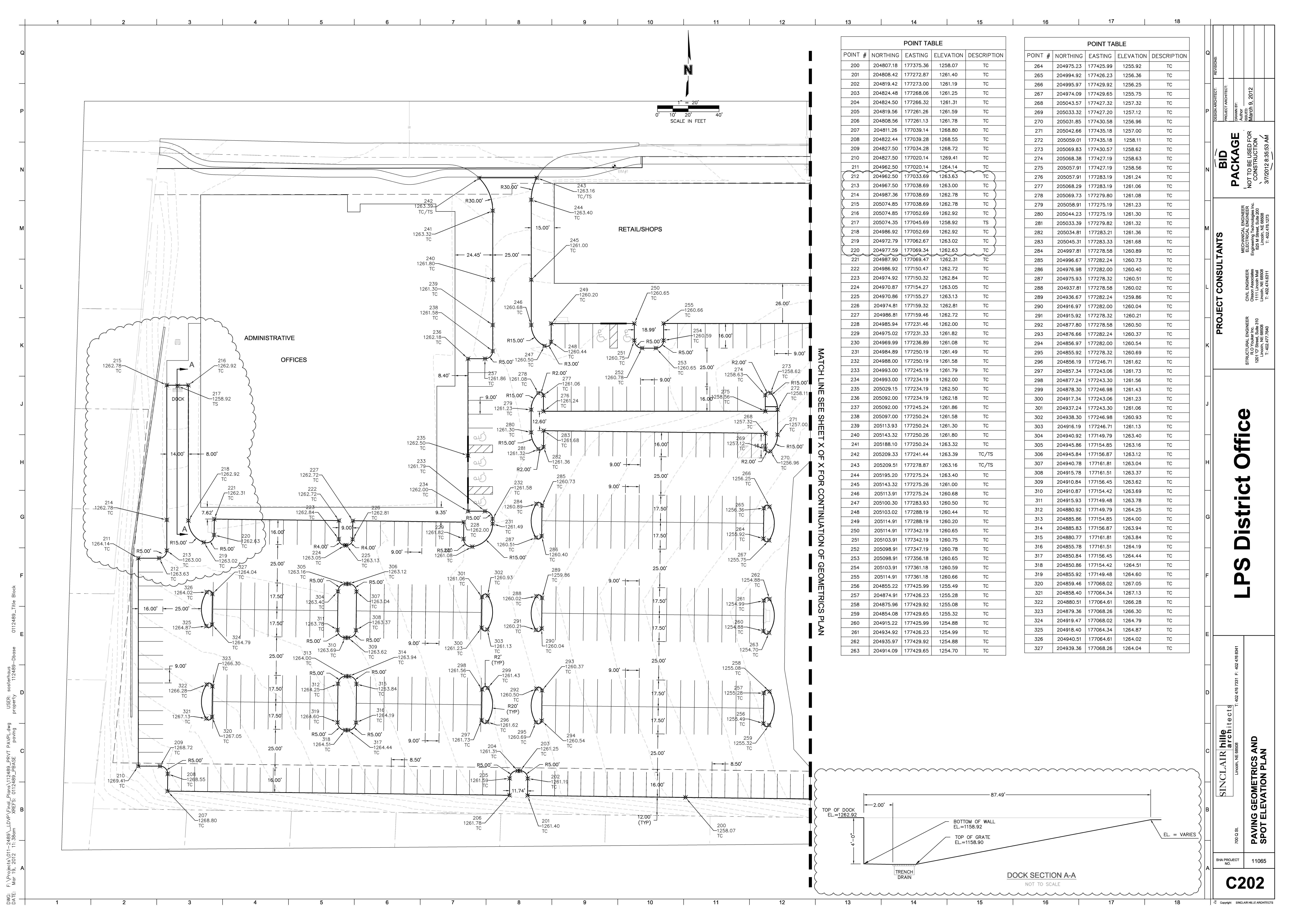

POINT TABLE				
POINT #	NORTHING	EASTING	ELEVATION	DESCRIPTION
200	204807.18	177375.36	1258.07	TC
201	204808.42	177272.87	1261.40	TC
202	204819.42	177273.00	1261.19	TC
203	204824.48	177268.06	1261.25	TC
204	204824.50	177266.32	1261.31	TC
205	204819.56	177261.26	1261.59	TC
206	204808.56	177261.13	1261.78	TC
207	204811.26	177039.14	1268.80	TC
208	204822.44	177039.28	1268.55	TC
209	204827.50	177034.28	1268.72	TC
210	204827.50	177020.14	1269.41	TC
211	204962.50	177020.14	1264.14	TC
212	204962.50	177033.69	1263.63	TC
213	204967.50	177038.69	1263.00	TC
214	204987.36	177038.69	1262.78	TC
215	205074.85	177038.69	1262.78	TC
216	205074.85	177052.69	1262.92	TC
217	205074.35	177045.69	1258.92	TS
218	204986.92	177052.69	1262.92	TC
219	204972.79	177062.67	1263.02	TC
220	204977.59	177069.34	1262.63	TC
221	204987.90	177069.47	1262.31	TC
222	204986.92	177150.47	1262.72	TC
223	204974.92	177150.32	1262.84	TC
224	204970.87	177154.27	1263.05	TC
225	204970.86	177155.27	1263.13	TC
226	204974.81	177159.32	1262.81	TC
227	204986.81	177159.46	1262.72	TC
228	204985.94	177231.46	1262.00	TC
229	204975.02	177231.33	1261.82	TC
230	204969.99	177236.89	1261.08	TC
231	204984.89	177250.19	1261.49	TC
232	204988.00	177250.19	1261.58	TC
233	204993.00	177245.19	1261.79	TC
234	204993.00	177234.19	1262.00	TC
235	205029.15	177234.19	1262.50	TC
236	205092.00	177234.19	1262.18	TC
237	205092.00	177245.24	1261.86	TC
238	205097.00	177250.24	1261.58	TC
239	205113.93	177250.24	1261.30	TC
240	205143.32	177250.26	1261.80	TC
241	205188.10	177250.24	1263.32	TC
242	205209.33	177241.44	1263.39	TC/TS
243	205209.51	177278.87	1263.16	TC/TS
244	205195.20	177275.24	1263.40	TC
245	205143.32	177275.26	1261.00	TC
246	205113.91	177275.24	1260.68	TC
247	205100.30	177283.93	1260.50	TC
248	205103.02	177288.19	1260.44	TC
249	205114.91	177288.19	1260.20	TC
250	205114.91	177342.19	1260.65	TC
251	205103.91	177342.19	1260.75	TC
252	205098.91	177347.19	1260.78	TC
253	205098.91	177356.18	1260.65	TC
254	205103.91	177361.18	1260.59	TC
255	205114.91	177361.18	1260.66	TC
256	204855.22	177425.99	1255.49	TC
257	204874.91	177426.23	1255.28	TC
258	204875.96	177429.92	1255.08	TC
259	204854.08	177429.65	1255.32	TC
260	204915.22	177425.99	1254.88	TC
261	204934.92	177426.23	1254.99	TC
262	204935.97	177429.92	1254.88	TC
263	204914.09	177429.65	1254.70	TC

POINT TABLE				
POINT #	NORTHING	EASTING	ELEVATION	DESCRIPTION
264	204975.23	177425.99	1255.92	TC
265	204994.92	177426.23	1256.36	TC
266	204995.97	177429.92	1256.25	TC
267	204974.09	177429.65	1255.75	TC
268	205043.57	177427.32	1257.32	TC
269	205033.32	177427.20	1257.12	TC
270	205031.85	177430.58	1256.96	TC
271	205042.66	177435.18	1257.00	TC
272	205059.01	177435.18	1258.11	TC
273	205069.83	177430.57	1258.62	TC
274	205068.38	177427.19	1258.63	TC
275	205057.91	177427.19	1258.56	TC
276	205057.91	177283.19	1261.24	TC
277	205068.29	177283.19	1261.06	TC
278	205069.73	177279.80	1261.08	TC
279	205058.91	177275.19	1261.23	TC
280	205044.23	177275.19	1261.30	TC
281	205033.39	177279.82	1261.32	TC
282	205034.81	177283.21	1261.36	TC
283	205045.31	177283.33	1261.68	TC
284	204997.81	177278.58	1260.89	TC
285	204996.67	177282.24	1260.73	TC
286	204976.98	177282.00	1260.40	TC
287	204975.93	177278.32	1260.51	TC
288	204937.81	177278.58	1260.02	TC
289	204936.67	177282.24	1259.86	TC
290	204916.97	177282.00	1260.04	TC
291	204915.92	177278.32	1260.21	TC
292	204877.80	177278.58	1260.50	TC
293	204876.66	177282.24	1260.37	TC
294	204856.97	177282.00	1260.54	TC
295	204855.92	177278.32	1260.69	TC
296	204856.19	177246.71	1261.62	TC
297	204857.34	177243.06	1261.73	TC
298	204877.24	177243.00	1261.56	TC
299	204878.30	177246.98	1261.43	TC
300	204917.34	177243.06	1261.23	TC
301	204937.24	177243.00	1261.06	TC
302	204938.30	177246.98	1260.93	TC
303	204916.19	177246.71	1261.13	TC
304	204940.92	177149.79	1263.40	TC
305	204945.86	177154.85	1263.16	TC
306	204945.84	177156.87	1263.12	TC
307	204940.78	177161.81	1263.04	TC
308	204915.78	177161.51	1263.37	TC
309	204910.84	177156.45	1263.62	TC
310	204910.87	177154.42	1263.69	TC
311	204915.93	177149.48	1263.78	TC
312	204880.92	177149.79	1264.25	TC
313	204885.86	177154.85	1264.00	TC
314	204885.83	177156.87	1263.94	TC
315	204880.77	177161.81	1263.84	TC
316	204855.78	177161.51	1264.19	TC
317	204850.84	177156.45	1264.44	TC
318	204850.86	177154.42	1264.51	TC
319	204855.92	177149.48	1264.60	TC
320	204859.46	177068.02	1267.05	TC
321	204858.40	177064.34	1267.13	TC
322	204880.51	177064.61	1266.28	TC
323	204879.36	177068.26	1266.30	TC
324	204918.47	177068.02	1264.79	TC
325	204918.40	177064.34	1264.87	TC
326	204940.51	177064.61	1264.02	TC
327	204939.36	177068.26	1264.04	TC

MATCH LINE SEE SHEET X OF X FOR CONTINUATION OF GEOMETRICS PLAN

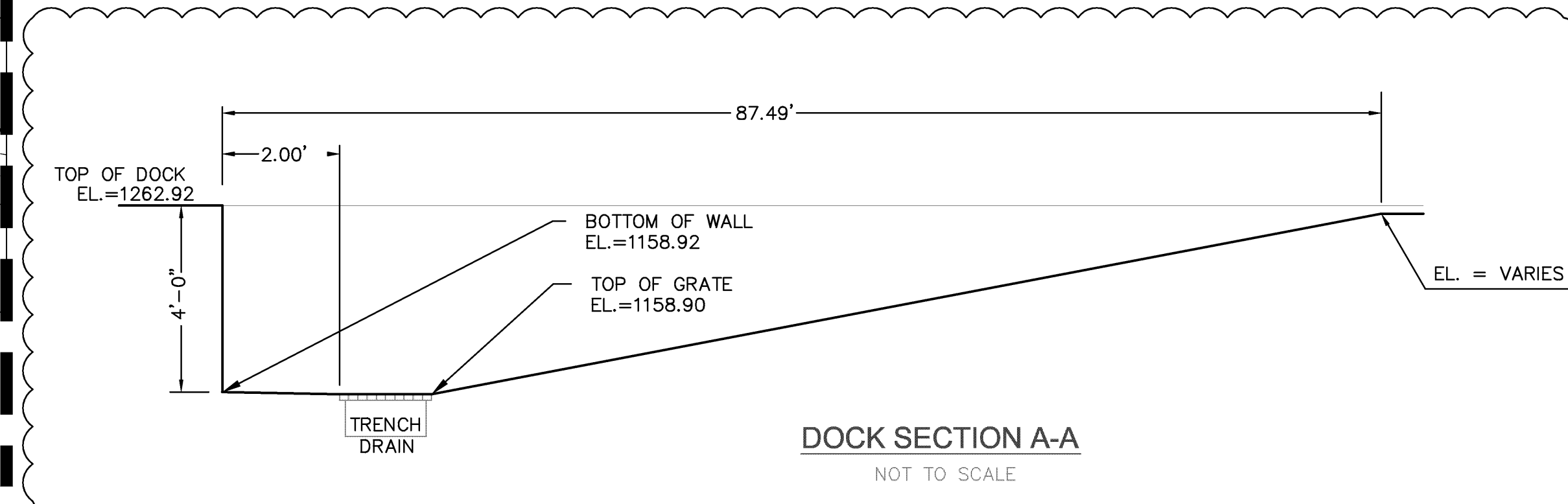

BID PACKAGE
NOT TO BE USED FOR CONSTRUCTION
3/7/2012 9:35:53 AM

PROJECT CONSULTANTS

MECHANICAL ENGINEER
ELECTRICAL ENGINEER
CIVIL ENGINEER
STRUCTURAL ENGINEER

SINCLAIR hille architects
Lincoln, NE 68508
700 Q St.
T: 402.476.7331 F: 402.476.8341

LPS District Office

PAVING GEOMETRICS AND SPOT ELEVATION PLAN

SHA PROJECT NO. 11065

C202

USER: sosterhaus\112489_title_block
 PROJECT: 112489-02ase
 DWG: F:\Projects\011-2489\LDVP\Final_Plan\112489_PAVING_PAVING.dwg
 DATE: Mar 15, 2012 11:36am