

June 6, 2019

Addendum CC-03

Milford Public Schools
Jr-Sr High School Addn. & Renovation
301 G Street
Milford, NE 68405

CWP # 18121



**CARLSON
WEST
POVONDRA**
ARCHITECTS

5060 Dodge Street
Omaha, Nebraska 68132
402.551.1500

cwparchitects.com

NOTICE TO BIDDERS:

- A. This Addendum is issued to all registered plan holders pursuant to the Instructions to Bidders and serves to clarify, revise, and supersede information in the Project Manual, Drawings, and previously issued Addenda. Once issued, portions of this Addendum affecting the Contract Documents shall be considered as fully incorporated into the Contract Documents unless further modified by subsequent Addenda.
- B. There are (2) previous Addenda issued.
- C. The Bidder shall acknowledge receipt of Addenda in the appropriate space on the Bid Form.
- D. The date for receipt of bids is NOT changed by this Addendum.
 - 1. Bid Date: June 7th at 2pm.
- E. The Contract Documents for the above referenced project are hereby amended as follows:

ASSOCIATED CONSULTANT ADDENDA:

Item No. A1 Civil Work - Sheet C2.1 Removal Plan

- A. See E&A Addendum 3, Responses to City Comments, attached hereto and dated 6/6/2019 for additional addendum items. This Sheet is Revised & Re-Issued per this Addendum.

Item No. A2 Civil Work - Sheet C3.1 Paving and Layout Plan

- A. See E&A Addendum 3, Responses to City Comments, attached hereto and dated 6/6/2019 for additional addendum items. This Sheet is Revised & Re-Issued per this Addendum

Item No. A3 Civil Work - Sheet C4.1 Grading and Landscape Plan

- A. See E&A Addendum 3, Responses to City Comments, attached hereto and dated 6/6/2019 for additional addendum items. This Sheet is Revised & Re-Issued per this Addendum

Item No. A4 Civil Work - Sheet C6.1 General Notes and Details

- A. See E&A Addendum 3, Responses to City Comments, attached hereto and dated 6/6/2019 for additional addendum items. This Sheet is Revised & Re-Issued per this Addendum

END OF ADDENDUM

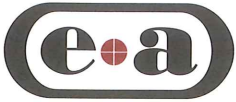

June 6, 2019

Kendall Hoggins
City of Milford
505 First Street
PO Box 13
Milford, NE 68405

RE: Milford Jr.-Sr. High School Addition
Milford, NE
E&A #P2018.264.002

Kendall:

I have review the City comments for the above referenced project and have the following responses (shown in red):

Civil/Site Engineering Comments

1. Accessible Routes: Existing sidewalk has been removed and replaced with a 5' sidewalk to provide an accessible route to the addition
2. Accessible ramps shall be on the east and west end of the sidewalks serving the new addition. Current ramps do not meet accessibility guidelines. Existing ramps east of the addition have been removed and replaced with an accessible depressed handicap ramp to provide access from the ADA parking stall.
3. The accessible parking stall shall be van accessible. A handicap stall and appropriate loading zone haven been added to the plan. The existing parking lot slopes currently accessibility guidelines so only striping and signage was necessary.

Please feel free to contact Doug Walter or me at 402-895-4700 or email with any further questions or comments.

Sincerely,

E & A CONSULTING GROUP, INC.

Brett Conyers, P.E.

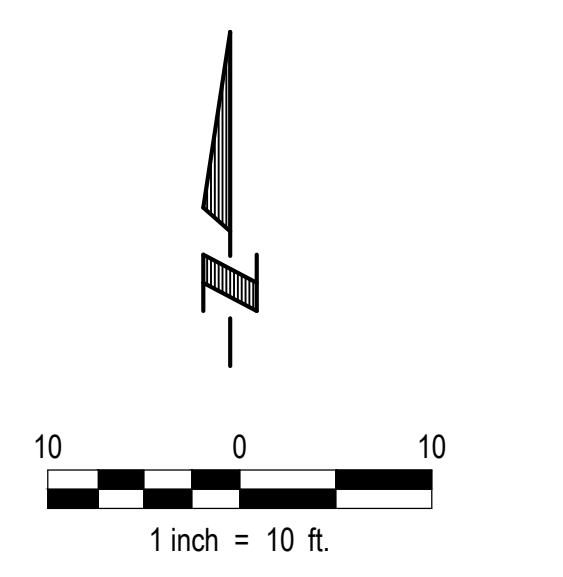
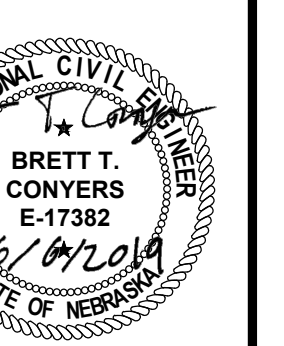

LEGEND

- Remove P.C.C. Sidewalk
- Remove Pavement w/ Integral Curb
- Clear and Grub Tree

REMOVAL NOTES

- RN 1 Remove P.C.C. Sidewalk
- RN 2 Sawcut and Remove P.C.C. Pavement w/ Integral Curb
- RN 3 Sawcut and Remove Concrete Sidewalk
- RN 4 Clear and Grub Tree
- RN 5 Existing Sanitary Sewer to Remain
- RN 6 Existing Gas Main to Be Relocated, Coordinate Relocation with Architect
- RN 7 Existing Sidewalk to Remain
- RN 8 Existing Pavement to Remain

NO.	REVISION	SCHEDULE	DATE	BY	CHKD
1					

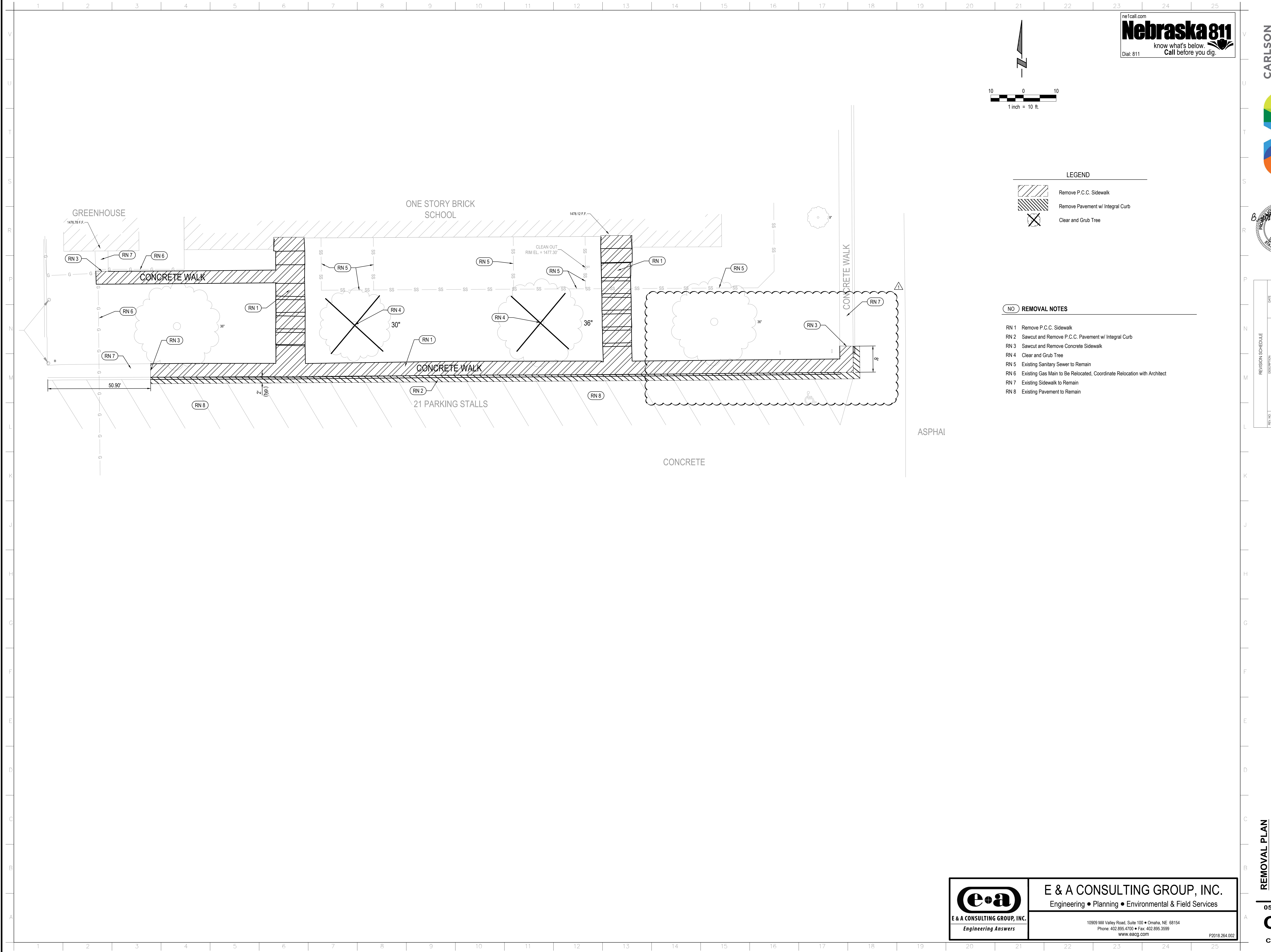

ASPHAI

CONCRETE

 E & A CONSULTING GROUP, INC. Engineering Answers	E & A CONSULTING GROUP, INC. Engineering • Planning • Environmental & Field Services
	10909 Mill Valley Road, Suite 100 • Omaha, NE 68154 Phone: 402.895.4700 • Fax: 402.895.3599 www.eacg.com

REMOVAL PLAN
MILFORD PUBLIC SCHOOLS
JR. - SR. HIGH SCHOOL ADDN. & RENOVATION
 301 'G' STREET, MILFORD, NE 68405
 05/17/2019
C2.1
 CWP 18121

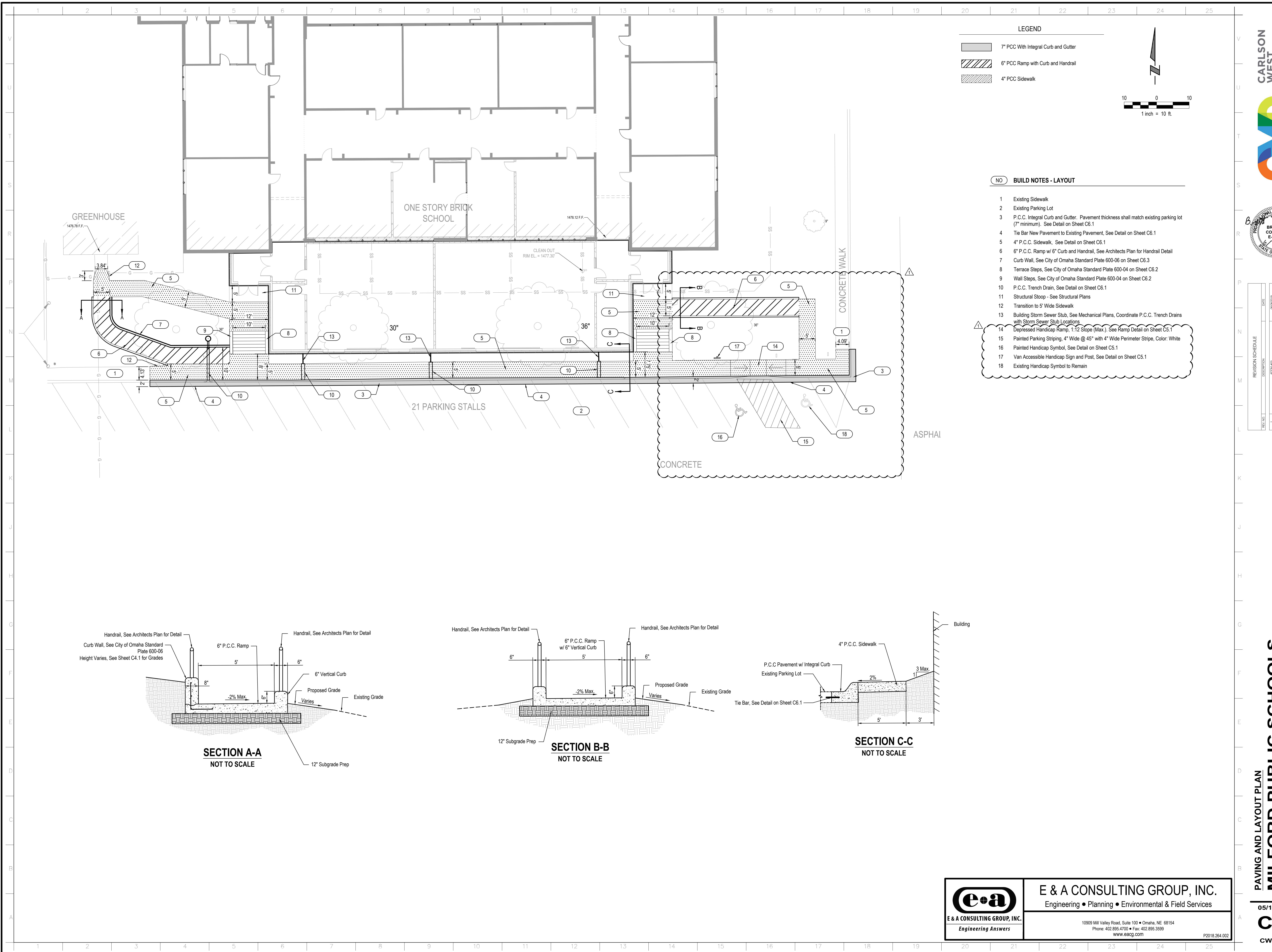

LEGEND

- 7" PCC With Integral Curb and Gutter
- 6" PCC Ramp with Curb and Handrail
- 4" PCC Sidewalk

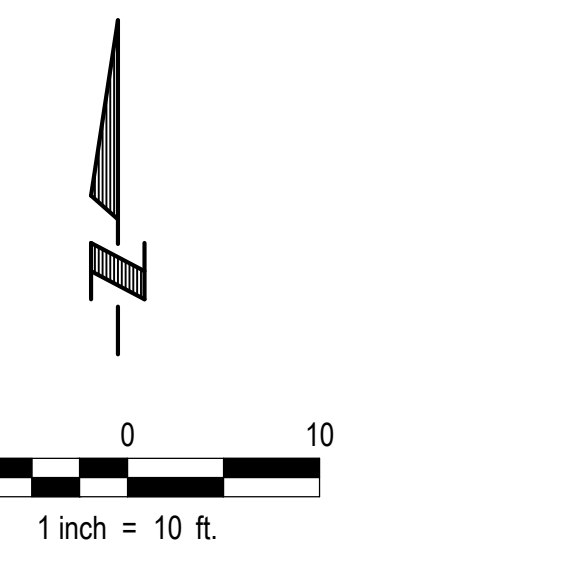

- BUILD NOTES - LAYOUT**
- 1 Existing Sidewalk
 - 2 Existing Parking Lot
 - 3 P.C.C. Integral Curb and Gutter. Pavement thickness shall match existing parking lot (7" minimum). See Detail on Sheet C6.1
 - 4 Tie Bar New Pavement to Existing Pavement, See Detail on Sheet C6.1
 - 5 4" P.C.C. Ramp, See Detail on Sheet C6.1
 - 6 6" P.C.C. Ramp w/ 6" Curb and Handrail, See Architects Plan for Handrail Detail
 - 7 Curb Wall, See City of Omaha Standard Plate 600-06 on Sheet C6.3
 - 8 Terrace Steps, See City of Omaha Standard Plate 600-04 on Sheet C6.2
 - 9 Wall Steps, See City of Omaha Standard Plate 600-04 on Sheet C6.2
 - 10 P.C.C. Trench Drain, See Detail on Sheet C6.1
 - 11 Structural Stoop - See Structural Plans
 - 12 Transition to 5' Wide Sidewalk
 - 13 Building Storm Sewer Stub, See Mechanical Plans. Coordinate P.C.C. Trench Drains with Storm Sewer Stub Locations
 - 14 Depressed Handicap Ramp, 1:12 Slope (Max.) See Ramp Detail on Sheet C5.1
 - 15 Painted Parking Striping, 4" Wide @ 45° with 4" Wide Perimeter Stripes, Color: White
 - 16 Painted Handicap Symbol, See Detail on Sheet C5.1
 - 17 Van Accessible Handicap Sign and Post, See Detail on Sheet C5.1
 - 18 Existing Handicap Symbol to Remain

CARLSON WEST POVONDRA ARCHITECTS

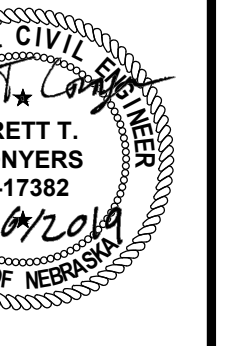

NO.	REVISION	SCHEDULE	DATE	BY	CHKD.
1					

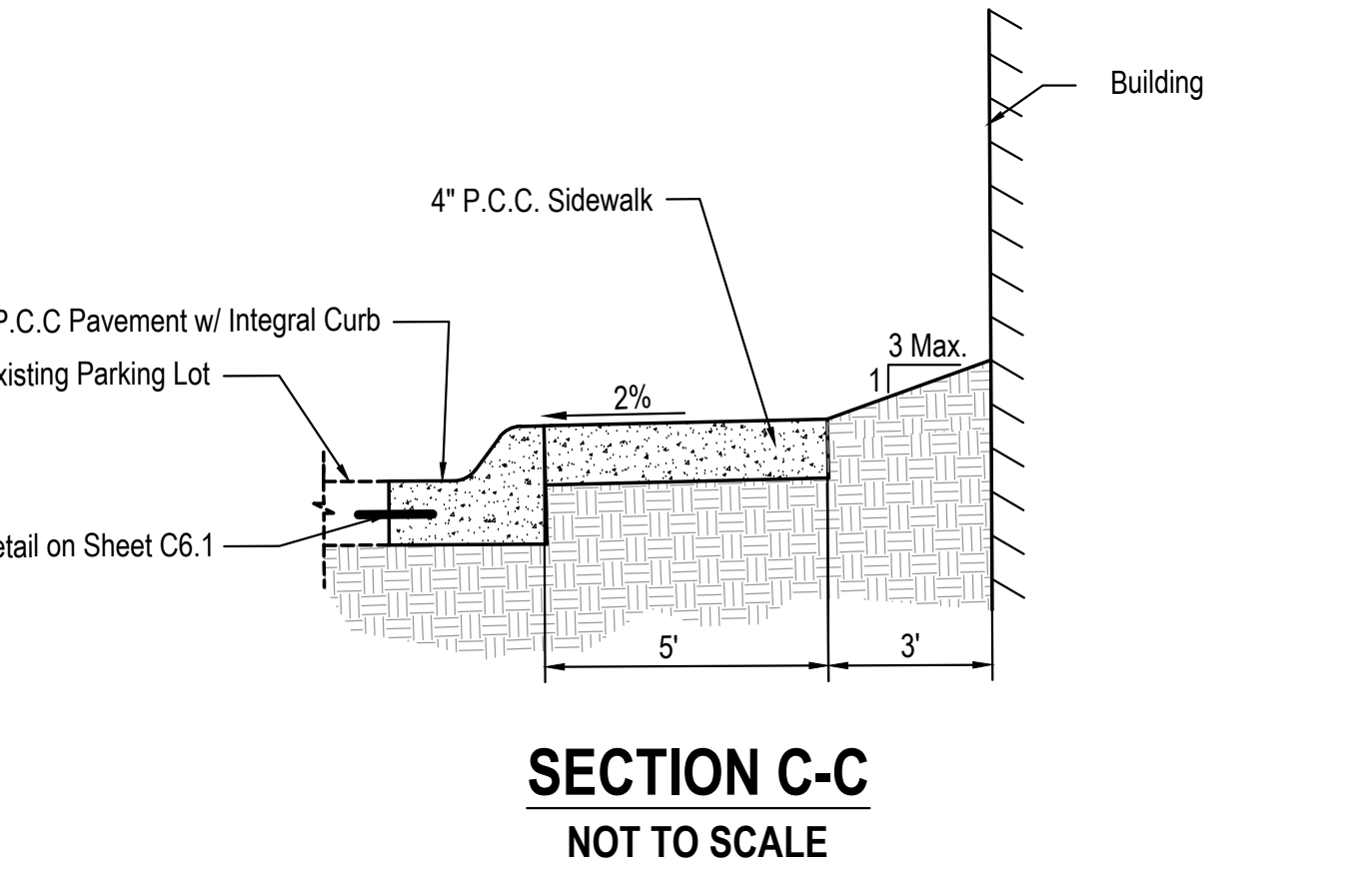
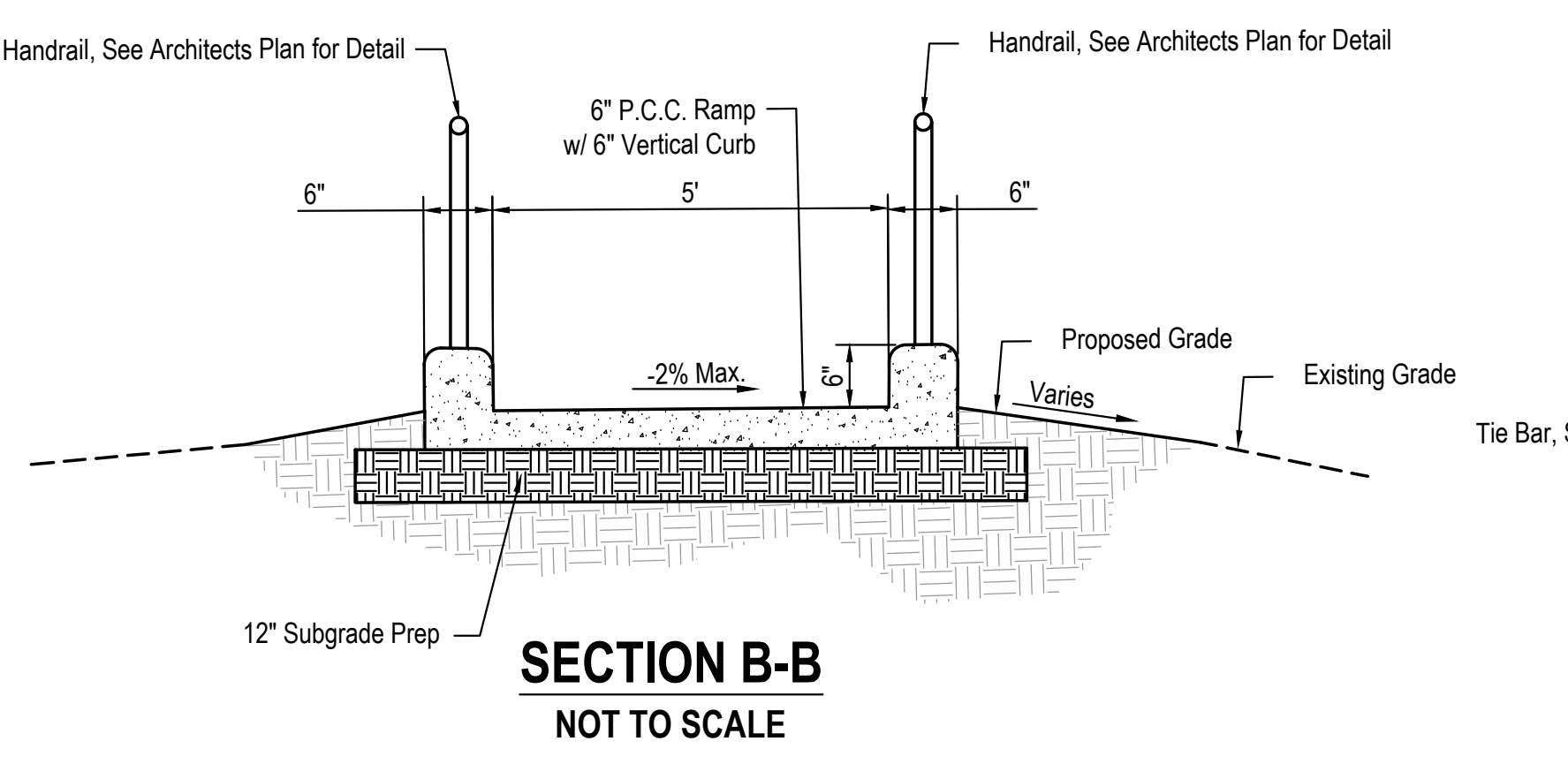
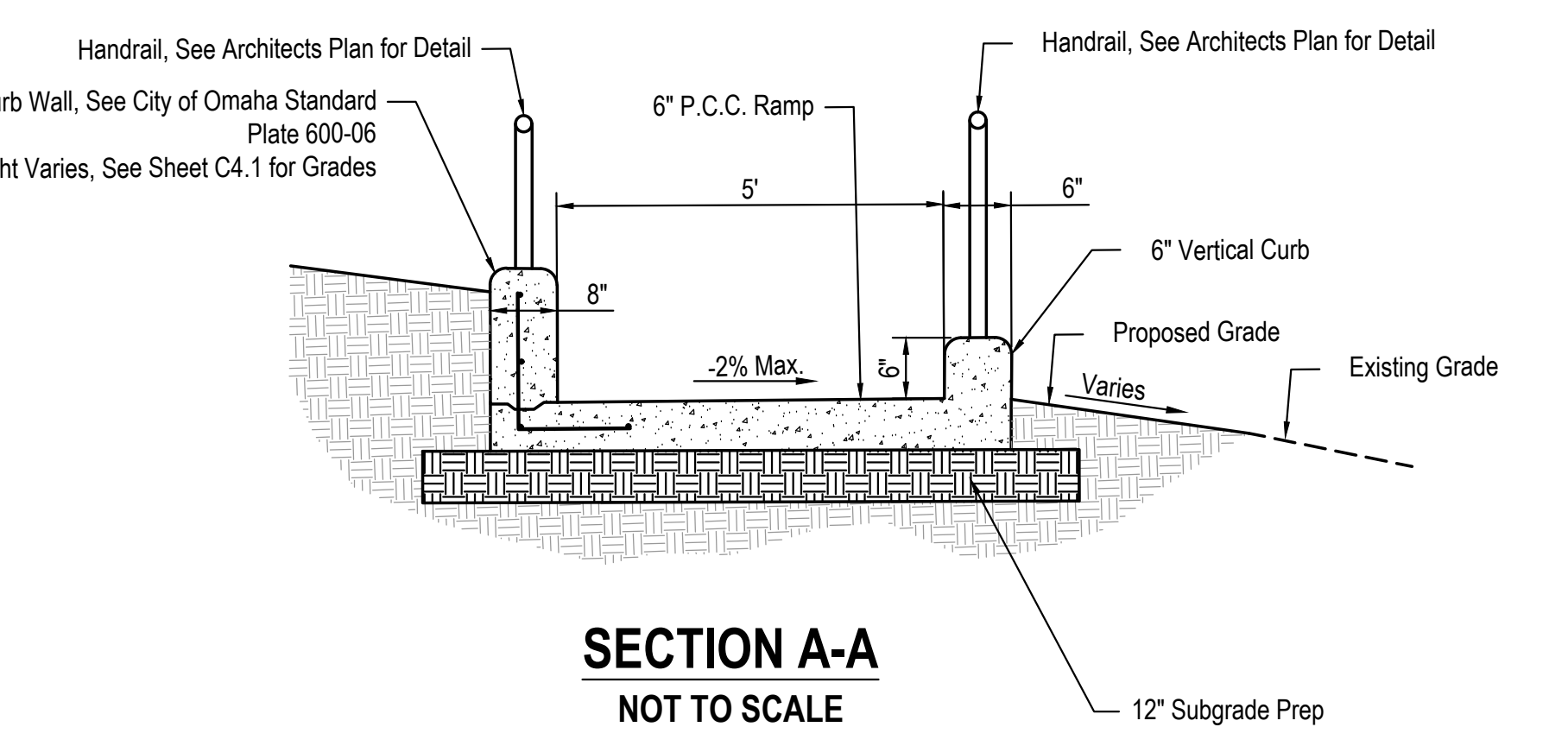

PAVING AND LAYOUT PLAN
MILFORD PUBLIC SCHOOLS
JR. - SR. HIGH SCHOOL ADDN. & RENOVATION
301 'G' STREET, MILFORD, NE 68405

E & A CONSULTING GROUP, INC.
Engineering • Planning • Environmental & Field Services

10909 Mill Valley Road, Suite 100 • Omaha, NE 68154
 Phone: 402.895.4700 • Fax: 402.895.3599
 www.eacg.com

05/17/2019
C3.1
 CWP 18121

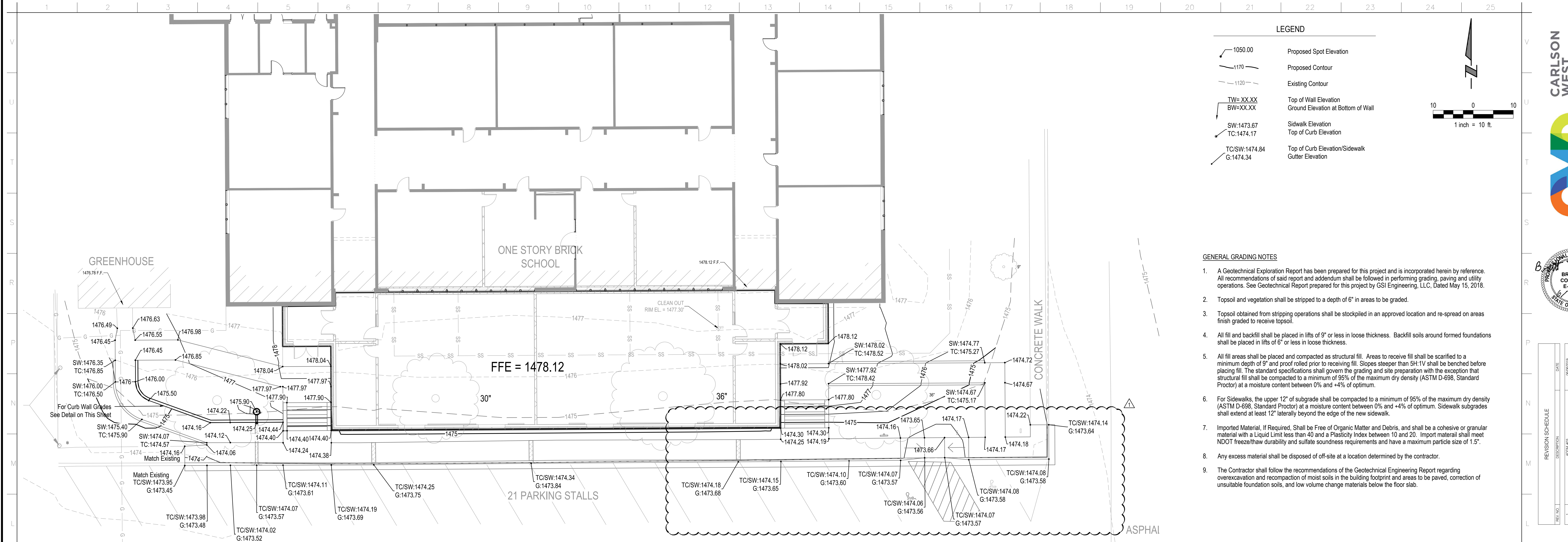

- LEGEND**
- 1060.00 Proposed Spot Elevation
 - 1170 Proposed Contour
 - 1120 Existing Contour
 - TW= XX.XX Top of Wall Elevation
 - BW=XX.XX Ground Elevation at Bottom of Wall
 - SW:1473.67 Sidewalk Elevation
 - TC:1474.17 Top of Curb Elevation
 - TC/SW:1474.84 Top of Curb Elevation/Sidewalk
 - G:1474.34 Gutter Elevation

- GENERAL GRADING NOTES**
1. A Geotechnical Exploration Report has been prepared for this project and is incorporated herein by reference. All recommendations of said report and addendum shall be followed in performing grading, paving and utility operations. See Geotechnical Report prepared for this project by GSI Engineering, LLC, Dated May 15, 2018.
 2. Topsoil and vegetation shall be stripped to a depth of 6" in areas to be graded.
 3. Topsoil obtained from stripping operations shall be placed in an approved location and re-spread on areas finish graded to receive topsoil.
 4. All fill and backfill shall be placed in lifts of 9" or less in loose thickness. Backfill soils around formed foundations shall be placed in lifts of 6" or less in loose thickness.
 5. All fill areas shall be placed and compacted as structural fill. Areas to receive fill shall be scarified to a minimum depth of 9" and proof rolled prior to receiving fill. Slopes steeper than 5H:1V shall be benched before placing fill. The standard specifications shall govern the grading and site preparation with the exception that structural fill shall be compacted to a minimum of 95% of the maximum dry density (ASTM D-698, Standard Proctor) at a moisture content between 0% and +4% of optimum.
 6. For Sidewalks, the upper 12" of subgrade shall be compacted to a minimum of 95% of the maximum dry density (ASTM D-698, Standard Proctor) at a moisture content between 0% and +4% of optimum. Sidewalk subgrades shall extend at least 12" laterally beyond the edge of the new sidewalk.
 7. Imported Material, If Required, Shall be Free of Organic Matter and Debris, and shall be a cohesive or granular material with a Liquid Limit less than 40 and a Plasticity Index between 10 and 20. Imported material shall meet NDOT freeze/thaw durability and sulfate soundness requirements and have a maximum particle size of 1.5".
 8. Any excess material shall be disposed of off-site at a location determined by the contractor.
 9. The Contractor shall follow the recommendations of the Geotechnical Engineering Report regarding overexcavation and recompaction of moist soils in the building footprint and areas to be paved, correction of unsuitable foundation soils, and low volume change materials below the floor slab.

CARLSON WEST POVONDRA ARCHITECTS

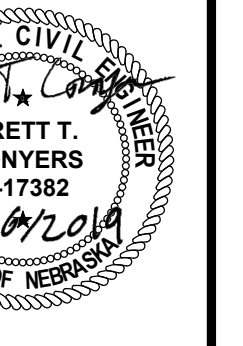

NO.	REVISION	SCHEDULE	DATE	BY	CHKD

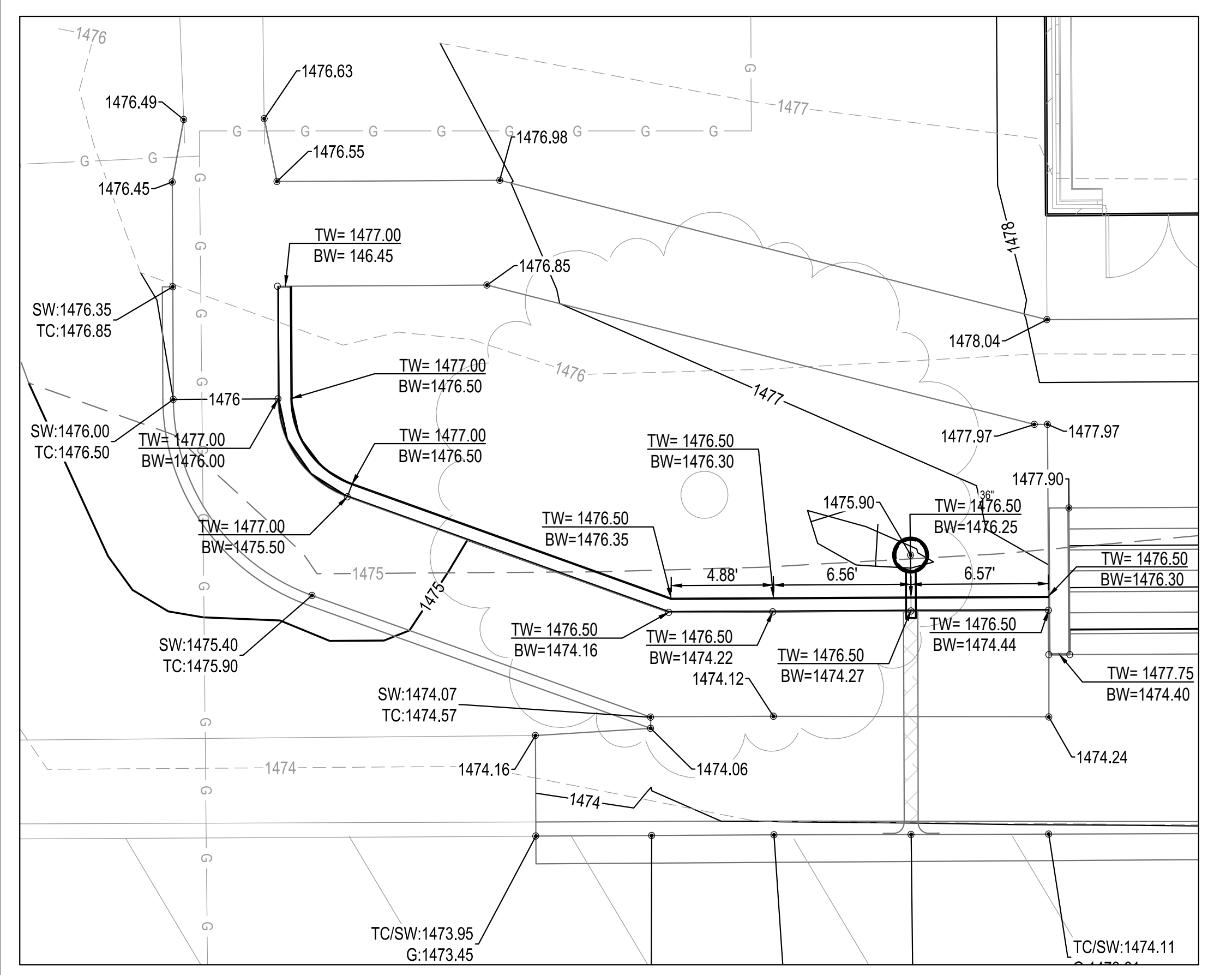

CURB WALL GRADING DETAIL
1" = 5'

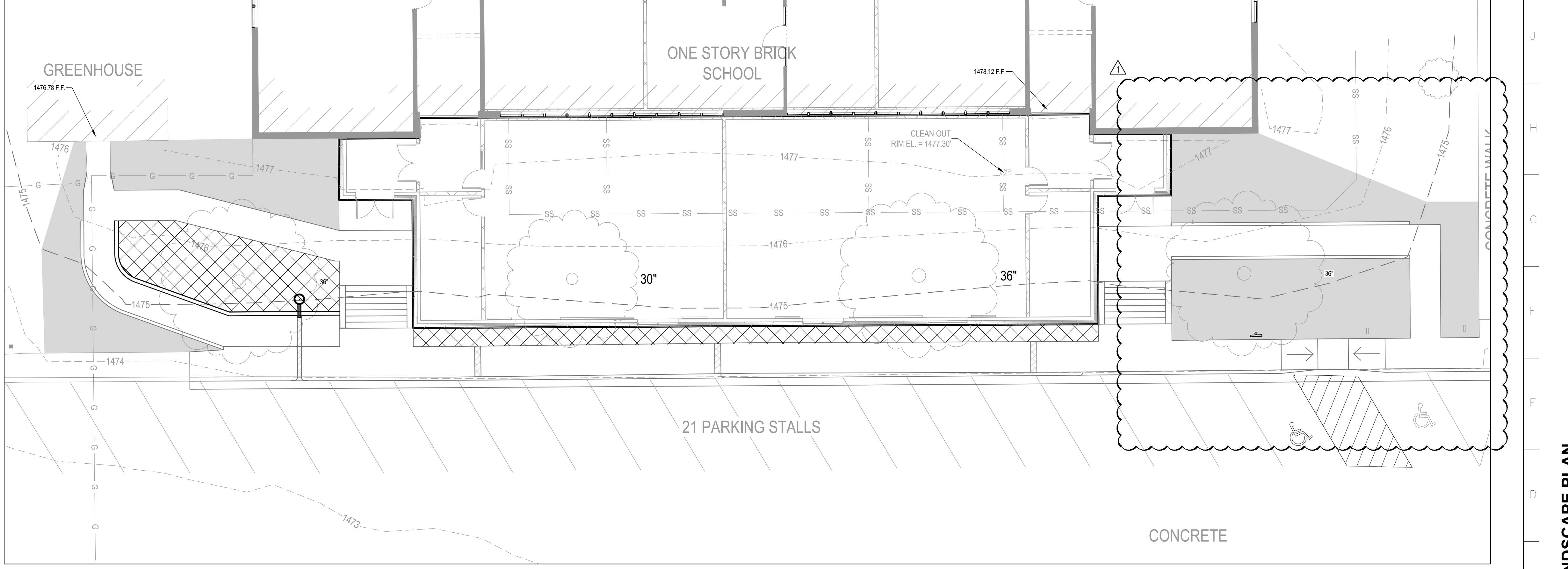

- LANDSCAPE NOTES:**
1. All disturbed areas shall receive sod or seeding and matting. To Be Determine by Owner
- LEGEND:**
- Sod or Seeding and Matting, Approximately 1800 SF
 - Landscaped by Owner

LANDSCAPE PLAN
1" = 10'

E & A CONSULTING GROUP, INC.
Engineering • Planning • Environmental & Field Services

E & A CONSULTING GROUP, INC.
Engineering • Planning • Environmental & Field Services

10909 Mill Valley Road, Suite 100 • Omaha, NE 68154
Phone: 402.895.4700 • Fax: 402.895.3599
www.eacg.com P2018.264.002

GRADING AND LANDSCAPE PLAN
MILFORD PUBLIC SCHOOLS
JR. - SR. HIGH SCHOOL ADDN. & RENOVATION
 301 'G' STREET, MILFORD, NE 68405

GENERAL SITE CONSTRUCTION NOTES - PHASE 2

- The City of Omaha Standard Specifications for Public Works Construction, 2014 Edition and any current revisions or amendments thereto and the Special Provisions for this Project shall apply and the Contractor shall perform in accord therewith.
- The Contractor shall check with the Owner for City approval of the project before starting work.
- Utilities are shown as a convenience for the Contractor. The locations of all aerial and underground utility facilities may not be indicated in these plans. Underground utilities, whether indicated or not, will be located and flagged by the utility companies at the Contractor's request. No excavation will be permitted in the area of the underground utilities until all facilities have been located and identified to the satisfaction of all parties and then only with extreme care to avoid any possibility of damages to the facilities.
- Erosion control improvements shall be constructed on this site, including silt fencing and a construction entrance. The Contractor shall be responsible for prompt reconstruction of any erosion control improvements disturbed by his operations. All disturbed erosion control improvements shall be fully reconstructed at the end of each working day prior to leaving the site. Separate payment will not be made for reconstruction of any erosion control improvements. Positive drainage in all work areas shall be maintained in the condition the construction site was in prior to Contractor arrival.
- The Portland Cement Concrete for the pavement slab shall be "L65", in accordance with the Standard Specifications.
- Portland Cement Concrete mix design for sidewalks shall be City of Omaha Type "L6" or "SG65" mix.
- Non-colored concrete pavement shall be cured using a white pigmented liquid membrane-forming curing compound that has been approved by the State of Nebraska Department of Roads. The minimum rate of application shall be 200 sq. ft. per gal. if a mechanical-powered sprayer is used and 100 sq. ft. per gal. if a hand powered sprayer is used.
- Water reducing admixtures shall be added to all hand-placed and finished concrete.
- A diamond edge saw blade shall be used for cutting all required contraction and longitudinal pavement joints.
- 5' sidewalk shall be jointed in 5'x5' panels. Contractor shall submit a jointing plan for approval for larger sidewalk areas.
- The 6 inch (Solid Wall) sanitary sewer pipe may be ABS (SDR 23.5), PVC (SDR 23.5), or VCP.
- Backfill soils in utility trenches, around foundations, basement walls, and retaining walls shall be compacted to a minimum of 95% of the maximum dry density (ASTM D-698, Standard Proctor) at a moisture content between 0% and +4% of the optimum. Lift thickness shall be appropriately matched to the type of compaction equipment used.
- The following storm sewer pipe materials may be used:
 - Reinforced Concrete Pipe (RCP), conforming to ASTM C76 (Class III unless otherwise indicated). Materials and installation shall conform to City of Omaha Standard Specifications.
 - PVC pipe with smooth interior and corrugated exterior, such as Contech A-2000, or equal. Pipe and fittings shall conform to ASTM F949. Installation shall conform to ASTM D 2321. Gasketed joints shall be used, and shall show no leakage when tested in accordance with ASTM D 3212.
 - PVC pipe, SDR -35, in accordance with ASTM D 3034. Installation shall conform to ASTM D 2321. Gasketed joints shall be used, and shall show no leakage when tested in accordance with ASTM D 3212.
 - Polyethylene pipe, with smooth interior and corrugated exterior, such as ADS N-12, Hancor HI-Q, or equal. Pipe and fittings shall conform to AASHTO M-252 and M-294. Installation shall conform to ASTM D 2321. Joints shall be made with split couplings, corrugated to engage the pipe corrugations, and shall engage a minimum of 2 corrugations on each side of the pipe joint. A neoprene gasket, per the manufacturer's recommendations, shall be used for all joints to ensure a soil-tight connection. Class IV soils shall not be used for bedding or backfill of N-12 pipe.
- 8" Yard Inlets shall be a Nyloplast Drain Basin with 8" Pedestrian Grate, or approved equal. Nyloplast basin size shall be determined by the manufacturer based on pipe alignment and diameter.
- Standard Plates are available from the City of Omaha Public Works Department, 1819 Farnam Street, Suite 600, Omaha, NE 68183, PH 402-444-5220. Plates may also be downloaded via the internet from the City of Omaha Web Site at: <http://www.cityofomaha.org/pw/index.php/contractors-consultants2/contractors-standard-plates-curb-ramp-and-specifications>

ITEMS	STANDARD PLATE	REVISION DATE
Concrete Pavement Joint Details	500-50	12/10/2013
Concrete Curb Details	500-52	12/10/2013
Misc. Concrete Pavement Details	500-60	12/10/2013
Concrete Curb Ramp Details	500-82	12/10/2013
Concrete Driveway Details	500-70	12/10/2013
Pipe Bedding w/Aggregate Detail	700-23	12/10/2013
Sewer Bedding Detail	700-01	12/10/2013
Reinforced Concrete Pipe Couplers	700-83	12/10/2013
Cast Iron Manhole Rings, Covers, Manhole Steps	700-90 (1 & 2)	12/10/2013
Manhole Detail	700-40	12/10/2013

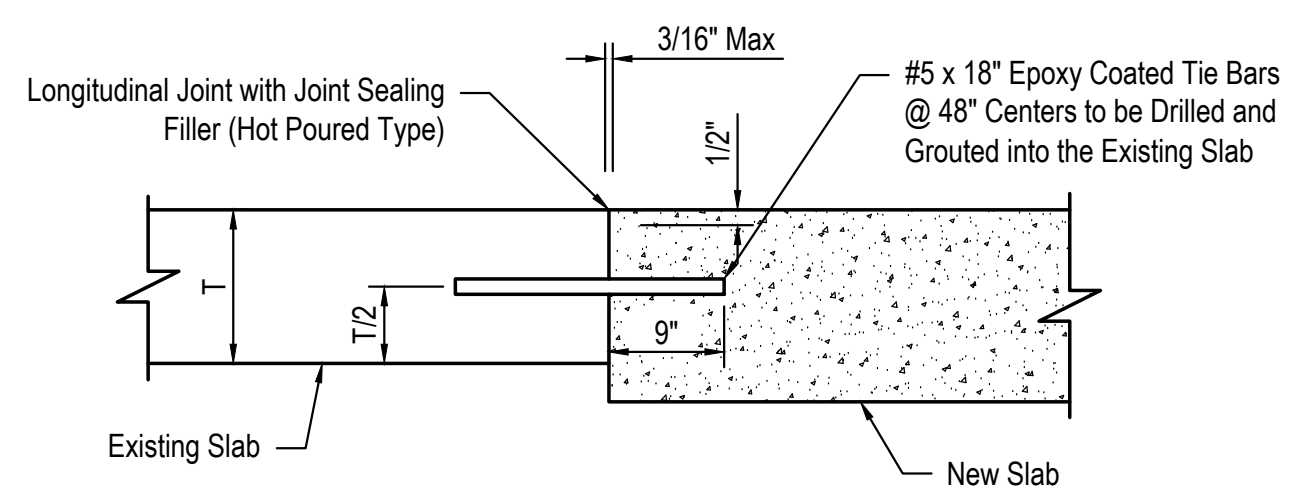

Tie Bars are to be Installed as Called Out in the Plans
TIE BAR DETAIL
NOT TO SCALE

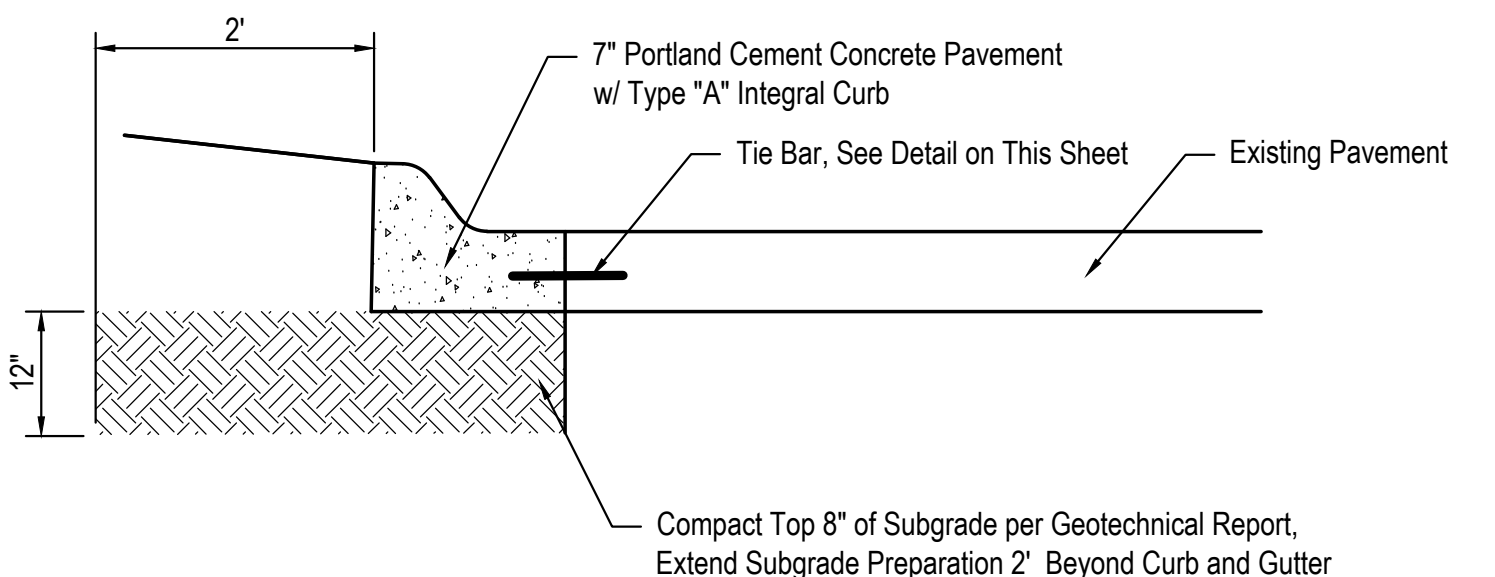

7" PORTLAND CEMENT PAVEMENT WITH INTEGRAL CURB SECTION
NOT TO SCALE

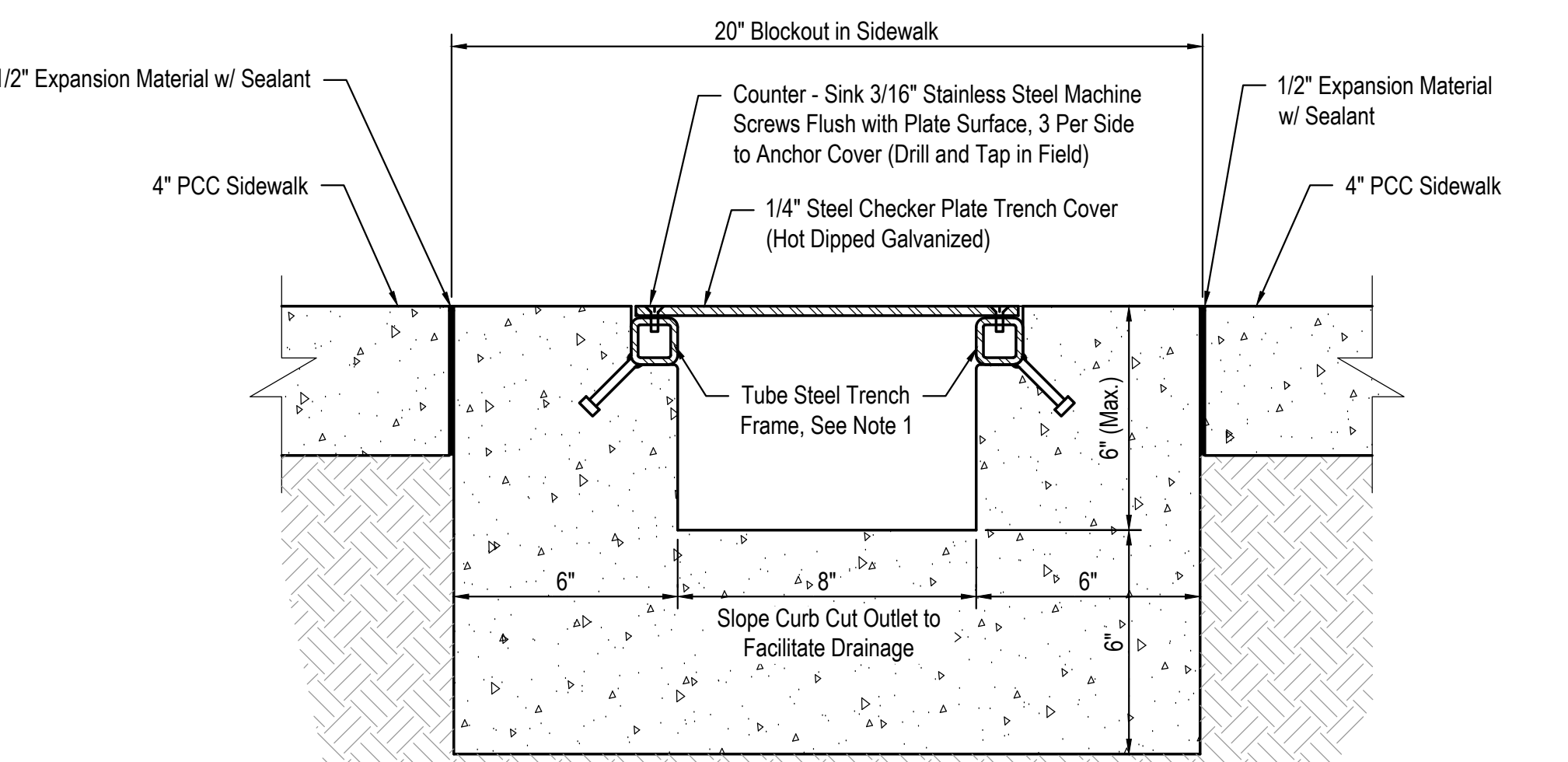
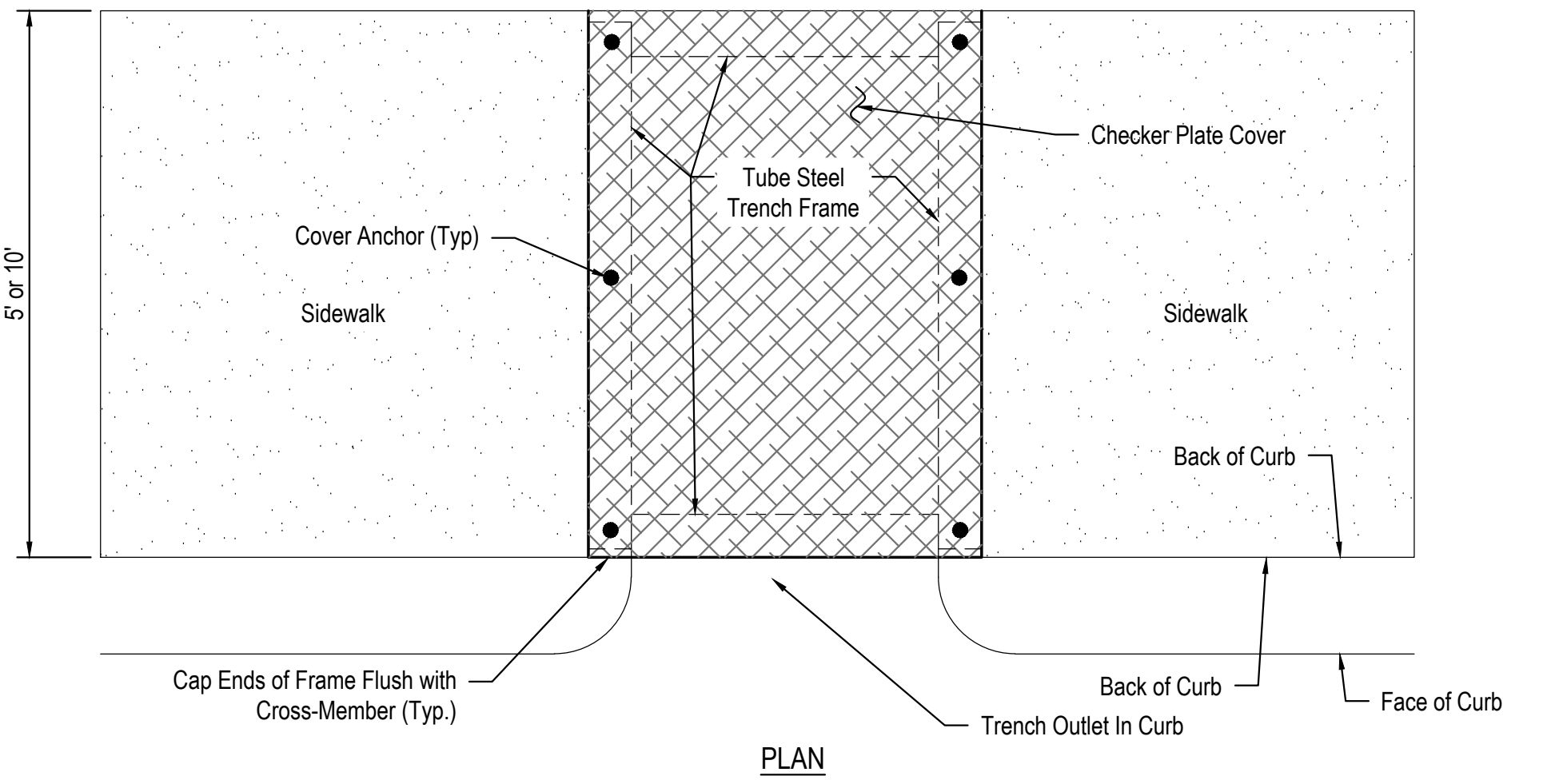

Note 1: Tube Steel Trench Frame Shall be a 1.25" x 1.25" Tube Steel Rectangular Frame With End Caps. Shop Weld 1/4" Headed Stud Anchors @ 18" O.C. as Shown
PCC TRENCH DRAIN WITH TUBE FRAME AND SOLID COVER
NOT TO SCALE

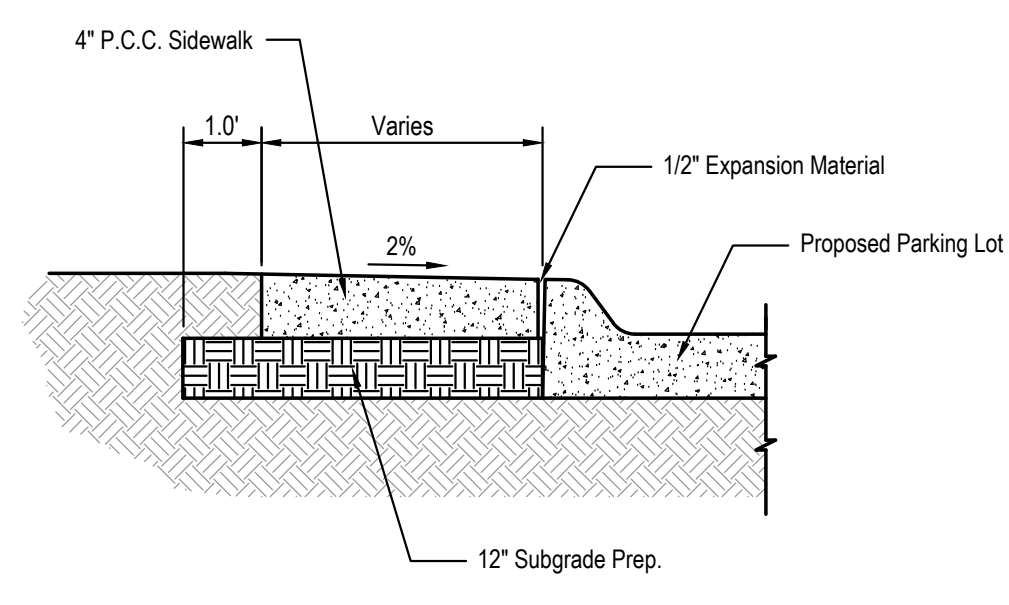

TYPICAL SIDEWALK SECTION
NOT TO SCALE

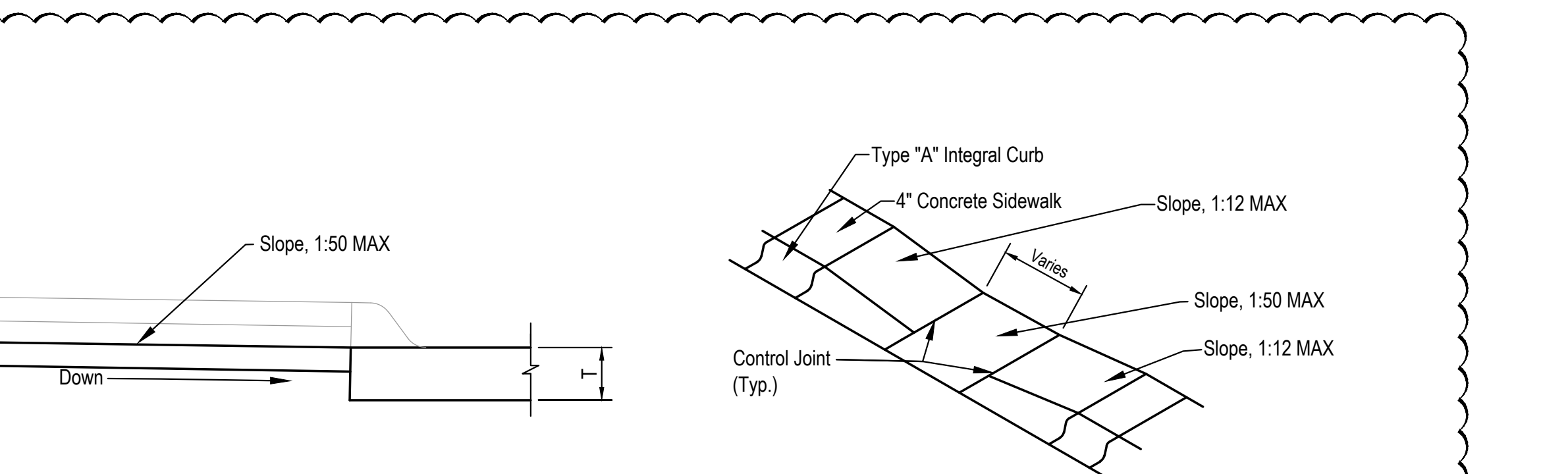

DEPRESSED HANDICAP RAMP DETAIL
NOT TO SCALE

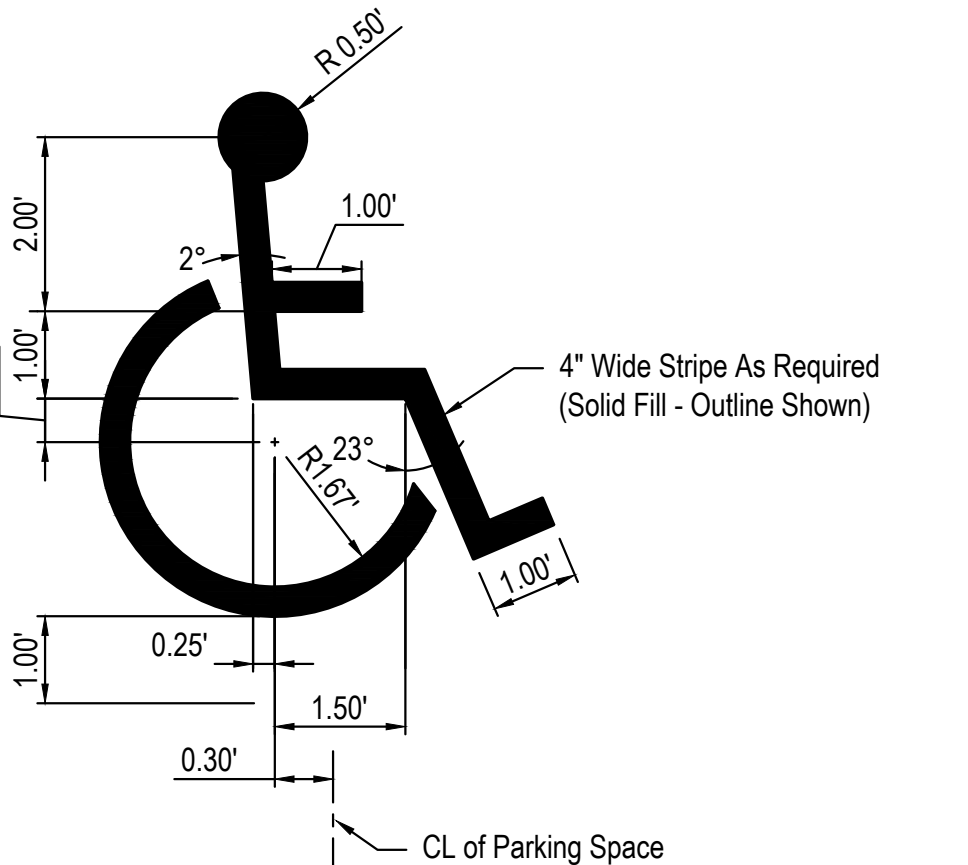

- NOTES
- Paint Color by Surface:
Pavement Surface: Concrete (Yellow), Bituminous (White)
Paint Color: Yellow, White
 - Paint shall Conform to Federal Specification: TT-P-115 (2 Coats)

HANDICAP PARKING LOT STENCIL DETAIL
NOT TO SCALE

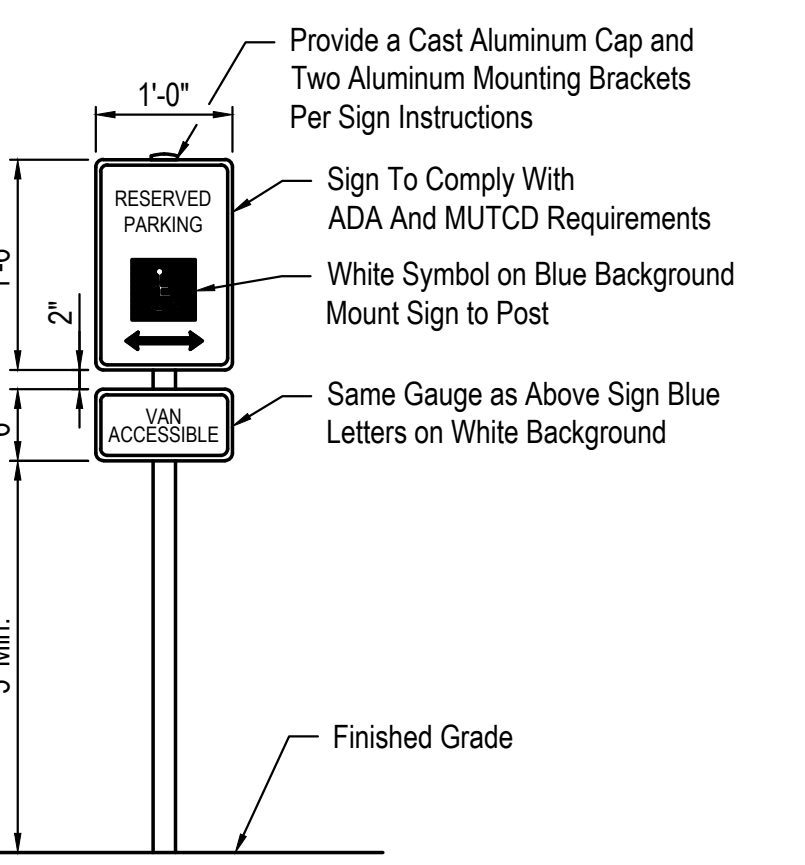

HANDICAP PARKING SIGN
NOT TO SCALE

REVISION	SCHEDULE	DATE	DESCRIPTION
1			

E & A CONSULTING GROUP, INC.
Engineering • Planning • Environmental & Field Services
10909 Mill Valley Road, Suite 100 • Omaha, NE 68154
Phone: 402.895.4700 • Fax: 402.895.3599
www.eacg.com P2018.264.002