



ADDENDUM #002

DATE: MAY 7, 2024

6912 NORTH 97TH CIRCLE, SUITE 1 • OMAHA, NEBRASKA 68122 • 402.391.3999
WEB: WWW.JACKSON-JACKSONASSOCIATES.COM • EMAIL: JACKSON-JACKSON@JJAARCHITECTS.COM

JACKSON
JACKSON
& ASSOCIATES, INC.

ELKHORN PUBLIC SCHOOLS
ELKHORN HIGH SCHOOL
AUDITORIUM RENOVATIONS
1401 VETERANS DRIVE; ELKHORN, NEBRASKA 68022

JJA PROJECT: 3626
DRAWINGS & SPECIFICATIONS
DATED: 04/15/2024

The Drawings and Specifications for the above referenced project are hereby amended and the following changes shall be made part of the Contract Documents.

Structural:

Item #1

Refer to Drawing S1.1 – Mezzanine Framing Plan.

- A. Change all reference of “5/16” CHECKERED PLATE (A36)” to “5/16” FLAT PLATE (A36)”.
- B. Add the following to all notes referencing “5/16” CHECKERED PLATE”:
 - a. OPTIONAL PLATE CONNECTION: PLATE MAY BE WELDED TO ALL SUPPORTING STEEL (BOTH SIDES) WITH 3/16” FLARE BEVEL GROOVE WELD (2@12) FROM UNDERSIDE AT INTERMEDIATE SUPPORTS AND 3/16” FILLET WELD (2@12) FROM ABOVE AT PERIMETER SUPPORTS.

Item #2

Refer to Drawing S2.2 & S2.3 – Framing Details.

- A. Change all reference of “5/16” CHECKERED PLATE (A36)” to “5/16” FLAT PLATE (A36)”.
- B. Add the following to all notes referencing “5/16” CHECKERED PLATE”:
 - a. OPTIONAL PLATE CONNECTION: PLATE MAY BE WELDED TO ALL SUPPORTING STEEL (BOTH SIDES) WITH 3/16” FLARE BEVEL GROOVE WELD (2@12) FROM UNDERSIDE AT INTERMEDIATE SUPPORTS AND 3/16” FILLET WELD (2@12) FROM ABOVE AT PERIMETER SUPPORTS.

Electrical:

Item #3

Refer to Drawing E3.5– Lighting Elevations and attached revised sheet.

- A. Modify graphic scales for clarification.

Item #4

Refer to Drawing E3.6– Lighting Elevations and attached revised sheet.

- A. Modify graphic scales for clarification.

Item #5

Refer to Drawing E6.0 – Electrical Schedules and attached revised sheet.

- A. ADD – Alternate manufacturers to luminaire schedule.
- B. Revise lighting control schedule for control tag N2.
- C. Revise luminaire schedule notes for clarification.

(End of Addendum #002)

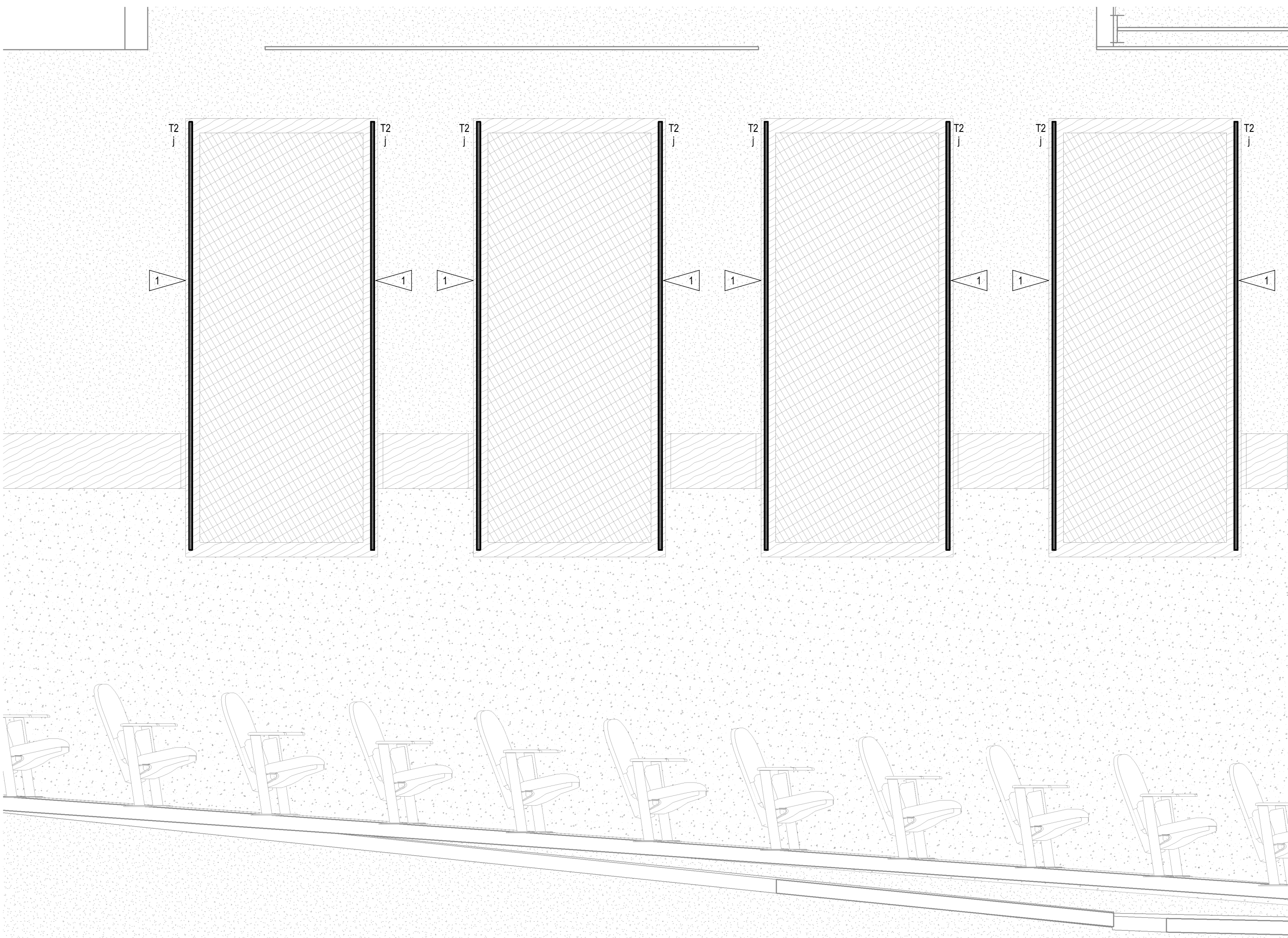

1 ELEVATION - ACOUSTIC PANELS - HOUSE LEFT
E3.5 1/2" = 1'-0" 1' 2' 4' 6' 8' 10'

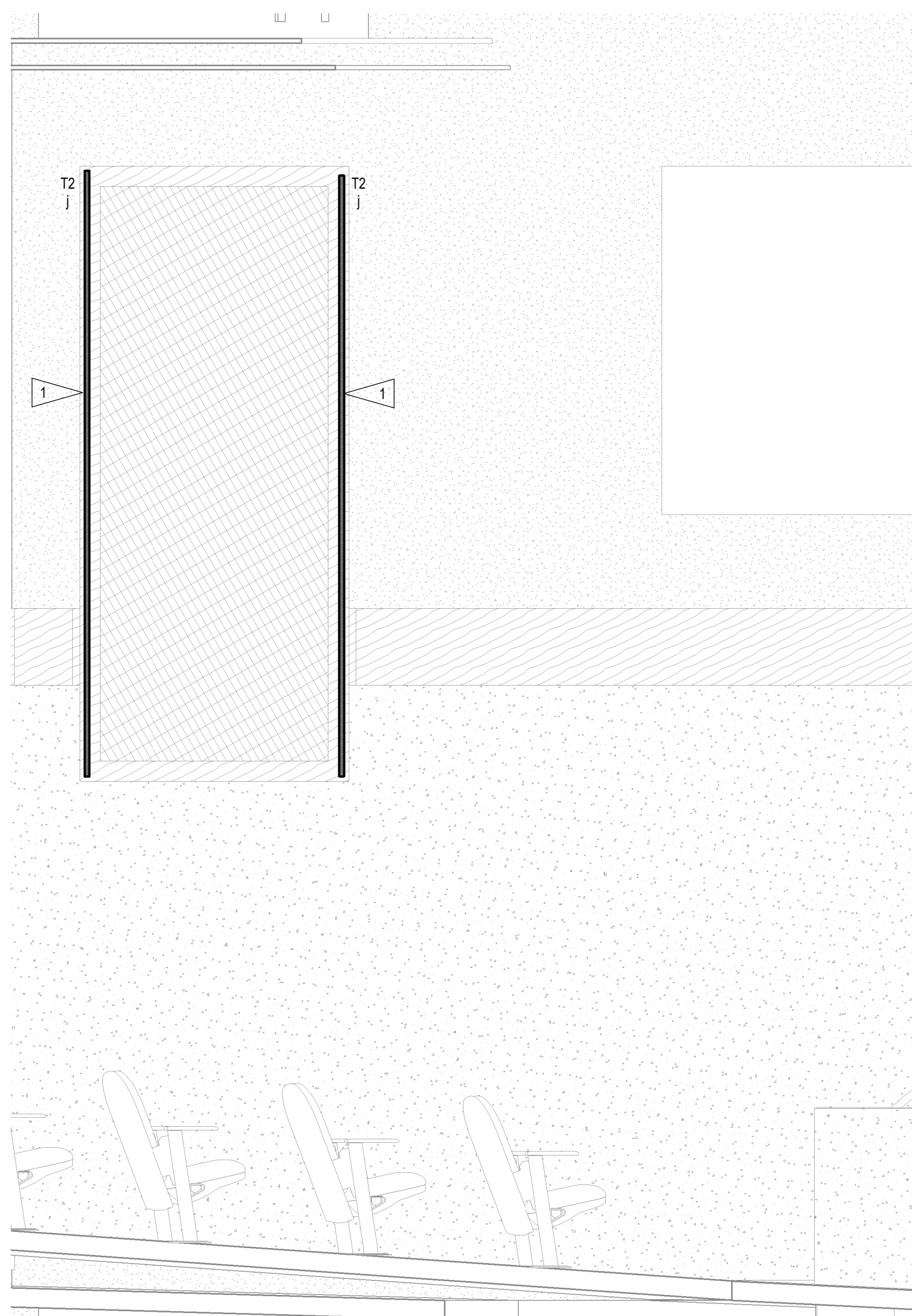

2 ELEVATION - ACOUSTIC PANELS - HL APRON
E3.5 1/2" = 1'-0" 1' 2' 4' 6' 8' 10'

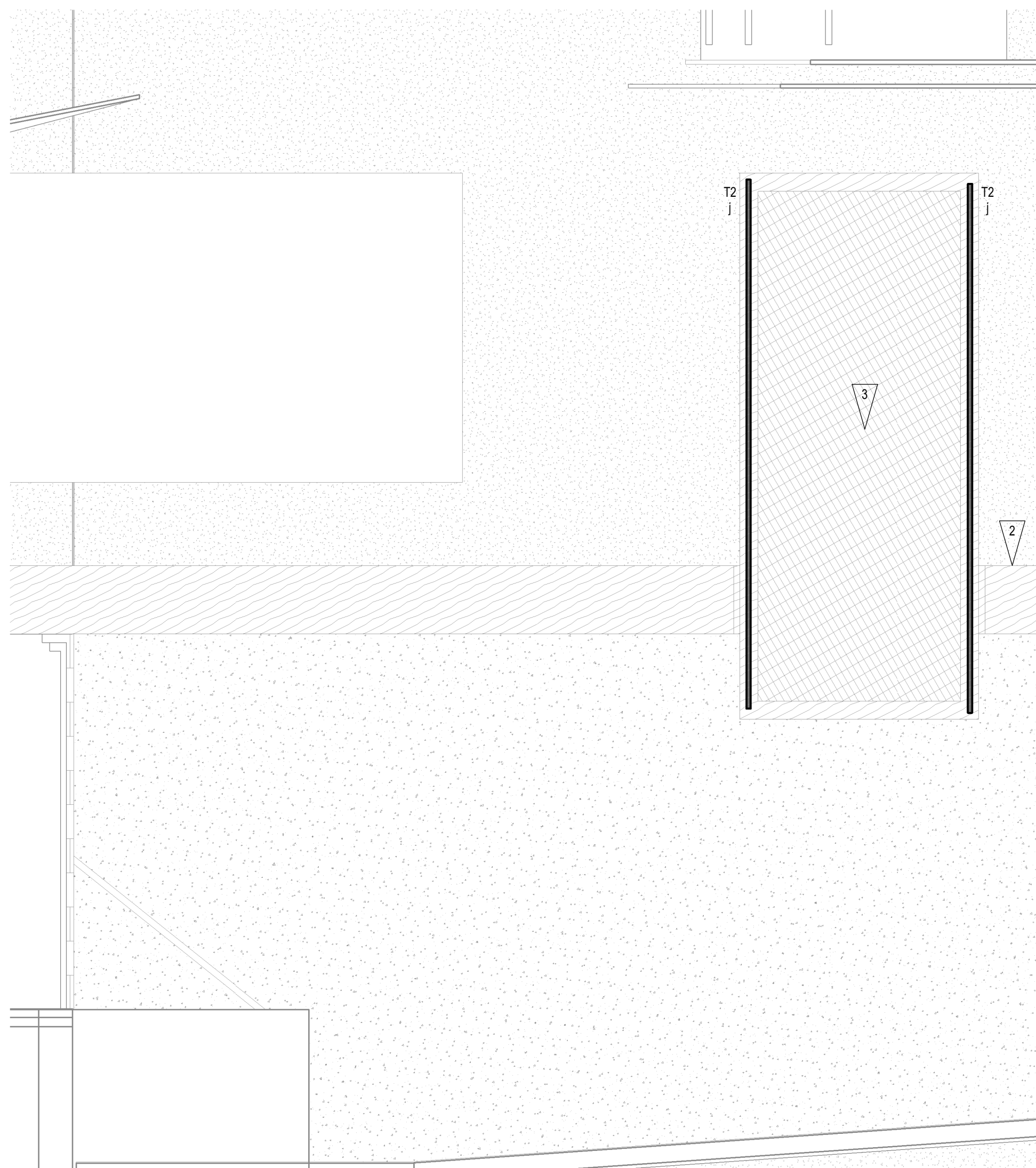

3 ELEVATION - ACOUSTIC PANELS - HR APRON
E3.5 1/2" = 1'-0" 1' 2' 4' 6' 8' 10'

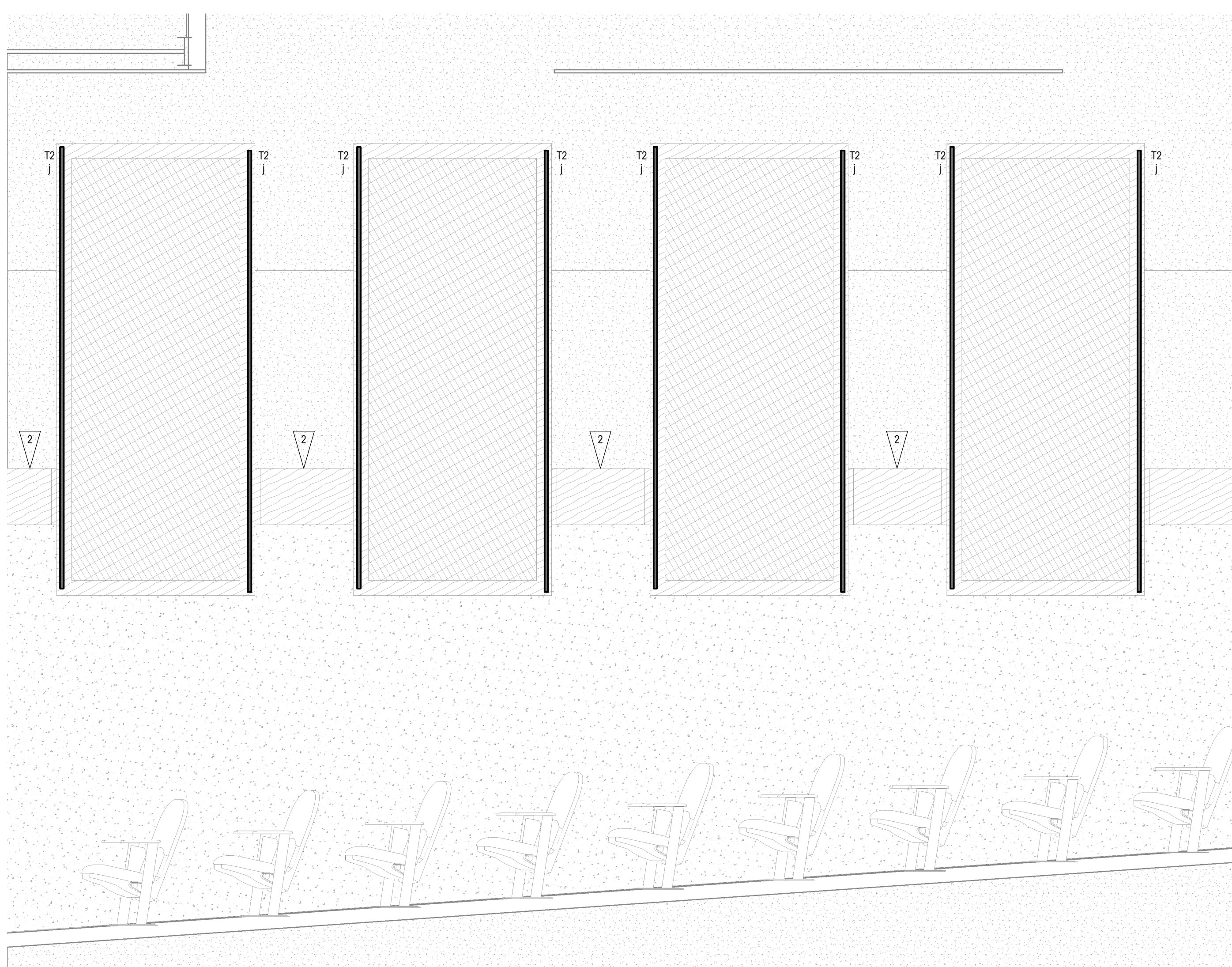

4 ELEVATION - ACOUSTIC PANELS - HOUSE RIGHT
E3.5 1/2" = 1'-0" 1' 2' 4' 6' 8' 10'

FLAG NOTES

- 1 DRIVERS SERVING TYPE T2 LUMINAIRES ON HOUSE LEFT SIDE SHALL BE LOCATED WITHIN EXISTING ELECTRICAL ROOM 122. WIRES BETWEEN DRIVER AND LUMINAIRE SHALL BE ROUTED WITHIN CEILING SPACE OF HALLWAY NORTH OF AUDITORIUM SPACE AND PENETRATE EXISTING WALL BEHIND ACOUSTIC PANELS. PENETRATION SHALL BE ACOUSTICALLY SEALED.
- 2 DRIVERS SERVING TYPE T2 LUMINAIRES ON HOUSE RIGHT SIDE SHALL BE LOCATED WITHIN STORAGE ROOM. WIRES BETWEEN DRIVER AND LUMINAIRE SHALL BE ROUTED WITHIN CHANNEL ON TOP OF BAND FEATURE CONNECTING ACOUSTIC PANELS ON THIS SIDE OF SPACE. WIRES SHALL PENETRATE WALL BEHIND PANEL INDICATED.
- 3 PENETRATE WALL BEHIND THIS PANEL TO ACCESS STORAGE SPACE. DRIVERS SHALL BE LOCATED WITHIN STORAGE SPACE. ACOUSTICALLY SEAL PENETRATION.

© COPYRIGHT 2024 20240680
Permission to reproduce all or part of this drawing is hereby granted solely for the limited purpose of construction of this project or archiving. Unauthorized copying, disclosure or construction use without written permission of Alvine Engineering is prohibited by copyright law.

NOTE:
DO NOT SCALE DRAWINGS. VERIFY ALL DIMENSIONS and clearances from ARCHITECTURAL, STRUCTURAL, shop and other appropriate drawing or at site. Lay out and coordinate all work prior to installation to provide clearances required for operation, maintenance, and codes and verify non-interference with other work. DO NOT FABRICATE PRIOR TO VERIFICATION OF CLEARANCE FOR ALL TRADES. READ SPECIFICATIONS.

LOW VOLTAGE SWITCH SCHEDULE					
SWITCH MARK	MINIMUM BUTTON QUANTITY	BUTTON ENGRAVED LABEL	ROOM ZONES CONTROLLED	FUNCTION	REMARKS
\$	3	ON/OFF RAISE LOWER	SEE PLANS	ON/OFF DIM UP DIM DOWN	
\$ 0	1	ON/OFF	SEE PLANS	ON/OFF	
\$ 2	5	ON/OFF FRONT BACK RAISE LOWER	e, f, g	ALL ON e f - 100% ON g - 100% ON DIM UP DIM DOWN	1, 2
\$ 3	4	ON OFF GENERAL PRE FUNCTION PRODUCTION	SEE PLANS	TBD	1, 3
\$ 4	3	WHITE LIGHT BLUE LIGHT RAISE LOWER	x, y	x - 100% ON y - 100% ON DIMM UP DIM DOWN	1

- GENERAL NOTES
- a. PROVIDE EACH LOW-VOLTAGE SWITCH WITH PRE-ENGRAVED FACTORY LABELED BUTTONS INDICATING FUNCTION. WHERE MULTIPLE SWITCHES ARE GROUPED IN A SINGLE LOCATION OR FACEPLATE, PROVIDE ENGRAVED FACEPLATE INDICATING ZONE OR SPACE CONTROLLED.
- b. EACH SPACE SHALL HAVE MINIMUM OF ONE ZONE OF CONTROL. WHERE MORE THAN ONE LIGHTING ZONE IS PRESENT, LOWERCASE LETTERING INDICATES SEPARATE LIGHTING ZONE WITHIN A ROOM.
- c. DIMMING CONTROLS ON SCENE CONTROLLERS SHALL BE CAPABLE OF CONTROLLING ALL ZONES WITHIN SPACE.
- d. VERIFY INTEGRAL WALL SWITCH OCCUPANCY SENSOR REQUIREMENTS WITH LIGHTING CONTROL SCHEDULE.
- REMARKS
1. ELECTRICAL CONTRACTOR SHALL INSTALL BUTTON STATION AND WIRING FURNISHED BY THEATRICAL VENDOR. BUTTON CONFIGURATION IS SHOWN FOR DESIGN INTENT. REFER TO THEATRICAL DRAWINGS FOR FINAL LOCATION AND BUTTON CONFIGURATION.
2. BUTTON STATION SHALL BECOME DEACTIVATED WHEN PARTITION IS OPEN.
3. BUTTON STATION SHALL CONTROL AUDITORIUM CLASS ROOM. CONTROL ZONES f AND g WHEN PARTITION IS OPEN. ZONE f AND g SHALL BE CONTROLLED WITH ZONE c.

LIGHTING CONTROL SCHEDULE														
MARK	OCCUPANCY SENSOR										SPACE TYPE	REMARKS		
	MOUNTING	MANUAL ON	AUTO ON	OCCUPANT DETECTION TIME-OUT	LOCAL ON/OFF	DIMMING	PARTITION SENSOR CONTROL	DAYLIGHT HARVESTING, WHERE INDICATED (TARGET FOOTCANDLES)	CONNECTED TO NETWORKED LIGHTING CONTROL SYSTEM	CONTROL INTERFACE FOR AV SYSTEM			EXTERIOR PHOTOCELL CONTROL	TIME OF DAY CONTROL
C2	NONE	-	-	-	-	-	X	-	-	X	-	-	VESTIBULE	1, 3
E1	NONE	-	-	-	-	X	X	-	-	-	-	-	MECH/ELEC	
E2	NONE	-	-	-	-	X	X	-	-	-	-	-	STORAGE ROOM	
N1	NONE	X	-	-	-	X	X	-	-	X	-	-	AUDITORIUM	
N2	CEILING	X	-	15	X	X	X	-	-	X	-	-	CONTROL ROOM	1, 2
N3	NONE	-	-	-	-	X	X	-	-	-	-	-	CATWALK	
N4	NONE	X	-	-	-	X	X	-	-	X	-	-	STAGE	1
N5	CEILING	X	-	15	X	X	X	-	-	X	-	-	AUDITORIUM CLASSROOM	1, 2

- GENERAL NOTES
- a. SEE LOW VOLTAGE SWITCH SCHEDULE FOR SWITCH/CONTROL REQUIREMENTS.
- b. LIGHTING CONTROL DEVICES (WITH THE EXCEPTION OF SWITCHES) ARE NOT INDICATED ON LIGHTING PLANS. LIGHTING CONTROL SCHEDULE INDICATES CONTROL INTENT. PROVIDE SENSORS AND RELATED EQUIPMENT AS REQUIRED FOR COMPLETE COVERAGE AND CONTROL. SCHEMES, SUBMIT SHOP DRAWINGS INDICATING DEVICE LAYOUT AND CIRCUITING. SEE SPECIFICATIONS.
- c. EMERGENCY LUMINAIRES IDENTIFIED AS NIGHT LIGHTING (NL) SHALL BE CONNECTED UNSWITCHED TO THE INDICATED EMERGENCY POWER CIRCUIT.
- d. EMERGENCY LIGHTING CONTROL:
1. UNLESS INDICATED AS A NIGHTLIGHT (NL), EMERGENCY LIGHTING SHALL:
- BE PROVIDED WITH AN EMERGENCY RELAY FOR EACH LIGHTING CONTROL ZONE. RELAY SHALL BE COMPATIBLE WITH DIMMING CONTROLS SPECIFIED FOR EACH SPACE.
 - BE CONTROLLED WITH THE NORMAL LUMINAIRES OF THE SAME ZONE WHEN NORMAL POWER IS PRESENT.
2. PROVIDE A UL100 RELAY (BRANCH CIRCUIT EMERGENCY LIGHTING TRANSFER SWITCH) WHERE INDICATED ON THE PLANS FOR LUMINAIRES ON EMERGENCY POWER.
3. PROVIDE A UL924 RELAY (AUTOMATIC LOAD CONTROL RELAY) FOR REMAINING APPLICATIONS.

- REMARKS
1. CONTROL TYPE SHOWN FOR DESIGN INTENT AND INTEGRATION INTO BUILDING CONTROL SYSTEM. CONTROLS FURNISHED BY THEATRICAL LIGHTING VENDOR.
2. AUDITORIUM CLASSROOM SHALL BE CONTROLLED WITH AUDITORIUM WHEN PARTITION IS OPEN.
3. DURING NORMAL OPERATION LIGHTING SHALL BE CONTROLLED BY OCCUPANCY SENSOR. ZONE b SHALL BE NORMALLY OFF. DURING PERFORMANCES AND PREFUNCTION LIGHTING ZONE a SHALL BE CONTROLLED BY THEATRICAL LIGHTING CONTROL SYSTEM. WHEN LIGHTING ZONE a IS OFF LIGHTING ZONE b SHALL BE ON TO PROVIDE EGRESS LIGHTING.

PANEL EXIST. D3												
120/208V 3 PHASE 4 WIRE WITH GROUND BAR					SURFACE MOUNTED							
225 AMP MCB												
EXIST AMP S AVAILABLE FAULT												
42 POLES ONE SECTION					SOURCE EXIST. T-D3 LOCATION EX. ELEC.-1 A214-1							
DESCRIPTION	REMARKS	AMPS	POLES	CKT #	A	B	C	CKT #	POLES	AMPS	REMARKS	DESCRIPTION
EXIST LOAD	E	20	1	1	0	0		2	1	20	E	REC-BOYS DRESS RM
EXIST LOAD	E	20	1	3		0	0	4	1	20	E	REC-BAND RM OFFICE
EXIST LOAD	E	20	1	5			0	6	1	20	E	REC-BAND RM PRINTER
STAGE LIGHT PROPACK 5&6	E	100	3	7	0	0		8	1	20	E	REC-BAND RM OFFICE
--	--	--	--	9		0	0	10	1	20	E	EXIST. LOAD
--	--	--	--	11			0	12	1	20	E	EXIST. LOAD
STAGE LIGHT PROPACK 4	E	100	3	13	0	0		14	1	20	E	EXIST. LOAD
--	--	--	--	15		0	0	16	1	20	E	EXIST. LOAD
--	--	--	--	17			0	18	1	20	E	EXIST. LOAD
EXIST. FLOOR SANDER	E	25	2	19	0	720		20	1	20	NB,NL	REC-UPPER CONTROL BOOTH
--	--	--	--	21		0	600	22	1	20	NB,NL	REC-STG RIGHT FOLLOW SPOT
REC-STG RIGHT NEW CATWLK	NB,NL	20	1	23			180	24	1	20	NB,NL	REC-BOH PROJECTOR
REC-STG LEFT CATWLK	NB,NL	20	1	25	360	360		26	1	20	NB,NL	REC-STG LEFT CATWLK
REC-STG LEFT FOLLOW SPOT	NB,NL	20	1	27		600	720	28	1	20	NB,NL	REC-EXIST CATWLK
REC-NEW FOH PROJECTOR	NB,NL	20	1	29			180	30	1	20	NB,NL	SCENE SHP MTR DR
				31	0			32	1	20	NB	SPARE
				33		0		34	1	20	NB	SPARE
				35			0	36	1	20	NB	SPARE
				37				38				
				39				40				
				41				42				
FEED THRU LOAD TOTAL: 0												
REMARKS:												

LUMINAIRE SCHEDULE													
MARK	DESCRIPTION	MANUFACTURER	CATALOG NO.	SOURCE DATA			DIMMING PROTOCOL	COLOR TEMP (K)	VOLTAGE	MOUNTING	FINISH	ALTERNATE MANUFACTURER	REMARKS
				LUMENS	LOAD (VA)	PER FOOT							
D1	8" DIAMETER REMODEL DOWNLIGHT	COOPER	LDR188-20-DE010, ER88-1020-8030, 8LB-W-1-H	2000	21		0-10V, 0%	3000	277 V	RECESSED	ALUMINIUM	GOTHAM EV08R	6, 2
D2A	4" DIAMETER DOWNLIGHT	COOPER	LDR1TC-25-90-30-DE010-W-1-H	2500	33		0-10V, 0%	3000	277 V	RECESSED, GRID	ALUMINIUM	GOTHAM EV04	6
D2B	4" DIAMETER DOWNLIGHT	COOPER	LDR1TC-25-90-30-DE010-W-1-H	2500	33		0-10V, 0%	3000	277 V	RECESSED, GYP	ALUMINIUM	GOTHAM EV04	6
KA4	4" LED STRIPLIGHT	METALUX	4SNX-48SL-LW-UNV-L830-LH-1-B K-U-SCA	4500	32		0-10V, 0%	3000	277 V	PENDANT	BLACK	LITHONIA, LUMENFOCUS	6
KB4	4" BLUE LED LENSED EXTRUSION, SUSPENDED	QTL	VERS-07-SK-SC-6.0-B-DRY-DF-N/A-S2-BW-CLS-SV-AWM-SK-BK-48	264	20		0-10V, 0%	BLUE	277 V	PENDANT	BLACK	LLI	6
KC4	4" LED STRIPLIGHT	METALUX	4SNX-22SL-LW-UNV-L830-LH-1-B LK-U-AYC-CHAIN/SET-U-DECOE-NDRND-FF	2100	14		0-10V, 0%	3000	277 V	PENDANT	BLACK	LITHONIA, LUMENFOCUS	6
L16	CONTINUOUS, SEAMLESS TAPELIGHT IN RECESSED LENSED EXTRUSION	ACOLYTE	CHSC4-M-SV; RB-0-SWS220-3.0-30-X-16"	300	3	X	0-10V, 0%	3000	277 V	RECESSED	TBD	LLI, PURE EDGE, KOZUS	2, 5, 6
L32	CONTINUOUS, SEAMLESS TAPELIGHT IN RECESSED LENS EXTRUSION	ACOLYTE	CHSC4-M-SV; RB-0-SWS220-3.0-30-X-32"	300	3	X	0-10V, 0%	3000	277 V	RECESSED	TBD	LLI, PURE EDGE, KOZUS	2, 5, 6
P1	6" DIAMETER CYLINDER, 55 DEGREE OPTIC, REMOTE DRIVER	ALW	CRP6-60-90-30-55-HL-R-ELDV0-T-B-BK-AC	6000	58		0-10V, 0%	3000	277 V	PENDANT	BLACK	GOTHAM EV08PC	6
P2	6" DIAMETER CYLINDER, 80 DEGREE OPTIC, HEXCELL LOUVER	ALW	CRP6-35-90-30-80-HL-N-ELDV0-T-B-BK-AC	3500	30		0-10V, 0%	3000	277 V	PENDANT	BLACK	GOTHAM EV08PC	6
SA4	4" LED STRIPLIGHT	METALUX	4SNX-48SL-LW-UNV-L830-LH-1-B LK-U	0	0		0-10V, 0%	3000	277 V	SURFACE	BLACK	LITHONIA	6
S84	4" BLUE LED LENSED EXTRUSION, SURFACE	QTL	VERS-01-SC-5.0-B-DRY-DF-SX-B W-CLS-BK-CL2-CC-BK-48"E	264	20		0-10V, 0%	BLUE	277 V	SURFACE	BLACK	LLI	6
T1	AISLE EDGE LIGHTING, 6" SPACING	TIVOLI	SATT-xx-30-06-C-x	0	0	X	0-10V, 0%	3000	277 V	SURFACE, FLOOR	BLACK	TEMPO THEATRE	2, 4, 5, 6
T2	LED TAPE IN LENSED EXTRUSION	QTL	VERS-02-SW-5.0-30-DRY-DF-N/A-P1-BW-BW-BK-CL2-CC-BK-10FT5-IN-O	392	5	X	0-10V, 0%	3000	277 V	SURFACE	BLACK	LLI, KLUS	1, 2, 5, 6
T3	STAIR EDGE LIGHTING, 6" SPACING	TIVOLI	ST-30-30-C-C-X-X-X	4	0	X	0-10V, 0%	3000	277 V	SURFACE, FLOOR	BLACK	TEMPO THEATRE	2, 4, 5, 6
W1	"QUIET PLEASE AUDITORIUM IN USE" EDGE LIT LED SIGN	TITUS TECHNICAL LABS	HPL-x-RED-HMW	0	5		-	-	277 V	SURFACE, WALL	ALUMINIUM	ISOLITE, EXITRONIX	3
WA4	4" LED STRIPLIGHT, WALL MOUNTED	METALUX	4SNX-48SL-LW-UNV-L830-LH-1-B K-U	4500	32		0-10V, 0%	3000	277 V	SURFACE, WALL	BLACK	LITHONIA, LUMENFOCUS	6, 2
WB2	2" BLUE LED LENSED EXTRUSION, WALL MOUNTED	QTL	VERS-01-SC-5.0-B-DK-CL2-CC-B K-24"E	132	10		0-10V, 0%	BLUE	277 V	SURFACE, WALL	BLACK	LLI	6
WB4	4" BLUE LED LENSED EXTRUSION, WALL MOUNTED	QTL	VERS-01-SC-5.0-B-DK-CL2-CC-B K-48"E	264	20		0-10V, 0%	BLUE	277 V	SURFACE, WALL	BLACK	LLI	6
X1	DIE CAST ALUMINUM SINGLE FACE EXIT SIGN, RED LETTERING	SURE-LITES	CX-6-1-R	0	2		-	-	277 V	SURFACE, WALL	ALUMINIUM	LITHONIA LE, EXITRONIX	1
X2	DIE CAST ALUMINUM SINGLE FACE EXIT SIGN, RED LETTERING, BLACK FINISH	SURE-LITES	CX-6-1-BK-R	0	2		-	-	277 V	SURFACE, WALL	BLACK	LITHONIA LE, EXITRONIX	1

- GENERAL NOTES
- a. SEE SPECIFICATIONS FOR ADDITIONAL REQUIREMENTS.
- b. CONTRACTOR TO VERIFY LUMINAIRE CATALOG NUMBER AND INSTALLATION REQUIREMENTS PRIOR TO ORDERING.
- c. LUMINAIRE NUMBERS INDICATED WITH LETTER "E" SHALL BE PROVIDED WITH AN EMERGENCY BATTERY PACK.
- d. LISTED ALTERNATE MANUFACTURERS ARE PERMITTED TO BID AN EQUIVALENT LUMINAIRE WHICH COMPLIES WITH THE PRODUCT REQUIREMENTS IDENTIFIED IN THIS SCHEDULE AND THE SPECIFICATIONS WITHOUT SUBMITTING A PRIOR APPROVAL REQUEST. ALTERNATE LUMINAIRES WILL BE REVIEWED DURING THE SUBMITTAL PROCESS AND THE MANUFACTURER WILL BE RESPONSIBLE TO PROVIDE A LUMINAIRE WHICH MEETS THE PRODUCT REQUIREMENTS.
- e. ELECTRICAL CONTRACTOR SHALL PROVIDE THE SPECIFIED LUMINAIRES DEFINED WITHIN THIS SCHEDULE AND ASSOCIATED CONTRACT DOCUMENTS. IF REQUIRED, THE ELECTRICAL CONTRACTOR MAY UTILIZE MULTIPLE DISTRIBUTORS AND/OR DISTRIBUTORS MAY UTILIZE MULTIPLE LIGHTING MANUFACTURER REPRESENTATIVES TO COMPLY WITH THE CONTRACT DOCUMENTS FOR THIS PROJECT.

- REMARKS
1. PROVIDE MULTIPLE FIXTURES END TO END TO CREATE A CONTINUOUS FIXTURE AS SHOWN ON PLANS.
2. PROVIDE ALL DRIVERS, LEADER CABLES, JUMPER CABLES, MOUNTING ACCESSORIES, AND ALL OTHER APPURTENANCES AS REQUIRED FOR A COMPLETE AND FUNCTIONAL INSTALLATION.
3. CUSTOM LETTERING SHALL BE "QUIET PLEASE AUDITORIUM IN USE". PROVIDE A SHOP DRAWING INDICATING LETTERING SIZE AND FONT FOR REVIEW.
4. COORDINATE FINAL PROFILE WITH FLOORING TO BE INSTALLED.
5. PROVIDE CONTINUOUS LIGHTING AS SHOWN ON PLANS.

TRANSFORMER SCHEDULE						
TRANSFORMER	VOLTAGE	KVA RATING	MOUNTING	CONDUCTORS		REMARKS
				PRIMARY	SECONDARY	
T-D	480V DELTA 208Y/120V	75	WALL	3-#1, #6 GND, 1 1/2"	4-#4/0, #2 GND, 2 1/2"	#2 3/4"
						1

- GENERAL NOTES
- a. THE CONTRACTOR SHALL VERIFY THE SIZE OF EQUIPMENT SUPPLYING DOES NOT EXCEED THE AVAILABLE MOUNTING SPACE.

- REMARKS
1. TRANSFORMER SHALL BE ONE-FOR-ONE REPLACEMENT OF EXISTING TRANSFORMER. CONFIRM EXISTING WIRE SIZE MEETS OR EXCEEDS VALUES INDICATED WITHIN THIS SCHEDULE. CONTRACTOR SHALL FIELD VERIFY ALL REQUIREMENTS PRIOR TO SUBMITTAL.

PANEL EXIST. D2												
120/208V 3 PHASE 4 WIRE WITH GROUND BAR					SURFACE MOUNTED							
125 AMP MCB												
EXIST AMP AVAIL FAULT												
42 POLES ONE SECTION												
					SOURCE LOCATION EX. ELEC.-1 A214-1							
DESCRIPTION	REMARKS	AMPS	POLES	CKT #	A	B	C	CKT #	POLES	AMPS	REMARKS	DESCRIPTION
REC-RM A229/A227	E	20	1	1	0	0		2	1	20	E	REC-A219 S WALL
REC-RM A228/A227	E	20	1	3		0	0	4	1	20	E	REC-A219 W WALL (SHOP)
MUSIC RM DRINK FOUNTAIN	E	20	1	5			0	6	1	20	E	A218 UNIT HEATERS
REC-A230,232,231,233,234,235	E	20	1	7	0	0		8	1	20	E	REC-A220
LGT-A231	E	20	1	9		0	2500	10	1	20	E,NL	CNTRL RM PLUG MOLD
EF-11	E	20	1	11			0	12	1	20	E,NL	REC-EX CNTRL ROOM
REC-WEST MAIN ENTRY	E	20	1	13	0	0		14	1	20	E	REC-A222,224,221
MAIN ENTRY HANDICAP DR	E	20	1	15		0	0	16	1	20	E	REC-A223,A226
EX. CNTRL RM MTR DOOR	E,NL	20	1	17			0	18	1	20	E	REC-A219 E WALL
REC-FRON HALLW...	E	20	1	19	0	700		20	1	20	E,NL	OBSERV DECK MTR DOOR
HVAC CNTRL PANEL	E	20	1	21		0	0	22	1	20	E	LGT-A225
OBSERV DECK PLUG MOLD	E	20	1	23			2680	24	1	20	E	LECTURE HALL SEAT LIGHTS
REC-CONCESSION E COUNTER	E	20	1	25	0	0		26	1	20	E	CONTROL BOOTH FOLLOW SPOT
REC-CONCESSION REFRIG	E	20	1	27		0	0	28	1	20	E	REC-CONTROL BOOTH
REC-CONCESSION SODA	E	20	1	29			0	30	1	20	E	CONTROL BOOTH...
REC-CONCESSION ICE MACH	E	20	1	31	0	0		32	1	20	E	REC-LECTURE HALL
REC-CONCESSION POPCORN	E	20	1	33			0	34	1	20	E	CNTRL BOOTH PA SYSTEM
REC-CONCESSION SE COUNTER	E	20	1	35			0	36	1	20	E	REC-RM A204
REC-NE ROOM	E	20	1	37	0	0		38	1	20	E	REC-CONC WINDOW CAFETERIA
REC-POOD STORAGE	E	20	1	39		0	0	40	1	20	E	REC-RM A207
COOLER LIGHTS	E	20	1	41			0	42	1	20	E	REC-CONC POPCORN MACHINE
FEED THRU FEED TOTAL: 0												
REMARKS:												