

## ADDENDUM NO. 11

### MISSOURI VALLEY FIRE STATION ADDITION MISSOURI VALLEY, IOWA

**DATE OF ADDENDUM ISSUE:** April 19, 2024  
**DATE OF BID OPENING:** April 23<sup>th</sup>, 2024  
**PROJECT NO.:** 232908

NOTE TO ALL PLAN HOLDERS: Please insert this Addendum into your copy of the contract documents for the above-named project. The following changes to the contract documents are issued by the Architect/Engineer, shall be attached and made a part of the plans and specifications, shall be acknowledged with the bidder's proposal and shall have the same force and effect as though a part of the original issue. All other stipulations and requirements of the plans and specifications remain in effect.

### UPDATE TO THE DRAWINGS

#### ROOF PLAN A1.2:

- Water-diverting cricket shown on the high slope side of the Make-up Air Unit on the roof top together w/ general note calling for similar crickets for any other major equipment on the roof. Cricket to be provided by roof manufacturer to fit with standing seam metal roof assembly.

#### ELECTRICAL SITE PLAN, POWER & SYSTEMS PLAN E2.1:

- 1) Change keynote # 6 to read "PROVIDE EXCEL HAND DRYER #XL-SP (RED BARON) AND INSTALL AT +44" AFF TO BOTTOM. SEE TOILET ELEVATIONS ON SHEET A3.1 FOR MORE INFORMATION."

Note: Excel Hand Dryer Manufacturer recommends "Allied Hand Dryer" one of their best distributors for this product, but also offered thru Amazon and ProDryers.

ELECTRICAL KEYED NOTES	
1	INSTALL NEW RECEPTACLE AND FACEPLATE, RECONNECT TO EXISTING CIRCUIT. PROVIDE EXTENSION AND PLASTER RING WHERE WALL IS BEING FURRED OUT.
2	PROVIDE NEW 35/3 CIRCUIT BREAKER FOR EXISTING SIEMENS TYPE 'S1' PANEL. CONNECT TO <u>ENH-1</u> WITH 3-#8, 1-#10 GND, 3/4"C.
3	CONNECT TO SPARE 20/1 CIRCUIT BREAKER IN EXISTING SIEMENS TYPE 'S1' PANEL WITH 2-#12, 1-#12 GND, 1/2"C. IF NECESSARY, REMOVE CIRCUITS FEEDING THE CARDIO ROOM WHICH ARE NOT LONGER NECESSARY. PROVIDE NEW TYPED SCHEDULE FOR THIS PANEL.
4	RELOCATE EXISTING SECURITY PANEL TO NEW FURRED WALL.
5	UNDER ALTERNATE BID #1, REPLACE RECEPTACLES AND FACEPLATES AND CONNECT TO EXISTING CIRCUIT. DO NOT PROVIDE HAND DRYERS UNDER ALTERNATE BID #1.
6	PROVIDE XLERATOR #XL-S1, COLOR TO MATCH BRADLEY TOILET PARTITION, CARNIVAL RED 2145.
7	CONNECT TO 20/1 CIRCUIT BREAKER IN EXISTING PANEL THAT WAS MADE SPARE BY DEMOLITION.

## **MISCELLANEOUS CLARIFICATIONS**

- "WRB" refers to weather barrier as per section 072500 "Weather Barriers" of the specifications. This is to be laid on the exterior wall sheathing facing outward/exterior.
- On sheet A3.1, "Enlarged Floor Plans, Room Finish Schedule and Color & Materials Schedule, Interior Casework and Elevations", under toilet accessories schedule, item TA-7, the electric hand dryer product basis of design is listed. Also attached is its product cutsheet.

Attachments:

Sheet A1.2 Roof Plan (30" x 42" full size sheet)  
PDF Cutsheet Excel Hand Dryer

***Please acknowledge receipt of this Addendum #11 on your bid form.***

Respectfully Submitted,  
**PROCHASKA & ASSOCIATES**

BY: *Paul Cocolas*

---



PREFINISHED SHEET MET. COPING TO MATCH FASCIA SYSTEM OVER TREATED WOOD BLOCKING W/4" VERT. LEG & CONTINUOUS CLEAT

TOP OF PARAPET  
EL. = 1119'-8" (1029.67')

6" MET. STUDS @ 16" O.C. & 5/8" GYP EXTERIOR SHEATHING UNDER 2" POLYISOCYANURATE RIGID INSUL., WRB & PREFIN. FASCIA PANEL OUTSIDE

6" MET. STUDS @ 16" O.C. & 5/8" GYP EXTERIOR SHEATHING UNDER 2" POLYISOCYANURATE RIGID INSUL., WRB & PREFIN. FASCIA PANEL OUTSIDE

MFR. STD. PREFIN. DRIP FLASHING

WOOD BLOCKING UNDER 3/4" OSB SCUPPER SHEATHING & 60-MIL FULLY-ADHERED EPDM LINER

SHEET MET. DRIP FLASH'G UNDER BONDED EPDM IN SCUPPER - HEM TO GUTTER APRON

PREFIN. GUTTER & DOWNSPOUT - SIZED BY PEMB MANUF.

R-19 BATT INSUL. & 5/8" GYP. BD. INSIDE

6" MET. STUDS @ 16" O.C. & 5/8" GYP EXTERIOR SHEATHING UNDER 2" POLYISOCYANURATE RIGID INSUL., WRB, & PREFIN. FASCIA PANEL OUTSIDE

### ROOF DETAIL @ SCUPPER

SCALE: 1 1/2" = 1'-0"

EXIST. MULTIPLY THE BRICK WALL W/CONC. COPING & SHEET MET. FLASHING

SAWOUT NEW REGLET & INSERT SHT. MET. COUNTER-FLASH & SEALANT W/HEM TO WALL FLASH'G

PREFINISHED GALVALUME SHT. MET. FLASHING & STANDING SEAM ROOFING BY PEMB MFR.

TREATED WOOD BLOCKING

5" POLYISOCYANURATE RIGID INSULATION ON 1 1/2" METAL DECKING & 12" COLD-FORMED JOISTS

NEW 12" COLD-FORMED JOIST

### DETAIL @ ROOF TO EXISTING WALL

SCALE: 1 1/2" = 1'-0"

MEMBRANE FLASHING SECURE TO EXISTING ROOF EDGE BLOCKING

METAL DRIP EDGE FLASHING, LOCK WITH FLASHING ASSEMBLY AT CORNER SEAM USE EPDM WASHERS

END WALL METAL FLASHING EDGE, ATTACH TO EXISTING PARAPET

RUBBER CASKET BETWEEN STANDING SEAM RIDGES, SECURED TO END WALL FLASHING BY PEMB MFR STANDING SEAM MTL ROOF PANEL BY PEMB OVER #30 ROOFING FELT

END WALL FLASHING MEMBRANE, RUN UNDER FELT AND STANDING SEAM PANEL, UP AND OVER EXISTING PARAPET AND ROOF ASSEMBLY EDGE 5" RIGID INSUL. OVER 1 1/2" METAL DECK

METAL JOISTS, SEE STRUCTURAL FOR SIZE AND DETAILS

TOP OF BENT PL. JTS.  
EL.=108'-9"(1018.72')F.V.

EXISTING CMU WALL, FIELD VERIFY

BENT PLATE JOISTS SUPPORT ATTACHED TO EXISTING CMU WALL. SEE STRUCTURAL

### DETAIL @ ROOF TO EXISTING WALL

SCALE: 1 1/2" = 1'-0"

STANDING SEAM MTL ROOF PANEL BY PEMB OVER #30 ROOFING FELT OVER 5" RIGID INSULATION OVER 1-1/2" METAL DECK

SHEET MET DRIP EDGE FLASHING ATTACHED TO TOP OF WALL BLOCKING, WITH CLEAT ATTACHMENT TO WALL END

PREFORMED MTL SHEET GUTTER BY PEMB MFR, ATTACH TO BACK WALL

PREFORMED MTL SHEET GUTTER, ATTACH TO BACK WALL

### FASCIA EDGE GUTTER DETAIL

SCALE: 1 1/2" = 1'-0"

WRAP FULLY-ADHERED 60-MILL EPDM ALL SIDES OF SCUPPER & EXTEND UP 8" VERT. BOTH INSIDE & OUT UNDER FASCIA PANEL SYSTEMS

GALVALUME STANDING SEAM ROOF BY PEMB ON 1/2" STAND-OFF CLIPS

8" EAVE STRUT W/ 5/8" GYP EXTERIOR SHEATHING ON GUTTER SIDE UNDER 60-MIL FULLY-ADHERED EPDM EXTEND EPDM UNDER STANDING SEAM ROOF

PROFILE OF SCUPPER BEYOND

6" R-19 BLANKET INSUL. W/ R-11 VINYL-FACED CONTINUOUS LINER SYSTEM INSULATION

6" MET. STUDS @ 16" O.C. W/R-19 BATT INSUL. TO SUPPORT 3/4" OSB GUTTER BOTTOM

TOP SURFACE OF PEMB FRAME BEYOND

8" INSET WALL GIRT

6" MET. STUDS @ 16" O.C. & 5/8" GYP EXTERIOR SHEATHING UNDER 2" POLYISOCYANURATE RIGID INSUL., WRB, & PREFIN. FASCIA PANEL OUTSIDE

### ROOF DETAIL @ CONCEALED FACADE GUTTER

SCALE: 1 1/2" = 1'-0"

3'-8 5/8"

3'-4" TO COL. C

4 5/8"

WRAP FULLY-ADHERED 60-MILL EPDM ALL SIDES OF SCUPPER & EXTEND UP 8" VERT. BOTH INSIDE & OUT UNDER FASCIA PANEL SYSTEMS

GALVALUME STANDING SEAM ROOF BY PEMB ON 1/2" STAND-OFF CLIPS

8" EAVE STRUT W/ 5/8" GYP EXTERIOR SHEATHING ON GUTTER SIDE UNDER 60-MIL FULLY-ADHERED EPDM EXTEND EPDM UNDER STANDING SEAM ROOF

6" R-19 BLANKET INSUL. W/ R-11 VINYL-FACED CONTINUOUS LINER SYSTEM INSULATION

6" MET. STUDS @ 16" O.C. W/R-19 BATT INSUL. TO SUPPORT 5/8" GYP EXTERIOR SHEATHING GUTTER BOTTOM

REMOVE SHEET METAL FLASHING FROM EXIST. C.I.P. CONCRETE PARAPET COPING

8" EXISTING. CONC. BLK. PARAPET WALL W/ EXISTING 4" CONC. BLK PILASTER BEYOND

EAVE CLOSURE TRIM/GUTTER APRON BY PEMB MANUF.

PREFINISHED GUTTER SYSTEM FURNISHED BY PEMB MANUF. MINIMUM SIZE IS 6" X 8" COORDINATE WITH PEMB MANUFACTURER

CANTILEVERED PEMB FRAME EXTENSION BEYOND

5/8" GWB

6" MET. STUDS @ 16" O.C. & 5/8" GYP SHEATHING UNDER 2" POLYISOCYANURATE RIGID INSUL., & WRB

PREFIN. METAL FASCIA PANEL

MFR. STD. PREFIN. DRIP FLASHING

60-MIL FULLY-ADHERED EPDM - BOND TO EXIST. EPDM APPARATUS GARAGE ROOF AND EXTEND UP BACK SURFACE OF PARAPET UNDER OSB

EXIST. EPDM ROOF

LAP SEALANT

BATTEN STRIPS ANCHORED WITH FASTENERS, TYP.

### ROOF DETAIL @ EXPOSED GUTTER

SCALE: 1 1/2" = 1'-0"

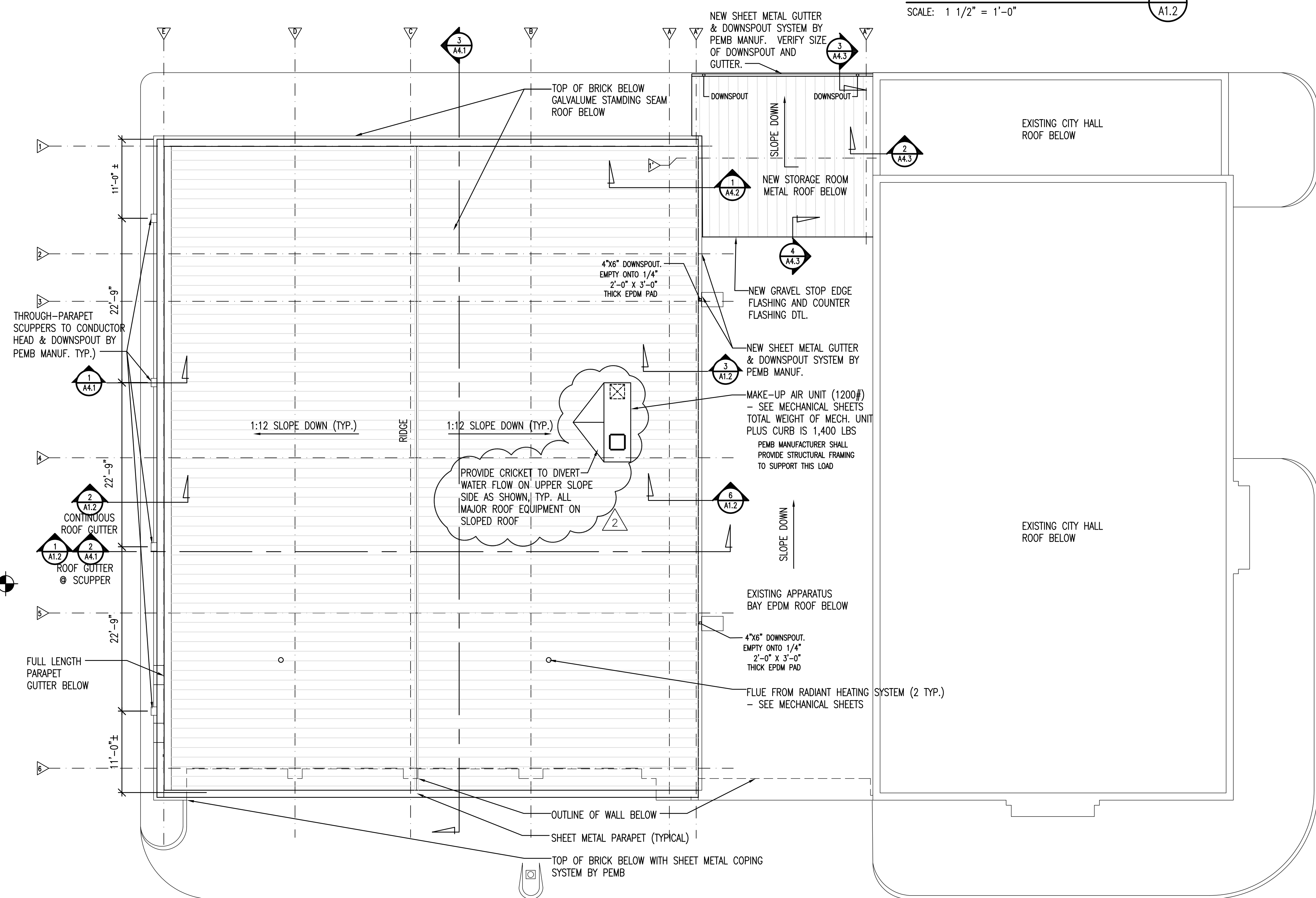

### ROOF PLAN

SCALE: 1/8" = 1'-0"

### NOTES

### PROJECT GENERAL NOTES:

- THE CONTRACTOR SHALL REVIEW THE CONTRACT DOCUMENTS AND VISIT THE PROJECT SITE TO DETERMINE ANY CONFLICTS OR OMISSIONS THAT ARE PRESENT. FAILURE TO REPORT ANY DISCREPANCIES TO THE ARCHITECT/ENGINEER OR DEVIATIONS FROM THE CONSTRUCTION DOCUMENTS WITHOUT PRIOR APPROVAL FROM THE ARCHITECT SHALL PLACE FULL RESPONSIBILITY FOR ANY NECESSARY REWORK, MODIFICATIONS, ETC. DIRECTLY UPON THE CONTRACTOR.
- ALL ITEMS SHOWN ON THE DRAWINGS ARE AS EXACT AS COULD BE SECURED. THE CONTRACTOR SHALL OBTAIN EXACT LOCATIONS, MEASUREMENTS, LEVELS, ETC. AT THE SITE AND SHALL SATISFACTORILY ADAPT HIS WORK TO THE ACTUAL CONDITIONS OF THE PROJECT. REPORT ANY DISCREPANCIES TO THE ARCHITECT.
- CONTRACTORS SHALL VISIT THE JOB SITE PRIOR TO SUBMITTING A BID TO FAMILIARIZE THEMSELVES WITH THE CONDITIONS OF THE PROJECT.
- ALL WORK SHALL COMPLY WITH ALL FEDERAL, STATE AND LOCAL CODES AND REGULATORY AGENCIES HAVING JURISDICTION IN THIS AREA.
- PRIOR TO STARTING CONSTRUCTION, THE CONTRACTOR SHALL BE RESPONSIBLE TO VERIFY THAT ALL REQUIRED PERMITS AND APPROVALS HAVE BEEN OBTAINED. NO CONSTRUCTION OR FABRICATION OF ANY ITEM SHALL BEGIN UNTIL THE CONTRACTOR HAS RECEIVED ALL COMMENTS AND ANY OTHER DOCUMENTATION FROM ALL ASSOCIATED REGULATORY AND PERMIT AUTHORITIES. FAILURE OF THE CONTRACTOR TO FOLLOW THIS PROCEDURE SHALL CAUSE THE CONTRACTOR TO ASSUME FULL RESPONSIBILITY FOR ANY SUBSEQUENT MODIFICATIONS TO THE WORK MANDATED BY ANY REGULATORY AUTHORITY.
- SHOP DRAWINGS SHALL BE SUBMITTED TO THE ARCHITECT/ENGINEER FOR APPROVAL PRIOR TO FABRICATION OF ANY ITEM. FAILURE TO ADHERE TO THIS PROCEDURE SHALL PLACE FULL RESPONSIBILITY FOR ANY ERRORS OR REWORK DIRECTLY UPON THE CONTRACTOR.
- THE GENERAL CONTRACTOR SHALL COORDINATE THE WORK OF ALL TRADES. IF THE INSTALLED WORK OF ONE SUBCONTRACTOR INTERFERES WITH THE WORK OF ANOTHER TRADE, AND NEEDS TO BE RELOCATED, THE EXPENSE OF THE MODIFICATION WILL NOT BE PASSED ON TO THE OWNER.
- THE GENERAL CONTRACTOR SHALL COORDINATE AREAS TO STAGE JOB MATERIALS AND CONSTRUCTION MATERIALS WITH THE OWNER PRIOR TO MOBILIZATION TO THE SITE.
- INTERIOR DIMENSIONS PROVIDED ARE TO FACE OF GYPSUM BOARD OR COLUMN I. CORNERLINES UNLESS NOTED OTHERWISE.

### ABBREVIATIONS

ALUM.	ALUMINUM
ANOD.	CLEAR ANODIZED
CONC	CONCRETE
COL.	COLUMN
CONT.	CONTINUOUS
DBL	DOUBLE
EXP.	EXPOSED
EXT	EXTERIOR
FIN.	FOUNDATION
ONLY	ORIENTED
GYP.	GYPSUM
HW	HOLLOW METAL
INSUL.	INSULATION
MANUF.	MANUFACTURER
MET.	METAL
OSB	ORIENTED STRAND BOARD
P	PAINT
PC	POWDER COATING
PEMB	PRE-ENGINEERED METAL BUILDING
SHT	SHEET
ST	WOOD SEMITRANSSPARENT STAIN FINISH
STL	STEEL
SCW	SOLID CORE WOOD
REINF.	REINFORCED

ADDENDUM # 11

04/18/24

REV. DESCRIPTION DATE

## MISSOURI VALLEY FIRE STATION ADDITION



223 EAST ERIE STREET  
MISSOURI VALLEY, IOWA 51555

REPRODUCTION - THIS DOCUMENT AND THE INFORMATION CONTAINED HEREIN MAY NOT BE REPRODUCED OR EXCERPTED FROM WITHOUT THE EXPRESS WRITTEN PERMISSION OF PROCHASKA & ASSOCIATES. UNAUTHORIZED COPYING, DISCLOSURE, OR CONSTRUCTION USE ARE PROHIBITED BY COPYRIGHT LAW. © COPYRIGHT 2024 PROCHASKA & ASSOCIATES, INC.

Planning Architecture Engineering  
**Prochaska & Associates**  
Interiors & Facility Management  
11317 Chicago Circle Omaha, Nebraska 68154-2633  
Phone: (402) 334-0755 Fax: (402) 334-0863

### ROOF PLAN

Date: 04/18/2024 Project No. 232908

Designed By: -

Drawn By: -

Checked By: OAF

A1.2



# XLERATOR® HAND DRYER



## ENHANCED STANDARD FEATURES



Adjustable Speed and  
Sound Control



Multi-Voltage Options:  
110-120V Or 208-277V



Adjustable Heat Settings -  
High, Medium, Low & Off



Externally Visible  
Service LED

**8**  
**SECONDS'**  
dry time

**95%**  
**COST SAVINGS**  
versus paper towels

**3.7**  
**WATT HOURS**  
energy use



# XLERATOR® HAND DRYER



MODELS: **XL - BW W GR C SB SI SP -H** (HEPA Filter) OPTIONS: **-1.1N** (Noise Reduction Nozzle) **-VOLTAGE** (See Chart)



**XL-BW**  
White Thermoset Resin (BMC)



**DRY TIME: 8 SECONDS<sup>1</sup>**

**ENERGY PER USE: 3.7 Wh**



UL Environment published the first global Product Category Rules (PCR) for hand dryers which outlined industry consensus testing procedures to quantify environmental impact and performance. Third-party testing to these guidelines documents a product's environmental impact over its lifecycle. This impact is detailed in certified, internationally-recognized Environmental Product Declarations (EPDs). EPDs enable specifiers and buyers to make true apples-to-apples comparisons and more informed product selections. Excel Dryer received the industry's first certified EPDs.

## FEATURES & BENEFITS

- ✓ Industry Leading 7-Year Limited Warranty
- ✓ 95% Cost Savings Vs. Paper Towels
- ✓ Helps Contribute to WELL Points and Several LEED® credits
- ✓ Made In USA Certified®
- ✓ A Hygienic Hand Drying Solution
- ✓ Washable Pre-Filter
- ✓ Adjustable Sensor Range

## OPTIONS

- ✓ **Electrostatic HEPA Filtration System:** Removes 99.999% of viruses and 99.97% of potentially present bacteria at 0.3 microns from the airstream<sup>2</sup>.
- ✓ **1.1" Noise Reduction Nozzle:** Reduces the sound level by 9 decibels by significantly decreasing air deflection noise while only increasing dry time by approximately 3 seconds.



**XL-W**  
White Epoxy Painted



**XL-GR**  
Graphite Textured Painted



**XL-SP<sup>3</sup>**  
Custom Special Paint

"XL-SP Red Baron"



**XL-SI<sup>4</sup>**  
Custom Special Image



**XL-C**  
Chrome Plated



**XL-SB**  
Brushed Stainless Steel

**MISSOURI VALLEY FIRE STATION - ADDITION**

## PERFORMANCE

**ADJUSTABLE SOUND LEVEL:** 65-75 dB **ADJUSTABLE VELOCITY:** 13,000-20,000 LFM  
**ADJUSTABLE HEAT RANGE:** 72°F-135°F **ADJUSTABLE FLOW RATE:** 42-63 CFM

## DIMENSIONS

**Width** 11 3/4" (298 mm) **Height** 12 11/16" (322 mm) **Depth** 6 11/16" (170 mm)

## ELECTRICAL

VOLTS	AMPS	WATTS	AMPS (NO HEAT)	WATTS (NO HEAT)	HERTZ	LISTING
110-120V	11.3-12.2A	1,213-1,450W	4.3-4.5A	442-513W	416-50/60 Hz	cULus
208-240V	5.6-6.2A	1,135-1,450W	2.0-2.2A	495W	50/60 Hz	cULus
208-277V	5.6-6.2A	1,135-1,450W	2.0-2.2A	416-495W	50/60 Hz	UL
230V	6.1A	1,400W	2.1A	500W	50-60 Hz	CE

## CERTIFICATIONS



## WEIGHT

**XL-BW:** 15 lbs. (6.8 kgs.) **XL-SB:** 16 lbs. (7.26 kgs.) **XL-W, GR, C, SI, SP:** 17 lbs. (7.71 kgs.)

## ACTIVATION

Automatic Sensor Operated

## MOUNTING

Surface Mounted

## SUGGESTED MOUNTING HEIGHTS

**Men** 45" (114 cm) **Women** 43" (109 cm) **Accessible** 37" (94 cm)

Note: Heights measured from floor to bottom of dryer.

## ACCESSORIES

- ✓ Antimicrobial Wall Guards (#89B, #89W, #89S)
- ✓ XChanger® Paper Towel Dispenser Retrofit Kit (#40575, #40550)
- ✓ ADA-Compliant Recess Kit (#40502)

#40502



<sup>1</sup>Dry time and energy use testing performed by SGS International on standard XLERATOR Hand Dryer with 0.8" nozzle to 0.25g or less of residual moisture, pursuant to the UL Environment Global Product Category Rules (PCR) for Hand Dryers. <sup>2</sup>Based on testing performed by LMS Technologies, 2023. <sup>3</sup>Special Paint powder-coated covers are available in many colors and textures. <sup>4</sup>Exclusive digital image technology allows for the addition of company, school or team logos with any color, design or a 'green message'.



# TIME TO THROW IN THE TOWEL®

EXCEL DRYER INC • 1.800.255.9235 • EXCELDRYER.COM

**AUG  
2023**

23XLS1195